

LAYOUT 6/14/11 INSP 4 _____
INSP 2 _____ INSP 5 _____
INSP 3 _____ INSP 6 _____

ISSUE DATE: 6-1-11

PERMIT

P ~~63286~~ 535730

APPROVAL DATE: 6/27/11

A _____

Tax ID # _____

ON-SITE SEWAGE DISPOSAL SYSTEM TANK REPLACEMENT HOWARD COUNTY HEALTH DEPARTMENT BUREAU OF ENVIRONMENTAL HEALTH

J.A. Smith and Co. Inc. IS PERMITTED TO INSTALL ALTER

ADDRESS: 7080 Kitkat Road PHONE NUMBER: 410-796-7532

SUBDIVISION: _____ LOT NUMBER: _____

ADDRESS: 12010 Triadelphia Road PROPERTY OWNER: Jack Lauderdale

SEPTIC TANK CAPACITY (GALLONS): 1500 OUTLET BAFFLE FILTER REQUIRED

PUMP CHAMBER CAPACITY (GALLONS): _____ COMPARTMENTED TANK REQUIRED

NUMBER OF BEDROOMS: 4 APPLICATION RATE: _____

SQUARE FOOTAGE OF HOUSE: _____

LINEAR FEET OF TRENCH REQUIRED: _____

NOTES:	Do not order the septic tank until after layout inspection and Sanitarian approval. Layout inspection required prior to tank installation. Original septic tank must be properly abandoned before new tank installation. A written variance request is required for tanks deeper than 3 feet. A traffic bearing lid is required for tanks deeper than 4 feet.
--------	--

PLANS APPROVED: HS DATE: 6-1-11

- NOTE: PERMIT VOID AFTER 2 YEARS
- NOTE: CONTRACTOR RESPONSIBLE FOR SCHEDULING A PRE-CONSTRUCTION INSPECTION FOR ALL INSTALLATIONS
- NOTE: WATERTIGHT SEPTIC TANKS REQUIRED
- NOTE: ALL PARTS OF SEPTIC SYSTEM SHALL BE 100 FEET FROM ANY WATER WELL
- NOTE: MANHOLE RISERS REQUIRED ON ALL SEPTIC TANKS AND PUMP CHAMBERS

**NEITHER THE HOWARD COUNTY COUNCIL OR THE HEALTH DEPARTMENT IS
RESPONSIBLE FOR THE SUCCESSFUL OPERATION OF ANY SYSTEM
PERMITTEE RESPONSIBLE FOR OBTAINING FINAL APPROVAL ON THIS PERMIT
CALL 410-313-1771 FOR INSPECTION OF SEPTIC SYSTEM**

NOT TO SCALE

☐ = Proposed Addition

40

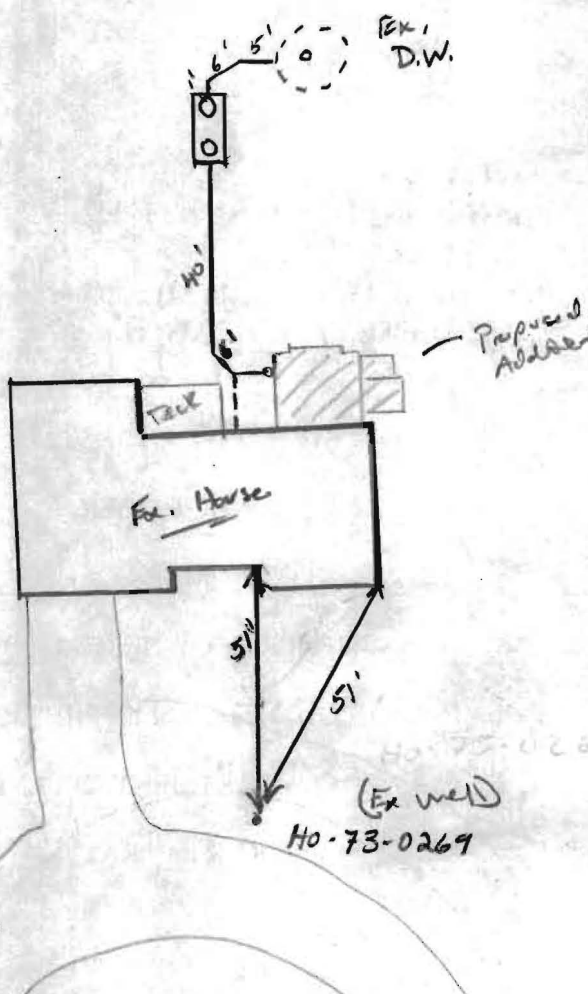

ROAD NAME

TRENCH/DRAINFIELD DATA

WIDTH _____ INLET _____ BOTTOM _____

NUMBER OF TRENCHES _____

TOTAL LENGTH _____

ABSORPTION AREA _____

DISTRIBUTION BOX LEVEL _____

DISTRIBUTION BOX BAFFLE _____

DISTRIBUTION BOX PORT _____

SEPTIC TANK DATA

SEPTIC TANK I LEVEL Yes

MANUFACTURER Myer Bros

CAPACITY 1500 GAL

SEAM LOC Top

TANK LID DEPTH 3'

BAFFLES Yes

BAFFLE FILTER —

MANHOLE LOC Front/Door

6" PORT LOC none

WATERTIGHT TEST —

SLOTTED Yes

DATE ON LID —

PUMP/SEPTIC TANK LEVEL

MANUFACTURER _____

CAPACITY _____ GAL

SEAM LOC _____

TANK LID DEPTH _____

BAFFLES _____

BAFFLE FILTER _____

MANHOLE LOC _____

6" PORT LOC _____

WATERTIGHT TEST _____

SLOTTED _____

DATE ON LID _____

PRE-CONSTRUCTION:

6/14/11 Spoke w/ contractor on phone. Told him it was ok to set back. Make sure addition is staked out and new tank location is at least 20' removed. Call when done is set (14)

INSTALLATION:

6/27/11 New S.T installed. Baffles installed. Tied back in existing Day wall. 106 feet Add. Could not confirm setback from new addition as it was not staked. (14)

FINAL INSPECTOR

J. Wolf

DATE OF APPROVAL

6/27/11

