

APPLICATION

A 17641

P _____

SEWAGE DISPOSAL TESTING

MARYLAND STATE DEPARTMENT OF HEALTH

HOWARD COUNTY

ELLICOTT CITY

DISTRICT 5th

DATE 11/14/72

11/16/72
9:30 A.M.

Rejected

TO: THE COUNTY HEALTH OFFICER
ELLICOTT CITY, MARYLAND

I, HEREBY, APPLY FOR THE NECESSARY TESTS IN ORDER TO CONSTRUCT (OR RECONSTRUCT) A SEWAGE DISPOSAL SYSTEM.

PROPERTY OWNER William E. Richards & Wife (Schaffner - Contract Purchaser)

ADDRESS _____

Any questions call Mr. Wm.
PHONE Swann - 286-2608

PROPERTY LOCATION:

SUBDIVISION _____ LOT NO. _____

ROAD AND DESCRIPTION Brighton Dam Road-Highland Road - 1/2 mile east on Brighton Dam Road - Peck Real Estate sign is on lot.

OCCUPANT _____ PHONE _____

PERSON TO CONSTRUCT SYSTEM _____

ADDRESS _____ PHONE _____

SIZE OF LOT 5 acres TYPE BLDG. 3 or 4 bedrooms
NUMBER OF BEDROOMS

IF NOT SINGLE RESIDENCE DESCRIBE _____

SIGNATURE OF APPLICANT /s/ William Swann

APPROVED BY _____ FOR _____ DATE _____

REJECTED BY C. Shaker FOR Any Type DATE 11/16/72
(KIND OF SYSTEM)

HOLD PENDING FURTHER TESTS _____ DATE _____

REASONS FOR REJECTION OR HOLDING Water everywhere 4' deep

THIS IS NOT A PERMIT

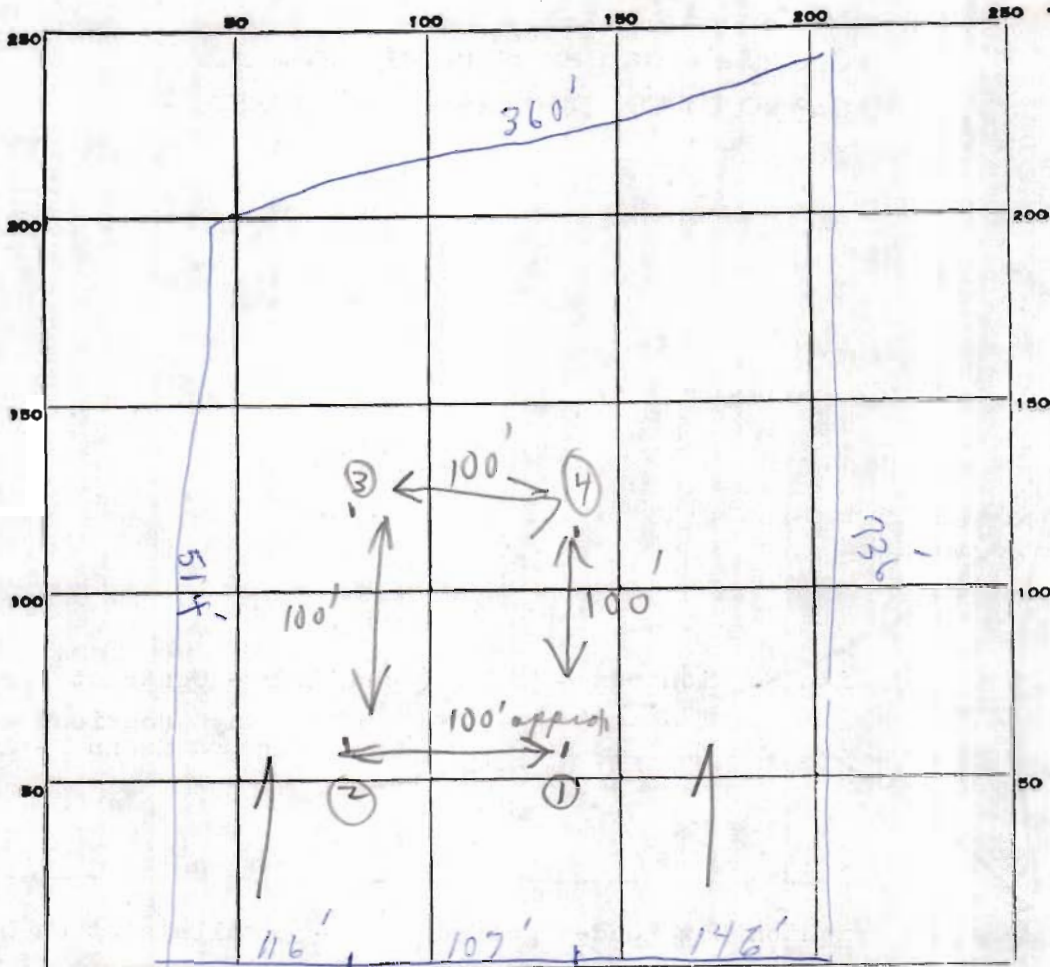

INDICATE NORTH. - NAME ADJOINING ROADWAY AS BASE LINE.

Brighton Dam Road

DATE	TEST NO.	DEPTH	PRE-WET		TEST - 1" DROP		TIME
			START	STOP	START	STOP	
11/14/72	1	Water at		4'			
	2	" "		4'			
	3	Water		3'			
	4	Water		3 1/2'			
(No tests. Water in every hole!!)							
Revised C.S.D.							

SOIL AUGER FINDING _____

TESTED BY _____

REMARKS _____

This lot closest to Highland Rd.

M.A. Hoover

APPLICATION

A 17642

P _____

SEWAGE DISPOSAL TESTING

MARYLAND STATE DEPARTMENT OF HEALTH

HOWARD COUNTY Septic Tank $\left\{ \begin{array}{l} 1000 \text{ } 3 \text{ Bedrooms} \\ 1200 \text{ } 4 \text{ Bedrooms} \end{array} \right.$ ELLICOTT CITY

Day Well to have 120 sq. ft. effective diameter DISTRICT 5th DATE 11/14/72

Side wall area per bedroom below inlet. Inlet to be 4' below original grade and maximum depth 12' below original grade. Location 175' from edge of road and 135' in from right property line when facing lot from road.

TO: THE COUNTY HEALTH OFFICER
ELLICOTT CITY, MARYLAND

I, HEREBY, APPLY FOR THE NECESSARY TESTS IN ORDER TO CONSTRUCT (OR RECONSTRUCT) A SEWAGE DISPOSAL SYSTEM.

PROPERTY OWNER William E. Richards & Wife (Schaffner - Contract Purchaser)

ADDRESS _____ PHONE Swann - 286-2608
Any questions call Mr. Wm.

PROPERTY LOCATION:

SUBDIVISION _____ LOT NO. _____

ROAD AND DESCRIPTION Brighton Dam Road & Highland Road - 1/2 mile east on Brighton Dam Road - Peck Real Estate sign on lot.

OCCUPANT _____ PHONE _____

PERSON TO CONSTRUCT SYSTEM _____

ADDRESS _____ PHONE _____

SIZE OF LOT 5 acres TYPE BLDG. 3 or 4 bedrooms
NUMBER OF BEDROOMS

IF NOT SINGLE RESIDENCE DESCRIBE _____

SIGNATURE OF APPLICANT /s/ William Swann

APPROVED BY C. Straker FOR Day Well DATE 11/16/72
(KIND OF SYSTEM)

REJECTED BY _____ FOR _____ DATE _____
(KIND OF SYSTEM)

HOLD PENDING FURTHER TESTS _____ DATE _____

REASONS FOR REJECTION OR HOLDING _____

THIS IS NOT A PERMIT

SAVY A

APPLICATION

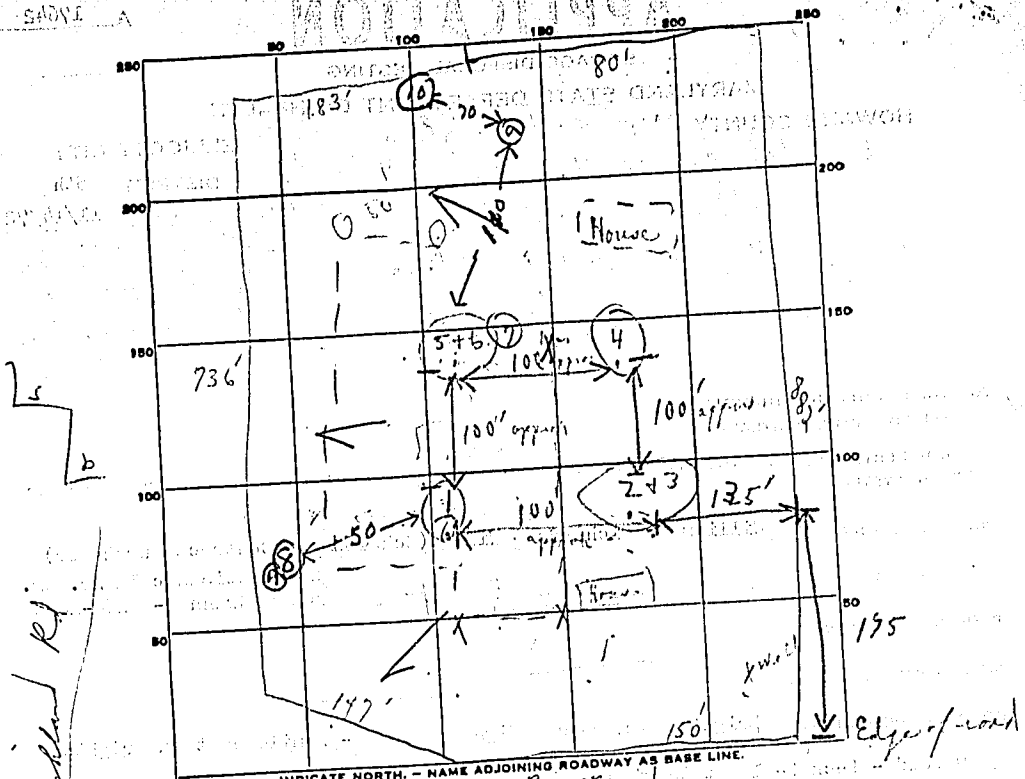

INDICATE NORTH. - NAME ADJOINING ROADWAY AS BASE LINE.

Highland Rd

Burrton Dom Road

DATE	TEST NO.	DEPTH	PRE-WET		TEST - 1" DROP		TIME	
			START	STOP	START	STOP		
11/14/72	1	1 1/2	Day	10:15	10:22	10:29	2 min	
	2	4'	10:15	10:22	10:22	10:29	2 min	
	3	1 1/2	10:17	10:20	10:20	10:33	13 min	
	4	Same as 2 + 3						
	5	4'	10:04	10:04	10:04	10:13	5 min	
	6	12'	10:05	10:08	10:08	10:13	5 min	
	7	4 1/2'	10:37	10:41	10:41	10:48	7 min	
8/29/73	8	10 1/2'	10:55	10:55	11:02	11:14	11 min	
	8A	4 ft.	10:58	10:58	10:58	10:58	0 min	
	9	12 ft.	10:28	10:28	10:28	10:32	3 min	
	9A	4 1/2 ft.	10:29	10:29	10:29	10:29	0 min	
	10	10 1/2'	hard soil - hitting some stone					

1200 gpd per bedrock

8 min

SOIL AUGER FINDING

B.S.

TESTED BY

Mr. Hoxon & Mr. Sam P... (This lot furthest from Highland Rd)

REMARKS

W.E. RICHARDS & WF.
524/612

360.0'
N 67° 24' 25" E

W.E. RICHARDS & WF
524/612

NOTE: PLAT FROM DEEDS

5 ACRES ±

TAX MAP 34 PART OF P. 14

501° 20' 35" E

736.0'

N 00° 50' 48" E

514.49'

BOYER
541/343

116.91'
N 77° 14' 42" W

107.73'
N 78° 55' 12" W

146.0'
253.73'

BRIGHTON

DAM

ROAD

PARCEL TO BE CONVEYED BY

WILLIAM E. RICHARDS & WF.

5th ELECT. DIST

HOWARD CO., MD.

NOV 13, 1972

SCALE 1" = 100'



Curt A. Jeschke
PURDUM & JESCHKE
CONSULTING ENGINEERS
AND LAND SURVEYORS
1023 NORTH CALVERT STREET
BALTIMORE, MARYLAND 21202

W.E. RICHARDS & WF
524/612

N 52° 12' 44"
80.0'

N 67° 24' 25" E
183.04'

POKORSKI

587/508

W.E. RICHARDS & WF,
524/612

5 ACRES ±
TAX MAP 34
PART OF P. 14

NOTE: PLAT FROM DEEDS

N 01° 20' 35" W

736.0'

S 04° 20' 42" E

882.47'

7th DAY ADVENTISTS

537/697

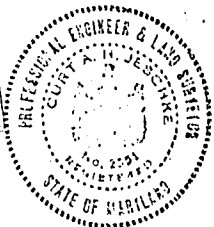

147.27'
N 78° 55' 12" W
BRIGHTON

150.0'
N 87° 20' 42" W
DAM ROAD

PARCEL TO BE CONVEYED BY
WILLIAM E. RICHARDS & WF.

5th ELECT. DIST. - HOWARD CO., MD.

Nov. 13, 1972

SCALE 1"=100'

William E. Purdum
PURDUM & JESCHKE
CONSULTING ENGINEERS
(AND LAND SURVEYORS)
223 NORTH CALVERT STREET
BALTIMORE, MARYLAND 21202