



# Building Permit Application

Howard County Maryland  
Department of Inspections, Licenses and Permits  
3430 Court House Drive  
Permits: 410-313-2455  
www.howardcountymd.gov

Date Received: \_\_\_\_\_

Permit No.: \_\_\_\_\_

Building Address: 3207 Rosway Ct.  
 City: Glenelg State: MD Zip Code: 21737  
 Suite/Apt. # \_\_\_\_\_ SDP/WP/BA #: \_\_\_\_\_  
 Census Tract: \_\_\_\_\_ Subdivision: 0000  
 Section: \_\_\_\_\_ Area: 3.3000AC Lot: 17  
 Tax Map: 0022 Parcel: 0549 Grid: 0001  
 Zoning: \_\_\_\_\_ Map Coordinates: \_\_\_\_\_ Lot Size: \_\_\_\_\_

Property Owner's Name: Karen & James Miller  
 Address: 3207 Rosway Ct  
 City: Glenelg State: MD Zip Code: 21737  
 Phone: 443-266-7089 Fax: \_\_\_\_\_  
 Email: kjmkiddoc@aol.com  
 Applicant's Name & Mailing Address, (if other than stated herein)  
 Applicant's Name: Meagan Braganca  
 Address: 9009 Mendenhall Ct., Ste E  
 City: Columbia State: MD Zip Code: 21045  
 Phone: 410-505-4848 Fax: 443-420-4098  
 Email: info@aurora-energy.com

Existing Use: \_\_\_\_\_  
 Proposed Use: \_\_\_\_\_  
 Estimated Construction Cost: \$ 101,800.00  
 Description of Work: INSTALL 105 GROUND MOUNTED SOLAR MODULES AND 4 GRID-TIED PHOTOVOLTAIC INVERTERS.  
 Occupant or Tenant: \_\_\_\_\_  
 Was tenant space previously occupied?  Yes  No  
 Contact Name: \_\_\_\_\_  
 Address: \_\_\_\_\_  
 City: \_\_\_\_\_ State: \_\_\_\_\_ Zip Code: \_\_\_\_\_  
 Phone: \_\_\_\_\_ Fax: \_\_\_\_\_  
 Email: \_\_\_\_\_

Contractor Company: Aurora Energy, Inc.  
 Contact Person: Fariborz S. Mahjouri  
 Address: 9009 Mendenhall Ct., Ste E  
 City: Columbia State: MD Zip Code: 21045  
 License No.: MHIC 92095  
 Phone: 410-505-4848 Fax: 443-420-4098  
 Email: info@aurora-energy.com

Engineer/Architect Company: Aurora Energy, Inc.  
 Responsible Design Prof.: Fariborz Mahjouri, P.E.  
 Address: 9009 Mendenhall Ct., Ste E  
 City: Columbia State: MD Zip Code: 21045  
 Phone: 410-505-4848 Fax: 443-420-4098  
 Email: info@aurora-energy.com

Commercial Building Characteristics	Residential Building Characteristics	
Height:	<input checked="" type="checkbox"/> SF Dwelling <input type="checkbox"/> SF Townhouse	
No. of stories:	Depth	Width
Gross area, sq. ft./floor:	1 <sup>st</sup> floor:	
Area of construction (sq. ft.):	2 <sup>nd</sup> floor:	
Use group:	Basement:	
	<input type="checkbox"/> Finished Basement	
	<input type="checkbox"/> Unfinished Basement	
	<input type="checkbox"/> Crawl Space	
	<input type="checkbox"/> Slab on Grade	
<b>Construction type:</b>	No. of Bedrooms:	
<input type="checkbox"/> Reinforced Concrete	<b>Multi-family Dwelling</b>	
<input type="checkbox"/> Structural Steel	No. of efficiency units:	
<input type="checkbox"/> Masonry	No. of 1 BR units:	
<input type="checkbox"/> Wood Frame	No. of 2 BR units:	
<input type="checkbox"/> State Certified Modular	No. of 3 BR units:	
	Other Structure:	
	Dimensions:	
<input checked="" type="checkbox"/> Roadside Tree Project Permit	Footings:	
<input type="checkbox"/> Yes <input checked="" type="checkbox"/> No	Roof:	
Roadside Tree Project Permit #	<input type="checkbox"/> State Certified Modular	
	<input type="checkbox"/> Manufactured Home	

Utilities	
<b>Water Supply</b>	
<input type="checkbox"/> Public	
<input checked="" type="checkbox"/> Private	
<b>Sewage Disposal</b>	
<input type="checkbox"/> Public	
<input checked="" type="checkbox"/> Private	
Electric:	<input type="checkbox"/> Yes <input type="checkbox"/> No
Gas:	<input type="checkbox"/> Yes <input type="checkbox"/> No
<b>Heating System</b>	
<input checked="" type="checkbox"/> Electric	<input type="checkbox"/> Oil
<input type="checkbox"/> Natural Gas	<input type="checkbox"/> Propane Gas
<input type="checkbox"/> Other:	
<b>Sprinkler System:</b>	
<input type="checkbox"/> Yes	<input checked="" type="checkbox"/> No
Grading Permit Number:	
Building Shell Permit Number:	

THE UNDERSIGNED HEREBY CERTIFIES AND AGREES AS FOLLOWS: (1) THAT HE/SHE IS AUTHORIZED TO MAKE THIS APPLICATION; (2) THAT THE INFORMATION IS CORRECT; (3) THAT HE/SHE WILL COMPLY WITH ALL REGULATIONS OF HOWARD COUNTY WHICH ARE APPLICABLE THERETO; (4) THAT HE/SHE WILL PERFORM NO WORK ON THE ABOVE REFERENCED PROPERTY NOT SPECIFICALLY DESCRIBED IN THIS APPLICATION; (5) THAT HE/SHE GRANTS COUNTY OFFICIALS THE RIGHT TO ENTER ONTO THIS PROPERTY FOR THE PURPOSE OF INSPECTING THE WORK PERMITTED AND POSTING NOTICES.

Applicant's Signature: \_\_\_\_\_  
 info@aurora-energy.com  
 Email Address  
 AURORA ENERGY, INC.  
 Title/Company

MEAGAN BRAGANCA  
 Print Name  
 11/10/2015  
 Date

Checks Payable to: DIRECTOR OF FINANCE OF HOWARD COUNTY

\*\*PLEASE WRITE NEATLY & LEGIBLY\*\*

-FOR OFFICE USE ONLY-

AGENCY	DATE	SIGNATURE OF APPROVAL
State Highways		
Building Officials		
PSZA ( Zoning )		
PSZA ( Engineering )		
Health	11/10/15	H. Oswald

Is Sediment Control approval required for issuance?  Yes  No  
 CONTINGENCY CONSTRUCTION START

DPZ SETBACK INFORMATION	
Front:	
Rear:	
Side:	
Side St.:	
All minimum setbacks met?	<input type="checkbox"/> Yes <input type="checkbox"/> No
Is Entrance Permit Required?	<input type="checkbox"/> Yes <input type="checkbox"/> No
Historic District?	<input type="checkbox"/> Yes <input type="checkbox"/> No
Lot Coverage for New Town Zone:	
SDP/Red-line approval date:	

Filing Fee	\$	55.00
Permit Fee	\$	55.00
Tech Fee	\$	
Excise Tax	\$	
PSFS	\$	
Guaranty Fund	\$	
Add'l per Fee	\$	
Total Fees	\$	
Sub- Total Paid	\$	
Balance Due	\$	
Check	#	

Distribution of Copies: White: Building Officials Green: PSZA,Zoning Yellow: PSZA,Engineering Pink: Health Gold: SHA

ARRAY & SUPPORT STRUCTURE LAYOUT  
SCALE: 1/4"=1'

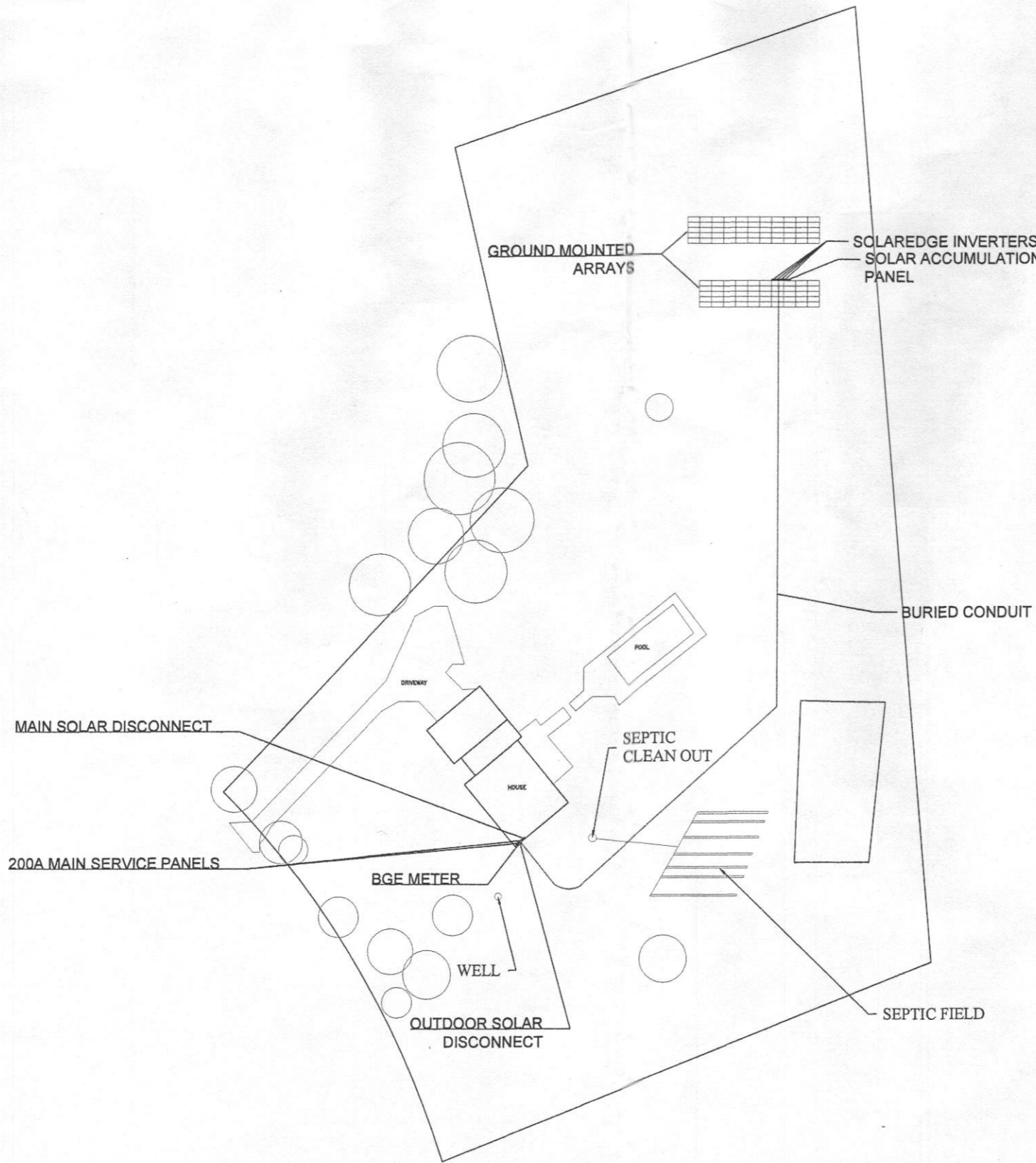

APPROVED  
WALK-THRU BUILDING PERMIT  
BP# \_\_\_\_\_ A# \_\_\_\_\_  
APP. SAN H. Osmond DATE: 11/10/15  
DESC. OF WORK: Install 1105  
ground mounted solar modules  
& 4 grid-tied photovoltaic  
inverters.



*M. Mahjour*  
11/10/15



**Aurora Energy**  
AURORA ENERGY, INC.  
9009 MENDENHALL COURT SUITE E  
COLUMBIA, MARYLAND 21045 (410) 505-4848  
THIS DOCUMENT CONTAINS PROPRIETARY INFORMATION, REPRODUCTION, DISCLOSURE, OR DISTRIBUTION OF THIS DOCUMENT WITHOUT THE AUTHORIZATION OF THE AURORA ENERGY CORPORATION IS STRICTLY FORBIDDEN.



MILLER RESIDENCE  
34,125 WATT SOLAR ELECTRIC SYSTEM  
MARYLAND 21737  
3207 ROSWAY COURT  
GLENELG (443) 266-7089  
Professional Certification: I hereby certify that these documents were prepared and that I am a duly licensed Professional Engineer under the laws of the State of Maryland. License # 39294. Expiration Date: July 9, 2016

REV #	DATE	DESCRIPTION	BY
1	10/1/2015	SITE PLAN	RS

OPPORTUNITY	SPR
PROJECT	NAME
DATE DRAWN	10/1/2015
DRAWN BY	RS

5 of 6  
SHEET  
PV04