

B 1 7943 SEQUENCE NO. (WRA USE ONLY)

STATE OF MARYLAND
WATER RESOURCES ADMINISTRATION
TAWES STATE OFFICE BLDG., ANNAPOLIS, MARYLAND 21401
APPLICATION FOR PERMIT TO DRILL WELL

WRA PERMIT NUMBER
 HO-795-9725
FILL IN THIS FORM COMPLETELY

DATE RECEIVED (WRA USE ONLY)
 5/1/78
 10:30 A.M.

OWNER MHWN Wm. H & Judith

STREET OR RFD 5423 STORM DRIFT

POST OFFICE COLUMBIA, Md. 21045

B 1 CONTINUED DRILLER INFORMATION

DATE 4/6/78 **LICENSE NUMBER** 154

FIRST NAME MD. DRILLING CO. **DRILLER LAST NAME** John Wells

SIGNATURE [Signature]

B 3 LOCATION OF WELL

COUNTY HOWARD

SUBDIVISION ADDRESS FIELD

SECTION PLAT 3 **LOT** 14-A

NEAREST TOWN FULTON

MILES FROM TOWN (ENTER 0 IF IN TOWN) 1

B 2 WELL INFORMATION

MAXIMUM PUMPING RATE (GALLONS PER MINUTE) 5

AVERAGE DAILY QUANTITY NEEDED (GALLONS PER DAY) 500

USE FOR WATER (CIRCLE APPROPRIATE BOX)

HOME (SINGLE OR DOUBLE HOUSEHOLD UNIT ONLY)

FARMING, AGRICULTURE, IRRIGATION

INDUSTRIAL, COMMERCIAL, STATE AND FEDERAL GOVERNMENT.

MUNICIPAL WATER SUPPLY

PRIVATE WATER COMPANY } MUST HAVE STATE HEALTH DEPT. APPROVAL

TEST

B 4 DIRECTION FROM TOWN (CIRCLE APPROPRIATE BOX)

NORTH EAST NE NORTHEAST SE SOUTHEAST

SOUTH WEST NW NORTHWEST SW SOUTHWEST

NEAR WHAT ROAD CHERRY TREE DRIVE

ON WHICH SIDE OF ROAD (CIRCLE APPROPRIATE BOX) NORTH SOUTH EAST WEST

DISTANCE FROM ROAD (ENTER DISTANCE AND CIRCLE APPROPRIATE BOX) 100

APPROXIMATE DEPTH OF WELL 200 FEET

APPROXIMATE DIAMETER OF WELL 6 (NEAREST INCH)

METHOD OF DRILLING USED (CIRCLE APPROPRIATE METHOD)

RORED (OR AUGERED) JETTED DRIVEN

AIR-ROTARY AIR-PERCUSSION ROTARY (HYDRAULIC ROTARY)

CABLE REVERSE-ROTARY DRIVE-POINT

OTHER (DESCRIBE)

REPLACEMENT OR DEEPEMED WELLS (CIRCLE APPROPRIATE BOX)

THIS WELL WILL NOT REPLACE AN EXISTING WELL

THIS WELL WILL REPLACE A WELL THAT WILL BE ABANDONED AND SEALED

THIS WELL WILL REPLACE A WELL THAT WILL BE USED AS A STANDBY

THIS WELL WILL DEEPEM AN EXISTING WELL PERMIT NUMBER OF WELL TO BE REPLACED OR DEEPEMED (IF AVAILABLE)

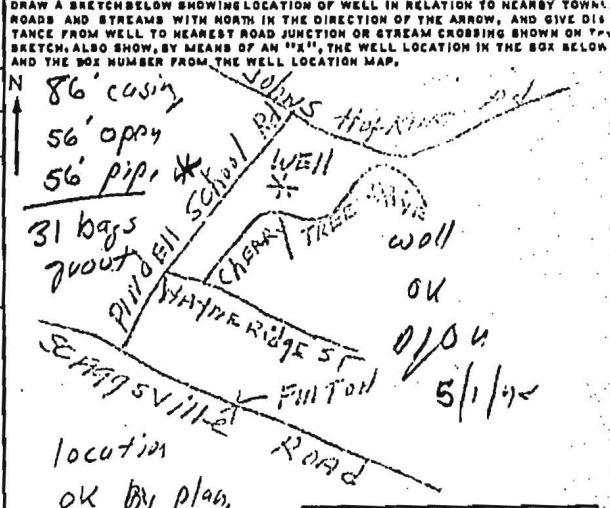

NOT TO BE FILLED IN BY DRILLER (WRA USE ONLY)

APPROPRIATION PERMIT NUMBER 84 **ENGINEER REVIEW DISTRICT NO.** 85

FORCE WRITE INITIALS IN BOX **CONDITIONS** 70 71 72 73 74 75 76 77 78 79

BOX NUMBER 820 480

NORTH COORDINATE 480000

EAST COORDINATE 480000

ELEVATION AT WELL HEAD (FEET) 0/0 5/0

B 4 CONTINUED HEALTH DEPARTMENT APPROVAL

COUNTY HOWARD **COUNTY NO.** 27801

DATE 4/27/78

APPROVED BY [Signature]

48 Donald W. Monahan, Sanitarian

B 5 SPECIAL CONDITIONS 8-83 (WRA USE ONLY)

407601 HEALTH See Back

* reached 56' with weight.

Attempted to insert 60' grout pipe, jetted with water under pressure. Unable to get past ~ 56', grouted with 50' grout pipe in place.

Done 5/1/76 3:30 pm

RECEIVED
HOWARD COUNTY
HEALTH DEPT.
MAY 25 9 03 AM '76
DIVISION OF
ENVIRONMENTAL
HEALTH