

1. HMA SUPERPAVE LAYERS SHALL BE PLACED IN APPROPRIATE COMPACTED LIFT THICKNESSES: 18.0 MM BASE (0.7\"/>
- 2. GRADED ADVERTISE BASE (GAB) TO BE PLACED AND COMPACTED IN 4\"/>
- 3. THE INTERMEDIATE SURFACE COURSE LAYER MUST BE PLACED WITHIN 2 WEEKS OF PLACEMENT OF BASE COURSE, AND IS REQUIRED PRIOR TO SUBSTANTIAL COMPLETION INSPECTION AND BOND REDUCTION.
- 4. IN LIEU OF PLACING THE INTERMEDIATE SURFACE COURSE LAYER FOR COMMERCIAL / INDUSTRIAL ENTRANCE APPROX WITHIN THE COUNTY RIGHT-OF-WAY WHERE AUXILIARY LANES ARE NOT REQUIRED, THE THICKNESS OF THE INTERMEDIATE PAVEMENT LAYER CAN BE ADDED TO THE REQUIRED THICKNESS OF THE BASE ASPHALT LAYER.
- 5. THE CONSTRUCTION DRAINAGE SHALL SHOW THE PAVING SECTION, ROAD CLASSIFICATION AND CURB VALUE FOR EACH ROADWAY.



OWNER/DEVELOPER
 LINWOOD CENTER, INC.
 C/O WILLIAM MOSS
 3421 MARTHA BUSH DRIVE
 ELLICOTT CITY, MARYLAND 21043
 410.486.1352

SITE DEVELOPMENT PLAN
LINWOOD CENTER, INC.
 HDC-10-10; ECP-11-037

TAX MAP 25 GRID 1 PARCELS 2
 2ND ELECTION DISTRICT HOWARD COUNTY, MD

Sill · Adcock & Associates · LLC
 Engineers · Surveyors · Planners
 3300 North Ridge Road, Suite 160
 Ellicott City, Maryland 21043
 Phone: 443.325.7682 Fax: 443.325.7685
 Email: info@silladcock.com

DESIGN BY: _____
 DRAWN BY: _____
 CHECKED BY: _____
 SCALE: 1"= _____'
 DATE: APRIL 11
 PROJECT #: _____
 SHEET #: 3

PROFESSIONAL CERTIFICATION: I HEREBY CERTIFY THAT THESE DOCUMENTS WERE PREPARED OR APPROVED BY ME, AND THAT I AM A LICENSED PROFESSIONAL ENGINEER UNDER THE LAWS OF THE STATE OF MARYLAND, LICENSE NO. 8896, EXPIRATION DATE: 2014.

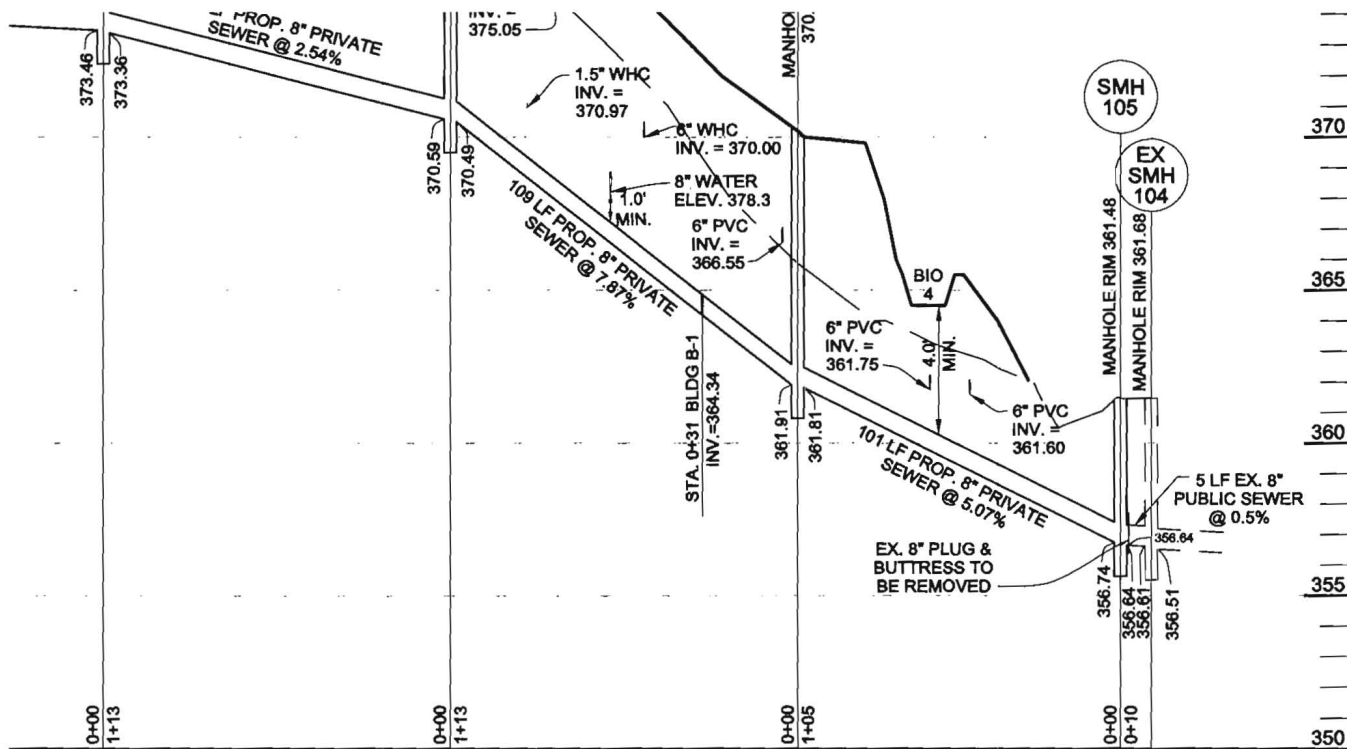

PRIVATE SEWER PROFILE

HORIZONTAL SCALE: 1"=50'
 VERTICAL SCALE: 1"=5'

SITE INSPECTION SHEET

OWNER: _____ PHONE #: _____
ADDRESS: 3431 Park Dr CONTRACTOR: _____
(or Church Rd.) WELL TAG #: _____
SUBDIVISION: _____ LOT: _____ COUNTY #: _____
PROPOSAL: _____

LOCATION DIAGRAM

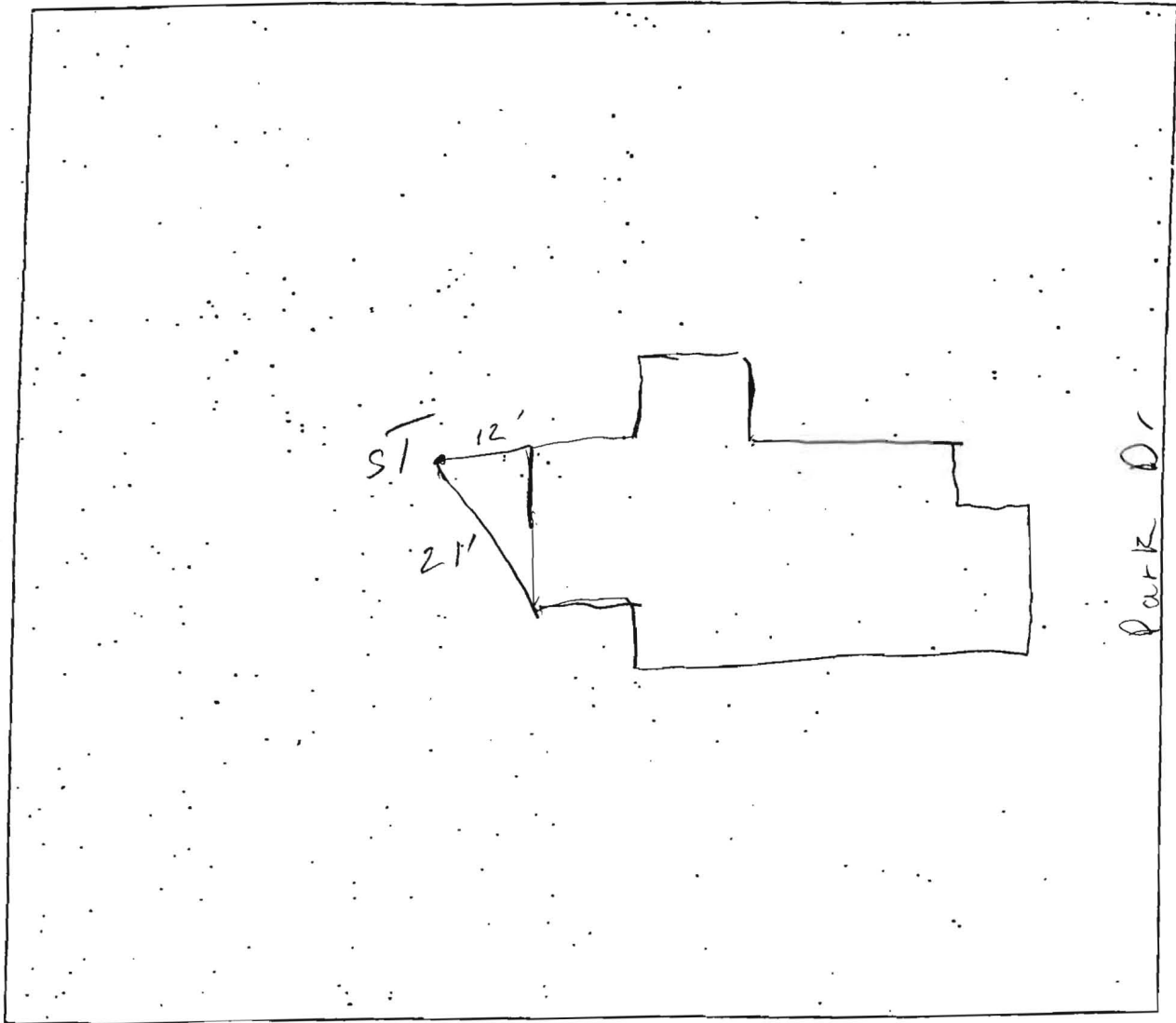

COMMENTS: Public sewer available in R-O-W (Church Rd.)

-76°48'4."

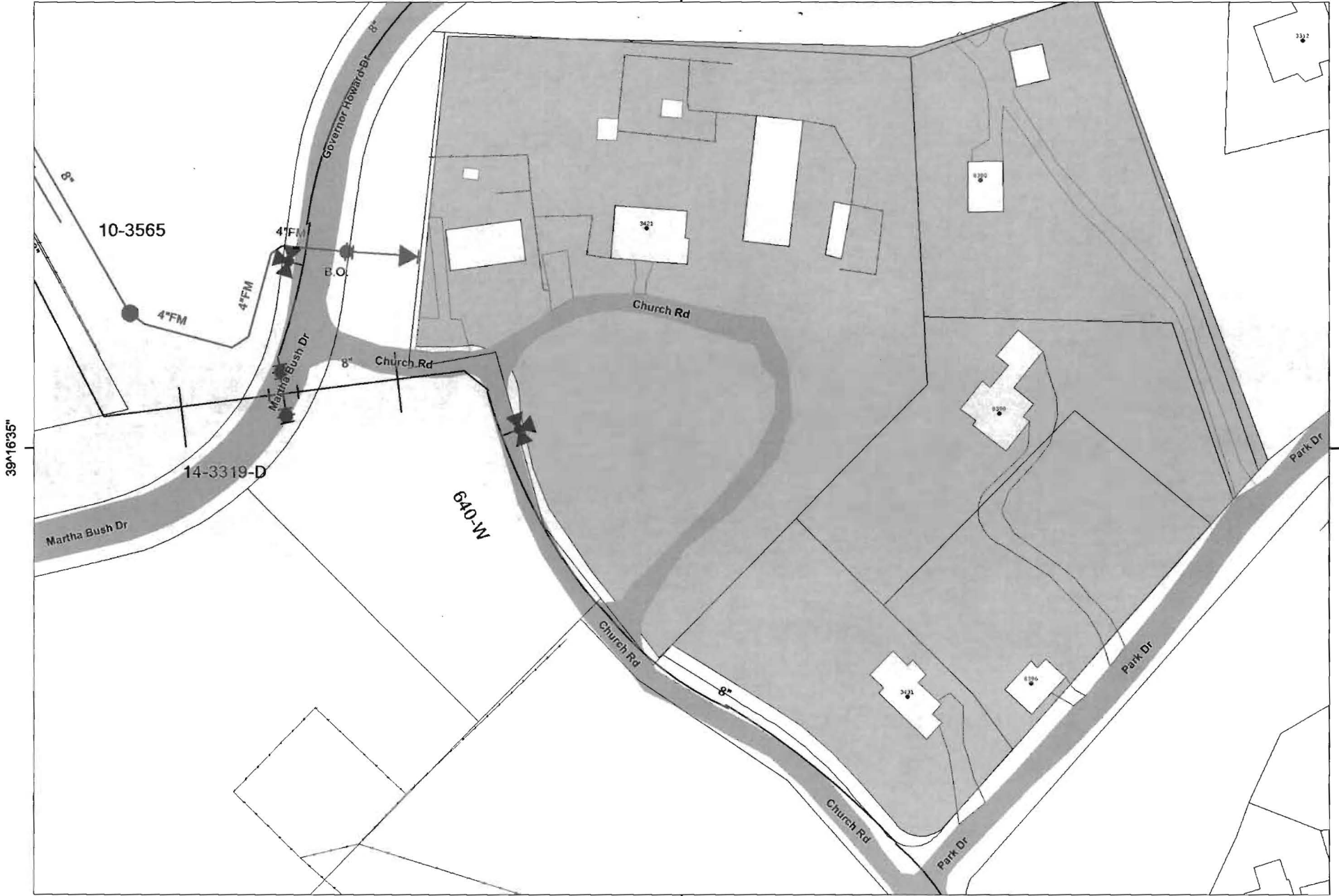

39°16'35"

39°16'35"

Disclaimer: Howard County, Maryland assumes no responsibility for the accuracy of this report or the information contained herein or derived therefrom. The user assumes all risks and liabilities whatsoever resulting from or arising out of the use of this information. There are no oral agreements or warranties relating to the use of this report.

-76°48'4."

