

WR-W-4  
4-66

State Office Building  
ANNAPOLIS, MARYLAND 21401

RECEIVED  
STATE OF MARYLAND

DEPARTMENT OF HEALTH  
WATER RESOURCES

THIS REPORT  
MUST BE SUBMITTED  
WITHIN 30 DAYS  
AFTER COMPLETION  
OF THE WELL.

WELL COMPLETION REPORT

Lot 9D Sec. 3 WELL DESCRIPTION A 09024

Permit Number Bo 67 w 148  
Owner Clayton E. Miller  
Address Jessup Md.  
Subdivision Buratwood  
Section \_\_\_\_\_ Lot 9 d

WELL LOG  
State the kind of formations penetrated, their color, their depth, their thickness, and their water-bearing.

CASING AND SCREEN RECORD  
State the kind and size and position of casing, liner, shoe, screen, and other accessories (if no casing used, give diameter of well).

45 ft of sand and 18 ft of sand rock

FEET  
from 0 to 45

DIAM. (Inches)  
5/5/8

FEET  
from 0 to 45

PUMPING TEST  
Hours Pumped 2  
Type of Pump Used Sand  
Pumping Rate 8  
Gallons per Minute 10

WATER LEVEL  
(Distance from land surface to water)  
Before Pumping 25 Ft.  
When Pumping 30 Ft.

APPEARANCE OF WATER  
Clear  Cloudy \_\_\_\_\_  
Taste ok  
Odor non

Height of Casing Above Land  
Surface 1 ft Ft.

PUMP INSTALLED  
Type non  
Capacity  
Gallons per Minute \_\_\_\_\_  
Gallons per Hour \_\_\_\_\_  
Pump Column Length \_\_\_\_\_ Ft.

LOCATION OF WELL ON LOT  
Show permanent structures such as building(s), septic tank, and/or other landmarks and indicate not less than 2 distances (measurements) to well.

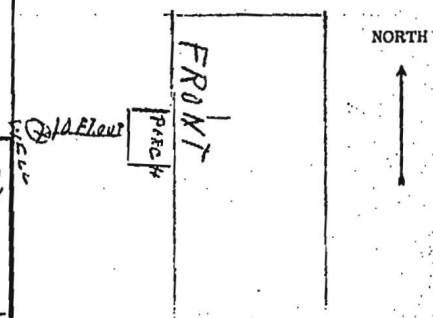

DATE WELL WAS COMPLETED

Oct, 21, 1966

I hereby affirm that this report contains no willful misrepresentations or falsifications and that information given in this report is true, accurate and complete to the best of my knowledge and belief.

Arthur P. Edmondson, Well Driller

Well Driller License No.: 317

HEALTH