

WR-W-4  
4-66

State Office Building  
ANNAPOLIS, MARYLAND 21401

RECEIVED  
STATE OF MARYLAND  
DEPARTMENT OF  
WATER RESOURCES

THIS REPORT  
MUST BE SUBMITTED  
WITHIN 30 DAYS  
AFTER COMPLETION  
OF THE WELL

WELL COMPLETION REPORT

A09144

WELL DESCRIPTION

WELL LOG

State the kind of formations penetrated, their color, their depth, their thickness, and if water-bearing

CASING AND SCREEN RECORD

State the kind and size and position of casing, liner, shoe, screen, and other accessories (if no casing used, give diameter of well).

FEET from ___ to ___	DIAM. (inches)	FEET from ___ to ___
		Sand
		60 ft
		Gravel Rock
		well 9 1/2 ft

H6-68-w-26

Permit Number H68 W 26  
Owner M. J. Connor  
Address Dayton  
Subdivision Belairwood  
Section Lot 16

PUMPING TEST

Hours Pumped 1  
Type of Pump Used Bayler  
Pumping Rate 7  
Gallons per Minute 7

WATER LEVEL

(Distance from land surface to water)  
Before Pumping 60 Ft.  
When Pumping 75 Ft.

APPEARANCE OF WATER

Clear Partly Cloudy \_\_\_\_\_  
Taste None  
Odor None

Height of Casing Above Land  
Surface 2 Ft.

PUMP INSTALLED

Type \_\_\_\_\_  
Capacity \_\_\_\_\_  
Gallons per Minute \_\_\_\_\_  
Gallons per Hour \_\_\_\_\_  
Pump Column Length \_\_\_\_\_ Ft.

LOCATION OF WELL ON LOT

Show permanent structures such as buildings, septic tank, and/or other landmarks and indicate not less than 2 distances (measurements) to well.

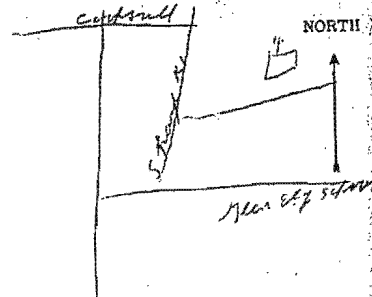

DATE WELL WAS COMPLETED

Dec 2 1967

I hereby affirm that this report contains no willful misrepresentations or falsifications and that information given in this report is true, accurate and complete to the best of my knowledge and belief.

Devery Brown, Well Driller

Well Driller License No.: 113

HEALTH