

Building Address: 14835 Cemetery Rd
Cocksville, MD 21723

Suite/Apt. # _____ SDP/WP/BA #: _____

Census Tract: _____ Subdivision: _____

Section: _____ Area: _____ Lot: _____

Tax Map: _____ Parcel: _____ Grid: _____

Zoning: _____ Map Coordinates: _____ Lot Size: 1 acre

Existing Use: SFD

Proposed Use: Deck

Estimated Construction Cost: \$ 3,000

Description of Work: Deck 13' x 27' with steps

Occupant or Tenant: _____

Was tenant space previously occupied? Yes No

Contact Name: _____

Address: _____

City: _____ State: _____ Zip Code: _____

Phone: _____ Fax: _____

Email: _____

BUILDING DESCRIPTION - COMMERCIAL	
Building Characteristics	Utilities
Height: <u>10'</u>	<u>Water Supply</u>
No. of stories: _____	<input type="checkbox"/> Public
Gross area, sq. ft./floor: _____	<input type="checkbox"/> Private
	<u>Sewage Disposal</u>
Area of construction (sq. ft.): _____	<input type="checkbox"/> Public
<u>351</u>	<input type="checkbox"/> Private
Use group: _____	Electric: <input type="checkbox"/> Yes <input type="checkbox"/> No
	Gas: <input type="checkbox"/> Yes <input type="checkbox"/> No
<u>Construction type:</u>	<u>Heating System</u>
<input type="checkbox"/> Reinforced Concrete	<input type="checkbox"/> Electric <input type="checkbox"/> Oil
<input type="checkbox"/> Structural Steel	<input type="checkbox"/> Natural Gas <input type="checkbox"/> Propane Gas
<input type="checkbox"/> Masonry	<u>Sprinkler System:</u>
<input checked="" type="checkbox"/> Wood Frame	<input type="checkbox"/> N/A
<input type="checkbox"/> State Certified Modular	<input type="checkbox"/> Full
<input checked="" type="checkbox"/> <u>Roadside Tree Project Permit</u>	<input type="checkbox"/> Partial
<input type="checkbox"/> Yes <input checked="" type="checkbox"/> No	<input type="checkbox"/> Other Suppression
<u>Roadside Tree Project Permit #</u>	No. of Heads: _____

Property Owner's Name: MARION SARHY

Address: 14835 Cemetery Rd

City: Cocksville State: MD Zip Code: 21723

Home Phone: 410 3538 2981 Work Phone: _____

Applicant's Name & Mailing Address, (If other than stated herein): _____

Phone: _____ Fax: _____

Email: _____

Contractor Company: Owner

Contact Person: _____

Address: _____

City: _____ State: _____ Zip Code: _____

License No. : _____

Phone: _____ Fax: _____

Email: _____

Engineer/Architect Company: _____

Responsible Design Prof.: _____

Address: _____

City: _____ State: _____ Zip Code: _____

Phone: _____ Fax: _____

Email: _____

BUILDING DESCRIPTION - RESIDENTIAL	
Building Characteristics	Utilities
<input type="checkbox"/> SF Dwelling <input type="checkbox"/> SF Townhouse	<u>Water Supply</u>
<u>Depth</u> <u>Width</u>	<input type="checkbox"/> Public
1 st floor: _____	<input checked="" type="checkbox"/> Private
2 nd floor: _____	<u>Sewage Disposal</u>
Basement: _____	<input type="checkbox"/> Public
<input type="checkbox"/> Finished Basement	<input checked="" type="checkbox"/> Private
<input type="checkbox"/> Unfinished Basement	Electric: <input checked="" type="checkbox"/> Yes <input type="checkbox"/> No
<input type="checkbox"/> Crawl Space	Gas: <input type="checkbox"/> Yes <input type="checkbox"/> No
<input type="checkbox"/> Slab on Grade	<u>Heating System</u>
No. of Bedrooms: _____	<input type="checkbox"/> Electric
<u>Multi-family Dwelling</u>	<input type="checkbox"/> Oil
No. of efficiency units: _____	<input type="checkbox"/> Natural Gas
No. of 1 BR units: _____	<input type="checkbox"/> Propane Gas
No. of 2 BR units: _____	
No. of 3 BR units: _____	
Other Structure: _____	
Dimensions: _____	
Footings: _____	<input checked="" type="checkbox"/> <u>Roadside Tree Project Permit</u>
Roof: _____	<input type="checkbox"/> Yes <input type="checkbox"/> No
<input type="checkbox"/> State Certified Modular	<u>Roadside Tree Project Permit #</u>
<input type="checkbox"/> Manufactured Home	

THE UNDERSIGNED HEREBY CERTIFIES AND AGREES AS FOLLOWS: (1) THAT HE/SHE IS AUTHORIZED TO MAKE THIS APPLICATION; (2) THAT THE INFORMATION IS CORRECT; (3) THAT HE/SHE WILL COMPLY WITH ALL REGULATIONS OF HOWARD COUNTY WHICH ARE APPLICABLE THERETO; (4) THAT HE/SHE WILL PERFORM NO WORK ON THE ABOVE REFERENCED PROPERTY NOT SPECIFICALLY DESCRIBED IN THIS APPLICATION; (5) THAT HE/SHE GRANTS COUNTY OFFICIALS THE RIGHT TO ENTER ONTO THIS PROPERTY FOR THE PURPOSE OF INSPECTING THE WORK PERMITTED AND POSTING NOTICES.

Applicant's Signature: [Signature]

Email Address: marion_sarhy@gmail.com

Title/Company: _____

Print Name: MARION SARHY

Date: 8/18/11

Checks Payable to: DIRECTOR OF FINANCE OF HOWARD COUNTY

PLEASE WRITE NEATLY & LEGIBLY

-FOR OFFICE USE ONLY-

AGENCY	DATE	SIGNATURE OF APPROVAL
State Highways		
Building Officials		
PSZA (Zoning)		
PSZA (Engineering)		
Health	<u>8/18/11</u>	<u>[Signature]</u>
Fire Protection		

DPZ SETBACK INFORMATION

Front: _____

Rear: _____

Side: _____

Side St.: _____

All minimum setbacks met? Yes No

Is Entrance Permit Required? Yes No

Historic District? Yes No

Lot Coverage for New Town Zone: _____

SDP/Red-line approval date: _____

Filing Fee	\$
Permit Fee	\$
Tech Fee	\$
Excise Tax	\$
PSFS	\$
Guaranty Fund	\$
Add'l per Fee	\$
Total Fees	\$
Sub- Total Paid	\$
Balance Due	\$



CEMETERY ROAD

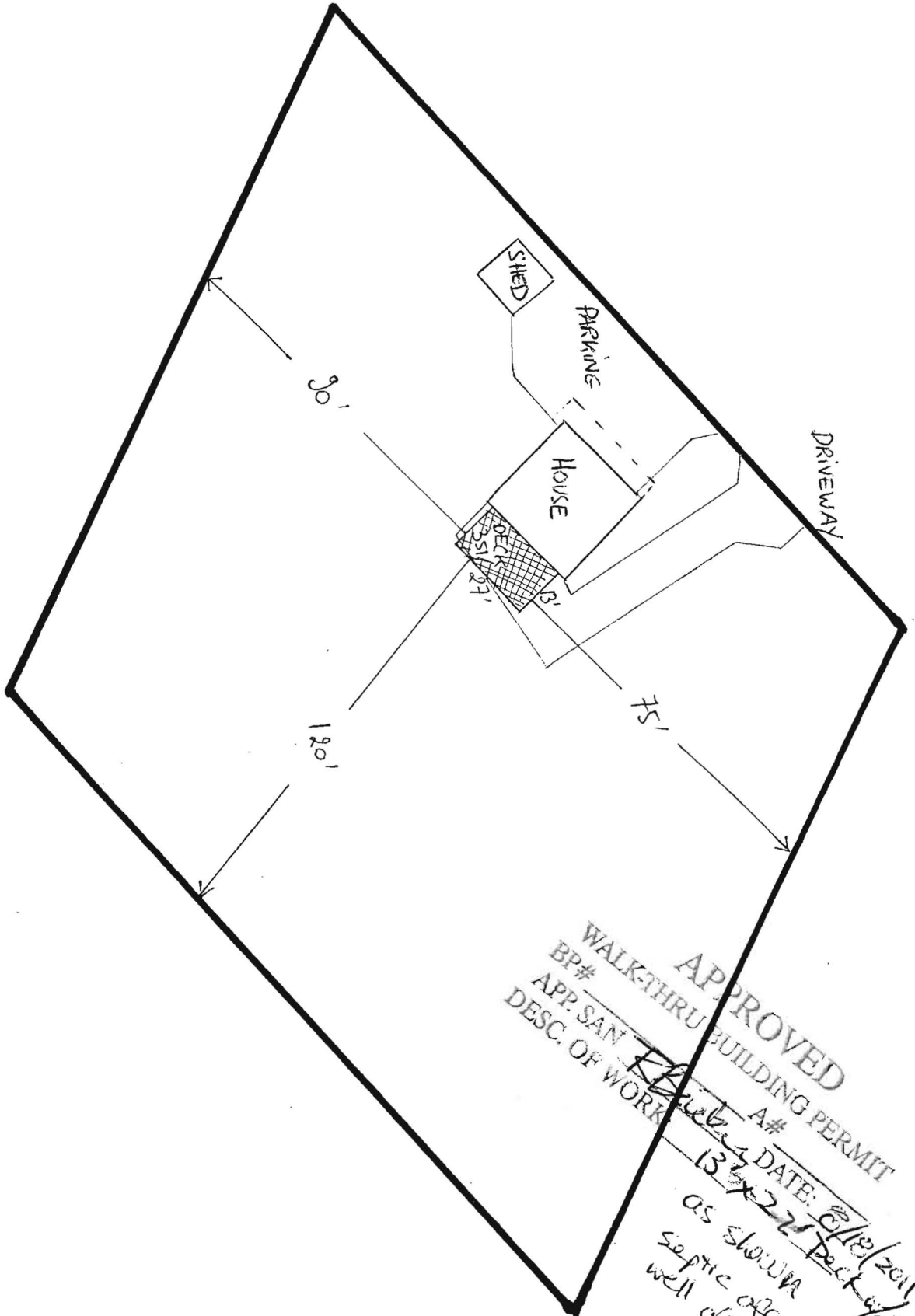

MARION SARNY
 14835 CEMETERY RD
 COOKSVILLE, MO 63012

APPROVED
 WALK-THRU BUILDING PERMIT
 BP# 137422 A# 137422
 APP. SAN 137422 DATE: 6/12/2011
 DESC. OF WORK: 13' x 22' Deck w/ steps
as shown
septic on-site
well on site

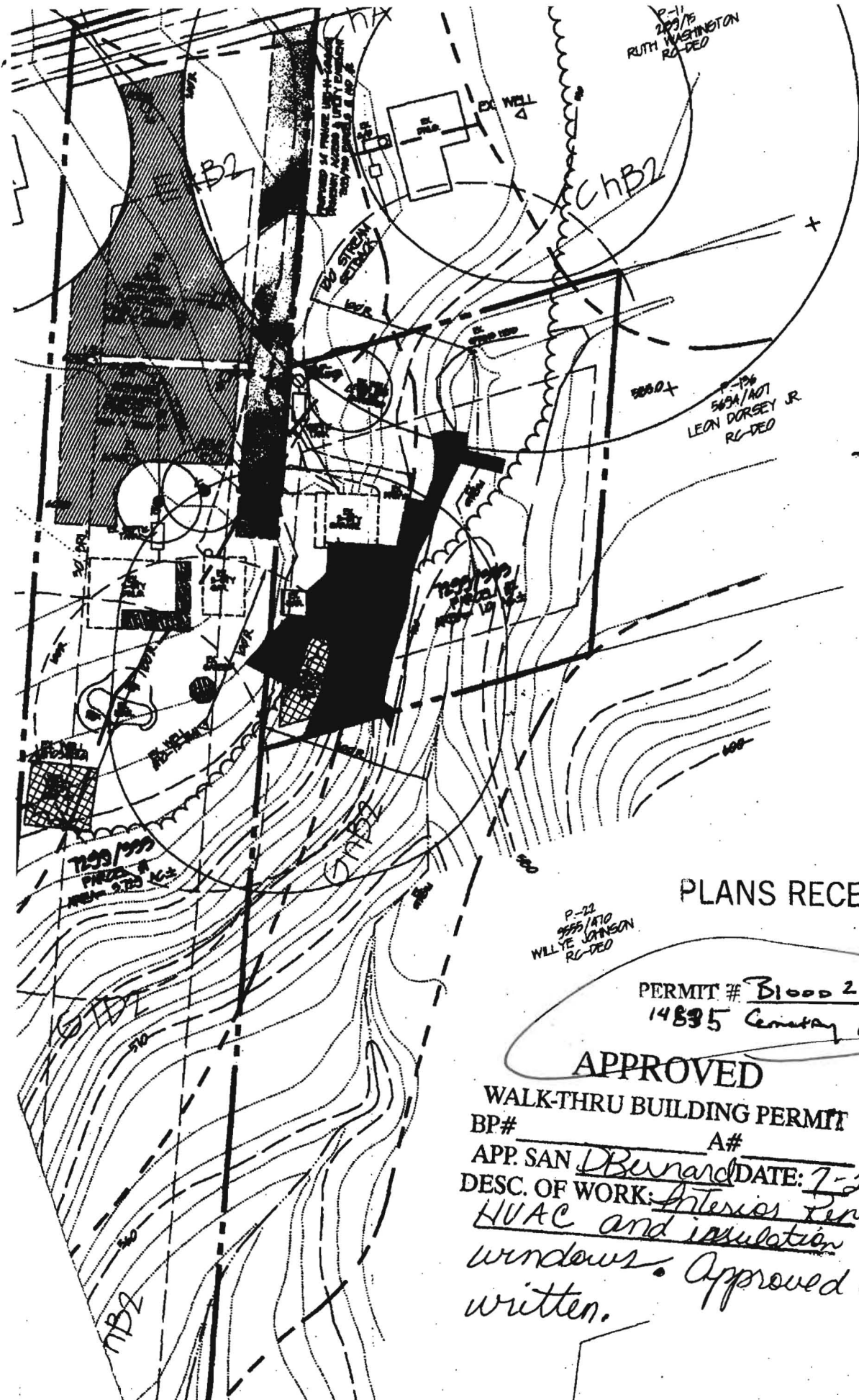

PLANS RECEIVED

P-22
985/170
WILLYE JOHNSON
RC-DEO

PERMIT # B1000 2228
14835 Cemetery Rd

APPROVED

WALK-THRU BUILDING PERMIT

BP# _____ A# _____
 APP. SAN DBernard DATE: 7-22-10
 DESC. OF WORK: Arteries Renovation
HVAC and insulation of only!
windows. Approved as
written.