

*Hickory C.O.*

*Approved 4/26/78 T.S.O.*

*4/26/78*  
*4/25/78*

# PERMIT

SEWAGE DISPOSAL SYSTEM

MARYLAND STATE DEPARTMENT OF HEALTH\*

HOWARD COUNTY

05-379636

ELLICOTT CITY

DISTRICT 5th

DATE 4/13/78

P 27818  
A 24197

**INDEXED**

Jim Brittingham IS PERMITTED TO INSTALL X ALTER

ADDRESS Ellicott City, Md. PHONE \_\_\_\_\_

SUBDIVISION Chris Mar Estates ROAD 13451 Chris Mar Court LOT 6

PROPERTY OWNER John Finnegan *Clyde A. Via*

ADDRESS \_\_\_\_\_

SPECIFICATIONS 4 bedrooms

SEPTIC TANK CAPACITY 1260 GALLONS

DRAIN FIELD \_\_\_\_\_ DEPTH \_\_\_\_\_ FEET, BOTTOM AREA \_\_\_\_\_ SQ. FT.

DEEP TRENCH \_\_\_\_\_ DEPTH \_\_\_\_\_ FEET, BOTTOM AREA \_\_\_\_\_ SQ. FT.

SEEPAGE PITS \_\_\_\_\_ ABSORBENT SIDE-WALL AREA \_\_\_\_\_ SQ. FT.

INLET PIPE \_\_\_\_\_ FT. BELOW ORIGINAL GRADE, MAXIMUM DEPTH \_\_\_\_\_ FT. BELOW ORIGINAL GRADE

EFFECTIVE DEPTH AT \_\_\_\_\_ FT. BELOW ORIGINAL GRADE.

LOCATE DISPOSAL AREA \_\_\_\_\_ FT. FROM \_\_\_\_\_ LOT LINE AND \_\_\_\_\_ FT. FROM \_\_\_\_\_ LOT LINE AS SEEN WHEN FACING LOT FROM

BLDG. PERMIT SIGNED  
AND RETURNED 4/13/78  
*Serial # 58845*  
*In ground pool*

DRY WELL & TRENCH SYSTEM - to have 135 sq. ft. effective absorbent sidewall area per bedroom to begin below the first 3 ft. of non-porous soil. Maximum depth permitted for dry well or trench is 11 ft. below original grade. Place the dry well 55 ft. from the right sideline and 170 ft. from the rear property line, as seen when facing the property from Chris Mar Court. Start the trench after a 5 ft. earth buffer with the dry well and proceed to dig it on level ground, the necessary distance. NOTE: If trenches only are used, there must be two trenches, connected in series containing at least 200 sq. ft. effective sidewall absorption area per bedroom.

*If trenches are used use a 400 a distribution box; no series.*

PLANS APPROVED BY Frank Skinner DATE 8/1/77

COVER NO WORK UNTIL INSPECTED AND APPROVED.

NEITHER THE HOWARD COUNTY COUNCIL NOR THE HEALTH DEPARTMENT IS RESPONSIBLE FOR THE SUCCESSFUL OPERATION OF ANY SYSTEM.

NOTE IF TRENCH IS USED CALL FOR INSPECTION BEFORE PLACING GRAVEL IN TRENCH.

NOTE: NO DRY WELL SHALL EXCEED 15 FOOT IN DIAMETER.

NOTE: ALL PIPE FROM HOUSE TO DISPOSAL AREA MUST BE CAST IRON.

PERMIT VOID AFTER THREE YEARS.

NOTE INSTALL STAND PIPE ON SEPTIC TANK AND DRY WELL. STAND PIPES MUST BE 6 INCHES IN DIAMETER. CAST IRON, CONCRETE OR TERRA COTTA ACCEPTED.

**\*INSTALLER IS RESPONSIBLE FOR OBTAINING FINAL APPROVAL ON THIS PERMIT.**

BLDG. PERMIT SIGNED  
AND RETURNED 8/17/77  
*Serial # 13728*  
*Addition*

*A 24197*

13451  
Chris Mar Ct.  
Luis Baldevana  
301-617-0808

**MESSAGE**

Message For Javier

from Sarah (Holo. Health Dept) 10/19/07

number (410) 313-4261 time 3:12 AM

message 13451 Chris Mar Ct. is OK!  
You can do the walk thru.

taken by [Signature]

best call back time \_\_\_\_\_ date \_\_\_\_\_ WS

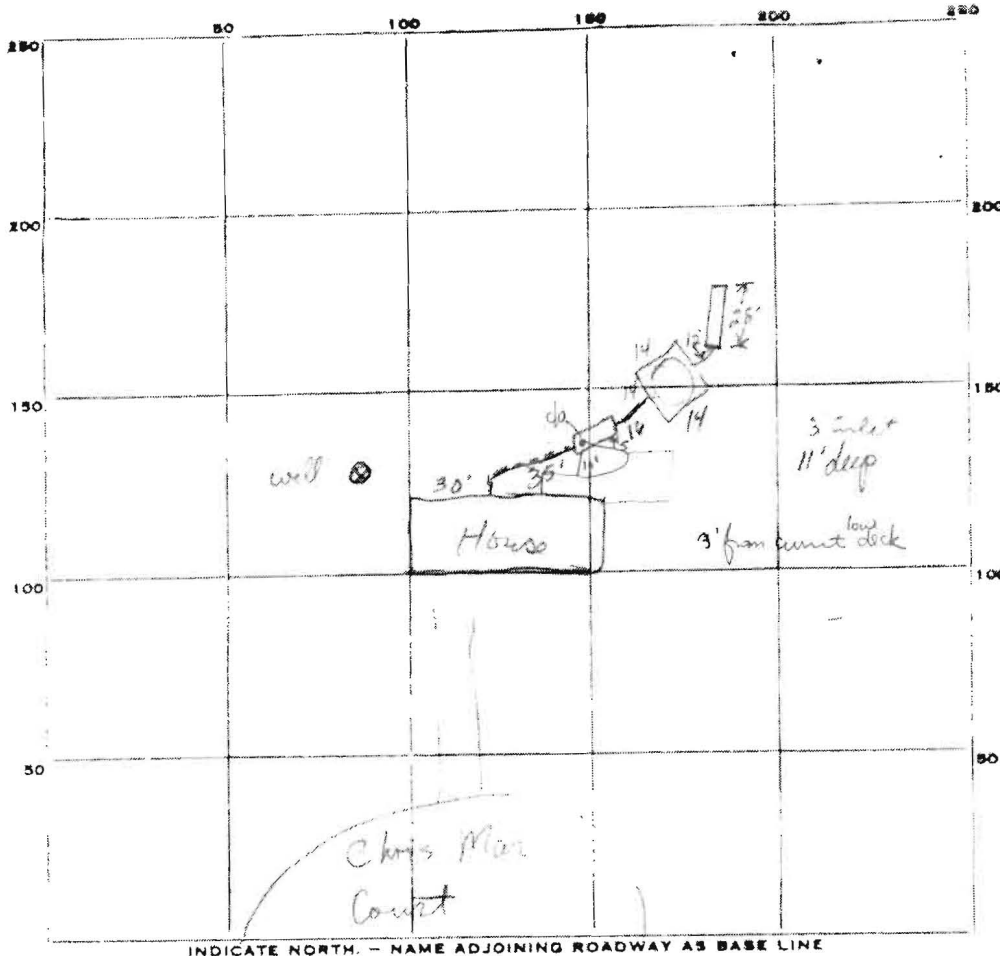

PERMIT CARD

SEPTIC TANK, LEVEL 1250

CLEANOUTS

DISTRIBUTION BOX, LEVEL N/A

TILE FIELD, DEPTH 11 FT. TRENCH WIDTH 2 FT.

GRAVEL DEPTH 8 IN. TOTAL LENGTH 28' FT.

NUMBER OF TRENCHES 1 TOTAL BOTTOM AREA 1/2 sq. ft.

SEEPAGE PITS, INSIDE DIAMETER 56 FT. DEPTH BELOW INLET 8 FT.

ABSORBENT AREA 692 SQ. FT. 4/24/78 750. OK to add stone to trench

REMARKS

4/25/78 (P.C.O. - Not ready - no demand, pipes not connected)  
C B D

DATE SYSTEM APPROVED

4/26/78

INSPECTOR

T.S. Ogler

SITE INSPECTION SHEET

OWNER: \_\_\_\_\_ PHONE #: \_\_\_\_\_

ADDRESS: 13451 Chris Mar Ct CONTRACTOR: \_\_\_\_\_

WELL TAG #: \_\_\_\_\_

SUBDIVISION: \_\_\_\_\_ LOT: \_\_\_\_\_ COUNTY #: \_\_\_\_\_

PROPOSAL: verify tank setback to new deck.

LOCATION DIAGRAM

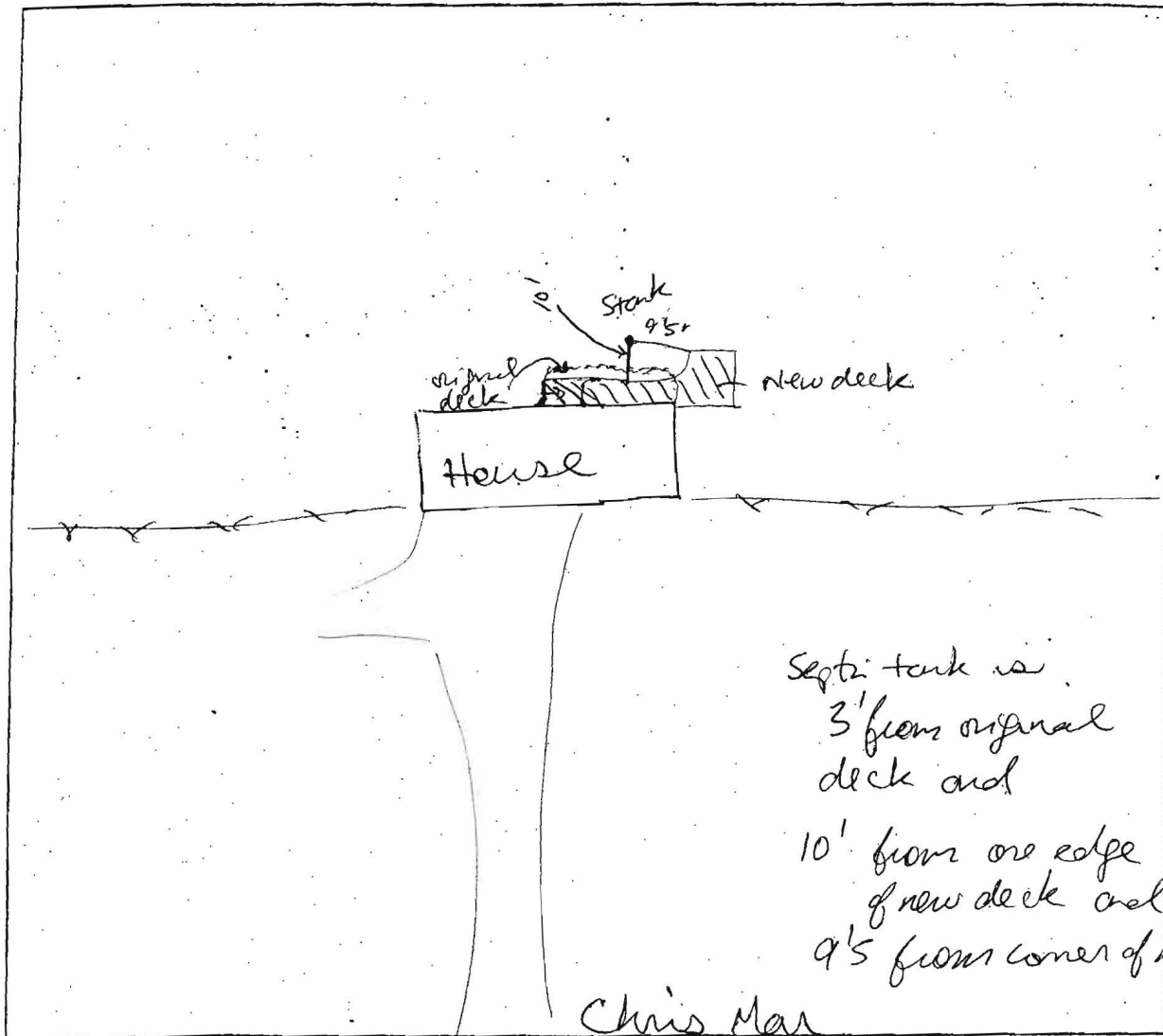

COMMENTS: New deck meets setback from tank.

6/19/07

JK