

C1 16550

SEQUENCE NO. (MDE USE ONLY)

STATE OF MARYLAND WELL COMPLETION REPORT

THIS REPORT MUST BE SUBMITTED WITHIN 45 DAYS AFTER WELL IS COMPLETED.

1 2 3 6 (THIS NUMBER IS TO BE PUNCHED IN COLS. 3-6 ON ALL CARDS)

COUNTY NUMBER

ST/CO USE ONLY

DATE WELL COMPLETED

Depth of Well

PERMIT NO. FROM "PERMIT TO DRILL WELL"

DATE RECEIVED MM DD YY

DATE WELL COMPLETED MM DD YY

DEPTH OF WELL 22 280 26

PERMIT NO. 40-95-2429

OWNER Walsh Elizabeth WELL SITE ADDRESS 3574 Church Rd TOWN Ellicott City SUBDIVISION SECTION LOT

WELL LOG

Not required for driven wells

STATE THE KIND OF FORMATIONS PENETRATED, THEIR COLOR, DEPTH, THICKNESS AND IF WATER BEARING

Table with columns: DESCRIPTION, FEET (FROM, TO), check if water bearing. Includes entries for Brown Shale, Gray Sandstone, Borehole #2, Borehole #3, Borehole #4.

GROUTING RECORD

WELL HAS BEEN GROUTED (Y/N) TYPE OF GROUTING MATERIAL (Cement, Bentonite Clay) NO. OF BAGS, NO. OF POUNDS, GALLONS OF WATER, DEPTH OF GROUT SEAL

CASING RECORD

MAIN CASING TYPE, Nominal diameter top (main) casing, Total depth of main casing. Includes casing type codes (ST, CO, PL, OT).

OTHER CASING (if used)

Table for OTHER CASING with columns: diameter inch, depth (feet) from, to.

SCREEN RECORD

screen type or open hole (ST, BR, HO, PL, OT) DEPTH (nearest ft.)

Table for SCREEN RECORD with columns: E, A, C, H, S, R, E, N and depth values.

GRAVEL PACK IF WELL DRILLED WAS FLOWING WELL INSERT F IN BOX 88

MDE USE ONLY (NOT TO BE FILLED IN BY DRILLER) T (E.R.O.S.) W Q

TELESCOPE CASING LOG INDICATOR OTHER DATA

C3

PUMPING TEST

HOURS PUMPED, PUMPING RATE, METHOD USED TO MEASURE PUMPING RATE, WATER LEVEL, BEFORE PUMPING, WHEN PUMPING, TYPE OF PUMP USED (air, piston, turbine, centrifugal, rotary, other, jet, submersible).

PUMP INSTALLED

DRILLER INSTALLED PUMP (YES/NO), IF DRILLER INSTALLS PUMP, THIS SECTION MUST BE COMPLETED FOR ALL WELLS. TYPE OF PUMP INSTALLED, PLACE (A,C,J,P,R,S,T,O) IN BOX 29. CAPACITY: GALLONS PER MINUTE, PUMP HORSE POWER, PUMP COLUMN LENGTH, CASING HEIGHT.

LATITUDE 39.163900 LONGITUDE 77.006111 (DEFAULT COORD. WGS 84)

NOTES: Lat: 39.375278 Long: 77.006944 Lat: 39.378056 Long: 77.006944 Lat: 39.377222 Long: 77.005000

NUMBER OF UNSUCCESSFUL WELLS: 0

WELL HYDROFRACTURED (Y/N)

CIRCLE APPROPRIATE LETTER A WELL WAS ABANDONED AND SEALED WHEN THIS WELL WAS COMPLETED E ELECTRIC LOG OBTAINED P TEST WELL CONVERTED TO PRODUCTION WELL

I HEREBY CERTIFY THAT THIS WELL HAS BEEN CONSTRUCTED IN ACCORDANCE WITH COMAR 26.04.04 "WELL CONSTRUCTION" AND IN CONFORMANCE WITH ALL CONDITIONS STATED IN THE ABOVE CAPTIONED PERMIT...

DRILLERS LIC. NO. MSD 028 DRILLERS SIGNATURE

LIC. NO. MSD 028

SITE SUPERVISOR (sign. of driller or journeyman responsible for sitework if different from permittee)

B 1 09951

SEQUENCE NO. (MDE USE ONLY)

STATE OF MARYLAND APPLICATION FOR PERMIT TO DRILL WELL

STATE PERMIT NUMBER

538102 please type

Ho-95-2429 fill in this form completely

Date Received (APA) 10-22-12

OWNER INFORMATION

Walsh Elizabeth 3574 Church Rd Ellicott City MD 21043

B 3

LOCATION OF WELL

Howard 8 COUNTY 21 23 SUBDIVISION 42 SECTION 44 46 LOT 48 50 52 NEAREST TOWN 71

DRILLER INFORMATION

Michael J Rohler M S D 028 Eichelbergers Inc 175 S. Wilson Ln York PA 17406 Michael Rohler 10-19-12

B 4

SOURCES OF DRILLING WATER

1 Approved

Church Rd 11 STREET ADDRESS 30 ON WHICH SIDE OF ROAD (CIRCLE APPROPRIATE BOX) NORTH WEST EAST SOUTH 34 55 37 DISTANCE FROM ROAD FT 38 39 ENTER FT OR MI TAX MAP: BLK: PARCEL

B 2

WELL INFORMATION

APPROX. PUMPING RATE (GAL. PER MIN.) 8 12 AVERAGE DAILY QUANTITY NEEDED (GAL. PER DAY) 14 20

NOT TO BE FILLED IN BY DRILLER HEALTH DEPARTMENT APPROVAL

- USE FOR WATER (CIRCLE APPROPRIATE BOX) D DOMESTIC POTABLE SUPPLY & RESIDENTIAL IRRIGATION F FARMING (LIVESTOCK WATERING & AGRICULTURAL IRRIGATION) I INDUSTRIAL, COMMERCIAL, DEWATERING P PUBLIC WATER SUPPLY WELL T TEST, OBSERVATION, MONITORING O OPEN LOOP GEOTHERMAL C CLOSED LOOP GEOTHERMAL

Howard 13 A18063 COUNTY NAME COUNTY NO. STATE SIGNATURE INSERT S DATE ISSUED 11/2/12 CO SIGNATURE EXP. DATE 11/2/13

APPROXIMATE DEPTH OF WELL 4-280 FEET APPROXIMATE DIAMETER OF WELL 6 NEAREST INCH

PROPOSED LOCATION OF WELL ON LOT SHOW PERMANENT STRUCTURES SUCH AS BUILDINGS, SEPTIC SYSTEM, ROADS AND/OR LANDMARKS AND INDICATE NOT LESS THAN TWO DISTANCE MEASUREMENTS TO WELL

METHOD OF DRILLING (circle one)

BORED (or Augered) JETTED Jetted & DRIVEN AIR-ROTary AIR-PERCussion ROTARY (Hydraulic Rotary) CABLE REVERSE-ROTary DRIVE-POINT

REPLACEMENT OR DEEPEMED WELLS (CIRCLE APPROPRIATE BOX)

- N THIS WELL WILL NOT REPLACE AN EXISTING WELL Y THIS WELL WILL REPLACE A WELL THAT WILL BE ABANDONED AND SEALED S THIS WELL WILL REPLACE A WELL THAT WILL BE USED AS A STANDBY-CONTACT LOCAL APPROVING AUTHORITY FOR POLICY ON STANDBY WELLS D THIS WELL WILL DEEPM AN EXISTING WELL

PERMIT NUMBER OF WELL TO BE REPLACED OR DEEPEMED (IF AVAILABLE)

Not to be filled in by driller (MDE OR COUNTY USE ONLY)

APPROX. PERMIT NUMBER G PERMIT No. Ho-95-2429

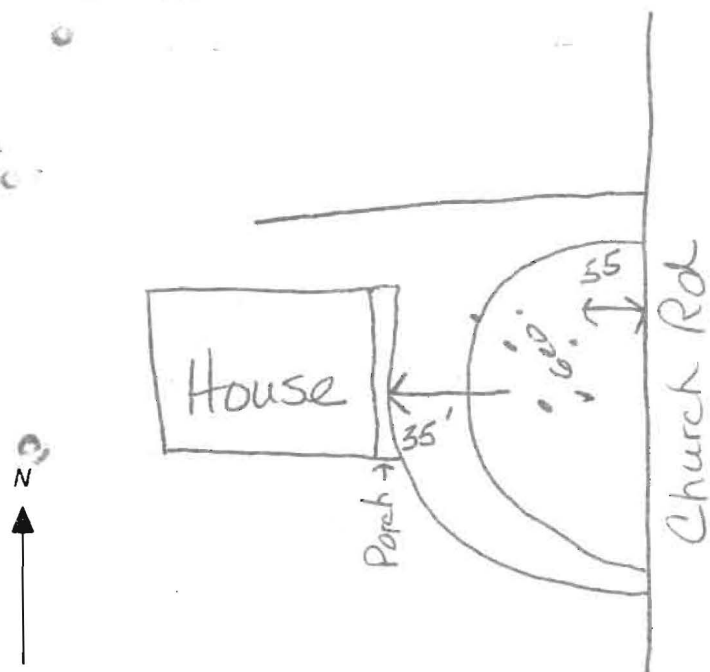

SPECIAL CONDITIONS Grout bores bottom to top.



Bureau of Environmental Health
7178 Columbia Gateway Drive, Columbia, MD 21046-2147
Main: 410-313-2640 | Fax: 410-313-2648
TDD 410-313-2323 | Toll Free 1-866-313-6300
www.hchealth.org
Facebook: www.facebook.com/hocohealth
Twitter: HowardCoHealthDep

Maura J. Rossman, M.D., Acting Health Officer

IMPORTANT

MEMORANDUM

TO: Eichelberger's Inc.
Attn: Michael J. Kohler, MSD 028
FILE

FROM: Kevin M. Wolf, R.S., R.E.H.S. *KMW*
Well and Septic Program
Groundwater Mgmt. Sec.

DATE: October 25th, 2012

RE: Geothermal Wells
3574 Church Road, Walsh Property

**sent
via mail
on 10/25/12*

The above well permit has been placed on hold. The following comments apply to the above aforementioned geo well application. Please review and resubmit:

A complete Site Plan must be submitted with all well permits. The plan must be clear and legible, and show indications of nominal distances from features on the property to the proposed geobore locations. These features include, but not limited to, wells, septic system components, house, right-of-ways, and property lines.

Site inspections occur frequently on most of the well permit applications submitted to our office for review. Please make sure the proposed geo bore sites are clearly marked in the field (i.e. stakes, flags, markers, etc...)

In conjunction with these statements and current regulations, geothermal bores must be separated by 30' to any potable wells and 50' to any adjacent septic's if geobores are up-gradient and 100' separation if down-gradient. Bores must also be 15' removed from foundations of structures and right-of-way's and 10' removed from all property lines.

Any questions please call me at 410-313-2645 or email kwolf@howardcountymd.gov

KMW
Cc: file