

APV _____

private drive

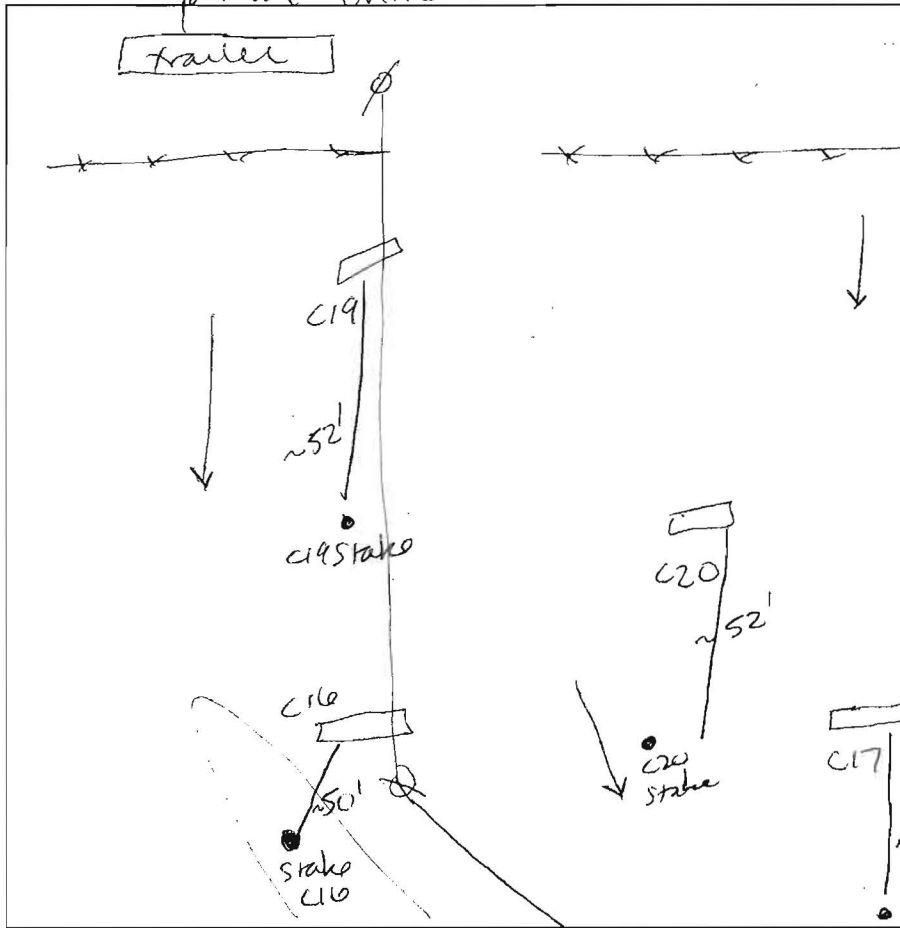

C17
 1' brn & sbk
 dry, hard } coarse chert
 2' red brn
 dense scl
 m
 side wall
 appears
 7' coarse chert
 layer
 7 1/2' pale brn / yellow brn
 med sl
 w/ red yellow list
 d(i) mottles yellow brn
 micaceous moist
 sticky
 13' scrapage

[Empty box]

C16
 1' brn &
 very hard, dry
 sbk
 3' 10% stony
 brn
 sl cw
 hard, dry
 2' 6" dk gray
 med sl
 micaceous
 saprolite
 trap
 rock

C19
 2' 1' dk brn &
 sbk
 dk brn
 med sl
 cemented
 micaceous
 saprolite
 12' 8"

DATE	TEST #	DEPTH	START	BREAK 1" DROP	STOP 2" DROP	TIME OF 2ND INCH	P/F/H
8/14/08	C16	3' 8" / 13	12:58	1:04	1:18	14	P
	C20	5' 8" / 127	1:28	1:52	No to first inch		
	"	6' 8" / #	1:59	2:32	only to first inch		F
	C17			deep clay / wet no sidewall	season visual		F
	C19	7' 12" / 8	2:31	3:00	No to 1st inch		F
	C18		Not tested				

C20
 1' dk brn &
 hard (dry)
 sbk
 5' brn red
 scl m
 hard (dry)
 5' 5" weathered
 granite
 12' 7" dk gray
 med. heavy sl
 cw
 saprolite
 very micaceous

REMARKS holes shifted ~50' from original stake due to landscape position
 SANITARIAN SS BACKHOE Fulton OTHERS
 TEST HOLES USED IN SDA _____ AVG. PERC TIME _____ SQ. FT/BR _____
 TRENCH WIDTH _____ INLET DEPTH _____ MAX. BOT DEPTH _____ EFFECTIVE SW _____

AVP _____

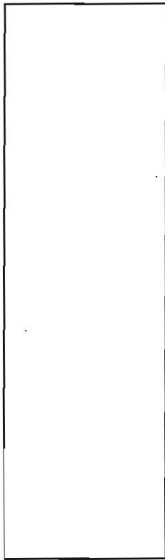
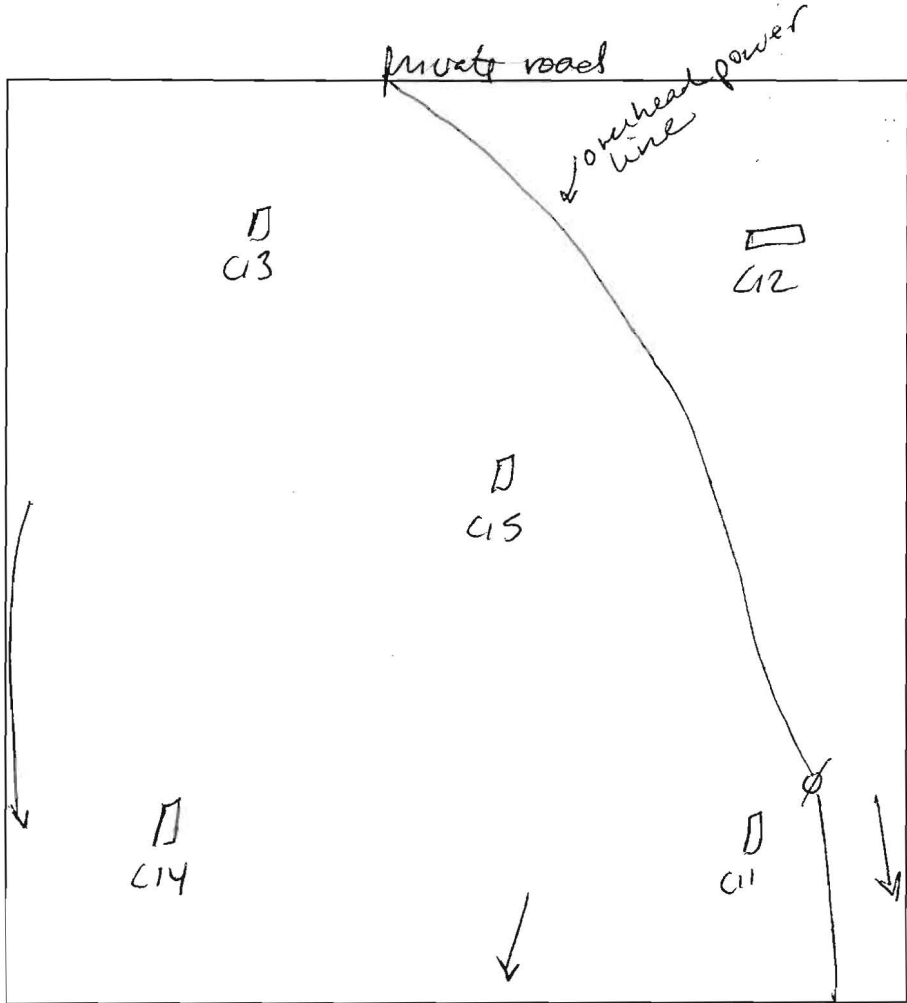

C15
 brn very dry hard. s/sr sbk
 1' st. brn dense (dry) very hard s/sr
 10% chert
 3' brn heavy s/sr sg micaceous dense side wall
 5'5' brown med s/sr sg micaceous mica flakes cemented (cw)
 trace rock

C14
 1' brn & very dry sbk
 2' brn
 2 1/2' weathered quartz frags heavy. 10% chert decomposing into coarse s/sr
 3' brn med s/sr sg micaceous mica flakes
 8' weathered quartz patch.
 ~10% chert coarse s/sr
 15'

C13
 1' brn & very dry hard sbk
 2'8" brn s/sr dense (dry) weathered quartz 10% chert
 3' brn cw s/sr micaceous
 4'9" brn med s/sr sg micaceous w/ mica flakes trace rock
 13'5"
C12
 1' brn & very dry dense sbk
 2'7" st. brn dense (dry) s/sr
 st. brn/red yellow pl s/sr cemented micaceous
 5'5" st. brn/red yellow s/sr sg micaceous trace rock
 7'5" red yellow s/sr sg micaceous rock
C11
 1' dk brn & sbk very dry 10% chert weathered quartz
 st. brn s/sr dry hard.
 2'-3' st. brn heavy s/sr cw pl
 5'5" yellow brn med s/sr sg trace w/ saponite rock micaceous
 14'8"

DATE	TEST #	DEPTH	START	BREAK 1" DROP	STOP 2" DROP	TIME OF 2ND INCH	P/F/H
8/14/08	C15	4'8" / 15'	9:36	10:07	only #1 in first	—	—
	11	5'7"	10:24	10:36	11:05	29	P
	C14	4' / 15'	9:43	9:52	10:10	18	P
	C13	5'6" / 13'5"	10:14	10:17	10:24	7	P
	C12	5'5" / 15'	10:47	10:54	11:10	16	P
	C11	4'9" / 14'8"	11:17	11:37	no first inch	—	—
		6'	11:50	11:57	12:06	9	P

REMARKS **EAP 5'5" #C15 EAP 3' #C14 EAP 4'9" #C13 EAP 5'5" #C11**
 SANITARIAN SS BACKHOE Fulton OTHERS _____
 TEST HOLES USED IN SDA _____ AVG. PERC TIME _____ SQ. FT/BR _____
 TRENCH WIDTH _____ INLET DEPTH _____ MAX. BOT DEPTH _____ EFFECTIVE SW _____

C7
 1' dk brn s.e.p.
 3' br wk scl micaceous
 4' bm fine scl micaceous
 4' bm red gray bands p mottles fine scl micaceous
 6' bm red dense fine scl bm red/gray br mottles (p) micaceous
 13 1/2' st. brn / gray med. scl micaceous saprolite trace rock

C8
 3' dk brn s.e. not s micaceous
 5' (d) mottles brn red / gray
 6' transition heavy se mottles brn red / gray (d) s
 11' 10" brn / st brn / gray coarse se Saprolite Mn mixed trace rock
 13' H₂O

C10
 1' dk brn l sbk 5% chert
 2' brown se
 4' brn red / yellow dense scl micaceous
 5' bm red fine wk scl micaceous
 ~8' brn red / brn fine se micaceous w/ Mn
 13' 3" red brn / brn se sg micaceous w/ Mn

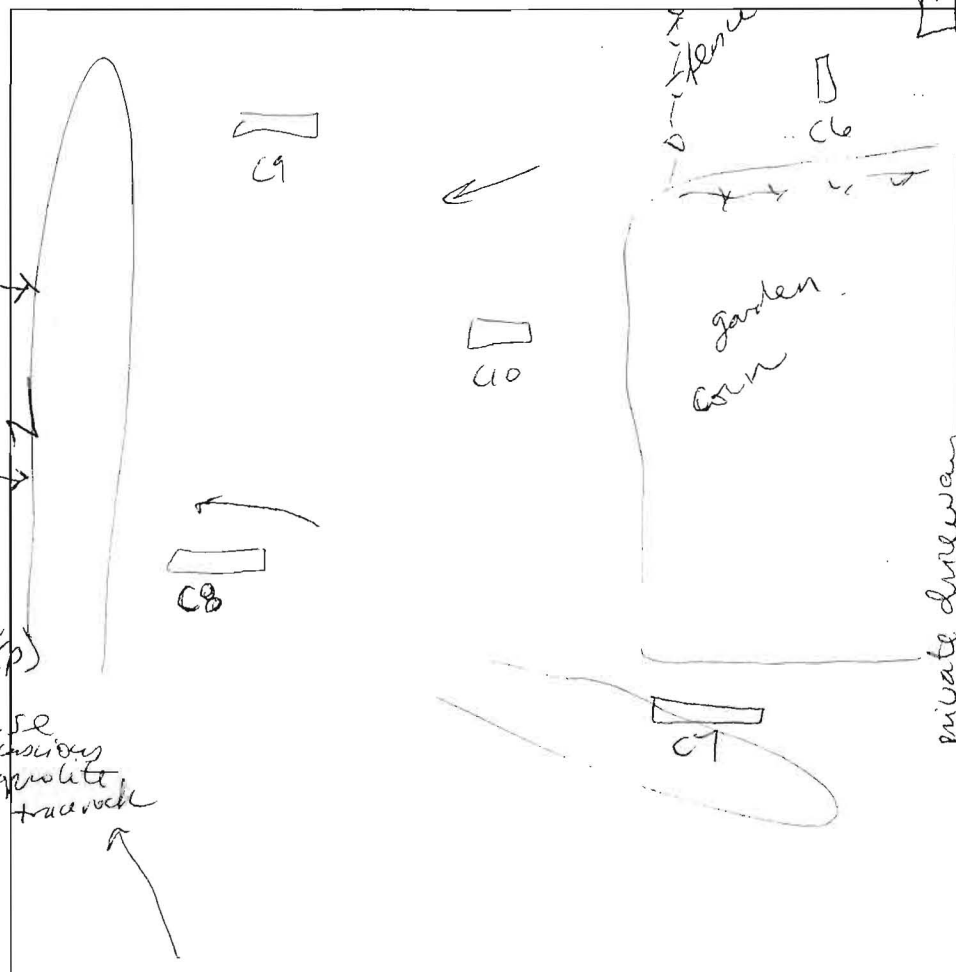

C9
 1' dk brn l sbk
 1' st. brn / red yellow med scl micaceous sticky
 6' 5" (f) mottles pale brn / red yellow med scl
 14' water level

A
 dk brn se
 brn wk scl micaceous
 2' 3" dk brn se micaceous
 Saprolite

C6
 1' dk brn se
 5' 2" brn brn red se cs micaceous 5% chert
 pale brn / gray med se sa Saprolite cw / cs

DATE	TEST #	DEPTH	START	BREAK 1" DROP	STOP 2" DROP	TIME OF 2ND INCH	P/F/H
7/10/08	C8	4' / 13'	9:41	10:01	No movement		F
		6'	10:20		No movement		F
	C10	6' 7" / 13' 3"	10:49	11:35	only to 2"		F
	C9	15'			deep clay		F
	A	3' 5" / 10' 9"	12:08	12:18	No movement		F
	C6	5' 1/2" / 13'	1:10	1:22	1:53	31	F
	C7	6' / 13' 5"			did not test for oil	visual	F

REMARKS clay per stake
 SANITARIAN SS / DB BACKHOE Fulton OTHERS _____
 TEST HOLES USED IN SDA _____ AVG. PERC TIME _____ SQ. FT/BR _____
 TRENCH WIDTH _____ INLET DEPTH _____ MAX. BOT DEPTH _____ EFFECTIVE SW _____

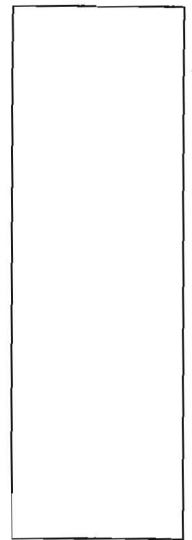
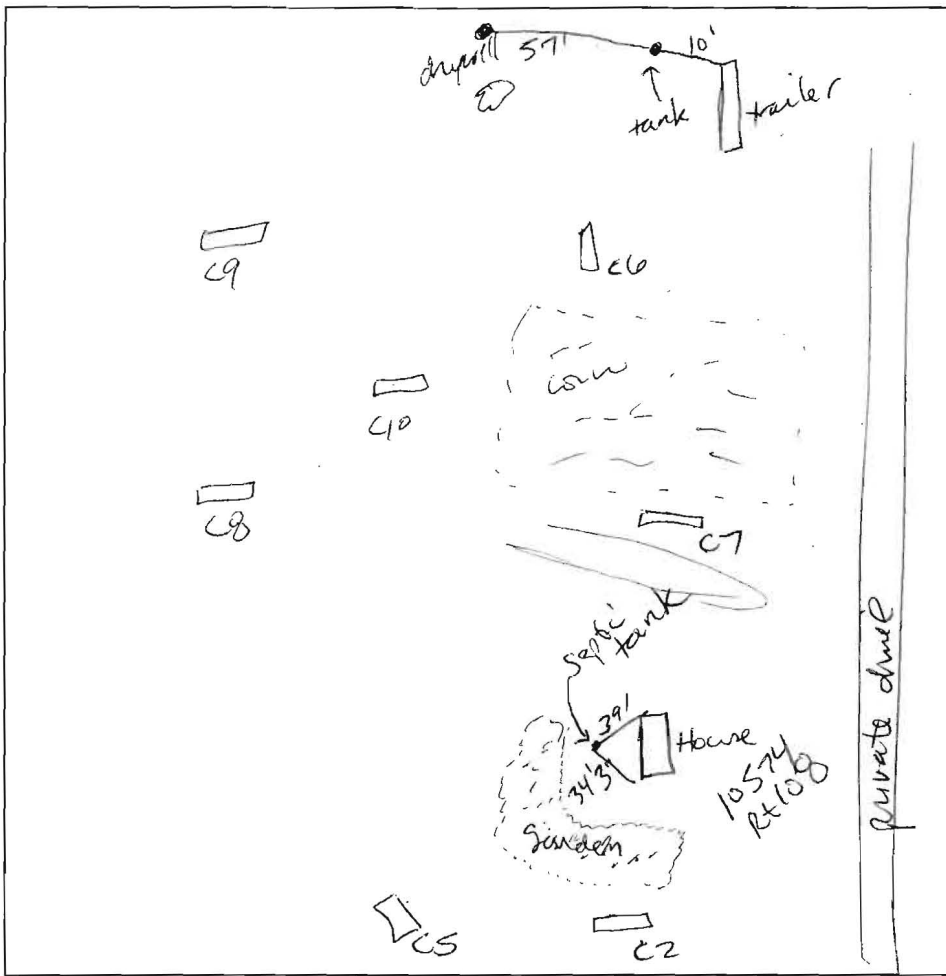
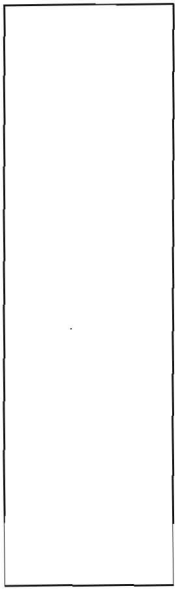

C2
 dk brn & sbk
 1'
 brn med sl sq cw → CS micaceous saponit
 trace Rock
 12'9" brn med sl saponit
 trace chert refusal

C5
 1' brn & micaceous
 brn fine scl micaceous sbk
 6'5" ↓ vs ice? 2" ribbon.
 trace Rock
 12' st. brn w/ gray mottles d2 scl micaceous 2" ribbon.
 13'

DATE	TEST #	DEPTH	START	BREAK 1" DROP	STOP 2" DROP	TIME OF 2ND INCH	P/F/H
6/19/08	C2	5'4" / 12'9"	11:41	12:01	Not 2" to	-	F
		7'4"	12:25	12:55	No + 2" to	-	F
	C5	6'5" / 13'	1:07	1:28	No movement		F

REMARKS Holes dug per plan
 SANITARIAN SS BACKHOE Fulton OTHERS _____
 TEST HOLES USED IN SDA _____ AVG. PERC TIME _____ SQ. FT/BR _____
 TRENCH WIDTH _____ INLET DEPTH _____ MAX. BOT DEPTH _____ EFFECTIVE S/W _____

septic tank top ~ 3' below grade + is full
 under block dry well - top ~ 2' below grade, dry, dirt below PVC inlet (~4' below grade)

