

9/17/89
10:00

APPLICATION

PERCOLATION TESTING

A 572684

P _____

HOWARD COUNTY HEALTH DEPARTMENT
BUREAU OF ENVIRONMENTAL HEALTH
3525-H ELLICOTT MILLS DRIVE/ELLICOTT CITY, MARYLAND 21043
TELEPHONE: 313-2640

Proposal - to establish
septic reserve area
to accomodate potential
commercial use

DISTRICT _____
DATE 8-27-95

TO: THE COUNTY HEALTH OFFICER
ELLICOTT CITY, MARYLAND

I HEREBY APPLY FOR THE NECESSARY TEST PRIOR TO APPLICATION FOR PERMIT TO CONSTRUCT (OR RECONSTRUCT) A SEWAGE DISPOSAL SYSTEM.

PROPERTY OWNER MARSHALL T. HARDING

ADDRESS 13440 Highland - Rt 108 PHONE _____

AGENT OR PROSPECTIVE BUYER C+B Development Highland 20222 Chris Carlyle

ADDRESS 10801 Hickory Ridge Rd PHONE 410-203-9900 / 884-0094

PROPERTY LOCATION:

SUBDIVISION Harding Property LOT NO. _____

ROAD AND DESCRIPTION 13440 Rt 108

TAX MAP 40 PARCEL # 55

SIZE OF LOT 1.5 AC TYPE BLDG. Commercial (7-Eleven)
(SINGLE FAMILY DWELLING OR COMMERCIAL)

THE SYSTEM INSTALLED UNDER THIS APPLICATION IS ACCEPTABLE ONLY UNTIL PUBLIC FACILITIES BECOME AVAILABLE. I FULLY UNDERSTAND THE FEE CONNECTED WITH THE FILING OF THIS PERC TEST APPLICATION IS NON-REFUNDABLE UNDER ANY CIRCUMSTANCES. I ALSO AGREE TO COMPLY WITH ALL M.O.S.H.A. REQUIREMENTS IN TESTING THIS LOT.

(SIGNATURE OF APPLICANT)

APPROVED BY _____ FOR _____ DATE _____

DISAPPROVED BY _____ FOR _____ DATE _____

HOLD PENDING FURTHER TESTS _____

REASONS FOR REJECTION OR HOLDING _____

PERCOLATION TEST PLAT/PRELIMINARY PLAT - TITLE OR I.D. # _____ DATE _____

SITE DEVELOPMENT PLAN/FINAL PLAT - TITLE OR I.D. # _____ DATE _____

THIS IS NOT A PERMIT

COUNTY #

SOIL PROFILE

0'

443 463 3250

Chans/Mob. 1

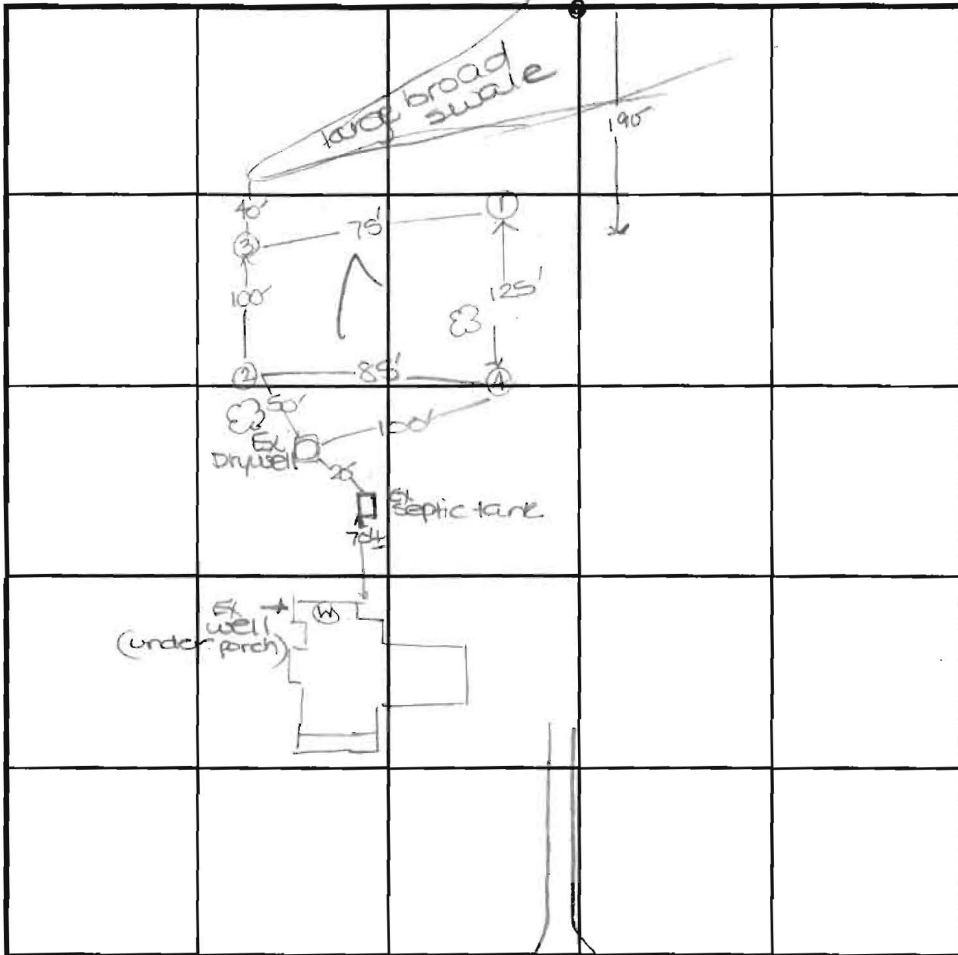

SOIL PROFILE

0'

1' topsoil

red brn cl lm

4' 4.5' med org brn sa lm

9' Evidence of mottles

12'

1' ① topsoil

red brn cl lm

4.5' med org brn sa lm

8.5' Evidence of mottles

12'

INDICATE NORTH - NAME ADJOINING ROADWAY AS BASE LINE.

Route 108

DATE	TEST NO.	DEPTH	PRE-WET		TEST - 1" DROP		TIME
			START	STOP	START	STOP	
9-23-99	4	4.5'S	1:04	1:06	1:06	1:10	4
		12.0'D	visual	-see	profile		Hold for wet season
	2	5.0'S	1:16	1:18 ₂	1:18 ₃	1:22	4
		13.0'D	visual	-see	profile		Hold for wet season
	3	5.0'S	1:28	1:31	1:31	1:35	4
		12.0'D	visual	-see	profile		Hold for wet season
	1	12.0'D	visual	-see	profile		Hold for wet season

REMARKS test holes not staked

TYPE OF SOIL _____

TESTED BY D. SOE ALSO PRESENT C. Curlye, D. Kettermar

TRENCH DESIGN DATA: AVERAGE PERCOLATION TIME _____ TRENCH WIDTH _____

INLET DEPTH _____ MAXIMUM BOTTOM DEPTH _____ SQ. FT./BEDROOM _____

0'

④

topsoil

red brn cl lm

4'

med org brn sa lm

w/ some mica

9.4' Evidence of mottles

12'

0'

②

topsoil

red brn cl lm

4.5'

med org brn sa lm

w/ mica

10' Evidence of mottles

13'

WELL SEASON) 3440 ROUTE 108

COUNTY #

SOIL PROFILE

0'

SOIL PROFILE

0'

INDICATE NORTH - NAME ADJOINING ROADWAY AS BASE LINE.

DATE	TEST NO.	DEPTH	PRE-WET		TEST - 1" DROP		TIME
			START	STOP	START	STOP	
4-3-00	1	13' 9" D	water	- see	profile		OK
	3	13.5' D	visual	- see	profile		OK

REMARKS _____

TYPE OF SOIL _____

TESTED BY DLS ALSO PRESENT Mr. Ketterman

TRENCH DESIGN DATA: AVERAGE PERCOLATION TIME _____ TRENCH WIDTH Mr. Harding

INLET DEPTH _____ MAXIMUM BOTTOM DEPTH _____ SQ. FT./BEDROOM _____



HOWARD COUNTY HEALTH DEPARTMENT

Diane L. Matuszak, M.D., M.P.H., County Health Officer

April 17, 2000

Mr. Thomas Harding
13440 Clarksville Pike
Highland, Maryland 20777

RE: Percolation Test Results

Proposed Use: Establish sufficient septic reserve area
Property ID: Harding Property
13440 Clarksville Pike
Tax Map: 40 Parcel #55

Dear Sir:

Wet season percolation testing was conducted April 3, 2000, on the above referenced property. Percolation test holes indicated limited satisfactory soil conditions. A copy of the percolation test results is enclosed.

A registered engineer should submit a Percolation Certification Plan showing the following information to this office at this time:

- actual locations and elevations of all excavated test holes
- locations of all existing wells and septic systems on the property
- locations of all existing structures on the property
- locations of streams/swales/springs and any other features on the property
- field matched contour lines at 2-foot intervals

This plat should be submitted within sixty (60) days to allow field verification if necessary.

If you have any questions regarding this matter, please feel free to contact me at the address below or by calling (410) 313-2640. Thank you in advance for your time and cooperation.

Sincerely,

Donna K. Soe, R.S.

Water and Sewerage Program

DKS

Enclosures

Cc: file



HOWARD COUNTY HEALTH DEPARTMENT

Diane L. Matuszak, M.D., M.P.H., County Health Officer

March 16, 2000

Mr. Thomas Harding
13440 Clarksville Pike
Highland, Maryland 20777

RE: **Wet season percolation test date**
Proposed Use: Commercial
Property ID: Harding Property
13440 Clarksville Pike
Tax Map: 40 Parcel #55

Dear Mr. Harding:

Wet season percolation testing has been tentatively scheduled for the above referenced property for **Monday, April 3, 2000 at 10:00 a.m.** Please call this office at (410) 313-2640 to confirm your acceptance of these percolation test dates.

You shall be responsible for having a contractor on site to excavate the test holes at the corners of the proposed septic area(s).

In the event of uncertain weather (i.e., precipitation or extremes of temperature), please contact this office prior to 9:00 a.m. on the test date to determine whether or not percolation testing can be performed on that date. If it is not feasible to perform the test, a new test date shall be assigned.

Please be advised that current groundwater levels are considerably lower than levels of previous years. Therefore, a supplemental buffer shall be added to account for this deficiency in the groundwater levels as part of our judgement of the soil suitability for septic systems. This supplemental buffer shall be applied in addition to that which is dictated by state regulatory standards. Furthermore, information gathered during this limited wet season may be subject to further consideration.

Percolation test results may be expected by mail approximately two weeks after the completion of the percolation testing.

Thank you in advance for your cooperation in this matter.

Sincerely,

Donna K. Soe, R.S.
Water and Sewerage Program

Cc: file

9:20 open
11:50 measured

