

8/11/90

Tax ID-05-342090

# PERMIT

## SEWAGE DISPOSAL SYSTEM

### DEPARTMENT OF HEALTH AND MENTAL HYGIENE

**HOWARD COUNTY HEALTH DEPARTMENT**  
BUREAU OF ENVIRONMENTAL HEALTH  
461-9933

INDEXED

P 46570

A REPAIR

DISTRICT \_\_\_\_\_

DATE 10/22/90

DATE SYSTEM APPROVED \_\_\_\_\_

INSPECTOR \_\_\_\_\_

Jack Fyock

IS PERMITTED TO INSTALL \_\_\_\_\_ ALTER

ADDRESS \_\_\_\_\_ PHONE 988-9270

SUBDIVISION Patuxent Hills LOT 2 ROAD 11772 Route 108

PROPERTY OWNER Carroll Baker

ADDRESS 11772 Route 108 Clarksville Pike  
Clarksville, Maryland 21029

SEPTIC TANK CAPACITY 1000 GALLONS

NUMBER OF BEDROOMS 3

125 SQUARE FEET PER BEDROOM 375 3BR

LINEAR FEET OF TRENCH REQUIRED 50

REPAIR - CALL FOR INSPECTION WHEN GROUND IS OPENED SO SANITARIAN CAN RECOMMEND REPAIR.

9/11/90 - TRENCH OFF OLD DRY WELL  
12 FT DEEP INLET TO TRENCH 4 1/2 FT  
FT, 7 1/2 FT STONE BK

PLANS APPROVED BY C. Williams DATE 9/07/90

COVER NO WORK UNTIL INSPECTED AND APPROVED.

NEITHER THE HOWARD COUNTY COUNCIL NOR THE HEALTH DEPARTMENT IS RESPONSIBLE FOR THE SUCCESSFUL OPERATION OF ANY SYSTEM

NOTE: CLEANOUT REQUIRED EVERY 70 FEET OF SEWER LINE AND/OR AT 90° SWEEPS IN LINES FROM HOUSE TO DRAIN FIELDS, 90° ELBOWS NOT ACCEPTABLE.

NOTE: ALL PARTS OF SEPTIC SYSTEMS (I.E. TANK, DISTRIBUTION BOX TRENCHES) TO BE 100 FEET FROM WELL (UNLESS OTHERWISE SPECIFICALLY AUTHORIZED)

NOTE: IF DEEP TRENCH(ES) ARE USED CALL FOR INSPECTION BEFORE AND AFTER PLACING GRAVEL IN TRENCH(ES)

NOTE: NO DRY WELL SHALL EXCEED 15 FOOT IN DIAMETER NO ABSORPTION TRENCH TO EXCEED 100 FEET IN LENGTH

NOTE: ALL PIPE FROM HOUSE TO SEPTIC TANK MUST BE CAST IRON OR SCHEDULE 35/40 PVC OR ABS

PERMIT VOID AFTER TWO YEARS

NOTE: INSTALL STAND PIPE ON SEPTIC TANK AND DRY WELL STAND PIPES MUST BE 6 INCHES IN DIAMETER CAST IRON. CONCRETE OR TERRA COTTA OR PVA OR ABS ACCEPTED. IF TOP OF SEPTIC TANK IS DEEPER THAN 3 FEET. MANHOLE TO GRADE REQUIRED.

NOTE: DISTRIBUTION BOXES MUST HAVE BAFFLES

**\*INSTALLER IS RESPONSIBLE FOR OBTAINING FINAL APPROVAL ON THIS PERMIT**

P  
46570

①  
 BROWN CLAY  
 LIGHT BROWN GRAY SAND LOAM

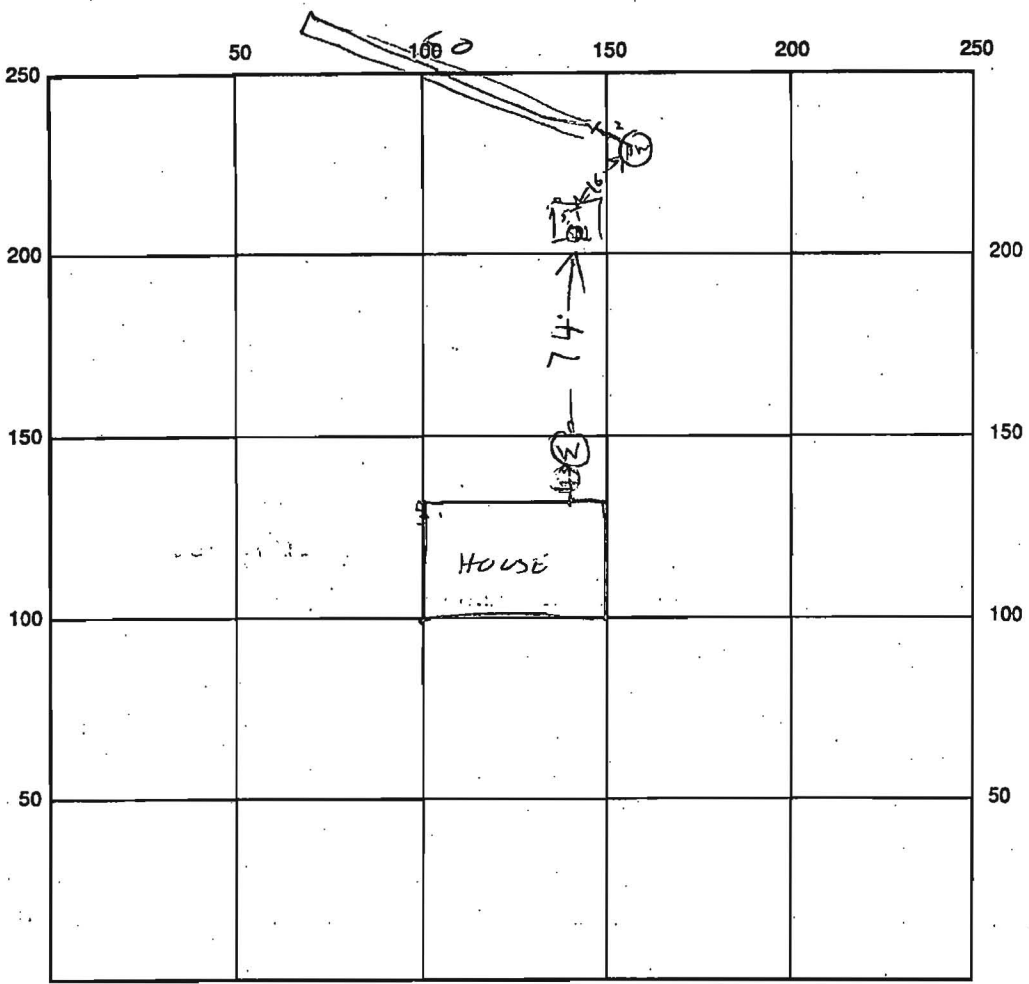

INDICATE NORTH - NAME ADJOINING ROADWAY AS BASE LINE

SEPTIC TANK LEVEL \_\_\_\_\_ CLEANOUTS \_\_\_\_\_

DISTRIBUTION BOX LEVEL \_\_\_\_\_

DRAIN FIELD/TITLE DEPTH 12 FT. TRENCH WIDTH 2 FT. INLET DEPTH 4 1/2 FT.

EFFECTIVE GRAVEL DEPTH 7 1/2 FT. TOTAL LENGTH 60 FT.

NUMBER OF TRENCHES 1 ONE SIDEWALL/BOTTOM AREA 450 SQ. FT.

DRYWALL INSIDE DIAMETER \_\_\_\_\_ FT. EFFECTIVE DEPTH BELOW INLET \_\_\_\_\_ FT.

ABSORBENT AREA \_\_\_\_\_ SQ. FT.

REMARKS: 9/11/90 - OLD SYSTEM IN USE 30 YEARS

ADD STONE TO END OF TRENCH & COVER RIT

DATE SYSTEM APPROVED 9/11/90 INSPECTOR Raymond Hodges