

18

# APPLICATION

PERCOLATION TESTING

A \_\_\_\_\_

P \_\_\_\_\_

HOWARD COUNTY HEALTH DEPARTMENT  
BUREAU OF ENVIRONMENTAL HEALTH  
3525-H ELLICOTT MILLS DRIVE/ELLICOTT CITY, MARYLAND 21043  
TELEPHONE: 313-2840

DISTRICT \_\_\_\_\_

DATE \_\_\_\_\_

TO: THE COUNTY HEALTH OFFICER  
ELLICOTT CITY, MARYLAND

I HEREBY APPLY FOR THE NECESSARY TEST PRIOR TO APPLICATION FOR PERMIT TO CONSTRUCT (OR RECONSTRUCT) A SEWAGE DISPOSAL SYSTEM.

PROPERTY OWNER \_\_\_\_\_

ADDRESS \_\_\_\_\_ PHONE \_\_\_\_\_

AGENT OR PROSPECTIVE BUYER \_\_\_\_\_

ADDRESS \_\_\_\_\_ PHONE \_\_\_\_\_

PROPERTY LOCATION:

SUBDIVISION \_\_\_\_\_ LOT NO. \_\_\_\_\_

ROAD AND DESCRIPTION \_\_\_\_\_

TAX MAP \_\_\_\_\_ PARCEL # \_\_\_\_\_

SIZE OF LOT \_\_\_\_\_ TYPE BLDG. \_\_\_\_\_  
(SINGLE FAMILY DWELLING OR COMMERCIAL)

THE SYSTEM INSTALLED UNDER THIS APPLICATION IS ACCEPTABLE ONLY UNTIL PUBLIC FACILITIES BECOME AVAILABLE. I FULLY UNDERSTAND THE FEE CONNECTED WITH THE FILING OF THIS PERC TEST APPLICATION IS NON-REFUNDABLE UNDER ANY CIRCUMSTANCES. I ALSO AGREE TO COMPLY WITH ALL M.O.S.H.A. REQUIREMENTS IN TESTING THIS LOT.

(SIGNATURE OF APPLICANT)

APPROVED BY \_\_\_\_\_ FOR \_\_\_\_\_ DATE \_\_\_\_\_

DISAPPROVED BY \_\_\_\_\_ FOR \_\_\_\_\_ DATE \_\_\_\_\_

HOLD PENDING FURTHER TESTS \_\_\_\_\_

REASONS FOR REJECTION OR HOLDING \_\_\_\_\_

PERCOLATION TEST PLAT/PRELIMINARY PLAT - TITLE OR I.D. # \_\_\_\_\_ DATE \_\_\_\_\_

SITE DEVELOPMENT PLAN/FINAL PLAT - TITLE OR I.D. # \_\_\_\_\_ DATE \_\_\_\_\_

# THIS IS NOT A PERMIT

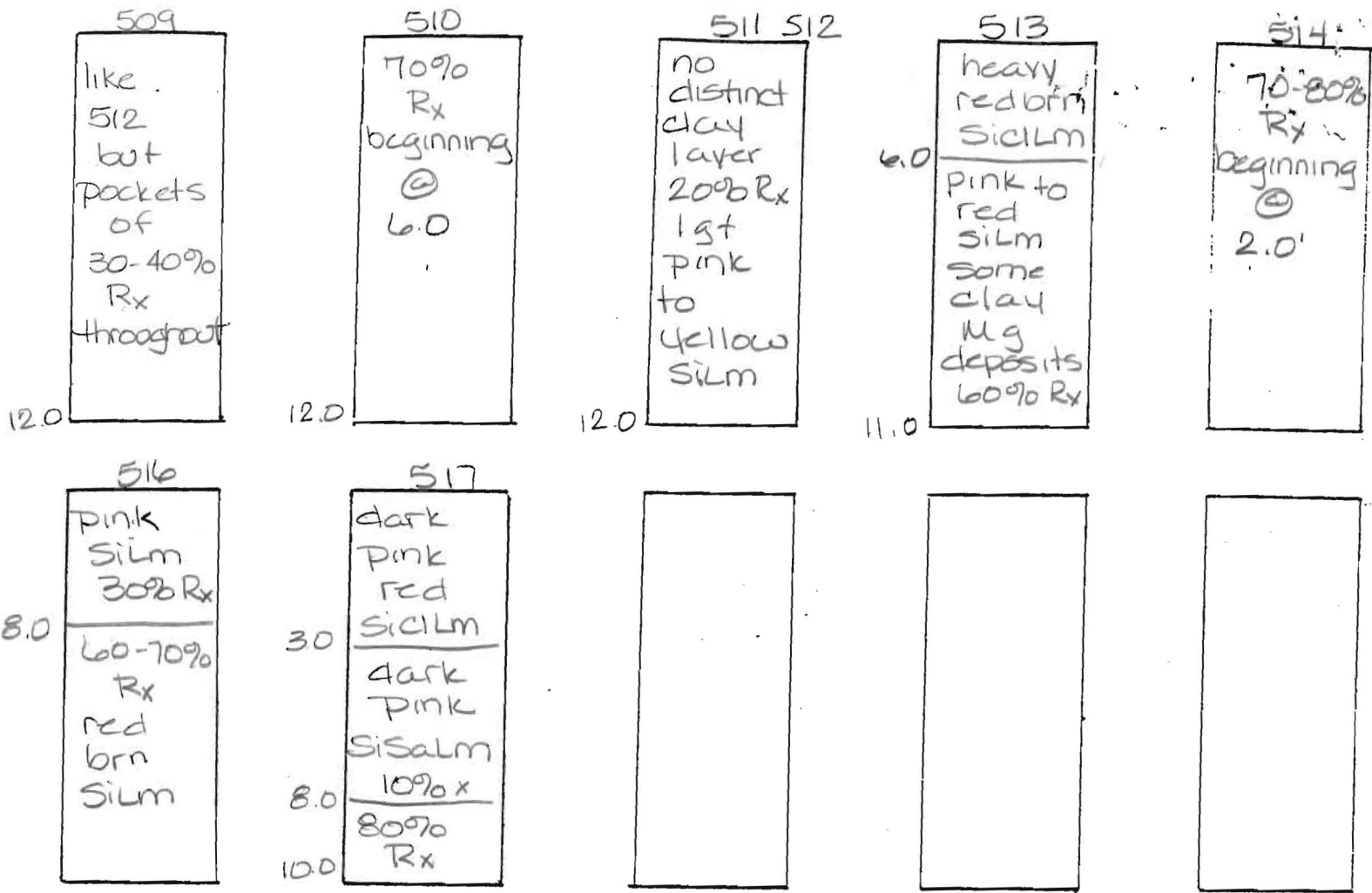

DATE	TEST NO.	DEPTH	PRE-WET		TEST - 1" DROP		TIME		
			START	STOP	START	STOP			
6-5-98	509	<del>3.0</del> 12.0	2:49	2:51	2:51	2:56	5min	P	
	510	Insufficient depth to bedrock - profile					sec	F	
	511	<del>3.5</del> 12.0	2:39	2:41	2:41	2:44	3min	P	
	512	<del>2.5</del> 12.0	2:27	2:29	2:29	2:33	4min	P	
	513	<del>2.5</del> 11.0	2:11	2:19	>30 min				
		Deep clay & Insufficient depth to bedrock						F	
	514	Insufficient depth to bedrock -						F	
	516	<del>3.0</del> 12.0	3:00	3:02	3:02	3:05	3min	P	
	517	<del>4.0</del> 10.0	3:18	3:21	3:21	3:35	14min	P	

REMARKS \_\_\_\_\_  
 TESTED BY Amy McMillen ALSO PRESENT MR. Smith

COUNTY #

SOIL PROFILE

C-6 C-5

or red  
SiLm

3.0

red  
brn  
SiLm  
30%  
shale

3.0

C-4

like  
C-6 &  
C-5

3.0

C-1

orange  
to  
pink  
SiLm

lgt  
yellow  
beign  
SiLm  
15%  
saprotic

SOIL PROFILE

C-2

like  
C-1  
but  
H<sub>2</sub>O  
⊙  
12.0

INDICATE NORTH - NAME ADJOINING ROADWAY AS BASE LINE.

DATE	TEST NO.	DEPTH	PRE-WET		TEST - 1" DROP		TIME
			START	STOP	START	STOP	
4-12-00	16/17	Water @ 7.0'	-open		15 sec	---	F
	C-6	4.0 V13.0	9:44	9:49	9:49	9:56	7min
	C-5	4.0 V13.0	10:02	10:11	10:11	10:27	16min
	C-4	4.0 V13.0	10:20	10:38	10:38	11:05	27min
	C-1	Visual to 13.0	- see profile				OK
	C-2	5.0 V13.0	12:35	12:41	12:41	12:55	14min

REMARKS \_\_\_\_\_

TYPE OF SOIL \_\_\_\_\_

TESTED BY Amy McMillen ALSO PRESENT \_\_\_\_\_

TRENCH DESIGN DATA: AVERAGE PERCOLATION TIME \_\_\_\_\_ TRENCH WIDTH \_\_\_\_\_

INLET DEPTH \_\_\_\_\_ MAXIMUM BOTTOM DEPTH \_\_\_\_\_ SQ. FT./BEDROOM \_\_\_\_\_

SMITH PROPERTY - ROUTE 94  
PERCOLATION TESTING - 06/05/98

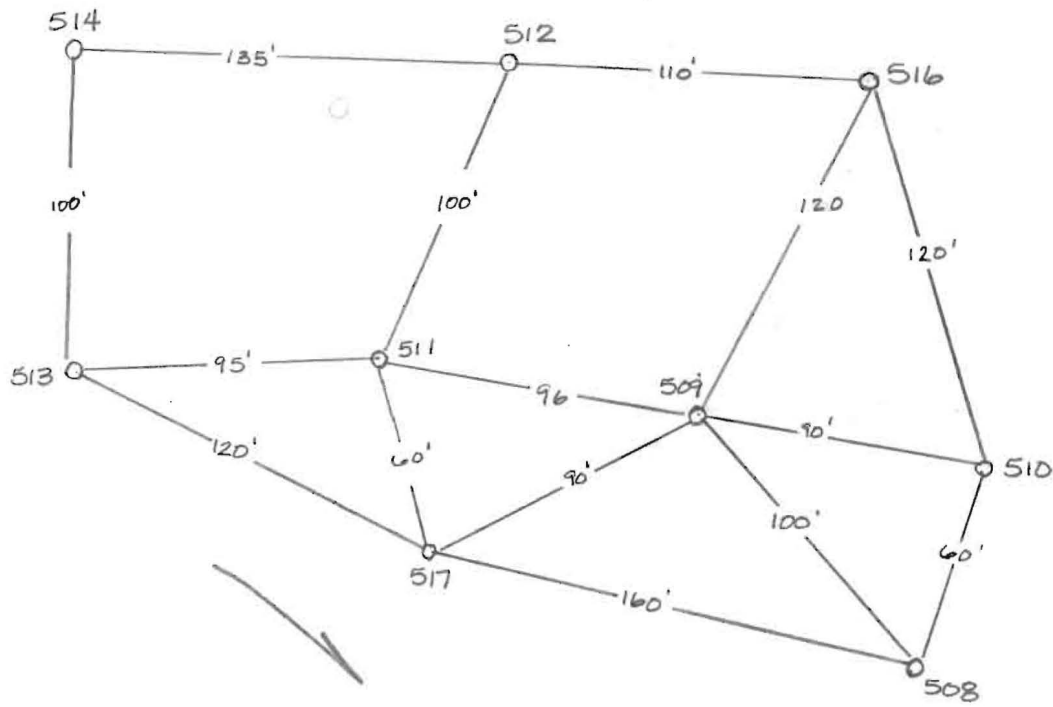

SWALE

↓ to Rt. 94

Smith Farm Rt 9A  
6/5/98

6/5/98  
Smith

513  
heavy red brn silm 2.5  
silcilm 2:11  
pink to red silm 2:19  
some clay-mg deposits slow (F)  
50% Rx 11.0

509 [3.0]  
like 2.49  
512 but 2:51  
pockets of 30-40% Rx 2:56  
(P)

517 [4.0]  
dark pink red silcilm 3:18  
dark pink silcilm 3:21  
100% Rx 3:25  
bottom @ 8.0' 80% Rx @ 8' (P)

514  
70-80% Rx beginning @ 2.0' (F)  
10.0

516 [3.0]  
pink silm 3:00  
30% Rx 3:02  
>50% Rx 3:05  
60-70% red brn silm 12.0 (P)

508 [5.0]  
dark red brn silcilm 3:04  
30% shale 3:07  
lgt red brn silm 20% shale 3:10 (P)  
12.0

512 [2.5]  
no distinct clay layer-20% Rx 2:27  
lgt pink to yellow silm 2:29  
2:33 (OK)  
12.0

510  
70% Rx beginning @ 6.0'  
visual to 12.0 (F)

511  
like 512 [3.5]  
2:39  
2:41  
2:44 (P)

