

12/15/79
As much possible

12/15/79 File
approved
P 30391 C.B.S.

PERMIT

SEWAGE DISPOSAL SYSTEM

MARYLAND STATE DEPARTMENT OF HEALTH

A Repair

HOWARD COUNTY

ELLICOTT CITY

DISTRICT 5th

INDEXED

DATE _____

Jack Fyock IS PERMITTED TO INSTALL ALTER X

ADDRESS 13775 Triadelphia Road, Glenelg, Md. 21737 PHONE 988-9270

SUBDIVISION _____ ROAD 7604 Brown Bridge Road LOT 3

PROPERTY OWNER Martin P. Wasserman

ADDRESS 7604 Brown Bridge Road, Fulton, Md. Phone: 854-0033

SPECIFICATIONS

SEPTIC TANK CAPACITY _____ GALLONS

DRAIN FIELD _____ DEPTH _____ FEET, BOTTOM AREA _____ SQ. FT.

DEEP TRENCH _____ DEPTH _____ FEET, BOTTOM AREA _____ SQ. FT.

SEEPAGE PITS _____ ABSORBENT SIDE-WALL AREA _____ SQ. FT.

INLET PIPE _____ FT. BELOW ORIGINAL GRADE, MAXIMUM DEPTH _____ FT. BELOW ORIGINAL GRADE

EFFECTIVE DEPTH AT _____ FT. BELOW ORIGINAL GRADE.

LOCATE DISPOSAL AREA _____ FT. FROM _____ LOT LINE AND _____ FT. FROM _____ LOT LINE AS SEEN WHEN

FACING LOT FROM

REPAIR - Call for an appointment when ground is opened up and Sanitarian will

recommend the repair system.

PLANS APPROVED BY Palmer F. Wine DATE 11/30/79

COVER NO WORK UNTIL INSPECTED AND APPROVED.

NEITHER THE HOWARD COUNTY COUNCIL NOR THE HEALTH DEPARTMENT IS RESPONSIBLE FOR THE SUCCESSFUL OPERATION OF ANY SYSTEM.

NOTE: IF TRENCH IS USED CALL FOR INSPECTION BEFORE PLACING GRAVEL IN TRENCH.

NOTE: NO DRY WELL SHALL EXCEED 18 FOOT IN DIAMETER.

NOTE: ALL PIPE FROM HOUSE TO DISPOSAL AREA MUST BE CAST IRON.

PERMIT VOID AFTER THREE YEARS.

NOTE: INSTALL STAND PIPE ON SEPTIC TANK AND DRY WELL. STAND PIPES MUST BE 6 INCHES IN DIAMETER. CAST IRON, CONCRETE OR TERRA COTTA ACCEPTED.

***INSTALLER IS RESPONSIBLE FOR OBTAINING FINAL APPROVAL ON THIS PERMIT.**

P 30391

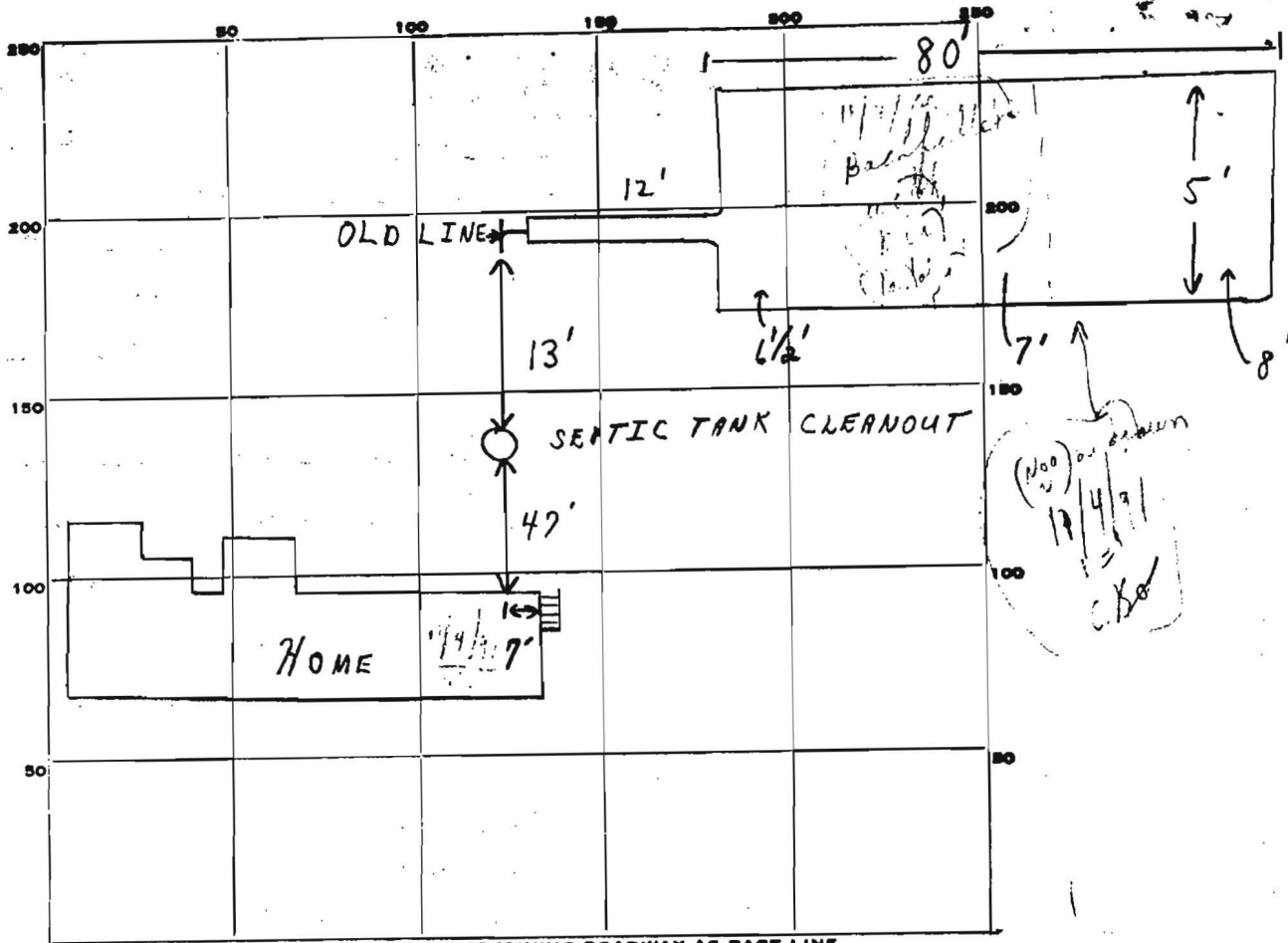

INDICATE NORTH. - NAME ADJOINING ROADWAY AS BASE LINE.

Brown Bridge Road

PERMIT CARD

SEPTIC TANK, LEVEL _____

CLEANOUTS _____

DISTRIBUTION BOX, LEVEL _____

TILE FIELD, DEPTH 6 1/2 - 8 FT. TRENCH WIDTH 5 FT.

GRAVEL DEPTH 2' + IN. TOTAL LENGTH 80 FT.

NUMBER OF TRENCHES 1 TOTAL BOTTOM AREA 400'

SEEPAGE PITS, INSIDE DIAMETER _____ FT. DEPTH BELOW INLET _____ FT.

ABSORBENT AREA 400' + SQ. FT.

REMARKS 12/5/79 Trench ok for stone. ; TRENCH

COMPLETED.
C.B.W.

DATE SYSTEM APPROVED

12/5/79 as per above INSPECTOR

C. B. W. Stecker