

LAYOUT 9/8/2010 INSP 4 _____
INSP 2 9/17/2010 INSP 5 _____
INSP 3 _____ INSP 6 _____

ISSUE DATE: 8/27/2010
APPROVAL DATE: 9/20/2010

PERMIT

Repair-5346827

P 534007
A Repair

ON-SITE SEWAGE DISPOSAL SYSTEM HOWARD COUNTY HEALTH DEPARTMENT BUREAU OF ENVIRONMENTAL HEALTH

IS PERMITTED TO INSTALL ALTER

ADDRESS: _____ PHONE NUMBER: _____

SUBDIVISION: _____ LOT NUMBER: _____

ADDRESS: 7345 Browns Bridge PROPERTY OWNER: John Connoly

SEPTIC TANK CAPACITY (GALLONS): Road 1500 OUTLET BAFFLE FILTER REQUIRED

PUMP CHAMBER CAPACITY (GALLONS): 1000 COMPARTMENTED TANK REQUIRED

NUMBER OF BEDROOMS: 3 Trenches 3' Wide
SQUARE FEET PER BEDROOM: _____ Inlet 4', Bottom 5.5'
LINEAR FEET OF TRENCH REQUIRED: 156' Top Trench 48', Two Middle
Trenches 38' Long, Bottom
Trench 32' in Length

TRENCHES:	Trench to be _____ feet wide. Inlet _____ feet below original grade. Bottom maximum depth _____ feet below original grade. Effective area begins at _____ feet below original grade. _____ feet of stone below distribution pipe.
LOCATION:	<u>Trenches to Be Installed on Upper Part of Adjacent Lot start Top Trench 45' From Browns Bridge Rd</u>
NOTES:	<u>Stay 100' From Well</u> <u>Trenches to Be Spaced 8' on Centers</u> <u>Pump Out and Abandon Steel Tank and Drywell</u>

PLANS APPROVED: B. Baker DATE: 9/8/2010

- NOTE: PERMIT VOID AFTER 2 YEARS
- NOTE: CONTRACTOR RESPONSIBLE FOR SCHEDULING A PRE-CONSTRUCTION INSPECTION FOR ALL INSTALLATIONS
- NOTE: WATERTIGHT SEPTIC TANKS REQUIRED
- NOTE: ALL PARTS OF SEPTIC SYSTEM SHALL BE 100 FEET FROM ANY WATER WELL
- NOTE: MANHOLE RISERS REQUIRED ON ALL SEPTIC TANKS AND PUMP CHAMBERS UNLESS SPECIFICALLY AUTHORIZED

NEITHER THE HOWARD COUNTY COUNCIL NOR THE HEALTH DEPARTMENT IS RESPONSIBLE FOR THE SUCCESSFUL OPERATION OF ANY SYSTEM PERMITTEE RESPONSIBLE FOR OBTAINING FINAL APPROVAL ON THIS PERMIT CALL 410-313-2640 FOR INSPECTION OF SEPTIC SYSTEM

NOT TO SCALE

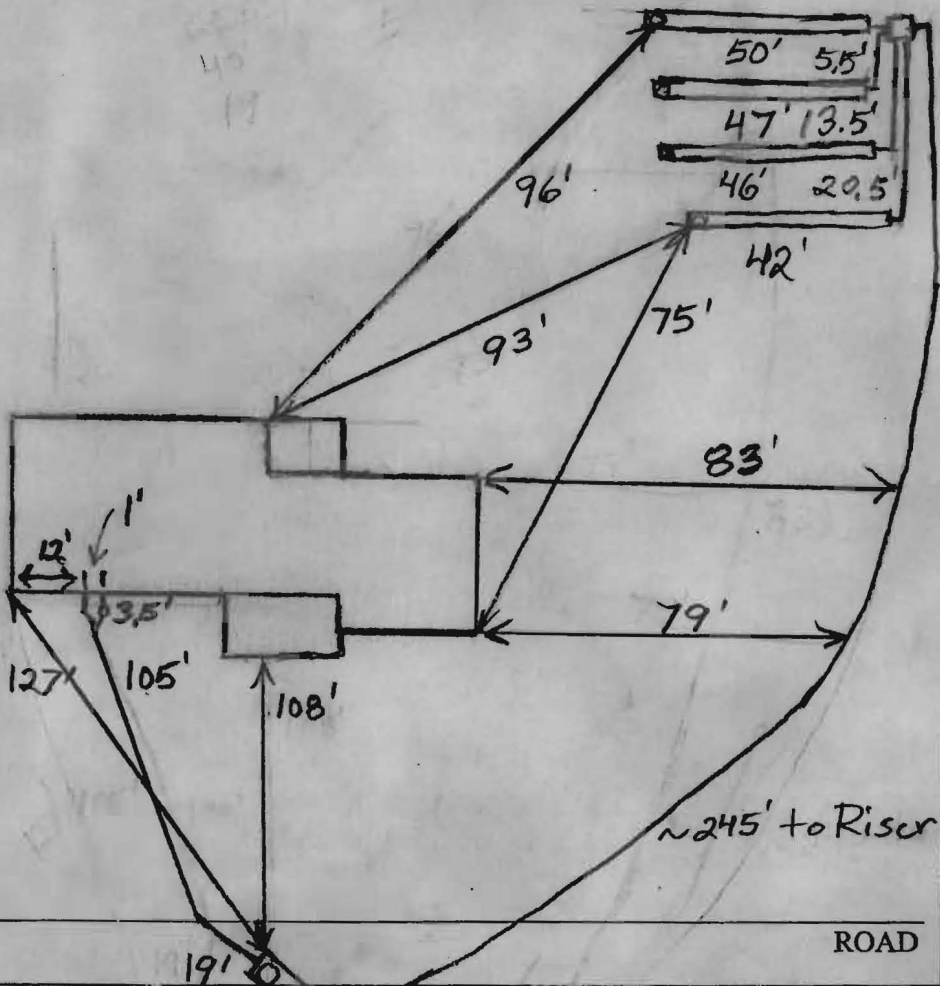

TRENCH/DRAINFIELD DATA		
WIDTH	INLET	BOTTOM
3'	3.5-4.5'	5.5'
NUMBER OF TRENCHES		4'
TOTAL LENGTH		185'
ABSORPTION AREA		555 + Sidewall //
DISTRIBUTION BOX LEVEL		Yes
DISTRIBUTION BOX BAFFLE		Elbow
DISTRIBUTION BOX PORT		Yes

SEPTIC TANK DATA	
SEPTIC TANK 1 LEVEL	Yes
CAPACITY	1500 GAL
SEAM LOC	Top
TANK LID DEPTH	0.5'-1'
BAFFLES	Yes
BAFFLE FILTER	No
MANHOLE LOC	Front
6" PORT LOC	Rear
WATERTIGHT TEST	No
SEPTIC TANK 2 LEVEL	Yes
CAPACITY	1000 GAL
SEAM LOC	Top
TANK LID DEPTH	1-1.5'
BAFFLES	Front
BAFFLE FILTER	No
MANHOLE LOC	Middle
6" PORT LOC	None
WATERTIGHT TEST	No

PRE-CONSTRUCTION

2010 layout done (BB) 9/17/2010

INSTALLATION 9/8/2010 Layout done (BB) 9/17/2010 Tanks set.

House Connection Made. Pump line installed. (BB)

9/20/2010 Trenches finished. Pump and alarm working. (BB)

FINAL INSPECTOR B. Baber

DATE OF APPROVAL 9/20/2010