

C1 3702

SEQUENCE NO. (OEP USE ONLY)

STATE OF MARYLAND WELL COMPLETION REPORT

FILL IN THIS FORM COMPLETELY PLEASE PRINT OR TYPE

THIS REPORT MUST BE SUBMITTED WITHIN 45 DAYS AFTER WELL IS COMPLETED.

COUNTY NUMBER

A-37884-W

DATE RECEIVED

1/13/86

DATE WELL COMPLETED

12/1/86

DEPTH OF WELL

100 (TO NEAREST FOOT)

PERMIT NO. FROM "PERMIT TO DRILL WELL"

MD-81-1769

OWNER

BRYANT

DOWNALD

STREET OR RFD.

WANTWOODS RD

FIRST NAME

TOWN

GLENSWOOD

SUBDIVISION

WARFIELD ESTATES

SECTION

LOT 37

WELL LOG

Not required for driven wells

STATE THE KIND OF FORMATIONS PENETRATED, THEIR COLOR, DEPTH, THICKNESS AND IF WATER BEARING

DESCRIPTION (Use additional sheets if needed) FEET FROM TO Check if water bearing

Table with columns for Description, Feet From, and Feet To. Rows include: Top soil (0-2), clay (2-5), Brown soil (5-19), Shell (19-25), Gray rock (25-100).

GROUTING RECORD

WELL HAS BEEN GROUTED (Circle Appropriate Box)

YES (Y) NO (N)

TYPE OF GROUTING MATERIAL

CEMENT (CM) BENTONITE CLAY (BC)

NO. OF BAGS 20 NO. OF POUNDS 1800

GALLONS OF WATER 270 DEPTH OF GROUT SEAL (to nearest foot) from 0 ft. to 5 ft.

CASING RECORD

Casing types insert appropriate code below: ST (STEEL), CO (CONCRETE), PL (PLASTIC), OT (OTHER)

MAIN CASING TYPE: ST Nominal diameter: 4 inch Total depth: 100 feet

OTHER CASING (if used) diameter inch depth (feet) from to

SCREEN RECORD

screen type or open hole insert appropriate code below: ST (STEEL), BR (BRASS), HO (OPEN HOLE), PL (PLASTIC), OT (OTHER)

Table for screen depth with columns for depth (feet) from 0 to 51.

SLOT SIZE 1 2 3 DIAMETER OF SCREEN (NEAREST INCH)

GRAVEL PACK IF WELL DRILLED WAS FLOWING WELL INSERT F IN BOX 68

OEP USE ONLY (NOT TO BE FILLED IN BY DRILLER) T (TELESCOPE CASING), WQ (WELL QUANTITY), LOG INDICATOR, OTHER DATA

CIRCLE APPROPRIATE LETTER A WELL WAS ABANDONED AND SEALED WHEN THIS WELL WAS COMPLETED E ELECTRIC LOG OBTAINED P TEST WELL CONVERTED TO PRODUCTION WELL

I HEREBY CERTIFY THAT THIS WELL HAS BEEN CONSTRUCTED IN ACCORDANCE WITH COMAR 10.17.13 "WELL" CONSTRUCTION AND IN CONFORMANCE WITH ALL CONDITIONS STATED IN THE ABOVE CAPTIONED PERMIT, AND THAT THE INFORMATION PRESENTED HEREIN IS ACCURATE AND COMPLETE TO THE BEST OF MY KNOWLEDGE.

DRILLERS IDENT. NO. 3702

DRILLERS SIGNATURE (MUST MATCH SIGNATURE ON APPLICATION)

SITE SUPERVISOR (sign. of driller or journeyman responsible for sitework if different from permittee)

C 3

PUMPING TEST

HOURS PUMPED (nearest hour) 3 PUMPING RATE (gal. per min. to nearest gal.) 100 METHOD USED TO MEASURE PUMPING RATE WATER LEVEL (distance from land surface) BEFORE PUMPING WHEN PUMPING TYPE OF PUMP USED (for test) A air, P piston, T turbine, C centrifugal, R rotary, O other, J jet, S submersible

PUMP INSTALLED

DRILLER WILL INSTALL PUMP YES (Y) NO (N) IF DRILLER INSTALLS PUMP, THIS SECTION MUST BE COMPLETED FOR ALL WELLS EXCEPT HOME USE TYPE OF PUMP INSTALLED PLACE (A,C,J,P,R,S,T,O) IN BOX - SEE ABOVE: CAPACITY: GALLONS PER MINUTE (to nearest gallon) PUMP HORSE POWER PUMP COLUMN LENGTH (nearest ft.) CASING HEIGHT (circle appropriate box and enter casing height) LAND SURFACE (nearest foot)

LOCATION OF WELL ON LOT SHOW PERMANENT STRUCTURE SUCH AS BUILDING, SEPTIC TANKS, AND/OR LANDMARKS AND INDICATE NOT LESS THAN TWO DISTANCES (MEASUREMENTS TO WELL)

B i 2738

SEQUENCE NO. (OEP USE ONLY)

STATE OF MARYLAND PERMIT TO DRILL WELL

please print or type

OEP PERMIT NUMBER

10-81-1769

fill in this form completely

Date Received

1/13/86

OWNER INFORMATION

Owner: Donald... Street: Columbia... Town: Columbia... State: MD... Zip: 21046

B 3

LOCATION OF WELL

Harford County... Subdivision: Woodfield Estates... Section: 44... Lot: 29... Nearest Town: Glenwood... Miles from town: 1 MI

DRILLER INFORMATION

Driller's Name: Bernard Fetter... License No. 070... Firm Name: Tri County... Address: 16009 Frederick Highway... Signature: [Signature]... Date: 2/7/85

B 4

DIRECTION OF WELL FROM TOWN (CIRCLE BOX)

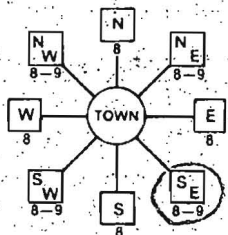

NEAR WHAT ROAD: Burnt Woods rd

ON WHICH SIDE OF ROAD (CIRCLE APPROPRIATE BOX)



DISTANCE FROM ROAD: 500 FT

ENTER FT or MI: 500

B 2

WELL INFORMATION

APPROX. PUMPING RATE (GAL. PER MIN.): 4... AVERAGE DAILY QUANTITY NEEDED (GAL. PER DAY): 200

USE FOR WATER (CIRCLE APPROPRIATE BOX)

- HOME (SINGLE OR DOUBLE HOUSEHOLD UNIT ONLY) - circled
FARMING (LIVESTOCK WATERING & AGRICULTURAL IRRIGATION)
INDUSTRIAL, COMMERCIAL, STATE AND FEDERAL GOV. OTHER (REQUIRES APPROPRIATION PERMIT)
PUBLIC OR PRIVATE WATER COMPANY (REQUIRES APPROPRIATION PERMIT AND STATE HEALTH DEPARTMENT APPROVAL)
TEST, OBSERVATION, MONITORING (MAY REQUIRE APPROPRIATION PERMIT)

NOT TO BE FILLED IN BY DRILLER HEALTH DEPARTMENT APPROVAL

County Name: Harford... County No. A-37384... OEP Signature: [Signature]... State Health Insert S... Date Issued: 11/20/85... Co-Signature: R. Wilson... Exp. Date: 05/10/88... North Grid: 527000... East Grid: 0792000

APPROXIMATE DEPTH OF WELL: 200 FEET

APPROXIMATE DIAMETER OF WELL: 6 INCH

METHOD OF DRILLING (circle one)

- BORED (or Augered)
JETTED
Jetted & DRIVEN
AIR-ROTARY - circled
AIR-PERCussion
ROTARY (Hydraulic Rotary)
CABLE
REVERSE-ROTARY
DRIVE-POINT
other:

SHOW MAJOR FEATURES OF BOX & LOCATE WELL WITH AN X

SOURCES OF DRILLING WATER

WRITE THE BOX NUMBER FROM THE MAP HERE

Box Number: 790.2

WELL LOCATION OK DRILLER REPORTS 3" CASING 32' OPEN 20 BAGS CEMENT 12/1/86 CW.

REPLACEMENT OR DEEPEMED WELLS (CIRCLE APPROPRIATE BOX)

- THIS WELL WILL NOT REPLACE AN EXISTING WELL - circled
THIS WELL WILL REPLACE A WELL THAT WILL BE ABANDONED AND SEALED
THIS WELL WILL REPLACE A WELL THAT WILL BE USED AS A STANDBY
THIS WELL WILL DEEPEM AN EXISTING WELL
PERMIT NUMBER OF WELL TO BE REPLACED OR DEEPEMED (IF AVAILABLE):

DRAW A SKETCH BELOW SHOWING LOCATION OF WELL IN RELATION TO NEARBY TOWNS AND ROADS AND GIVE DISTANCE FROM WELL TO NEAREST ROAD JUNCTION

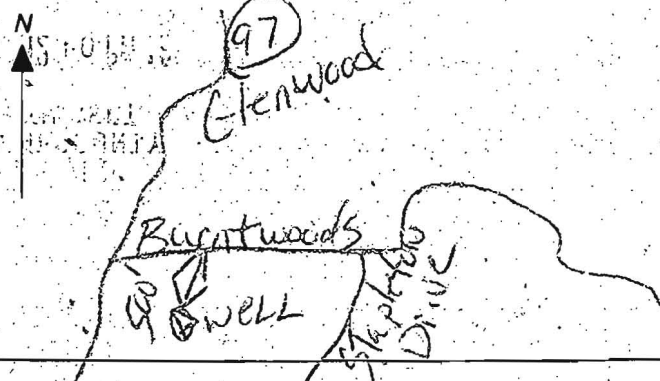

Not to be filled in by driller (OEP USE ONLY)

APPROX. PERMIT NUMBER: GAP... FORCE: [Signature]... PERMIT NO.: 10-81-1769

SPECIAL CONDITIONS

4/2/87 - ASAM

APPLICATION FOR PITLESS ADAPTER, WELL PUMP AND PRESSURE TANK INSTALLATION

Howard County Health Department
Bureau of Environmental Health
3525-H Ellicott Mills Drive
Court House Square
Ellicott City, Md. 21043
461-9933

4/2/87
inspected OK
outside covered
shaker attached (B)

New Installation X
Replacement _____

Receipt # 38408
Date 4/9/87

Name of Installer Robert L. Feezer Co. Inc.

Telephone 781-4655

License number 2122

Certified Well Pump Installer _____ Well Driller _____ Registered Plumber X

Name of Property Owner M/M Charles R. Noyes Telephone _____

Subdivision Warfield Estates Lot # 39 Well tag # H0 - 81 - 1769 ✓

Site Address 14813 Burnt Woods Road
Glenwood, Md. 21738

Pump

- 1. Type
 - a. Deep well jet _____
 - b. Shallow well jet _____
 - c. Submersible X

Motor

- 1. Horsepower 1/2
- 2. RPM 3450
- 3. Voltage
 - a. 110 _____
 - b. 220 ✓

Pitless Adapter

- 1. Make Harvard
- 2. Model # PT800
- 3. Depth 42" +

- 2. Make Griswold
- 3. Model # 3ALN-10
- 4. Capacity 8 GPM

5. Pump exceeds well capacity Yes _____ No X

6. If Yes, is low pressure cutoff switch installed? Yes _____ No _____

7. What methods are used to protect the pump and electrical wiring from vibrations? Torque arrestors _____ Cable guards X Other _____

4/2/87 was buried at inspection ground wire mounted seen - OR

Tank

- 1. Capacity 20 gal (WX-202 Well-
- 2. Pressure relief X (Trol) valve? X

Piping

- 1. Type Plastic
- 2. Size 1 1/2 black
- 3. NSF and/or BOCA Code approved X
- 4. Depth of supply line 42" +

Well data

- 1. Depth 100 ft.
- 2. Yield 10 GPM
- 3. Static water level 30 ft.
- 4. Will water supply be disinfected by installer? X

power line connected seen

4/2/87
Tank w/ relief valve in OK

I understand that it is my responsibility to notify the Howard County Health Department when the installation is ready for inspection (otherwise this permit is null and void).

All information given above is true to the best of my knowledge.

Signature of Applicant: Robert L. Feezer

Date: 4/9/87

Note: A sticker indicating approval/status of the installation will be placed on the well casing at the time of the inspection.