

Permits: 410-313-2455  
 Inspections: 410-313-1810  
 Automated Line: 410-313-3800

Howard County Building/Fire Permit Application  
 Department of Inspections, Licenses & Permits  
 3430 Court House Drive  
 Ellicott City, MD 21043

Permit Number:

Building Address: 10367 CAVEY LANE  
WOODSTOCK, MD 21163

Suite/Apt. # \_\_\_\_\_ SDP/WP/BA #: \_\_\_\_\_

Census Tract: \_\_\_\_\_ Subdivision: \_\_\_\_\_

Section: \_\_\_\_\_ Area: \_\_\_\_\_ Lot: 1C

Tax Map: 11 Parcel: 43 Grid: 13

Zoning: \_\_\_\_\_ Map Coordinates: \_\_\_\_\_ Lot Size: 5.38 AC

Existing Use: SF RESIDENTIAL

Proposed Use: \_\_\_\_\_

Estimated Construction Cost: \$ 70,000

Description of Work: 16'x20' DECK w/ 8'x44'  
WRAP AROUND DECK, STEPS, 15'x15'  
SCREENED GAZEBO, 8.5'x12' PORTICO,  
4'x12' BALCONY RESURFACE  
w/ NEW RAILING

Occupant or Tenant: \_\_\_\_\_

Was tenant space previously occupied?  Yes  No

Contact Name: \_\_\_\_\_

Address: \_\_\_\_\_

City: \_\_\_\_\_ State: \_\_\_\_\_ Zip Code: \_\_\_\_\_

Phone: \_\_\_\_\_ Fax: \_\_\_\_\_

Email: \_\_\_\_\_

Property Owner's Name: ROBERT + LINDA HOLLEY

Address: PO BOX 74

City: WOODSTOCK State: MD Zip Code: 21163

Home Phone: 410 461 5912 Work Phone: \_\_\_\_\_

Applicant's Name & Mailing Address, (if other than stated herein): \_\_\_\_\_

Phone: \_\_\_\_\_ Fax: \_\_\_\_\_

Email: \_\_\_\_\_

Contractor Company: RHINE LANDSCAPING

Contact Person: DAN MURPHY

Address: PO BOX 1825

City: SYKESVILLE State: MD Zip Code: 21784

License No.: MHIC # 121739

Phone: 410 442 2445 Fax: 410 489 4312

Email: dan@rhinelandscaping.com

Engineer/Architect Company: \_\_\_\_\_

Responsible Design Prof.: \_\_\_\_\_

Address: \_\_\_\_\_

City: \_\_\_\_\_ State: \_\_\_\_\_ Zip Code: \_\_\_\_\_

Phone: \_\_\_\_\_ Fax: \_\_\_\_\_

Email: \_\_\_\_\_

BUILDING DESCRIPTION - COMMERCIAL	
Building Characteristics	Utilities
Height:	<u>Water Supply</u>
No. of stories:	<input type="checkbox"/> Public
Gross area, sq. ft./floor:	<input type="checkbox"/> Private
	<u>Sewage Disposal</u>
Area of construction (sq. ft.):	<input type="checkbox"/> Public
	<input type="checkbox"/> Private
Use group:	Electric: <input type="checkbox"/> Yes <input type="checkbox"/> No
	Gas: <input type="checkbox"/> Yes <input type="checkbox"/> No
<u>Construction type:</u>	<u>Heating System</u>
<input type="checkbox"/> Reinforced Concrete	<input type="checkbox"/> Electric <input type="checkbox"/> Oil
<input type="checkbox"/> Structural Steel	<input type="checkbox"/> Natural Gas <input type="checkbox"/> Propane Gas
<input type="checkbox"/> Masonry	<u>Sprinkler System:</u>
<input type="checkbox"/> Wood Frame	<input type="checkbox"/> N/A
<input type="checkbox"/> State Certified Modular	<input type="checkbox"/> Full
<input checked="" type="checkbox"/> <u>Roadside Tree Project Permit</u>	<input type="checkbox"/> Partial
<input type="checkbox"/> Yes <input type="checkbox"/> No	<input type="checkbox"/> Other Suppression
<u>Roadside Tree Project Permit #</u>	No. of Heads:

BUILDING DESCRIPTION - RESIDENTIAL	
Building Characteristics	Utilities
<input checked="" type="checkbox"/> SF Dwelling <input type="checkbox"/> SF Townhouse	<u>Water Supply</u>
<u>Depth</u> <u>Width</u>	<input type="checkbox"/> Public
1 <sup>st</sup> floor:	<input checked="" type="checkbox"/> Private
2 <sup>nd</sup> floor:	<u>Sewage Disposal</u>
Basement:	<input type="checkbox"/> Public
<input type="checkbox"/> Finished Basement	<input checked="" type="checkbox"/> Private
<input type="checkbox"/> Unfinished Basement	Electric: <input type="checkbox"/> Yes <input type="checkbox"/> No
<input type="checkbox"/> Crawl Space	Gas: <input type="checkbox"/> Yes <input type="checkbox"/> No
<input type="checkbox"/> Slab on Grade	<u>Heating System</u>
No. of Bedrooms:	<input type="checkbox"/> Electric
<u>Multi-family Dwelling</u>	<input type="checkbox"/> Oil
No. of efficiency units:	<input type="checkbox"/> Natural Gas
No. of 1 BR units:	<input type="checkbox"/> Propane Gas
No. of 2 BR units:	
No. of 3 BR units:	
Other Structure:	
Dimensions:	
Footings:	<input checked="" type="checkbox"/> <u>Roadside Tree Project Permit</u>
Roof:	<input type="checkbox"/> Yes <input type="checkbox"/> No
<input type="checkbox"/> State Certified Modular	<u>Roadside Tree Project Permit #</u>
<input type="checkbox"/> Manufactured Home	

THE UNDERSIGNED HEREBY CERTIFIES AND AGREES AS FOLLOWS: (1) THAT HE/SHE IS AUTHORIZED TO MAKE THIS APPLICATION; (2) THAT THE INFORMATION IS CORRECT; (3) THAT HE/SHE WILL COMPLY WITH ALL REGULATIONS OF HOWARD COUNTY WHICH ARE APPLICABLE THERETO; (4) THAT HE/SHE WILL PERFORM NO WORK ON THE ABOVE REFERENCED PROPERTY NOT SPECIFICALLY DESCRIBED IN THIS APPLICATION; (5) THAT HE/SHE GRANTS COUNTY OFFICIALS THE RIGHT TO ENTER ONTO THIS PROPERTY FOR THE PURPOSE OF INSPECTING THE WORK PERMITTED AND POSTING NOTICES.

Dan Murphy  
 Applicant's Signature  
dan@rhinelandscaping.com  
 Email Address  
LANDSCAPE ARCHITECT  
 Title/Company

DAN MURPHY  
 Print Name  
7-22-15  
 Date

Checks Payable to: DIRECTOR OF FINANCE OF HOWARD COUNTY  
 \*\*PLEASE WRITE NEATLY & LEGIBLY\*\*  
 -FOR OFFICE USE ONLY-

AGENCY	DATE	SIGNATURE OF APPROVAL
State Highways		
Building Officials		
PSZA ( Zoning )		
PSZA ( Engineering )		
Health	<u>7-23-15</u>	<u>Dana Beard</u>
Fire Protection		

Is Sediment Control approval required for issuance?  Yes  No  
 CONTINGENCY CONSTRUCTION START  
 ONE STOP SHOP

DPZ SETBACK INFORMATION

Front: \_\_\_\_\_

Rear: \_\_\_\_\_

Side: \_\_\_\_\_

Side St.: \_\_\_\_\_

All minimum setbacks met?  Yes  No

Is Entrance Permit Required?  Yes  No

Historic District?  Yes  No

Lot Coverage for New Town Zone: \_\_\_\_\_

SDP/Red-line approval date: \_\_\_\_\_

Filing Fee	\$
Permit Fee	\$
Tech Fee	\$
Excise Tax	\$
PSFS	\$
Guaranty Fund	\$
Add'l per Fee	\$
Total Fees	\$
Sub- Total Paid	\$
Balance Due	\$

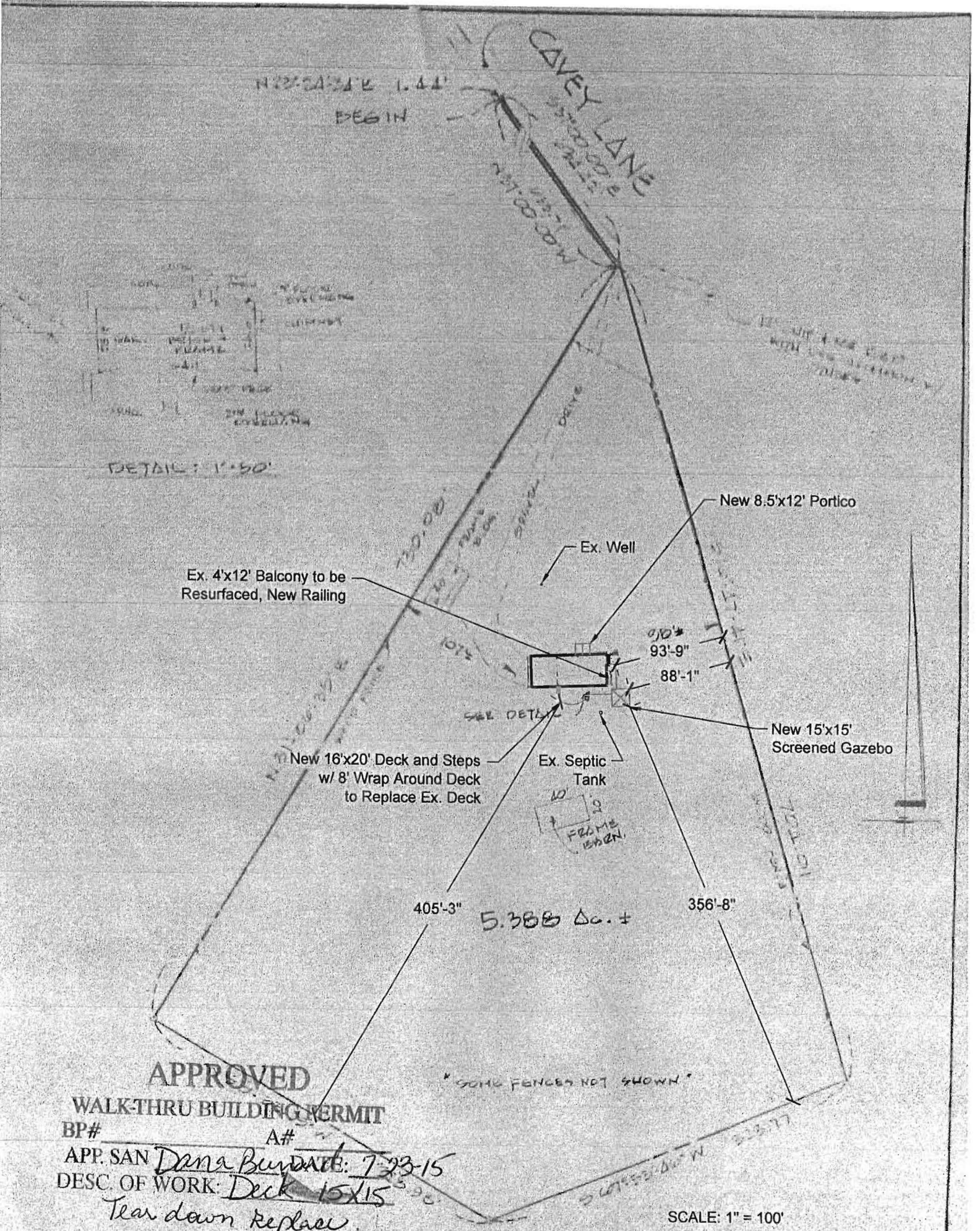

**APPROVED**

**WALK-THRU BUILDING PERMIT**

BP#

A#

APP. SAN *Dana Burdick* DATE: *7-23-15*

DESC. OF WORK: *Deck 15x15*

*Tear down Replace*

\* SOME FENCES NOT SHOWN \*

SCALE: 1" = 100'

I HEREBY CERTIFY THAT I HAVE MADE A SURVEY OF THIS LOT FOR THE PURPOSE OF LOCATING THE IMPROVEMENTS THEREON AND THAT THEY ARE LOCATED AS SHOWN

TOGETHER WITH A 30' EASEMENT FOR THE ROAD AND EGRESS, WITH THE USE OF COMMON WALLS TO BE BUILT FROM THE LOT SHOWN HEREON TO ADJACENT LOTS WHICH WAS ACQUIRED BY L. HALL, JR. BY AND FURTHER ACQUIRED BY JAMES HALL, JR. AND LIVED 847/477.

REG NO 7730

**LOCATION SURVEY**

**W. T. SADLER**  
Surveyors



507 MAIN STREET  
KEISTERSTOWN, MD.

\* 10367 CAVEY LANE  
HOWARD COUNTY, MD.

SCALE

DATE

APP. NO.

109-80



