



Building Permit Application

Howard County Maryland
Department of Inspections, Licenses and Permits
3430 Court House Drive
Permits: 410-313-2455
www.howardcountymd.gov

Date Received: _____

Permit No.: _____

Building Address: 7641 Green Dell Ln.
 City: Highland State: Md. Zip Code: 20777
 Suite/Apt. # _____ SDP/WP/BA #: _____
 Census Tract: _____ Subdivision: _____
 Section: _____ Area: _____ Lot: _____
 Tax Map: _____ Parcel: _____ Grid: _____
 Zoning: _____ Map Coordinates: _____ Lot Size: _____

Existing Use: Patio/Deck
 Proposed Use: 3 Season Rm.
 Estimated Construction Cost: \$ 80,000
 Description of Work: 3 Season Rm w/ Roof & stairs to Basement

Occupant or Tenant: Mike & Lauren Boteler
 Was tenant space previously occupied? Yes No
 Contact Name: Lee Hoffheiser
 Address: 6443 Hawthorn Ave
 City: Elkridge State: Md. Zip Code: 21075
 Phone: 443 677 9316 Fax: 443 445 3700
 Email: lee@clarksvilleconstruction.net

Property Owner's Name: Mike Boteler
 Address: 7641 Green Dell Lane
 City: Highland State: Md. Zip Code: 21075
 Phone: 410 302 2825 Fax: _____
 Email: lauren.boteler@gmail.com

Applicant's Name & Mailing Address, (If other than stated herein)
 Applicant's Name: Clarksville
 Address: _____
 City: _____ State: _____ Zip Code: _____
 Phone: _____ Fax: _____
 Email: _____

Contractor Company: Clarksville Construction
 Contact Person: Lee Hoffheiser
 Address: 9050 Red Branch Rd. Suite I
 City: Columbia State: Md. Zip Code: 21045
 License No.: 78947
 Phone: 443 306 3099 Fax: 410 531 2966
 Email: lee@clarksvilleconstruction.net

Engineer/Architect Company: _____
 Responsible Design Prof.: _____
 Address: _____
 City: _____ State: _____ Zip Code: _____
 Phone: _____ Fax: _____
 Email: _____

Commercial Building Characteristics	Residential Building Characteristics	
Height:	<input checked="" type="checkbox"/> SF Dwelling <input type="checkbox"/> SF Townhouse	
No. of stories:	Depth	Width
Gross area, sq. ft./floor:	1 st floor:	
	2 nd floor:	
Area of construction (sq. ft.):	Basement:	
	<input type="checkbox"/> Finished Basement	
Use group:	<input type="checkbox"/> Unfinished Basement	
	<input type="checkbox"/> Crawl Space	
Construction type:	<input type="checkbox"/> Slab on Grade	
<input type="checkbox"/> Reinforced Concrete	No. of Bedrooms:	
<input type="checkbox"/> Structural Steel	Multi-family Dwelling	
<input type="checkbox"/> Masonry	No. of efficiency units:	
<input type="checkbox"/> Wood Frame	No. of 1 BR units:	
<input type="checkbox"/> State Certified Modular	No. of 2 BR units:	
	No. of 3 BR units:	
	Other Structure:	
	Dimensions:	
Roadside Tree Project Permit	Footings:	
<input type="checkbox"/> Yes <input type="checkbox"/> No	Roof:	
Roadside Tree Project Permit #	<input type="checkbox"/> State Certified Modular	
	<input type="checkbox"/> Manufactured Home	

Utilities	
Water Supply	
<input type="checkbox"/> Public	
<input checked="" type="checkbox"/> Private	
Sewage Disposal	
<input type="checkbox"/> Public	
<input checked="" type="checkbox"/> Private	
Electric: <input checked="" type="checkbox"/> Yes <input type="checkbox"/> No	
Gas: <input type="checkbox"/> Yes <input type="checkbox"/> No	
Heating System	
<input checked="" type="checkbox"/> Electric <input type="checkbox"/> Oil	
<input type="checkbox"/> Natural Gas <input type="checkbox"/> Propane Gas	
<input type="checkbox"/> Other: _____	
Sprinkler System:	
<input type="checkbox"/> Yes <input checked="" type="checkbox"/> No	
Grading Permit Number: _____	
Building Shell Permit Number: _____	

THE UNDERSIGNED HEREBY CERTIFIES AND AGREES AS FOLLOWS: (1) THAT HE/SHE IS AUTHORIZED TO MAKE THIS APPLICATION; (2) THAT THE INFORMATION IS CORRECT; (3) THAT HE/SHE WILL COMPLY WITH ALL REGULATIONS OF HOWARD COUNTY WHICH ARE APPLICABLE THERETO; (4) THAT HE/SHE WILL PERFORM NO WORK ON THE ABOVE REFERENCED PROPERTY NOT SPECIFICALLY DESCRIBED IN THIS APPLICATION; (5) THAT HE/SHE GRANTS COUNTY OFFICIALS THE RIGHT TO ENTER ONTO THIS PROPERTY FOR THE PURPOSE OF INSPECTING THE WORK PERMITTED AND POSTING NOTICES.

Applicant's Signature: [Signature]
 Email Address: lee@clarksvilleconstruction.net
 Title/Company: Foreman/Clarksville Construction

Print Name: Lee Hoffheiser
 Date: 10/7/15

Checks Payable to: DIRECTOR OF FINANCE OF HOWARD COUNTY
 PLEASE WRITE NEATLY & LEGIBLY
 -FOR OFFICE USE ONLY-

AGENCY	DATE	SIGNATURE OF APPROVAL
State Highways		
Building Officials		
PSZA (Zoning)		
PSZA (Engineering)		
Health	<u>10/14/15</u>	<u>[Signature]</u>

Is Sediment Control approval required for issuance? Yes No
 CONTINGENCY CONSTRUCTION START

DPZ SETBACK INFORMATION
Front:
Rear:
Side:
Side St.:
All minimum setbacks met? <input type="checkbox"/> Yes <input type="checkbox"/> No
Is Entrance Permit Required? <input type="checkbox"/> Yes <input type="checkbox"/> No
Historic District? <input type="checkbox"/> Yes <input type="checkbox"/> No
Lot Coverage for New Town Zone:
SDP/Red-line approval date:

Filing Fee	\$
Permit Fee	\$
Tech Fee	\$
Excise Tax	\$
PSFS	\$
Guaranty Fund	\$
Add'l per Fee	\$
Total Fees	\$
Sub-Total Paid	\$
Balance Due	\$
Check	# <u>6186</u>

SCALE: 1'

LOT 27
3.746 AC.

V - 441.46'

30'-0"

APPROVED
WALK-THRU BUILDING PERMIT
 RP# _____ A# _____
 APP. SAN *Buckley* DATE: *10/13/2015*
 DESC. OF WORK *3 season room w/ roof & stairs to basement*

S 15° 59' 24" W - 277.00'

RMIT

E:

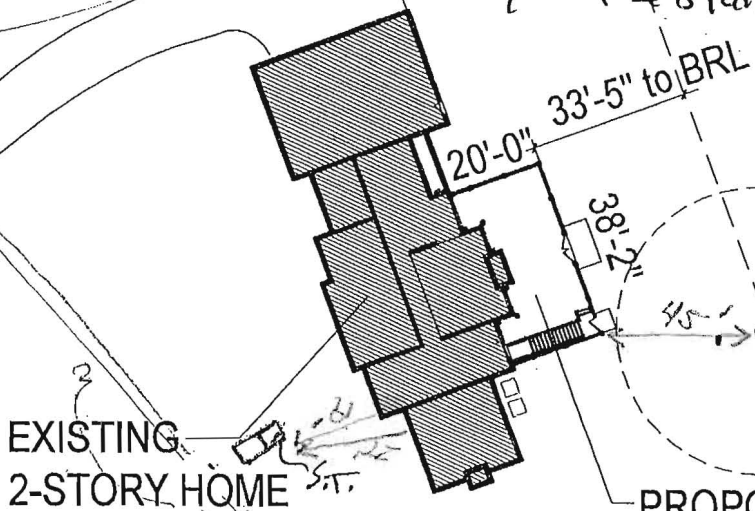

40-81-1653
 Plastic ease, 23" above soil
 2-pc plastic cap.
 Conduit OK

DELL LANE

ppook,
SDA

ING RESTRICTION LINE

PRIVATE DRIVE

60'-0"

30'-0"