

SYSTEM TO BE INSTALLED FIRST BEFORE BUILDING PERMIT CAN BE SIGNED.

8-8-79 APPROVED

PERMIT

SEWAGE DISPOSAL SYSTEM

MARYLAND STATE DEPARTMENT OF HEALTH*

HOWARD COUNTY

ELLICOTT CITY

DISTRICT 8TH

DATE 3/27/79

INDEXED

P 29617

A 28859 23859

4/6/79 8/8/79

Brantly Development IS PERMITTED TO INSTALL ALTER

ADDRESS 218 Teachers Building, Columbia, Md. 21044 PHONE 730-0810

SUBDIVISION Brantly ROAD Brantly Road LOT 10, Sec. 2

PROPERTY OWNER Brantly Development

ADDRESS same as above

SPECIFICATIONS 3 bedrooms

SEPTIC TANK CAPACITY 1000 GALLONS

DRAIN FIELD _____ DEPTH _____ FEET. BOTTOM AREA _____ SQ. FT.

DEEP TRENCH _____ DEPTH _____ FEET. BOTTOM AREA _____ SQ. FT.

SEEPAGE PITS ABSORBENT SIDE-WALL AREA 160 SQ. FT. per bedroom.

INLET PIPE 4 FT. BELOW ORIGINAL GRADE. MAXIMUM DEPTH 10 FT. BELOW ORIGINAL GRADE

EFFECTIVE DEPTH AT _____ FT. BELOW ORIGINAL GRADE.

LOCATE DISPOSAL AREA 215 FT. FROM 105 LOT LINE AND 15 FT. FROM 360 LOT LINE AS SEEN WHEN

~~XXXXXXXXXXXX~~

Begin the trench 5 ft. from the edge of the dry well and follow the contour of the land. The trench will be 2 ft. wide, 10 ft. deep, with 6 ft. of stone under pipe.

PLANS APPROVED BY Robert T. Moorefield DATE 8/22/77

COVER NO WORK UNTIL INSPECTED AND APPROVED.

NEITHER THE HOWARD COUNTY COUNCIL NOR THE HEALTH DEPARTMENT IS RESPONSIBLE FOR THE SUCCESSFUL OPERATION OF ANY SYSTEM.

NOTE: IF TRENCH IS USED CALL FOR INSPECTION BEFORE PLACING GRAVEL IN TRENCH.

NOTE: NO DRY WELL SHALL EXCEED 15 FOOT IN DIAMETER.

NOTE: ALL PIPE FROM HOUSE TO DISPOSAL AREA MUST BE CAST IRON.

PERMIT VOID AFTER THREE YEARS.

NOTE: INSTALL STAND PIPE ON SEPTIC TANK AND DRY WELL. STAND PIPES MUST BE 6 INCHES IN DIAMETER. CAST IRON, CONCRETE OR TERRA COTTA ACCEPTED.

BLDG. PERMIT SIGNED

AND RETURNED 4/19/79

Serial No. 38980

A 23859

*INSTALLER IS RESPONSIBLE FOR OBTAINING FINAL APPROVAL ON THIS PERMIT.

A23854

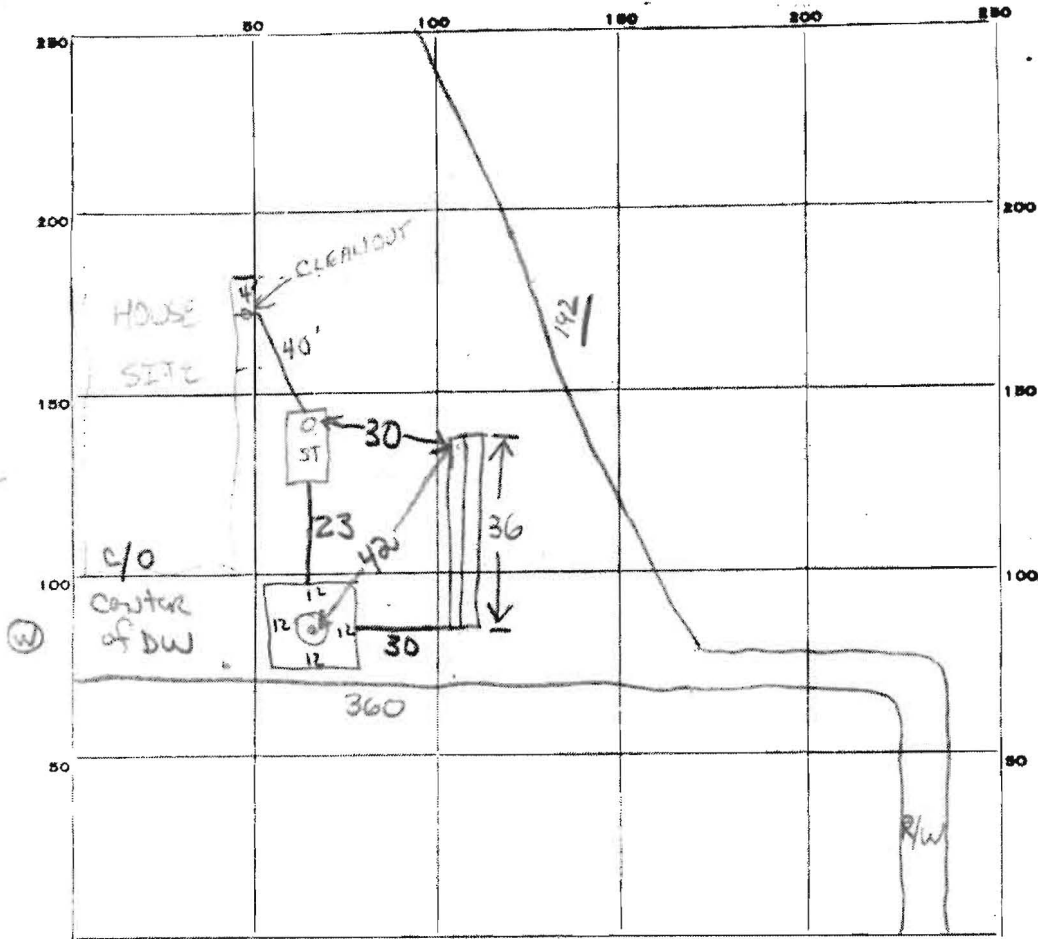

INDICATE NORTH. - NAME ADJOINING ROADWAY AS BASE LINE.

PERMIT CARD installer 4/10
 SEPTIC TANK, LEVEL 1000 rectangular
 DISTRIBUTION BOX, LEVEL Na
 TILE FIELD, DEPTH 10 FT. TRENCH WIDTH 2 FT.
 GRAVEL DEPTH 6 FT. TOTAL LENGTH 36 FT.
 NUMBER OF TRENCHES 1 TOTAL BOTTOM AREA 216 ±
 SEEPAGE PITS, INSIDE DIAMETER ±48 FT. DEPTH BELOW INLET 6 FT.
 ABSORBENT AREA ±504 SQ. FT.

BRANTLY RD

2x2' sections ST DW 3x2' sections
 CLEANOUTS terra cotta

REMARKS 6 Apr 79 - No plat available - checked with contractor's site plan. All
house corners, "system", 3 setbacks staked off at site. Call for inspection when
sewers, cleanouts, gravel & distribution pipe are installed. (GLK)
Next inspector should triangulate measurements as per notes. (GLK)
10 Apr 79 - OK to backfill. Call when house connection installed (GLK)
12 Apr 79 - OK TO COVER ALL WORK P.D.

DATE SYSTEM APPROVED 8-8-79 INSPECTOR R. DeMarco