

PUB. SEWER STATUS VERIFIED BY _____

ISSUE DATE: 5/6/04

APPROVAL DATE: 5/28/04

PERMIT INDEXED

P520388

A REPAIR

Layout with Kacie

ON-SITE SEWAGE DISPOSAL SYSTEM HOWARD COUNTY HEALTH DEPARTMENT BUREAU OF ENVIRONMENTAL HEALTH

IS PERMITTED TO INSTALL ALTER

ADDRESS: 7101 Braeburn Road PHONE NUMBER: _____

SUBDIVISION: Braeburn LOT NUMBER: 17

ADDRESS: 10870 Braeburn Road PROPERTY OWNER: Vickers

SEPTIC TANK CAPACITY (GALLONS): 1000

PUMP CHAMBER CAPACITY (GALLONS): N/A

NUMBER OF BEDROOMS: 3

SQUARE FEET PER BEDROOM: 180

LINEAR FEET OF TRENCH REQUIRED: 80⁺

*highest trench perc hole (A)
@ 5-6' ±
lowest trench perc hole (B)
@ 3'*

low trench High trench - 6.0 feet

TRENCHES:	Trench to be 3.0 feet wide. Inlet 4.0 feet below original grade. Bottom maximum depth 8.0 feet below original grade. Effective area begins at various feet below original grade. <u>8</u> feet of stone below distribution pipe.
LOCATION:	Run two 40' long trenches on contour at the location of the percolation test holes. Fill the existing dry well with clean #2 stone and place a monitoring pvc pipe in its center. Set the leveler inside the d. box to a higher position to allow overflow when new system fails.
PURPOSE:	<i>SIGN BPO0147428 After Septic Installation, Kitchen Remodeler to use east side for egress/ingress to back side of house.</i>

*Proposed
SEE
BACK
File*

PLANS APPROVED: KN DATE: 5/6/04

- NOTE: PERMIT VOID AFTER 2 YEARS
- NOTE: CONTRACTOR RESPONSIBLE FOR SCHEDULING A PRE-CONSTRUCTION INSPECTION FOR ALL INSTALLATIONS
- NOTE: WATERTIGHT SEPTIC TANKS REQUIRED
- NOTE: ALL PARTS OF SEPTIC SYSTEM SHALL BE 100 FEET FROM ANY WATER WELL
- NOTE: MANHOLE RISERS REQUIRED ON ALL SEPTIC TANKS AND PUMP CHAMBERS

NEITHER THE HOWARD COUNTY COUNCIL OR THE HEALTH DEPARTMENT IS RESPONSIBLE FOR THE SUCCESSFUL OPERATION OF ANY SYSTEM PERMITTEE RESPONSIBLE FOR OBTAINING FINAL APPROVAL ON THIS PERMIT CALL 410-313-2640 FOR INSPECTION OF SEPTIC SYSTEM

SEE ATTACHED SPECS

P520388

May 7, 2004

Dear Ms. Vickers:

The permit may be hard to follow due to its design for trenches to be dug with an inlet at one depth. The first trench, in order to allow gravitational fall from the septic tank, will have an inlet approximately at 6' with the bottom at 8'. The second trench location has effective soils higher up to the surface of the ground, and the ground is at a lower elevation level compared to the first trench location. Eighty feet of linear trench is required when averaging the absorption areas. Mr. Jenkins is to call me for the layout so we can shoot topo together and ensure correct placement from the septic tank.

I would also recommend to have the existing baffles in the septic tank looked at to ensure they are still useable unless they have been checked recently in the past. (By seeing a pvc cleanout on the septic line running to the dry well, I assume a previous repair to the line had been done, and thus terra cotta baffles have been replaced if necessary.)

According to Mr. Jenkins, he said he would be able to schedule the repair for the upcoming Thursday or Friday. If you have any other questions, please call 410-313-1775.

Sincerely,



Kacie Noonan, R.S.

Attn: Kacie Noonan
410-313-2648 fax
410-313-1775

Murray & Peggy Vickers
10870 Braeburn Rd
Columbia, MD 21044
410-531-2629 Home
443-896-2389 Peggy Office
301-688-9954 Murray Office

To Whom It May Concern:

The property referenced in this memo is 10870 Braeburn Road, Columbia, MD 21044. Gawthrop Construction, is the general contractor who will be adding onto the back of this property. During this construction they will be using the right side of the house to access the construction site. The septic system is located on the left side of the house and will remain clear and not used throughout the project.

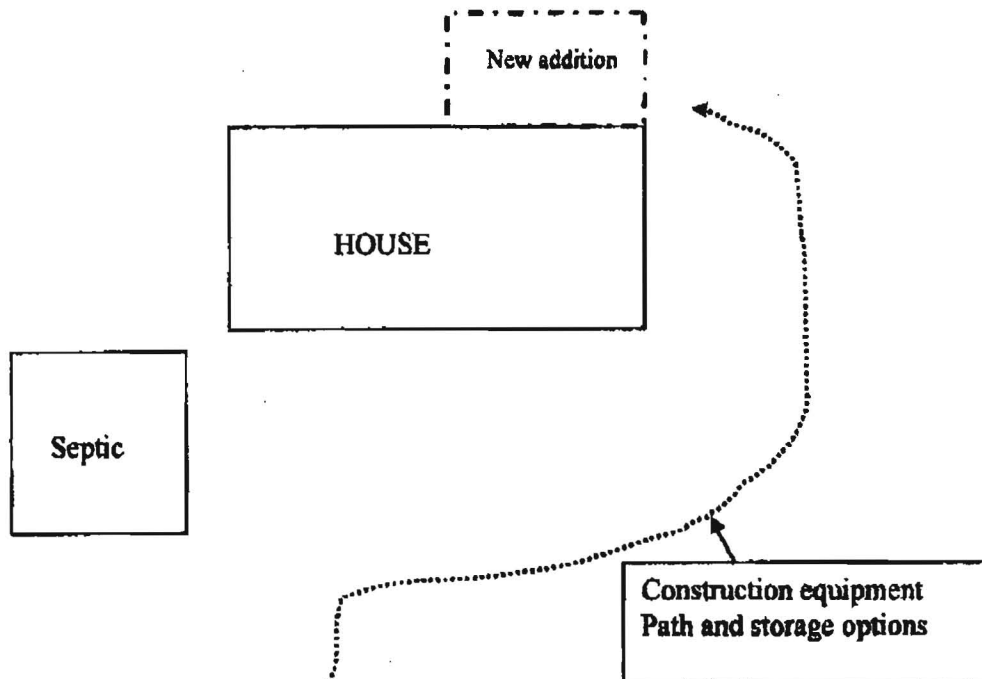

Bill Collins of Collins Construction will be doing the septic system trench repairs. This work will commence before June 1 and be complete shortly thereafter.

Gawthrop Construction, Inc.
133334 Folly Quarter Rd
Ellicott City, MD 21042
410-531-6413

Collins Construction, Inc
06 Valencia Ave
Moriarty NM, 87035
505-321-0217

Thank-You,

Peggy S. Vickers 5/10/04