

11/15/00  
10 = 00  
11/16/00  
In Progress  
13/01  
Pumped  
PH

# PERMIT

P 514272-A

## SEWAGE DISPOSAL SYSTEM

A 57577

HOWARD COUNTY HEALTH DEPARTMENT

BUREAU OF ENVIRONMENTAL HEALTH

ISSUE DATE 9/25/2000

TAX ID# 05-432022 410-313-2640

APPROVAL DATE 2/13/01

### INDEXED

Fogles Septic Clean, Inc. IS PERMITTED TO INSTALL X ALTER

ADDRESS 580 Obrecht Road, Sykesville, MD 21784 PHONE 410-795-5670

DIVISION Big Branch Overlook LOT NUMBER 15 ADDRESS 14069 Big Branch Drive

PROPERTY OWNER Big Branch Overlook LLC PROPERTY OWNER'S ADDRESS 7164 Columbia Gateway Dr

SEPTIC TANK CAPACITY 1500 GALLONS Ste 230, Columbia, MD 21046

PUMP CHAMBER CAPACITY 1500 GALLONS

NUMBER OF BEDROOMS 5

SQUARE FEET PER BEDROOM 210

FEET OF TRENCH REQUIRED 350

**\*\* TOP SEAMED SEPTIC TANK REQUIRED \*\***  
**\*\* COMPARTMENTED TANK WITH OUTLET BAFFLE FILTER REQUIRED \*\***  
**\*\* TOP SEAMED PUMP CHAMBER REQUIRED \*\***  
**(ONE COMPARTMENT)**

INCHES: Trenches to be 3 feet wide. Inlet 3 feet below original grade. Bottom maximum depth 5 feet below original grade. 2 feet of stone below distribution box.

LOCATION: Place distribution box on high edge of designated septic area, approximately 80 - 90 feet from left lot line and 25 - 30 feet from rear lot line. Install trenches (5@70') along contour in both directions.

\* Septic tank and pump pit location to be adjusted as necessary to be away from influence of drainage swale.\*

**KEEP TRENCHES 7' EDGE TO EDGE IF CONTOUR ALLOWS TO CONSERVE FUTURE REPAIR AREA**

PERMITS APPROVED Craig Williams OK SRK 9/25/00 DATE 8/8/2000

PERMIT VOID AFTER 2 YEARS

NOTE: CONTRACTOR RESPONSIBLE FOR SCHEDULING A PRE-CONSTRUCTION INSPECTION FOR ALL INSTALLATIONS

NOTE: TOP OF SEPTIC TANKS ARE TO BE NO DEEPER THAN 3.0 FEET BELOW FINISH GRADE

NOTE: WATERTIGHT SEPTIC TANKS REQUIRED

NOTE: CLEANOUT REQUIRED EVERY 70 FEET OF SEWER LINE AND/OR AT 90° SWEEPS IN LINES FROM HOUSE TO DRAIN FIELDS, 90° ELBOWS ARE NOT ACCEPTABLE

NOTE: ALL PARTS OF SEPTIC SYSTEMS (I.E. TANK, DISTRIBUTION BOX, DRAINFIELDS) TO BE 100 FEET FROM BUILDING PERMITS SIGNED OTHERWISE SPECIFICALLY AUTHORIZED

NOTE: NO ABSORPTION TRENCH TO EXCEED 100 FEET IN LENGTH UNLESS SPECIFICALLY AUTHORIZED

NOTE: ALL PIPE FROM HOUSE TO SEPTIC TANK MUST BE CAST IRON OR SCHEDULE 35/40 PVC OR ABS

NOTE: MANHOLE RISERS REQUIRED ON ALL SEPTIC TANKS AND PUMP CHAMBERS

NOTE: DISTRIBUTION BOXES MUST HAVE BAFFLES

NOTE: IF PUMPED SEPTIC SYSTEM REQUIRED, (1) SEPTIC PUMP DETAIL TO BE PROVIDED BY INSTALLER PRIOR TO ISSUANCE OF SEPTIC PERMIT (2) PUMP PERFORMANCE TEST IS NECESSARY PRIOR TO HEALTH DEPARTMENT APPROVAL OF SEPTIC PERMIT

**BUILDING PERMITS SIGNED AND RETURNED**  
102004 800 150 846 DECK

NEITHER THE HOWARD COUNTY COUNCIL NOR THE HEALTH DEPARTMENT IS RESPONSIBLE FOR THE SUCCESSFUL OPERATION OF ANY SYSTEM

PERMITTEE RESPONSIBLE FOR OBTAINING FINAL APPROVAL ON THIS PERMIT  
CALL 410-313-2640 FOR INSPECTION OF SEPTIC SYSTEM

NOT TO SCALE

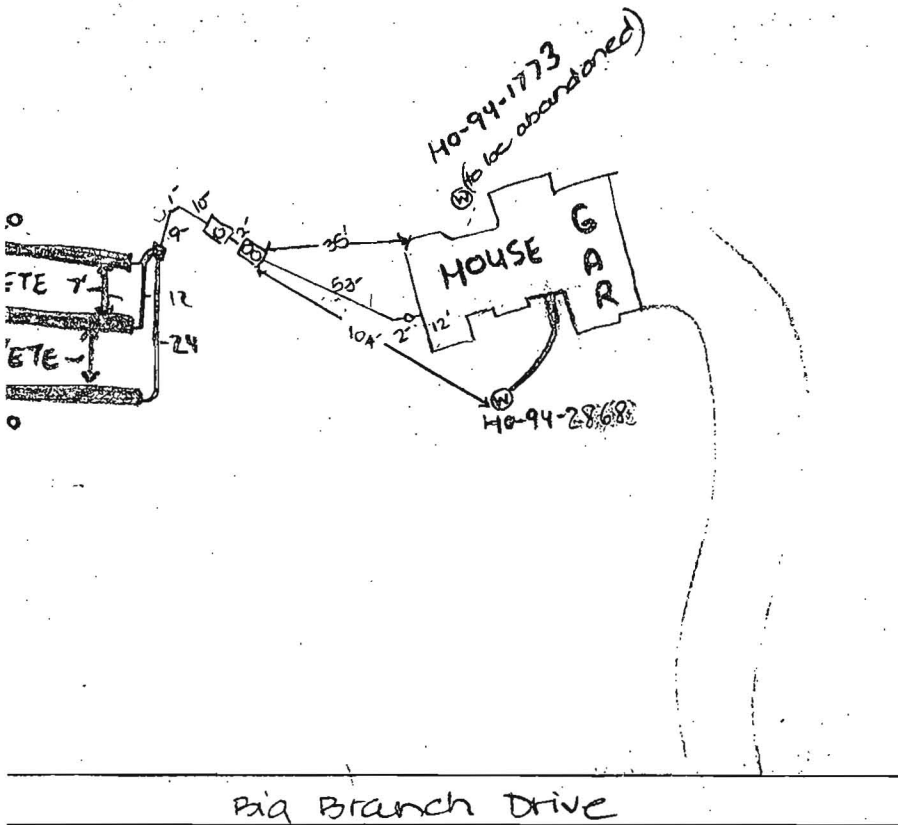

TRENCH DATA	
TRENCH WIDTH	<u>3'</u>
TRENCH INLET DEPTH	<u>3'</u>
TRENCH BOTTOM DEPTH	<u>5'</u>
DEPTH OF STONE	<u>2'</u>
NUMBER OF TRENCHES	<u>3</u>
TOTAL TRENCH LENGTH	<u>360'</u> → 3*
ABSORBENT AREA	<u>1080 ft<sup>2</sup></u>
DISTRIBUTION BOX LEVEL	<input checked="" type="checkbox"/>
MONITORING PIPE 1.5 IN	<input checked="" type="checkbox"/>
BAFFLE IN DISTRIBUTION BOX	<input checked="" type="checkbox"/>

SEPTIC TANK DATA	
SEPTIC TANK	<u>1500</u> <sup>TS</sup> GALLONS
OUTLET FILTER IN.	<input checked="" type="checkbox"/>
MANHOLE RISER	<input checked="" type="checkbox"/>
BAFFLES IN	<input checked="" type="checkbox"/>
6 INCH INSPECTION PORT	<u>N/A</u>
PUMP CHAMBER DATA	
PUMP CHAMBER GALLONS	<u>1500</u> <sup>TS</sup>
MANHOLE RISER	<input checked="" type="checkbox"/>
ALARM	<input checked="" type="checkbox"/>
PUMP PERFORMANCE TEST	<input checked="" type="checkbox"/>

RE-CONSTRUCTION INSPECTION: 11/15/00 layout check confirmed - tanks OK, SDA staked. DKC

INSPECTION COMMENTS: 11/15/00 P.M. OK to cover from house  
11/6/00 - OK TO COVER ALL WORK, PUMP PERFORMANCE TEST & ALARM. SIGNAL NEEDED (SRW) 2/13/01 Pump and alarm working. (BB)

INSPECTOR B. Baker DATE SYSTEM APPROVED 2/13/01