



Building Permit Application

Howard County Maryland
Department of Inspections, Licenses and Permits
3430 Court House Drive
Permits: 410-313-2455
www.howardcountymd.gov

Date Received:

Permit No.: B13001322

Building Address: 12402 Benson Branch Rd
City: Ellicott City State: MD Zip Code: 21042
Suite/Apt. # SDP/WP/BA #:
Census Tract: Subdivision: Woodmark
Section: Area: Lot:
Tax Map: 022 Parcel: 62 Grid: 0187
Zoning: R-20 Map Coordinates: Lot Size: 1.08 AC

Property Owner's Name: ALTON Clark
Address: 12402 Benson Branch Rd
City: Ellicott City State: MD Zip Code: 21042
Phone: 443-8194-7227 Fax:
Email:

Applicant's Name & Mailing Address, (If other than stated herein)
Applicant's Name:
Address:
City: State: Zip Code:
Phone: Fax:
Email:

Contractor Company: Design Build Remodeling Group of MD
Contact Person: Tom Siner
Address: 6229 Sikesville Rd
City: Ellicott City State: MD Zip Code: 21784
License No.: 129933
Phone: Fax:
Email:

Engineer/Architect Company: Merchant McDonald
Responsible Design Prof.: Merchant M. McDonald #9862
Address:
City: State: Zip Code:
Phone: Fax:
Email:

Existing Use: SFD
Proposed Use: SFD
Estimated Construction Cost: \$ 80,000
Description of Work: Interior Alterations -
Remodel Kitchen & Dining Rm
Construct new screen porch, deck & covered
Occupant or Tenant: ALTON Clark 7336A
Was tenant space previously occupied? Yes No
Contact Name: Thomas Siner
Address: 6229 Sikesville Rd
City: Ellicott City State: MD Zip Code: 21784
Phone: 443-827-8503 Fax:
Email: tom.siner@designbuildremodelgroup.com

Table with 2 columns: Commercial Building Characteristics, Residential Building Characteristics. Includes rows for Height, No. of stories, Gross area, Area of construction, Use group, Construction type, Reinforced Concrete, Structural Steel, Masonry, Wood Frame, State Certified Modular, Roadside Tree Project Permit, etc.

Table with 2 columns: Utilities, Heating System, Sprinkler System, Grading Permit Number, Building Shell Permit Number. Includes rows for Water Supply, Sewage Disposal, Electric, Gas, Heating System, etc.

THE UNDERSIGNED HEREBY CERTIFIES AND AGREES AS FOLLOWS: (1) THAT HE/SHE IS AUTHORIZED TO MAKE THIS APPLICATION; (2) THAT THE INFORMATION IS CORRECT; (3) THAT HE/SHE WILL COMPLY WITH ALL REGULATIONS OF HOWARD COUNTY WHICH ARE APPLICABLE THERETO; (4) THAT HE/SHE WILL PERFORM NO WORK ON THE ABOVE REFERENCED PROPERTY NOT SPECIFICALLY DESCRIBED IN THIS APPLICATION; (5) THAT HE/SHE GRANTS COUNTY OFFICIALS THE RIGHT TO ENTER ONTO THIS PROPERTY FOR THE PURPOSE OF INSPECTING THE WORK PERMITTED AND POSTING NOTICES.
Applicant's Signature: Tom Siner
Print Name: TOM SINER
Email Address: Tom.Siner@designbuildremodelgroup.com
Date: 4-9-13
Title/Company: Client Specialist / DBRG

Checks Payable to: DIRECTOR OF FINANCE OF HOWARD COUNTY
PLEASE WRITE NEATLY & LEGIBLY
-FOR OFFICE USE ONLY-

Table with 3 columns: AGENCY, DATE, SIGNATURE OF APPROVAL. Includes rows for State Highways, Building Officials, PSZA (Zoning), PSZA (Engineering), Health.

Table with 2 columns: DPZ SETBACK INFORMATION, SDP/Red-line approval date. Includes rows for Front, Rear, Side, Side St., All minimum setbacks met?, Is Entrance Permit Required?, Historic District?, Lot Coverage for New Town Zone.

Table with 2 columns: Fee Name, Amount. Includes rows for Filing Fee, Permit Fee, Tech Fee, Excise Tax, PSFS, Guaranty Fund, Add'l per Fee, Total Fees, Sub- Total Paid, Balance Due, Check.

PLANS RECEIVED

Distribution of Copies: White: Building Officials Green: PSZA,Zoning Yellow: PSZA,Engineering Pink: Health Gold: SHA

T:\Operations\Updated Forms\Building applmp 8.2012.docx

ON FILE W/PLAN REVIEW CLK # 11028



APPROVED

WALK-THRU BUILDING PERMIT

BP# B13001322 A# 14734

APR SAN HS DATE: 4-10-13

DESC. OF WORK: Ex. Kitchen remodel, screen porch & replace deck

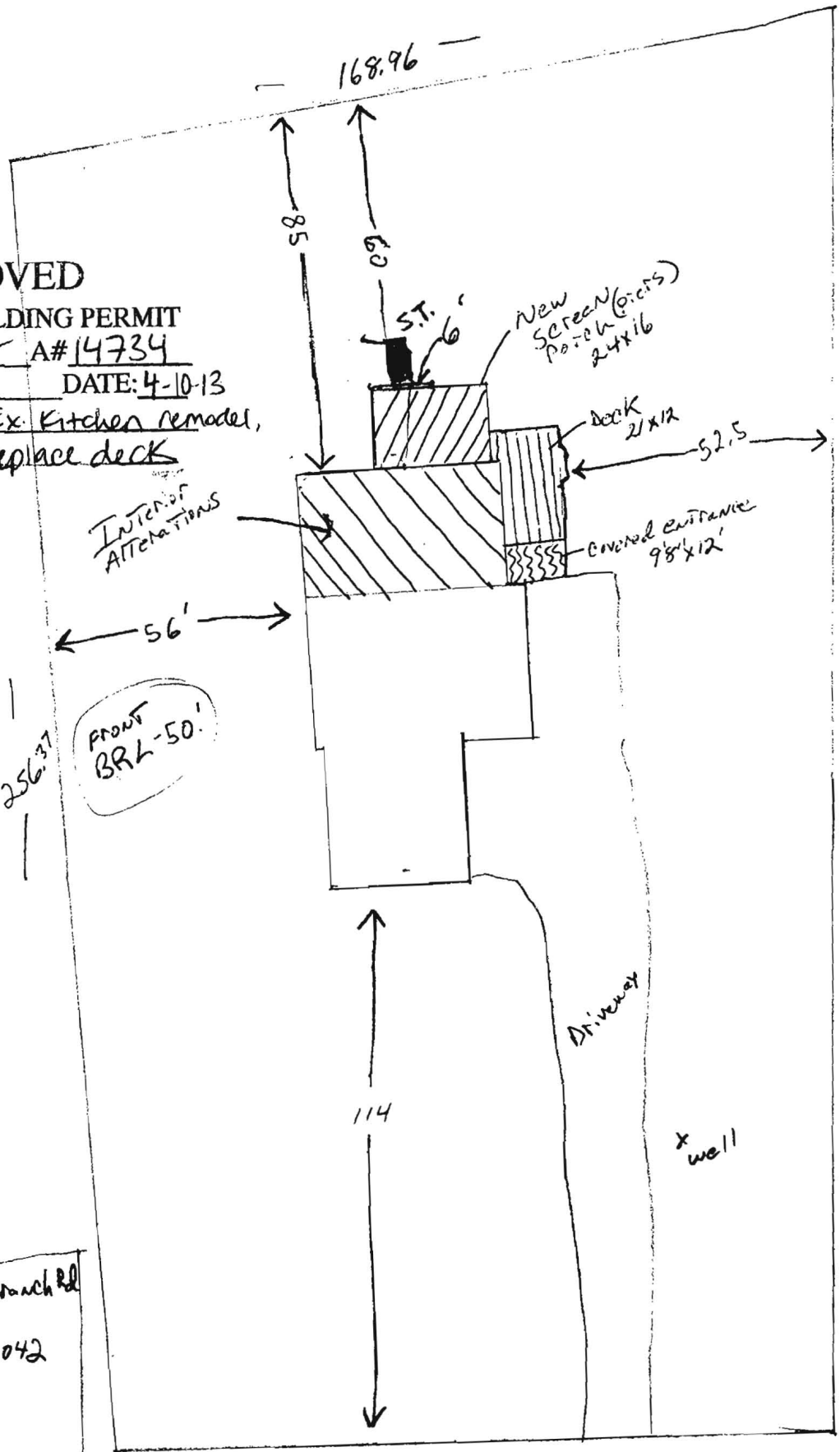

Benson Branch Road

12402 Benson Branch Rd
ELLICOTT CITY, MD
21042

LOT 62
WOODMARK
MAP 22

R-20
30' REAR
10' SIDE
50' FRONT

PANS SPRING CT

1" = 30'



DEPARTMENT OF INSPECTIONS, LICENSES & PERMITS

DECK ATTACHMENT AFFIDAVIT OF COMPLIANCE

Building Permit Serial Number: B13-1322

To: The Building Official of Howard County, Maryland

I, Tom Siner, the undersigned, am the owner, builder, deck contractor, or owner's agent of the dwelling located at: 12402 Benson Branch Rd, Ellicott City, MD 21042

I understand and accept the responsibility for compliance with the Howard County Deck Attachment Guide procedure related to the construction and attachment of decks to existing dwellings.

FOR ALL NEW DECK CONSTRUCTION ONE OF THE FOLLOWING MUST BE CHECKED:

- YES [checked] The dwelling has a conventional, solid sawn 2x 8' lumber floor framing system (including rim joist). The new or replacement deck will be attached directly to this conventional 2x__ lumber rim joist. By checking this response, I understand that the deck may be attached using any of the deck attachment methods indicated on the Howard County Deck Attachment Guide) and agree to use one of these methods.
NO The dwelling does not have a conventional, solid sawn 2x__ lumber floor framing system (including rim joist). By checking this response, I understand that only deck attachment method #2 (ledger supported by additional structural support, lagged into house foundation wall) or #3 (independent beam & column system) may be used, as indicated on the Howard County Deck Attachment Guide, and I agree to use one of these two methods.
NO I do not know whether the dwelling has a conventional, solid sawn 2x__ lumber floor framing system (including rim joist). By checking this response, I understand that only deck attachment method #2 (ledger supported by additional structural support, lagged into house foundation wall) or #3 (independent beam & column system) may be used, as indicated on the Howard County Deck Attachment Guide, and I agree to use one of these two methods.

I solemnly affirm under the penalties of perjury and upon personal knowledge that the contents of the foregoing paper are true.

Signature Tom Siner Date 4-9-13
Print Name Tom Siner Address: 6229 Sykesville Rd

White: Department

Yellow: Inspector

Pink: Owner

21784

T:\Updated Forms\deck attachment affidavit of compliance.wpd - June 2008