



URGENT RUSH!!!

APPLICATION

FOR PERCOLATION TESTING AND SITE EVALUATION

TEST DATE(S) _____ TEST TIME _____ A/P _____

AGENCY REVIEW: _____ DATE _____

DO NOT WRITE ABOVE THIS LINE

HEREBY APPLY FOR THE NECESSARY TESTING/EVALUATION PRIOR TO ISSUANCE OF SEWAGE DISPOSAL SYSTEM PERMIT(S) TO:

CHECK AS NEEDED:

- CONSTRUCT NEW SEPTIC SYSTEM(S)
- REPAIR/ADD TO AN EXISTING SEPTIC SYSTEM
- REPLACE AN EXISTING SEPTIC SYSTEM

CHECK AS NEEDED:

- NEW STRUCTURE(S)
- ADDITION TO AN EXISTING STRUCTURE
- REPLACE AN EXISTING STRUCTURE

CHECK ONE:

- CREATE NEW LOT(S)
- BUILD ON AN EXISTING LOT IN A SUBDIVISION
- BUILD ON AN EXISTING PARCEL OF RECORD

IS THE PROPERTY WITHIN 2500' OF ANY RESERVOIR?

- YES
- NO

THE TYPE OF STRUCTURE IS:

- RESIDENTIAL WITH same PROPOSED BEDROOMS IN THE COMPLETED STRUCTURE (NOTE **UNKNOWN** IF APPROPRIATE)
- COMMERCIAL (PROVIDE DETAIL OF NUMBERS AND TYPES OF EMPLOYEES/ CUSTOMERS ON ACCOMPANYING PLAN)
- INSTITUTIONAL/GOVERNMENT (PROVIDE DETAIL OF NUMBERS AND TYPES OF EMPLOYEES/USERS ON ACCOMPANYING PLAN)

PROPERTY OWNER(S) MARK + MARY ELLEN AMTOWER

DAYTIME PHONE 301-854-9187 CELL _____ FAX _____

MAILING ADDRESS 13491 Allnuttt Lane Highland Md. 20777
STREET CITY/TOWN STATE ZIP

APPLICANT Zepp Plumbing + Heating, Inc. (Eddy Zepp)

DAYTIME PHONE 410-531-6712 CELL 443-864-3101 FAX 410-531-5812

MAILING ADDRESS P.O. Box 512 Clarksville Md. 21029
STREET CITY/TOWN STATE ZIP

APPLICANT'S ROLE: DEVELOPER BUILDER BUYER RELATIVE/FRIEND REALTOR CONSULTANT

Plumber

PROPERTY LOCATION
SUBDIVISION/PROPERTY NAME Allnuttt Farms 13491 Allnuttt Lane LOT NO. _____

PROPERTY ADDRESS 13491 Allnuttt La. Highland
STREET TOWN/POST OFFICE

MAP PAGE(S) _____ GRID _____ PARCEL(S) _____ PROPOSED LOT SIZE _____

APPLICANT, I UNDERSTAND THE FOLLOWING: THE SYSTEM INSTALLED SUBSEQUENT TO THIS APPLICATION IS ACCEPTED ONLY UNTIL PUBLIC SEWERAGE IS AVAILABLE. THIS APPLICATION IS COMPLETE WHEN ALL APPLICABLE FEES AND A COMPLETE SITE PLAN HAVE BEEN RECEIVED. I ACCEPT THE RESPONSIBILITY FOR COMPLIANCE WITH ALL M.O.S.H.A. AND "S AND UTILITY" REQUIREMENTS. APPROVAL IS BASED UPON SATISFACTORY REVIEW OF A PERC CERTIFICATION PLAN.

RESULTS WILL BE MAILED TO APPLICANT.

Eddy W. Zepp, IV
SIGNATURE OF APPLICANT

HOWARD COUNTY HEALTH DEPARTMENT, BUREAU OF ENVIRONMENTAL HEALTH, WELL AND SEPTIC PROGRAM
7178 COLUMBIA GATEWAY DRIVE COLUMBIA, MARYLAND 21046 (410) 313-1771 FAX (410) 313-2648
TDD (410) 313-2323 TOLL FREE 1-877-4MD-DHMH

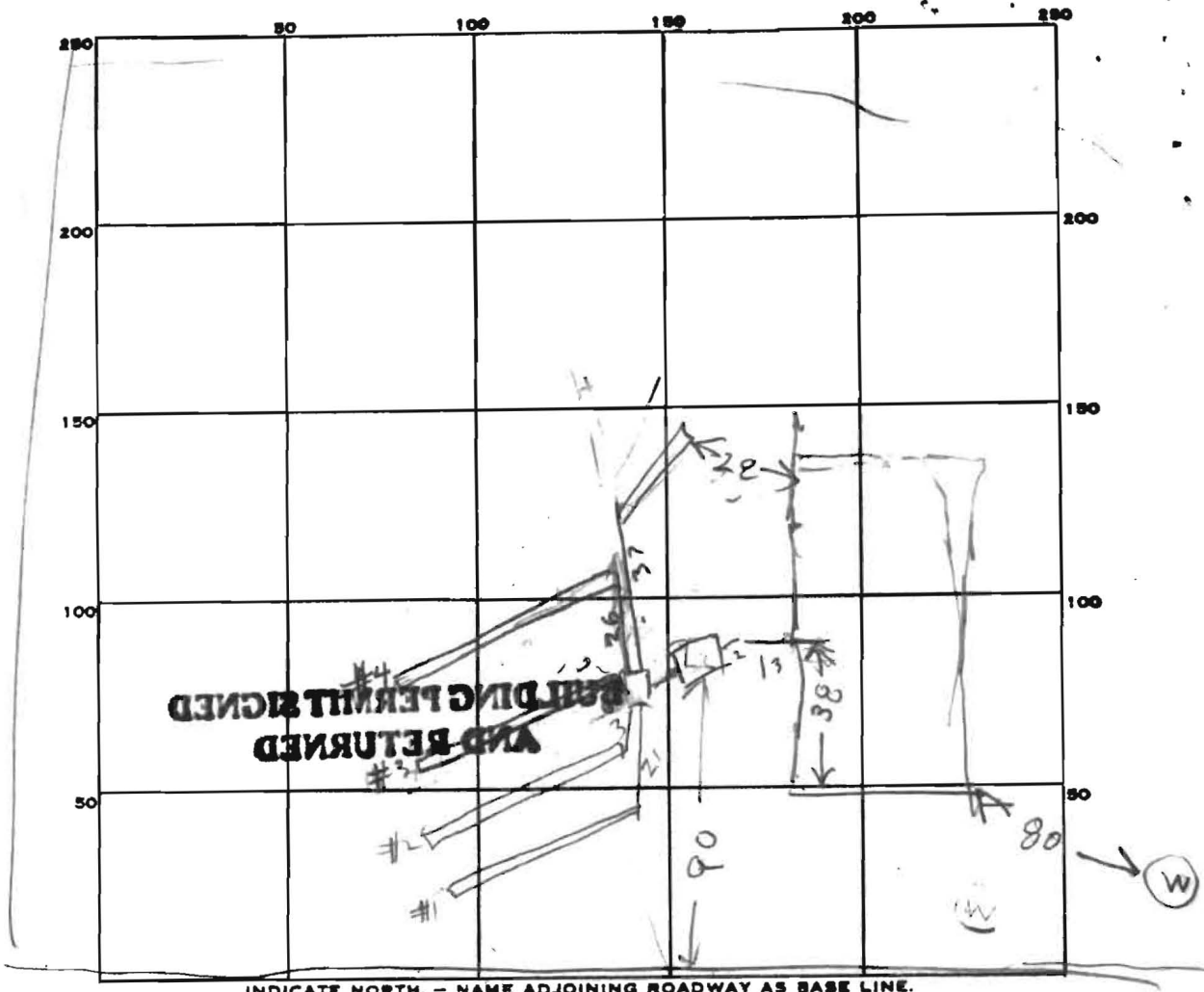

INDICATE NORTH. - NAME ADJOINING ROADWAY AS BASE LINE.

ALL NUTT

PERMIT CARD _____

SEPTIC TANK, LEVEL OK 1500

CLEANOUTS ST OK

DISTRIBUTION BOX, LEVEL OK

#1	#2	#3	#4	#5	#1	#2	#3	#4	#5
4.5	4.5	4.2	4.5	4.5	3	3	3	3	3

#1	#2	#3	#4	#5	#1	#2	#3	#4	#5	TOTAL
1.5	1.5	1.5	1.5	1.5	50	52	59	62	32	257

NUMBER OF TRENCHES 5 TOTAL BOTTOM AREA 1295

SEEPAGE PITS, INSIDE DIAMETER _____ FT. DEPTH BELOW INLET _____ FT.

ABSORBENT AREA _____ SQ. FT.

REMARKS 12/30/85 - LOCATION OK

12/30/85 - '180 SQ FT X 4 = 720 SQ FT

REQUIRED 1295 INSTALLED

FRANK & MARK TOOK PICTURES OF THIS JOB

FOR AN INFORMATIONAL PAPER

DATE SYSTEM APPROVED 12/30/85

INSPECTOR Raymond A. Hulse