

12-4-96
ASAP CO.

PERMIT

SEWAGE DISPOSAL SYSTEM

DEPARTMENT OF HEALTH AND MENTAL HYGIENE

HOWARD COUNTY HEALTH DEPARTMENT
BUREAU OF ENVIRONMENTAL HEALTH

~~XXXXXX~~ 313-2640

05-377587

INDEXED

57584
P 5784

A REPAIR

DISTRICT 5TH

DATE 12/1/96

DATE SYSTEM APPROVED 12/1/96

INSPECTOR ALM

Hatfield's Equipment & Dedication Service, Inc. IS PERMITTED TO INSTALL ALTER X

ADDRESS 13785 Burntwoods Road, Glenelg, Maryland 21737 PHONE 854-6172

SUBDIVISION Linden Chapel Hills, Sec 4 LOT 18, Blk C. ROAD 13540 Argo Drive

PROPERTY OWNER George Tasley

ADDRESS

SEPTIC TANK CAPACITY GALLONS

NUMBER OF BEDROOMS

SQUARE FEET PER BEDROOM

LINEAR FEET OF TRENCH REQUIRED

REPAIR - PURPOSE - SEPTIC SYSTEM HAS FAILED.

Call for inspection when ground is opened so sanitarian can recommend repair. 11/27/96

Install off end of drywell:	⊙ inkt 4.0	OR	inkt 4.0
	bottom 6.0		bottom 9.0
	stone 6.0		stone 5.0
	length 65'		length 75'

PLANS APPROVED BY DATE

COVER NO WORK UNTIL INSPECTED AND APPROVED

NEITHER THE HOWARD COUNTY COUNCIL NOR THE HEALTH DEPARTMENT IS RESPONSIBLE FOR THE SUCCESSFUL OPERATION OF ANY SYSTEM

NOTE: CLEANOUT REQUIRED EVERY 70 FEET OF SEWER LINE AND/OR AT 90° SWEEPS IN LINES FROM HOUSE TO DRAIN FIELDS, 90° ELBOWS NOT ACCEPTABLE.

NOTE: ALL PARTS OF SEPTIC SYSTEMS (I.E. TANK, DISTRIBUTION BOX TRENCHES) TO BE 100 FEET FROM WELL (UNLESS OTHERWISE SPECIFICALLY AUTHORIZED)

NOTE: IF DEEP TRENCH(ES) ARE USED CALL FOR INSPECTION BEFORE AND AFTER PLACING GRAVEL IN TRENCH(ES)

NOTE: NO DRY WELL SHALL EXCEED 15 FOOT IN DIAMETER NO ABSORPTION TRENCH TO EXCEED 100 FEET IN LENGTH

NOTE: ALL PIPE FROM HOUSE TO SEPTIC TANK MUST BE CAST IRON OR SCHEDULE 35/40 PVC OR ABS

PERMIT VOID AFTER TWO YEARS

NOTE: INSTALL STAND PIPE ON SEPTIC TANK AND DRY WELL STAND PIPES MUST BE 6 INCHES IN DIAMETER CAST IRON. CONCRETE OR TERRA COTTA OR PVA OR ABS ACCEPTED. IF TOP OF SEPTIC TANK IS DEEPER THAN 3 FEET. MANHOLE TO GRADE REQUIRED.

NOTE: DISTRIBUTION BOXES MUST HAVE BAFFLES

***INSTALLER IS RESPONSIBLE FOR OBTAINING FINAL APPROVAL ON THIS PERMIT**

57584

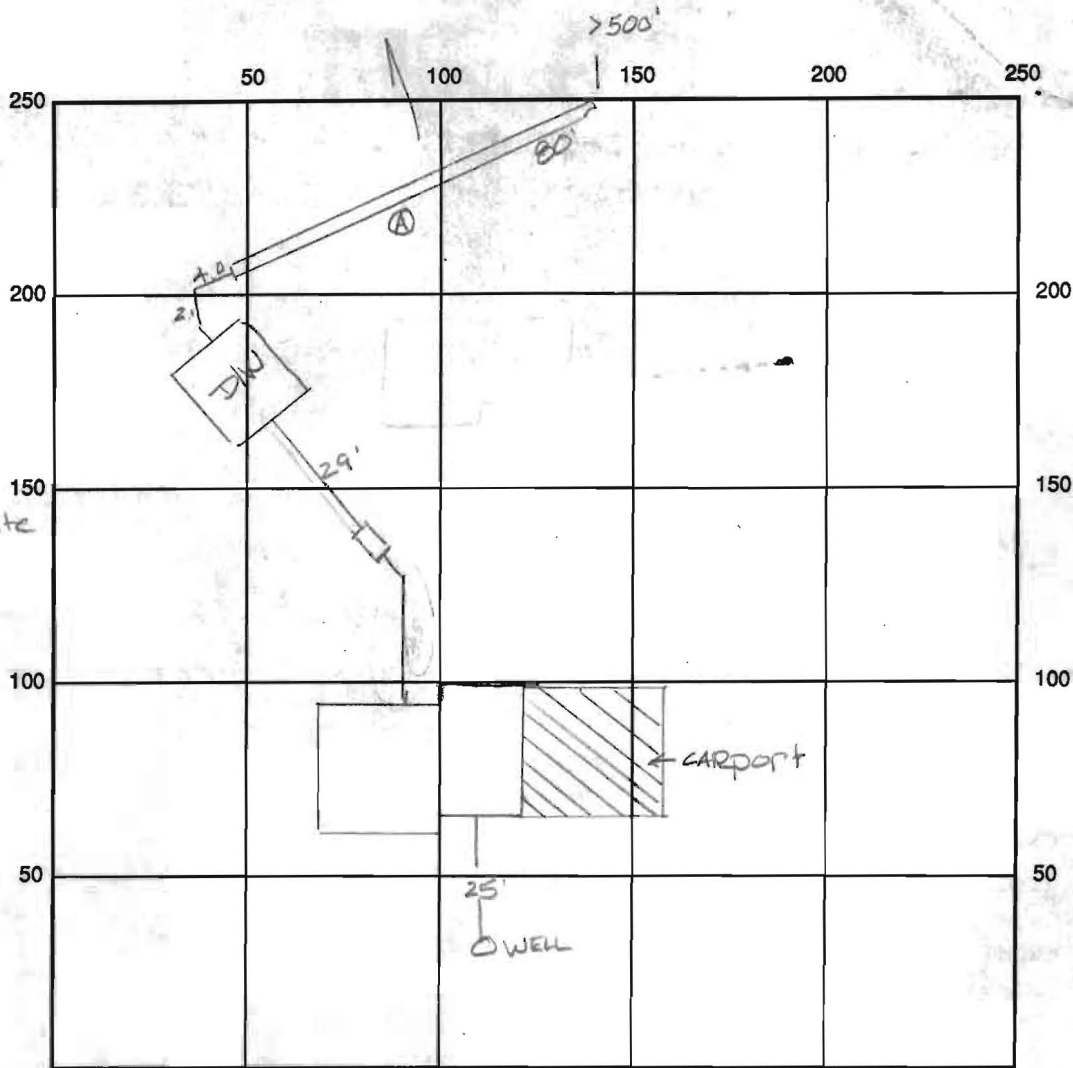

A
orange
brn
silt/clm
4.0
lgt
orange
beign
silt/clm
10% quartzite
bags
14.0

INDICATE NORTH - NAME ADJOINING ROADWAY AS BASE LINE

SEPTIC TANK LEVEL N/A CLEANOUTS N/A
 DISTRIBUTION BOX LEVEL N/A
 DRAIN FIELD/TITLE DEPTH 9.0 FT. TRENCH WIDTH 2.0 FT. INLET DEPTH 4.0 FT.
 EFFECTIVE GRAVEL DEPTH 5.0 FT. TOTAL LENGTH 80 FT. 80
 NUMBER OF TRENCHES 1 ONE SIDEWALL/BOTTOM AREA 400 SQ. FT.
 DRYWALL INSIDE DIAMETER — FT. EFFECTIVE DEPTH BELOW INLET — FT.
 ABSORBENT AREA — SQ. FT.

REMARKS: 12/4/96 Replaced cast iron line from tank to house w/ PVC
12/4/96 OK to cover all work final ALM

DATE SYSTEM APPROVED 12/4/96 INSPECTOR d. McMullen