

8/21/02
1-12

PUB. SEWER STATUS VERIFIED BY MR

ISSUE DATE: 8/23
8/23/02

APPROVAL DATE: _____

PERMIT

P 517435

A REPAIR

ON-SITE SEWAGE DISPOSAL SYSTEM HOWARD COUNTY HEALTH DEPARTMENT BUREAU OF ENVIRONMENTAL HEALTH

Hatfields Equipment IS PERMITTED TO INSTALL ALTER

ADDRESS: 13785 Burntwoods Road, Glenelg PHONE NUMBER: 301-854-61⁷²~~8~~

SUBDIVISION: _____ LOT NUMBER: _____

ADDRESS: 9263 All Saints Road PROPERTY OWNER: Kristen Beach

SEPTIC TANK CAPACITY (GALLONS): _____

PUMP CHAMBER CAPACITY (GALLONS): _____

NUMBER OF BEDROOMS: _____

SQUARE FEET PER BEDROOM: _____

LINEAR FEET OF TRENCH REQUIRED: _____

TRENCHES:	Trench to be _____ feet wide. Inlet _____ feet below original grade. Bottom maximum depth _____ feet below original grade. Effective area begins at _____ feet below original grade. _____ feet of stone below distribution pipe.
LOCATION:	_____
PURPOSE:	Septic tank collapsed. Call for inspection when ground is opened so sanitarian can recommend repair.

PLANS APPROVED: Mark Rifkin DATE: 8/21/2002

- NOTE: PERMIT VOID AFTER 2 YEARS
- NOTE: CONTRACTOR RESPONSIBLE FOR SCHEDULING A PRE-CONSTRUCTION INSPECTION FOR ALL INSTALLATIONS
- NOTE: WATERTIGHT SEPTIC TANKS REQUIRED
- NOTE: ALL PARTS OF SEPTIC SYSTEM SHALL BE 100 FEET FROM ANY WATER WELL
- NOTE: MANHOLE RISERS REQUIRED ON ALL SEPTIC TANKS AND PUMP CHAMBERS

NEITHER THE HOWARD COUNTY COUNCIL NOR THE HEALTH DEPARTMENT IS RESPONSIBLE FOR THE SUCCESSFUL OPERATION OF ANY SYSTEM PERMITTEE RESPONSIBLE FOR OBTAINING FINAL APPROVAL ON THIS PERMIT CALL 410-313-2640 FOR INSPECTION OF SEPTIC SYSTEM

From: Don Lieu
To: Skinner, Frank
Date: 8/7/02 8:43AM
Subject: 9263 All Saints Road

August 7, 2002

Frank,

I have reviewed the GIS mapping information that we have on 9263 All Saints Road. It appears from the property information on the GIS layer that the sewer that is in MD 216 is about 200 foot from the property. We will need a copy of the deed to confirm the property's actual location in relation to the sewer. If this is the case, a 200 foot public house connection or sewer extension is required to provide sewer service to their property line.

The manhole that they want to tie into at Sewall Avenue is 400 about foot from the property and would require private easements across two other properties. In the past this has not been our standard practice.

Please contact me if you have any questions.

Don Lieu

CC: Welty, Jeff

From: Don Lieu
To: Hobbs, Jeff
Date: 8/26/02 9:44AM
Subject: 9263 All Saints Road

August 26, 2002

Jeff,

The Health Department has requested information on the location of a sewer house connection for 9263 All Saints Road. We have been informed that the connection will involve a stream crossing and a lengthy cross country run. The Health Department has questioned the home owners construction cost for the private house connection. In order to determine a reasonable cost for the homeowners private connection, we need to know the limits of the property to determine who is responsible for the cost of the stream crossing.

We would like to ask your assistance in locating the property line in relation to the existing sewer.

Thanks,

Don Lieu

CC: Lepson, Ron; Skinner, Frank

Greg, Recommend Approval, but soifs in drainfield need verification @ time of s.T. replacement. Prior visits to the neighborhood suggest poor soil conditions.

Kristen Beach
9263 All Saints Road
Laurel, MD 20723
Home: 301-490-6483
Work: 410-313-5006
Email: kbeach@mail.howard.k12.md.us

Sand mound/holding tank?

Please call her @ home MR 7/26/02
ASAP

July 23, 2002

Attn: Mark Rifkin
Bureau of Environmental Health
3525 Ellicott Mills Drive
Suite H
Ellicott City, MD 21043

7/29/02 Called M's Beach and advised her to get a septic permit for the tank and to do test.
Greg

Dear Mr. Rifkin:

I am writing to you today to ask for an exemption in connecting to Howard County sewage. I currently have an existing septic tank that is collapsing. Initially, I wanted to connect to sewage, but I have come to realize that a sewage connection is financially impossible for me to install at this time and I would rather install a tank replacement.

The septic tank at my house has been in use for approximately 45 years. Since I moved into this house in 1995, the tank has been pumped three times. When it was last pumped, I was told that it was collapsing in on itself. My plumbers at Laurel Plumbing and Heating have also told me the tank was collapsing.

On July 2, 2002, I went to the Department of Public Works for a sewer connection permit. In the meantime, I called my plumber from Laurel Plumbing and Heating and asked them to call the Bureau of Utilities. The following week, George Abbott from the Bureau of Utilities met my plumber to discuss the sewer connection. The length of the proposed sewage line is over 1000 feet. My plumber was told that my connection would need to tap into the opposite side of a stream that is behind my house. The proposed cost of installing the sewage line was approximately \$40,000 - 50,000. I was well prepared to spend about \$6,000, but the amount I was told is financially impossible. The plumber actually told me the job was too big for his company.

The situation with my septic tank is an extremely large concern for me. The tank no longer has an appropriate cover, and it is filling up more quickly than usual. Although the tank is not failing yet, I believe that it will not last for much longer. I would like to install another septic tank as soon as possible. Thank you for your time.

Sincerely,

Kristen Beach

Howard County Health Department

Bureau of Environmental Health, Ellicott City, Maryland 410-313-2640

SEWAGE DISPOSAL PERMIT NO. A- REPAIR P- _____

PERMITTEE HATFIELDS EQUIPMENT

LOCATION 9263 ALL SAINTS ROAD
(KRISTEN BEACH)

Do Not Cover Work Until Health Department Approval Appears On This Card

POST THIS CARD WHERE IT CAN BE SEEN FROM ROAD

STOP ALL CONSTRUCTION ON SEWAGE DISPOSAL SYSTEM AND CONTACT HEALTH DEPARTMENT BEFORE CONTINUING

WORK IS SATISFACTORY, CONTINUE

Inspector

Date

Inspector

Date

FINAL INSPECTION MADE, COVER ALL WORK

Inspector

Date

TO MARK RIFKIN

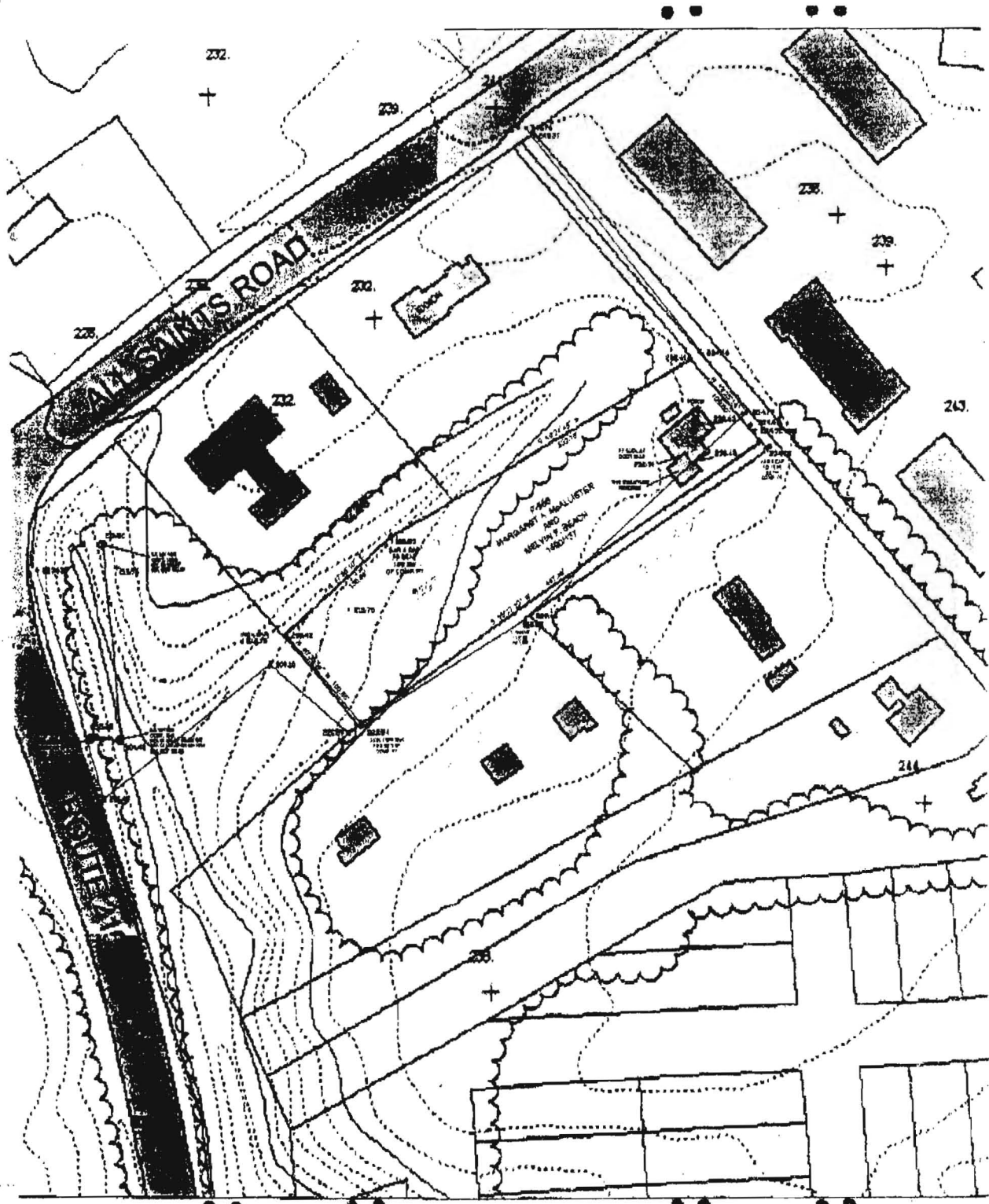

From: Don Lieu
To: Skinner, Frank
Date: 8/7/02 8:44AM
Subject: 9263 All Saints Road

August 7, 2002

Frank,

I have reviewed the GIS mapping information that we have on 9263 All Saints Road. It appears from the property information on the GIS layer that the sewer that is in MD 216 is about 200 foot from the property. We will need a copy of the deed to confirm the property's actual location in relation to the sewer. If this is the case, a 200 foot public house connection or sewer extension is required to provide sewer service to their property line.

The manhole that they want to tie into at Sewall Avenue is 400 about foot from the property and would require private easements across two other properties. In the past this has not been our standard practice.

Please contact me if you have any questions.

Don Lieu

CC: Welty, Jeff

8-8-02

Mark,

I brought up this site @ our meeting the other day. Private easements across other properties are not best option. DPW has a policy that restricts private access thru another's property to only one property removed from the water/sewer line.

Frank

Map 47

P/O P.837
5 of 7

9263 All Saints
Road

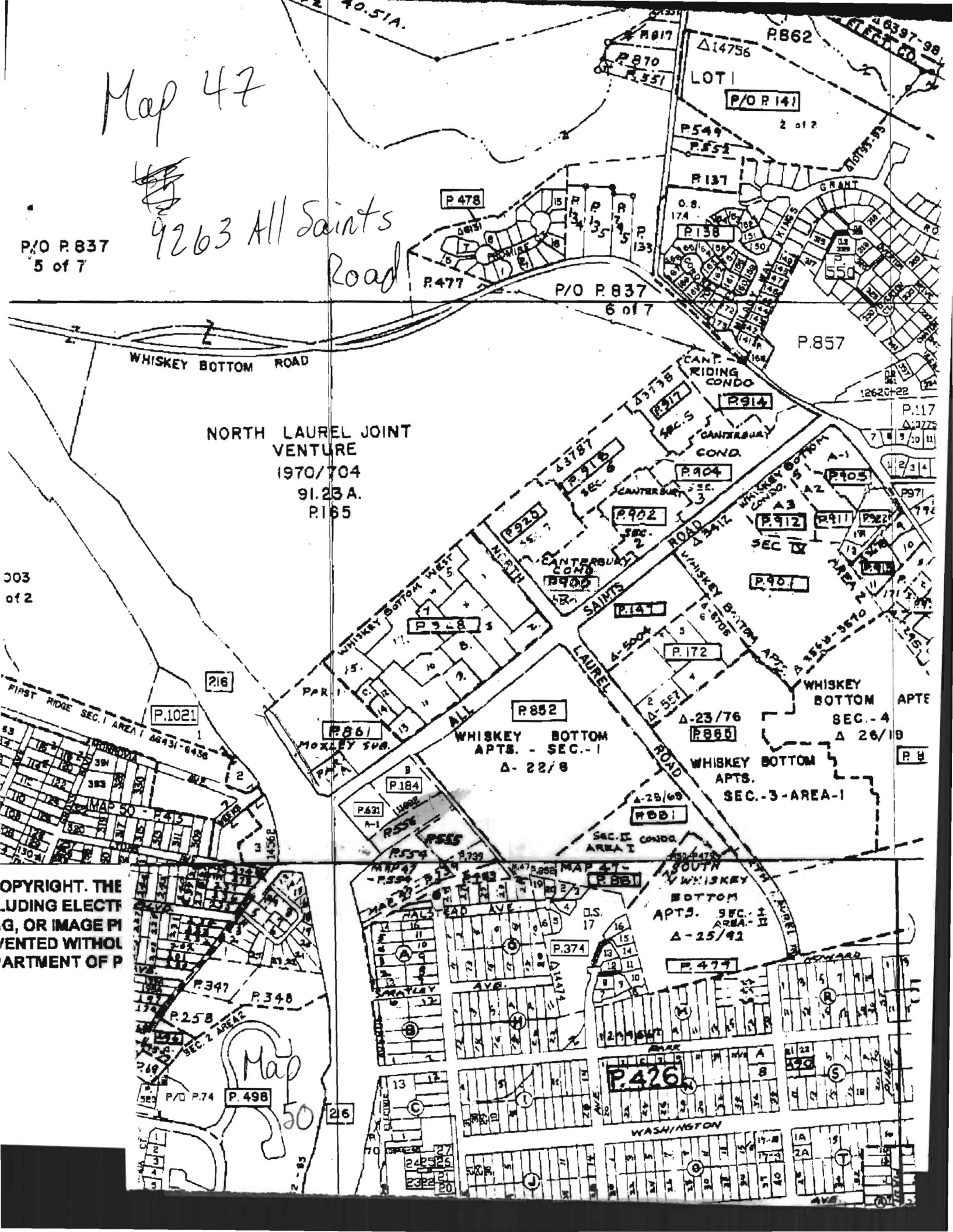

COPYRIGHT. THE
INCLUDING ELECTRIC
G, OR IMAGE PI
VENTED WITHOL
ARTMENT OF P

Map 50