



Building Permit Application

Howard County Maryland
Department of Inspections, Licenses and Permits
3430 Court House Drive
Permits: 410-313-2455
www.howardcountymd.gov

Date Received: _____

Permit No.: B15003188

Health

Building Address: 12307 Pleasant View Dr
 City: Fulton State: MD Zip Code: 20759
 Suite/Apt. # _____ SDP/WP/BA #: _____
 Census Tract: 6051.02 Subdivision: Fulton Manor II
 Section: _____ Area: _____ Lot: _____
 Tax Map: 12580 Parcel: 14-05598838 Grid: _____
 Zoning: _____ Map Coordinates: _____ Lot Size: 40380sf

Existing Use: Unfinished basement - SFD
 Proposed Use: finished basement
 Estimated Construction Cost: \$ 10,000
 Description of Work: Construction of basement bedroom + bathroom (640 sqft)

Occupant or Tenant: Occupant
 Was tenant space previously occupied? Yes No
 Contact Name: _____
 Address: _____
 City: _____ State: _____ Zip Code: _____
 Phone: _____ Fax: _____
 Email: _____

Property Owner's Name: David Solomonray
 Address: 12307 Pleasant View Dr
 City: Fulton State: MD Zip Code: 20759
 Phone: 301 317 1783 Fax: _____
 Email: d.solomonray@hotmail.com

Applicant's Name & Mailing Address, (if other than stated herein)
 Applicant's Name: _____
 Address: _____
 City: _____ State: _____ Zip Code: _____
 Phone: _____ Fax: _____
 Email: _____

Contractor Company: Self
 Contact Person: _____
 Address: _____
 City: _____ State: _____ Zip Code: _____
 License No.: _____
 Phone: _____ Fax: _____
 Email: _____

Engineer/Architect Company: _____
 Responsible Design Prof.: _____
 Address: _____
 City: _____ State: _____ Zip Code: _____
 Phone: _____ Fax: _____
 Email: _____

Commercial Building Characteristics	Residential Building Characteristics	
Height:	<input checked="" type="checkbox"/> SF Dwelling <input type="checkbox"/> SF Townhouse	
No. of stories:	Depth	Width
Gross area, sq. ft./floor:	1 st floor: <u>102 x 78 sq ft</u>	
Area of construction (sq. ft.):	2 nd floor: <u>100 sqft x 68 sqft</u>	
Use group:	Basement: <u>91 sqft x 89 sqft</u>	
	<input type="checkbox"/> Finished Basement	
	<input checked="" type="checkbox"/> Unfinished Basement	
	<input type="checkbox"/> Crawl Space	
Construction type:	<input type="checkbox"/> Slab on Grade	
<input type="checkbox"/> Reinforced Concrete	No. of Bedrooms: <u>4</u>	
<input type="checkbox"/> Structural Steel	Multi-family Dwelling	
<input type="checkbox"/> Masonry	No. of efficiency units:	
<input type="checkbox"/> Wood Frame	No. of 1 BR units:	
<input type="checkbox"/> State Certified Modular	No. of 2 BR units:	
	No. of 3 BR units:	
	Other Structure:	
	Dimensions:	
	Footings:	
	Roof:	
	<input type="checkbox"/> State Certified Modular	
	<input type="checkbox"/> Manufactured Home	

Utilities	
Water Supply	
<input type="checkbox"/> Public	
<input checked="" type="checkbox"/> Private	
Sewage Disposal	
<input type="checkbox"/> Public	
<input checked="" type="checkbox"/> Private	
Electric: <input type="checkbox"/> Yes <input type="checkbox"/> No	
Gas: <input type="checkbox"/> Yes <input type="checkbox"/> No	
Heating System	
<input type="checkbox"/> Electric <input type="checkbox"/> Oil	
<input type="checkbox"/> Natural Gas <input checked="" type="checkbox"/> Propane Gas	
<input type="checkbox"/> Other:	
Sprinkler System:	
<input checked="" type="checkbox"/> Yes <input type="checkbox"/> No	
Grading Permit Number: _____	
Building Shell Permit Number: _____	

THE UNDERSIGNED HEREBY CERTIFIES AND AGREES AS FOLLOWS: (1) THAT HE/SHE IS AUTHORIZED TO MAKE THIS APPLICATION; (2) THAT THE INFORMATION IS CORRECT; (3) THAT HE/SHE WILL COMPLY WITH ALL REGULATIONS OF HOWARD COUNTY WHICH ARE APPLICABLE THERETO; (4) THAT HE/SHE WILL PERFORM NO WORK ON THE ABOVE REFERENCED PROPERTY NOT SPECIFICALLY DESCRIBED IN THIS APPLICATION; (5) THAT HE/SHE GRANTS COUNTY OFFICIALS THE RIGHT TO ENTER ONTO THIS PROPERTY FOR THE PURPOSE OF INSPECTING THE WORK PERMITTED AND POSTING NOTICES.

Applicant's Signature: David Solomonray Print Name: DAVID SOLOMONRAY
 Email Address: d.solomonray@hotmail.com Date: 7/24/15
 Title/Company: _____

Checks Payable to: DIRECTOR OF FINANCE OF HOWARD COUNTY

****PLEASE WRITE NEATLY & LEGIBLY****
FOR OFFICE USE ONLY

AGENCY	DATE	SIGNATURE OF APPROVAL
State Highways		
Building Officials		
PSZA (Zoning)		
PSZA (Engineering)		
Health	<u>8/3/15</u>	<u>[Signature]</u>

Is Sediment Control approval required for assistance? Yes No
 CONTINGENCY CONSTRUCTION START

DPZ SETBACK INFORMATION
Front: _____
Rear: _____
Side: _____
Side St.: _____
All minimum setbacks met? <input type="checkbox"/> Yes <input type="checkbox"/> No
Is Entrance Permit Required? <input type="checkbox"/> Yes <input type="checkbox"/> No
Historic District? <input type="checkbox"/> Yes <input type="checkbox"/> No
Lot Coverage for New Town Zone: _____
SDP/Red-line approval date: _____

Filing Fee	\$
Permit Fee	\$
Tech Fee	\$
Excise Tax	\$
PSFS	\$
Guaranty Fund	\$ <u>150</u>
Add'l per Fee	\$
Total Fees	\$
Sub-Total Paid	\$
Balance Due	\$
Check #	<u>574</u>

Distribution of Copies: White: Building Officials Green: PSZA, Zoning Yellow: PSZA, Engineering Pink: Health Gold: SHA

T:\Operations\Updated Forms\Building applmp 8.2012.docx

mark to owner

Building Sketch

Borrower	David S. Solomonraj and Amber R.		
Property Address	12307 Pleasant View Dr		
City	Fulton	County	Howard
		State	MD
Lender	TD Bank	Zip Code	20759

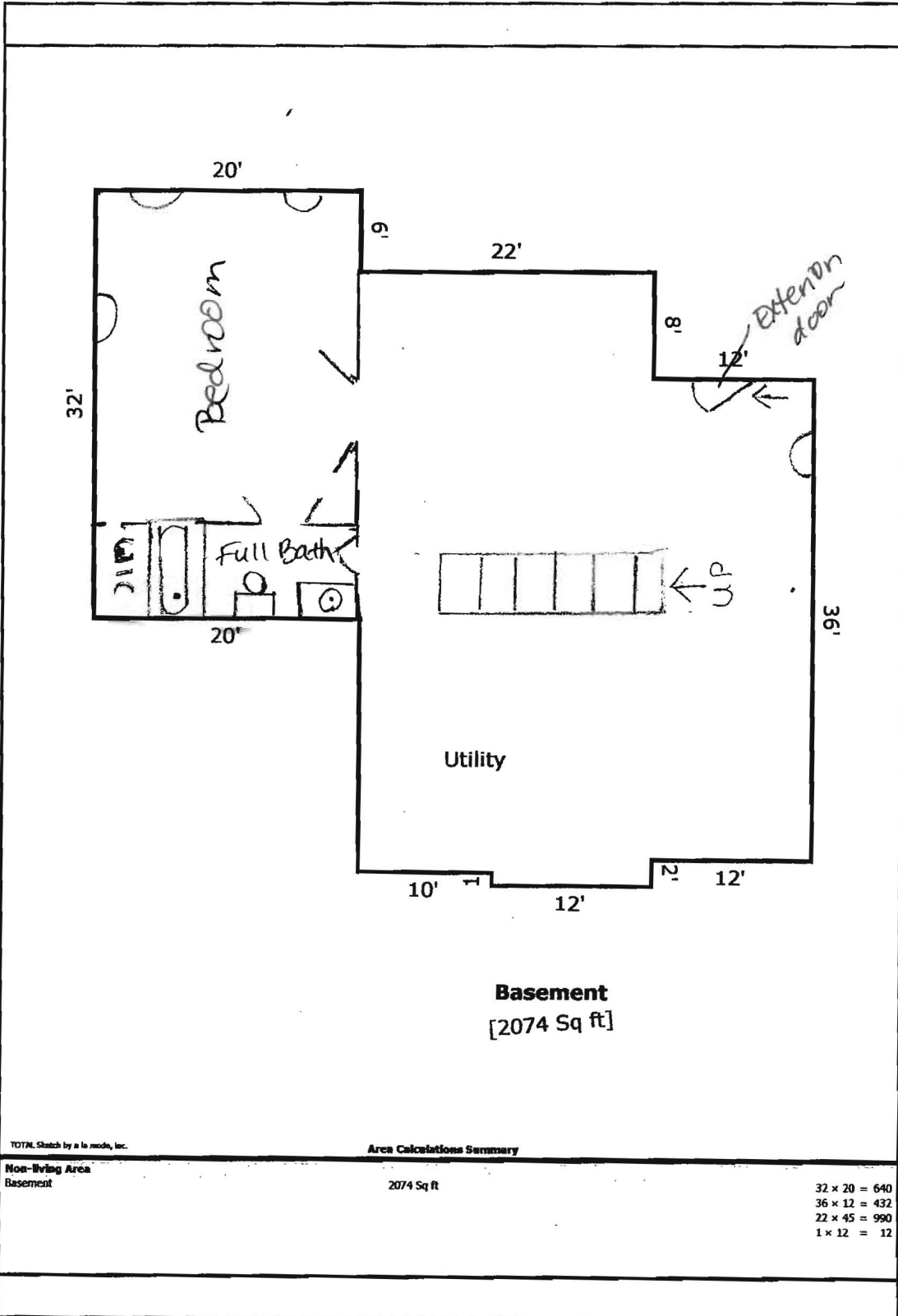

Building Sketch

Borrower	David S. Solomonraj and Amber R.			
Property Address	12307 Pleasant View Dr			
City	Fulton	County Howard	State MD	Zip Code 20759
Lender	TD Bank			

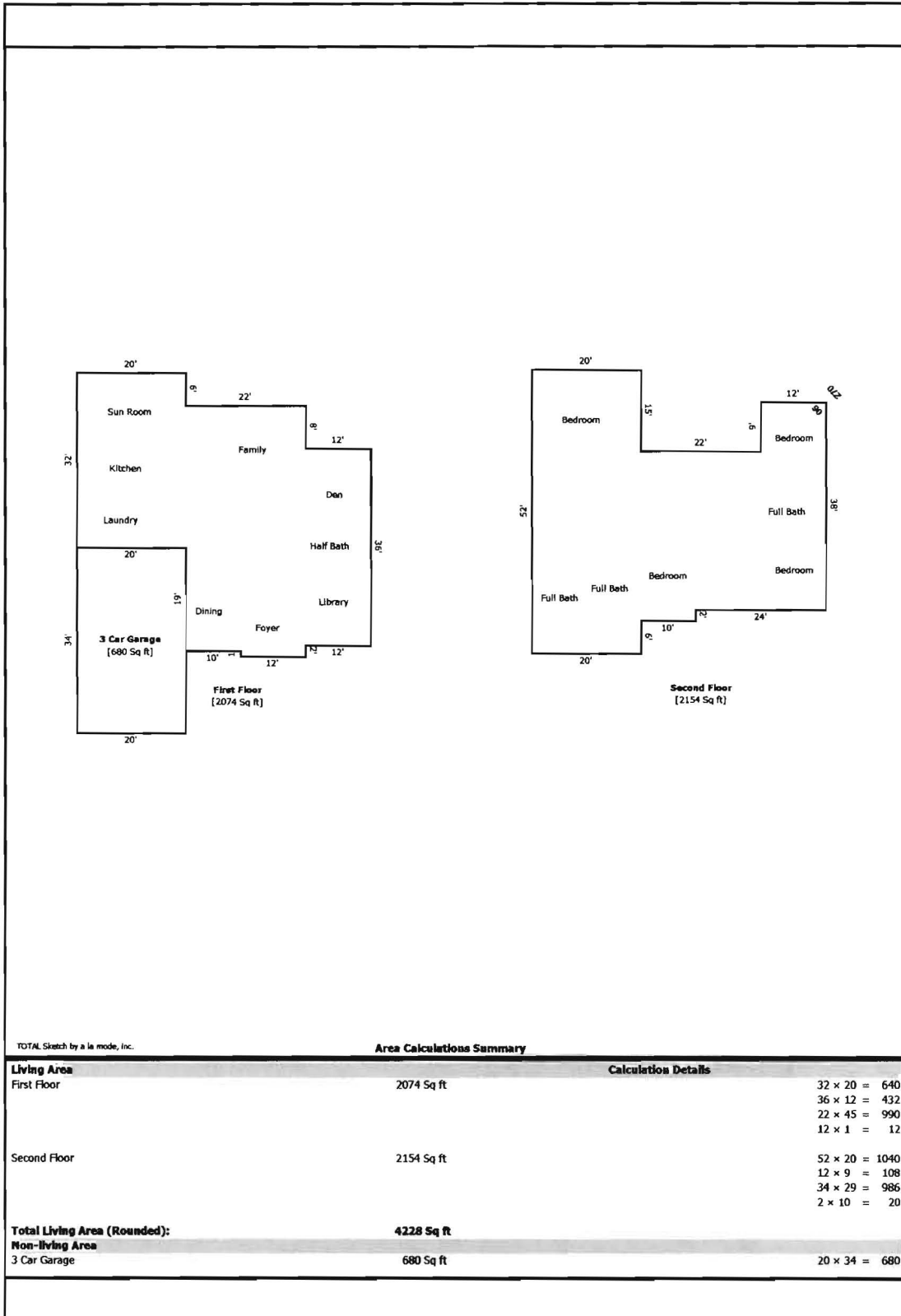

Building Sketch

Borrower	David S. Solomonraj and Amber R.			
Property Address	12307 Pleasant View Dr			
City	Fulton	County Howard	State MD	Zip Code 20759
Lender	TD Bank			

