

APPLICATION

A 24692

SEWAGE DISPOSAL TESTING

P _____

STATE OF MARYLAND - DEPARTMENT OF HEALTH AND MENTAL HYGIENE

HOWARD COUNTY HEALTH DEPARTMENT
ENVIRONMENTAL HEALTH SERVICES
P. O. BOX 476, ELLICOTT CITY, MARYLAND 21043
TELEPHONE: 465-5000, EXT. 356

DISTRICT Fifth

DATE 9/9/76

Syst First

TO: THE COUNTY HEALTH OFFICER
ELLICOTT CITY, MARYLAND

I, HEREBY, APPLY FOR THE NECESSARY TEST IN ORDER TO CONSTRUCT (OR RECONSTRUCT) A SEWAGE DISPOSAL SYSTEM.

PROPERTY OWNER Mr. and Mrs. Smith W. Allnutt, Jr.
13288 Highland Road
ADDRESS Highland, MD 20777 PHONE 988-9303

PROPERTY LOCATION: Allnutt
SUBDIVISION Hi-Land Farm Estates LOT NO. 27 *New lot 9*

ROAD AND DESCRIPTION Road "A"

SIZE OF LOT 1.16 Ac TYPE BLDG. 3 or 4 bedroom
NUMBER OF BEDROOMS _____

IF NOT SINGLE RESIDENCE DESCRIBE _____

THE SYSTEM INSTALLED UNDER THIS APPLICATION IS ACCEPTABLE ONLY UNTIL PUBLIC FACILITIES BECOME AVAILABLE.

SIGNATURE OF APPLICANT /s/ Margaret G. Allnutt

APPROVED BY Rjo'Neill FOR DWT Focus DATE 9-13-76
(KIND OF SYSTEM)

REJECTED BY _____ FOR _____ DATE _____
(KIND OF SYSTEM)

HOLD PENDING FURTHER TESTS _____ DATE _____

REASONS FOR REJECTION OR HOLDING _____

THIS IS NOT A PERMIT

APPLICATION

A _____

P _____

SEWAGE DISPOSAL TESTING

STATE OF MARYLAND - DEPARTMENT OF HEALTH AND MENTAL HYGIENE

HOWARD COUNTY HEALTH DEPARTMENT
ENVIRONMENTAL HEALTH SERVICES
P. O. BOX 476, ELLICOTT CITY, MARYLAND 21043
TELEPHONE: 465-5000, EXT. 356

DISTRICT Fifth

DATE 9/9/76

TO: THE COUNTY HEALTH OFFICER
ELLICOTT CITY, MARYLAND

I, HEREBY, APPLY FOR THE NECESSARY TEST IN ORDER TO CONSTRUCT (OR RECONSTRUCT) A SEWAGE DISPOSAL SYSTEM.

PROPERTY OWNER Mr. and Mrs. Smith W. Allnutt
ADDRESS 13288 Highland Road
Highland, MD 20777 PHONE 988-9303

PROPERTY LOCATION:

SUBDIVISION Hi-Land Farm Estates LOT NO. 29

ROAD AND DESCRIPTION Road "A"

SIZE OF LOT 1.61 Ac TYPE BLDG. 3 or 4 bedroom
NUMBER OF BEDROOMS

IF NOT SINGLE RESIDENCE DESCRIBE _____

THE SYSTEM INSTALLED UNDER THIS APPLICATION IS ACCEPTABLE ONLY UNTIL PUBLIC FACILITIES BECOME AVAILABLE.

SIGNATURE OF APPLICANT /s/ Margaret G. Allnutt

APPROVED BY _____ FOR _____ DATE _____
(KIND OF SYSTEM)

REJECTED BY _____ FOR _____ DATE _____
(KIND OF SYSTEM)

HOLD PENDING FURTHER TESTS _____ DATE _____

REASONS FOR REJECTION OR HOLDING _____

THIS IS NOT A PERMIT

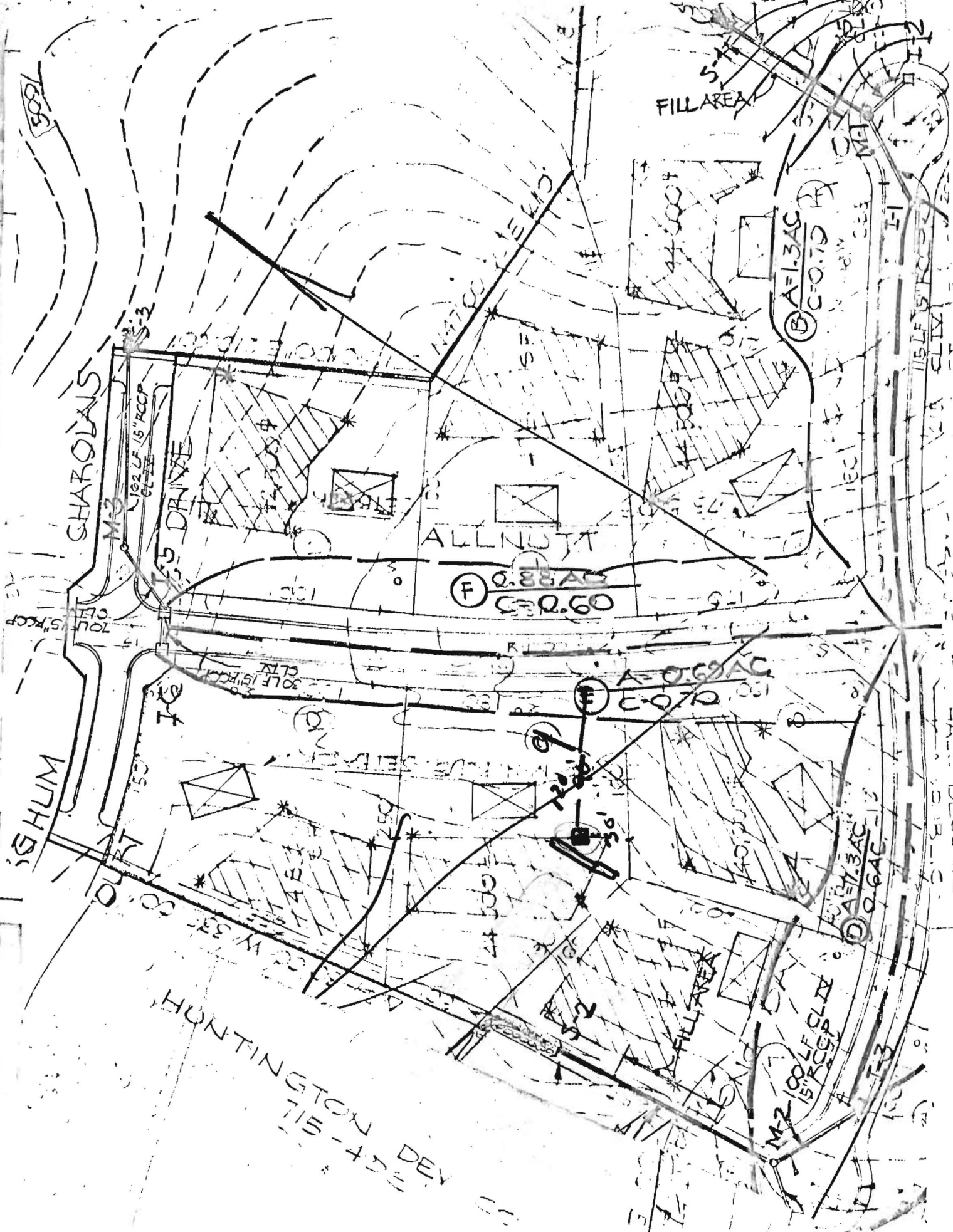

HUNTINGTON DEV
715-43

UNDEVELOPED
MAY BECOME
HALL BLDG

Steph, Pls. make
file.

5/19 THX
MR

SYSTEM FIRST

A 24692

SUBDIVISION: ALLNUT FARM ESTATES LOT NUMBER: 9 SECT 2

DRY WELL OR DRY WELL AND TRENCH

~~180~~ sq. ft./bedroom

	Septic Tank	Minimum Total square Feet
3 bedroom	1000 gallon	_____
4 bedroom	1250 gallon	_____
5 bedroom	1500 gallon	_____

Inlet 13 feet below original grade.

Bottom maximum depth 14 feet below original grade.

Effective area begins at _____ feet below original grade.

NOTE: If trench is used to make up absorbent area, run the trench on level ground and leave a 5 foot earth buffer between dry well and trench. No trench is to exceed 100 feet in length. Trench inlet to be same as dry well, with 13 feet of stone below distribution pipe.

OK TRENCHES

180
163 sq. ft./bedroom

Trench to be 2 wide.

Inlet 3 feet below original grade.

Bottom maximum depth 7 feet below original grade.

Effective area begins at 3 feet below original grade.

4 feet of stone below distribution pipe.

- NOTE:
- (1) No trench to exceed 100 feet in length.
 - (2) If more than one trench used, a distribution box is required.
 - (3) Trenches to be installed on level ground.
 - (4) Call for inspection of trench before gravel is installed.
 - (5) Provide 6"-8" diameter cleanout and cap to grade or above on septic tank and drywell.
 - (6) If a Garbage disposal is used, increase septic tank capacity by 50% and increase absorbant sidewall area by 22%.

UPDATE
LOCATION: 2/7/86 - PLACE THE DRY WELL OR START THE TRENCH 125 FT FROM THE FRONT LOT LINE AND 20 FT FROM THE LEFT SIDE OF THE LOT AS SEEN WHEN FACING THE LOT FROM ALLNUT LANE RUN THE TRENCH TOWARD THE RIGHT SIDE OF THE LOT. TRENCH PREFERRED SYSTEM MUST BE INSTALLED BEFORE BUILDING PERMIT ISSUED 1970

Lot 9, Sec. 2 A.F.E. owner
LOT NUMBER Sec 2 lot 9

ADON 21 2/25
prepared by

Absorbant Area/bedroom 130

SEPTIC TANK 1000 gal 1250 gal 1500 gal
3 bdrms 4 bdrms 5 bdrms

✓ DRY WELL 3' 9' 288
inlet Max. depth Abs. Area
Located ¹²⁰ ~~9'~~ From Allsett low, 30' From lot 8

✓ TRENCH 3' 9' # bedrooms Length Abs. Area
inlet Max. depth 3 30
4 60'
10' away From and
To start, even with corner of lot 7 and 8 and run on contour
towards lot 10

If dry well and trench are used leave a 5' earth buffer between them.
If septic tank is 3' or more below grade, use manhole type cleanout to grade.
If more than one trench is used space them parallel, twice their depth apart.
Call office for inspection of trench before placing stone in trench.
All pipe from house to disposal area cast iron.
Install standpipe (6" min.) on septic tank and dry well. Cast iron, concrete, terra
cotta ok. Trench distribution lines may be clay, asbestos cement, orangeburg type,
open joint cast iron or heavy duty plastic. (Commercial standard Cs228-61).

System First