



# 2791

brown

yellow brown silty micaceous

orange b-silt & hard silty clay

yellow brown silty micaceous

sil/silt mic

13

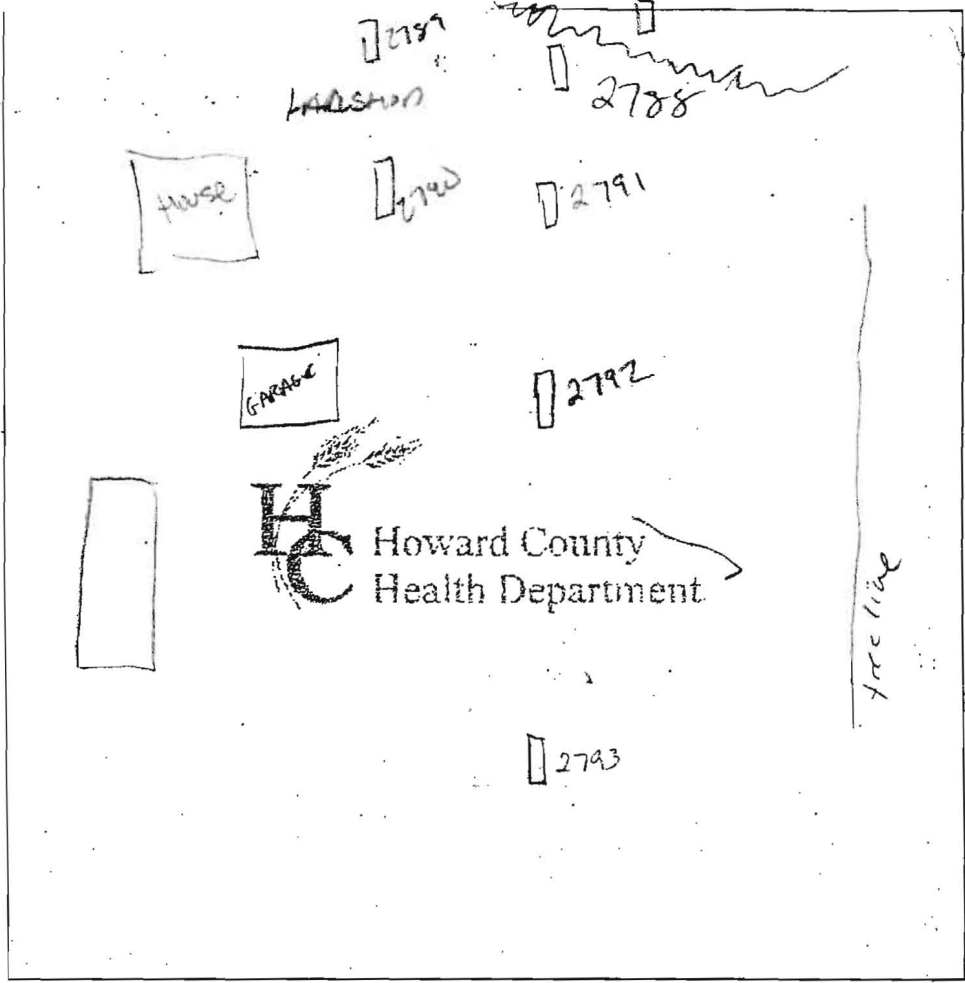

2790

brown

o-b-s silty ab

o-b-r sil (heavy to med)

yellow brown sil

15 <5% frags

13

2789

brown

red brown silty ab micaceous

r-b-s sil

white-brown sil

o-brown sil

5% clay frags

13

2793 A

brown

5/4 loe weak red silty (ab) sil micaceous

o-b-r sil (heavy to light)

4

6

13

2792

brown fill

weak red silty & sil

4 1/2

4 1/4 104R dark yellowish brown micaceous silt (fine)

micaceous

fluffy grey sil

13

DATE	TEST #	DEPTH	START	BREAK 1" DROP	STOP 2" DROP	TIME OF 2nd INCH	P/F/H
5/31/05	2793	6-13	9:44	9:50	9:59	9	P
✓	2792	6-13	9:37	9:39 <sup>30</sup>	9:42 <sup>00</sup>	2.5	P
✓	2791	8-13	9:30	Slow			F
✓	2789	6-13	9:59	10:20	10:46	26	P
✓	2788	7-13	10:14	10:23	10:31	8	P
✓	2790	6-13	12:08	12:10	12:12	2	P
✓	2792A	13	12:19	12:22	12:25	3	P

2789

brown fill

r-o-b micaceous silty

o-b-r sil

o-b sil

white sil

15% quartz frags

13

REMARKS - Perc #'s not on new plan!! / Soils INCOS. STANT

SANITARIAN PKY BACKHOE K&K OTHERS \_\_\_\_\_

TEST HOLES USED IN SDA \_\_\_\_\_ AVG. PERC TIME \_\_\_\_\_ SQ. FT/BR \_\_\_\_\_

TRENCH WIDTH \_\_\_\_\_ INLET DEPTH \_\_\_\_\_ MAX. BOT DEPTH \_\_\_\_\_ EFFECTIVE SW \_\_\_\_\_

AVP 4351  
 Red Br Heavy Loam 3.5'-5'  
 Red Br Si Loam and Or Br Sa Loam ~10% Rock 5.5'  
 Or Br Sa Loam ~10% Rock 13.5'

4352  
 Red Br Heavy Loam 4'  
 Red Br Loam Very Little Rock 5.5'  
 Tan Sa Loam 10-15% Saprofite 13.5'

4353  
 Red Br Heavy Loam 4.5'  
 Red Br Loam Very Little Rock 5.5'-6'  
 Beige Sa Loam ~15% Saprofite 13.5'

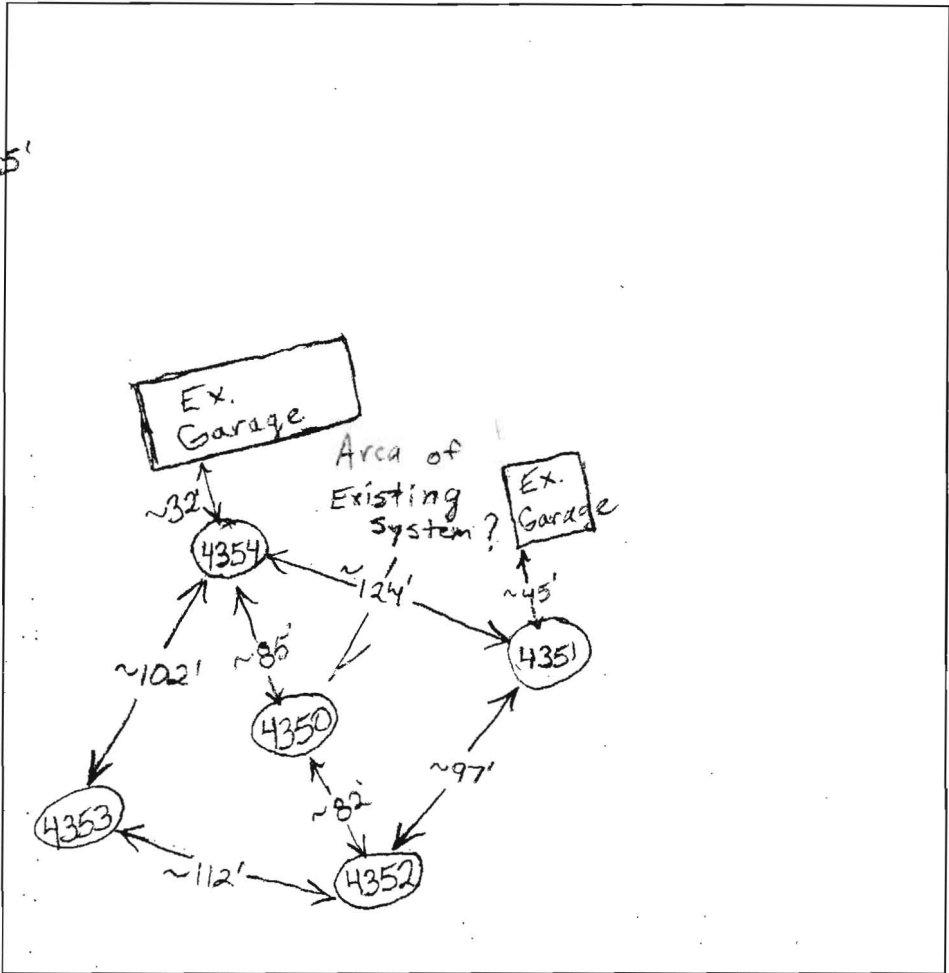

4354  
 Red Br Heavy Loam 4.5'  
 Red Br Loam Very Little Rock 5.5'-5.5'  
 Light Br Sa Loam 10-15% Saprofite 13.5'

4350  
 Red Br Heavy Loam 4.4.5'  
 Red Br Loam Scarce Rock 5.5'-6'  
 Or Br Sa Loam 15-20% Saprofite 13.5'

DATE	TEST #	DEPTH	START	BREAK 1" DROP	STOP 2" DROP	TIME OF 2nd INCH	P/F/H	
9/17/03	4351	7'/13.5'	9:53	9:54:45	9:54:45	9:58	~3	O.K.
	4352	6'3"/13.5'	10:03:30	10:05	10:05	10:07	2	O.K.
	4350	13.5'	— See Profile →					O.K.
	4353	6.5'/13.5'	10:18:15	10:20:15	10:20:15	10:23:45	3 1/2	O.K.
	4354	6.5'/13.5'	10:33	10:34:20	10:34:20	10:35:45	4 1/2	O.K.

REMARKS \_\_\_\_\_  
 SANITARIAN B. Baker BACKHOE K+K OTHERS \_\_\_\_\_  
 TEST HOLES USED IN SDA \_\_\_\_\_ AVG. PERC TIME \_\_\_\_\_ SQ. FT/BR \_\_\_\_\_  
 TRENCH WIDTH \_\_\_\_\_ INLET DEPTH \_\_\_\_\_ MAX. BOT DEPTH \_\_\_\_\_ EFFECTIVE SW \_\_\_\_\_

AP 4348

Dense Red Br. Loam 4'-5'  
 Beige Sa Loam  
 ~15% Saprolite  
 13'

(T)  
 Red Br Heavy Loam and Loam 4.5'  
 Beige Sa Loam  
 ~25% Rock and Saprolite  
 12.5'

(U)  
 Red Br Heavy Loam and Loam 4.5'  
 Dense Red Br Sa Loam Trace Rock 5'-5.5'  
 Light Red Br Sa Loam ~15% Saprolite 13'

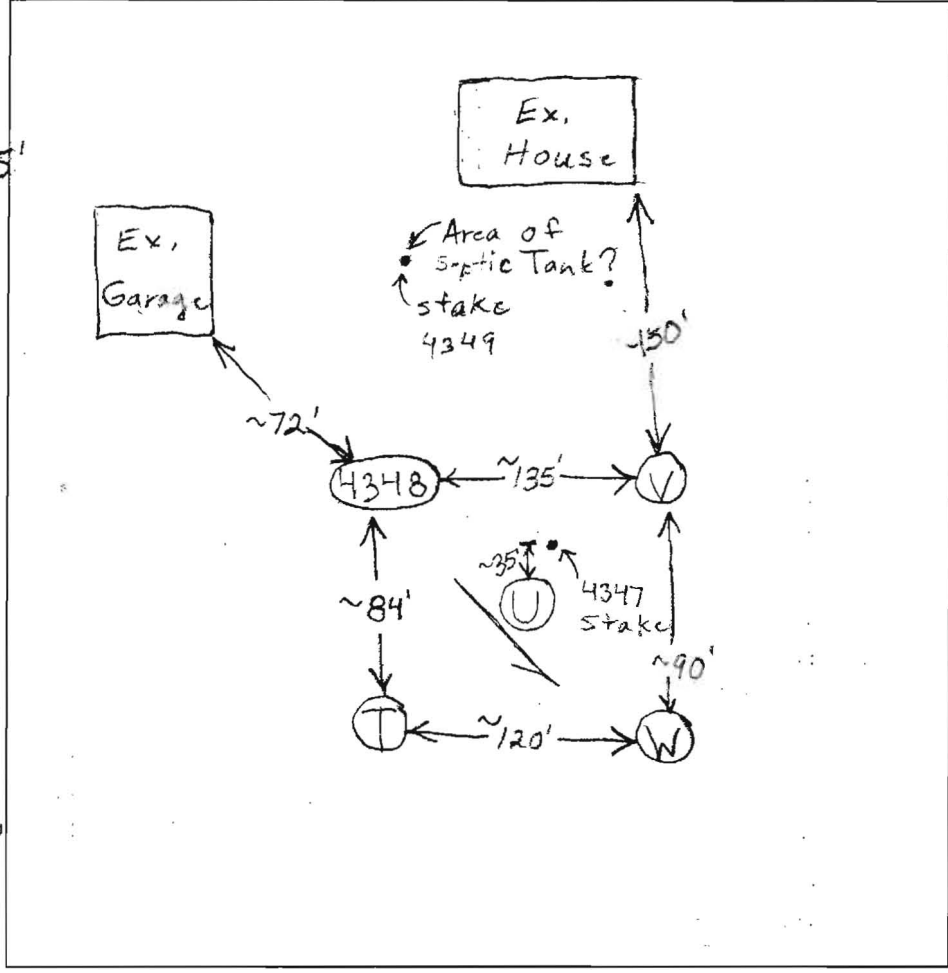

Red Br Heavy Loam 4'  
 Red Br Loam 4.5'  
 Beige Sa Loam 15-20% Rock and Saprolite 14'

(W)  
 Br Heavy Loam 3'-3.5'  
 Red Br Loam 4.5'  
 Dense Red Br Sa Loam Trace Rock 8.5'  
 Beige Sa Loam ~25% Saprolite 12'

DATE	TEST #	DEPTH	START	BREAK 1" DROP	STOP 2" DROP	TIME OF 2nd INCH	P/F/H	
9/18/03	4348	6' / 13' V	9:22:30	9:23:45	9:23:45	9:25:15	1 1/2	O.K.
	T	5.5' / 12.5' V	9:38:15	9:40	9:40	9:43:15	~3	O.K.
	U	5' 9" / 13' V	9:52:15	9:58	9:58	10:06	8	O.K.
	(V)	5' / 14' V	10:11:30	10:12:40	10:12:40	10:14:45	2	O.K.
	(W)	6' / 12' V	10:31	10:33:45	10:33:45	10:38:45	5	O.K.

REMARKS Field Locate Holes T, U, V+W  
 SANITARIAN B. Baker BACKHOE K+K OTHERS \_\_\_\_\_  
 TEST HOLES USED IN SDA \_\_\_\_\_ AVG. PERC TIME \_\_\_\_\_ SQ. FT/BR \_\_\_\_\_  
 TRENCH WIDTH \_\_\_\_\_ INLET DEPTH \_\_\_\_\_ MAX. BOT DEPTH \_\_\_\_\_ EFFECTIVE S/W \_\_\_\_\_