

LAYOUT 9/23/2013 INSP 4 _____
INSP 2 _____ INSP 5 _____
INSP 3 _____ INSP 6 _____

ISSUE DATE: 12/21/12

PERMIT

P 544495

APPROVAL DATE: 10/2/2013

A _____

Tax ID # 05-377285

ON-SITE SEWAGE DISPOSAL SYSTEM TANK REPLACEMENT HOWARD COUNTY HEALTH DEPARTMENT BUREAU OF ENVIRONMENTAL HEALTH

Michael Bork IS PERMITTED TO INSTALL ALTER

ADDRESS: 11337 Old Hopkins Road PHONE NUMBER: 301-725-9057

SUBDIVISION: Flamewood Sec I LOT NUMBER: 8

ADDRESS: 11337 Old Hopkins Road PROPERTY OWNER: Michael Bork

SEPTIC TANK CAPACITY (GALLONS): 2000 OUTLET BAFFLE FILTER REQUIRED

PUMP CHAMBER CAPACITY (GALLONS): _____ COMPARTMENTED TANK REQUIRED

NUMBER OF BEDROOMS: _____ APPLICATION RATE: _____

SQUARE FOOTAGE OF HOUSE: _____

LINEAR FEET OF TRENCH REQUIRED: _____

LOCATION:	Set septic tank per plan. Confirm capability for access to drain field at layout inspection. Pump, crush and fill location of old septic tank for final approval of installation.
NOTES:	Do not order the septic tank until after layout inspection and Sanitarian approval. Layout inspection required prior to tank installation. Original septic tank must be properly abandoned before new tank installation. A written variance request is required for tanks deeper than 3 feet. A traffic bearing lid is required for tanks deeper than 4 feet.

PLANS APPROVED: Robert Bricker DATE: 12/19/12

- NOTE: PERMIT VOID AFTER 1 YEAR
- NOTE: CONTRACTOR RESPONSIBLE FOR SCHEDULING A PRE-CONSTRUCTION INSPECTION FOR ALL INSTALLATIONS
- NOTE: WATERTIGHT SEPTIC TANKS REQUIRED
- NOTE: ALL PARTS OF SEPTIC SYSTEM SHALL BE 100 FEET FROM ANY WATER WELL
- NOTE: MANHOLE RISERS REQUIRED ON ALL SEPTIC TANKS AND PUMP CHAMBERS

**NEITHER THE HOWARD COUNTY COUNCIL OR THE HEALTH DEPARTMENT IS
RESPONSIBLE FOR THE SUCCESSFUL OPERATION OF ANY SYSTEM
PERMITTEE RESPONSIBLE FOR OBTAINING FINAL APPROVAL ON THIS PERMIT
CALL 410-313-1771 FOR INSPECTION OF SEPTIC SYSTEM**

NOT TO SCALE

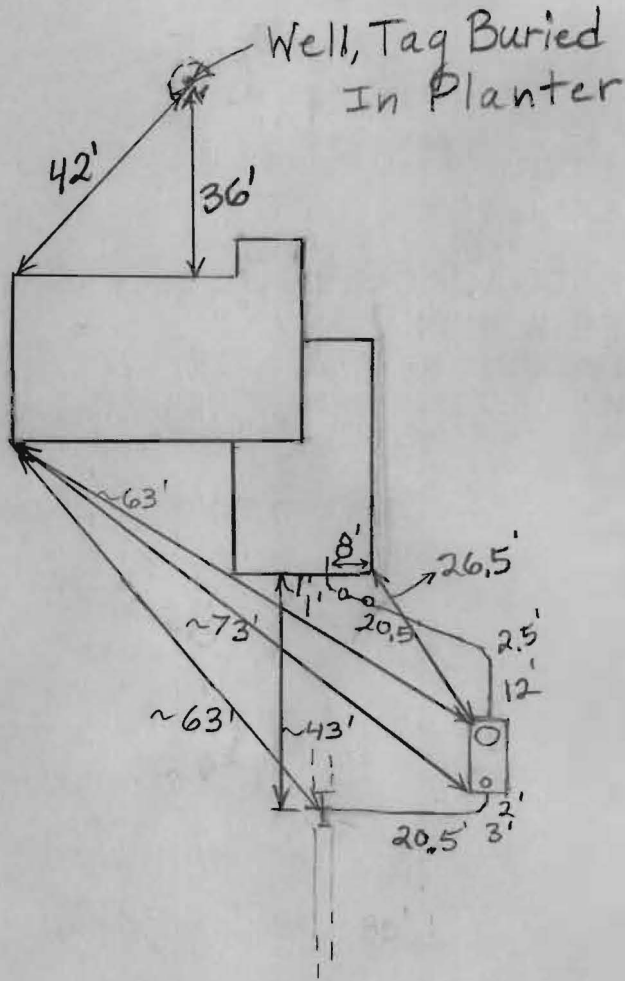

ROAD NAME

TRENCH/DRAINFIELD DATA		
WIDTH	INLET	BOTTOM
_____	_____	_____
NUMBER OF TRENCHES	_____	_____
TOTAL LENGTH	_____	_____
ABSORPTION AREA	_____	_____
DISTRIBUTION BOX LEVEL	_____	_____
DISTRIBUTION BOX BAFFLE	_____	_____
DISTRIBUTION BOX PORT	_____	_____

SEPTIC TANK DATA	
SEPTIC TANK 1 LEVEL	<u>Yes</u>
MANUFACTURER	<u>Babylon</u>
CAPACITY	<u>2000</u> GAL
SEAM LOC	<u>Top</u>
TANK LID DEPTH	<u>2-3</u>
BAFFLES	<u>Yes</u>
BAFFLE FILTER	<u>No</u>
MANHOLE LOC	<u>Front</u>
6" PORT LOC	<u>Rear</u>
WATERTIGHT TEST	<u>No</u>
SLOTTED	<u>Yes</u>
DATE ON LID	<u>Dry</u>
PUMP/SEPTIC TANK LEVEL	<u>N/A</u>
MANUFACTURER	_____
CAPACITY	_____ GAL
SEAM LOC	_____
TANK LID DEPTH	_____
BAFFLES	_____
BAFFLE FILTER	_____
MANHOLE LOC	_____
6" PORT LOC	_____
WATERTIGHT TEST	_____
SLOTTED	_____
DATE ON LID	_____

PRE-CONSTRUCTION:

9/23/2013 Tank layout done. (BB)

INSTALLATION: 10/2/2013 New tank set. Connected to existing trench with tee. O.K. to backfill. (BB)

FINAL INSPECTOR B. Baker

DATE OF APPROVAL 10/2/2013

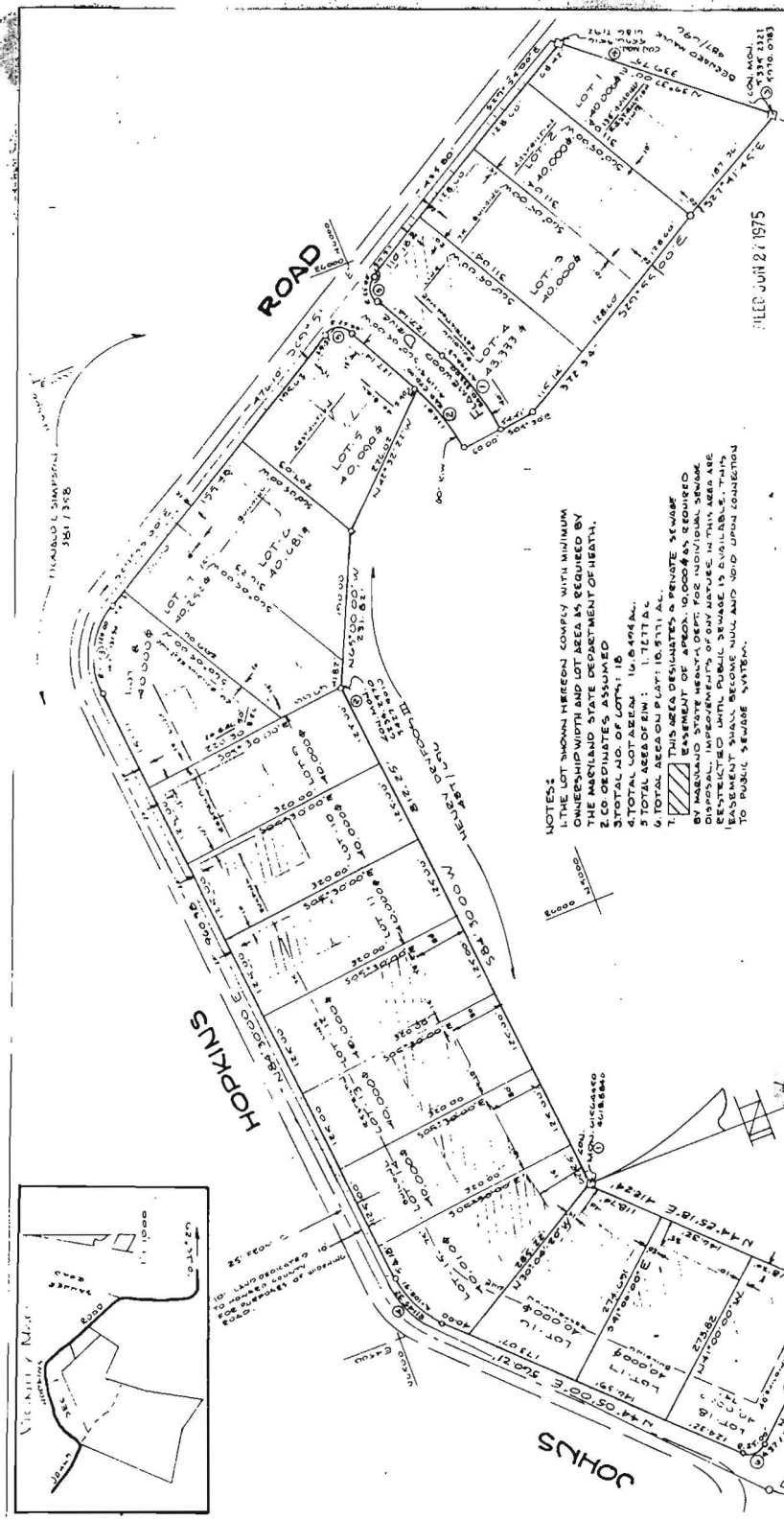

SECTION 1
FLAME WOOD
 FIFTH ELECTION DIST.
 HOWARD COUNTY, MARYLAND
 SCALE 1"=100' DEC. 19, 1974

RENN SURVEYS INC.
 BOX 55
 DAMASCUS MARYLAND
 253-3591

COORDINATES	CURVE DATA
1. 1176.840 448.880	NO. 1 1/4
2. 1213.870 448.780	ARC. 100.00
3. 1335.217 457.008	DELTA 90.00
4. 1471.117 462.000	CHORD 100.00
5. 1570.716 468.792	CHORD BEARING 270.00
6. 1638.000 475.000	CHORD BEARING 270.00

SURVEYOR'S CERTIFICATE

I HEREBY CERTIFY THAT THE PLAN SHOWN HEREON IS CORRECT AND ACCURATE AND WAS PREPARED BY ME OR UNDER MY CLOSE PERSONAL SUPERVISION AND TO THE BEST OF MY KNOWLEDGE AND BELIEF IT COMES INTO ACCORDANCE WITH THE ACTS OF THE GENERAL ASSEMBLY OF MARYLAND AND THE DECISIONS OF THE COURT OF APPEALS THEREOF. I FURTHER CERTIFY THAT THE PLAN MEETS THE REQUIREMENTS OF THE AUTHORIZED CODE OF MARYLAND AND IS IN ACCORDANCE WITH THE ACTS OF THE GENERAL ASSEMBLY OF MARYLAND AND THE DECISIONS OF THE COURT OF APPEALS THEREOF.

12-13-74 DATE
 [Signature] SURVEYOR'S SEAL

OWNER'S STATEMENT

WE, HENRY DEYPOON III PUBLIC WORKS DEPT., OWNER OF THE PROPERTY SHOWN HEREON, DO HEREBY STATE THAT THE PLAN SHOWN HEREON IS CORRECT AND ACCURATE AND WAS PREPARED BY ME OR UNDER MY CLOSE PERSONAL SUPERVISION AND TO THE BEST OF MY KNOWLEDGE AND BELIEF IT COMES INTO ACCORDANCE WITH THE ACTS OF THE GENERAL ASSEMBLY OF MARYLAND AND THE DECISIONS OF THE COURT OF APPEALS THEREOF. I FURTHER CERTIFY THAT THE PLAN MEETS THE REQUIREMENTS OF THE AUTHORIZED CODE OF MARYLAND AND IS IN ACCORDANCE WITH THE ACTS OF THE GENERAL ASSEMBLY OF MARYLAND AND THE DECISIONS OF THE COURT OF APPEALS THEREOF.

12-13-74 DATE
 [Signature] OWNER'S SEAL

NOTES:

- THE LOT SHOWN HEREON COMPLY WITH MINIMUM OWNERSHIP WIDTH AND LOT AREA AS REQUIRED BY THE MARYLAND STATE DEPARTMENT OF HEALTH.
- 2.00 ACRES ASSUMED
3. TOTAL NO. OF LOTS: 10
4. TOTAL LOT AREA: 400,000 SQ. FT.
5. TOTAL AREA OF NEW LOTS: 400,000 SQ. FT.
6. THIS AREA DESIGNATED AS PRIVATE SEWER EASEMENT STATE HEALTH DEPT. FOR INDIVIDUAL SEWER DISPOSAL IMPROVEMENTS OF ANY NATURE IN THIS AREA ARE TO BE PROVIDED BY THE OWNER OF THE SEWER EASEMENT SHALL BECOME VALID AND BIND UPON CONNECTION TO PUBLIC SEWER SYSTEM.

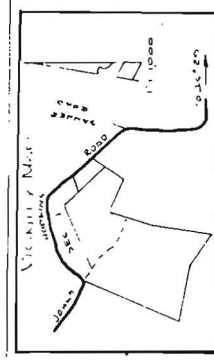

APPROVED FOR PRIVATE AND TRAVEL GENERAL PURPOSES COUNTY HEALTH DEPT.

COUNTY HEALTH OFFICER DATE

APPROVED HOWARD COUNTY OFFICE OF PLANNING AND ZONING

DIRECTOR DATE

PLANNING AND ZONING DEPARTMENT HOWARD COUNTY OFFICE OF PLANNING AND ZONING

APPROVED FOR PRIVATE AND TRAVEL GENERAL PURPOSES COUNTY HEALTH DEPT.

COUNTY HEALTH OFFICER DATE

APPROVED HOWARD COUNTY OFFICE OF PLANNING AND ZONING

DIRECTOR DATE

PLANNING AND ZONING DEPARTMENT HOWARD COUNTY OFFICE OF PLANNING AND ZONING

FILE INQUIRY NOTES

11337 Old Hopkins Road

DATE

RESULTS OF REVIEW FOR FILE

12/19/12 At 4:10 pm, I called (301-725-9057) the Bork residence and spoke with Mrs. Bork. I asked if the addition they are planning will have a basement. Her reply was "No". I informed her that the waiver they had requested would be granted (per MSD). A. Biden

FIGURE 2

