

## Wolf, Kevin

---

**From:** Wolf, Kevin  
**Sent:** Wednesday, January 09, 2013 9:29 AM  
**To:** 'Judi Miller'  
**Subject:** RE: Demo request

Judi,

Looking at the situation more closely, we (Health Department) determined to keep with our decision to have the well sealed prior to demo release.

Your comments below described in detail actually make more sense having the well sealed **before** demo. Foundation excavations will work around and work through the grouted well. This will and should disrupt the 'new' foundation excavations. A Licensed Well Driller has to fill in the void (well) to conditions which existed before the well was constructed, taking into account changes, if any, which have occurred since the time of construction. Demolishing the existing house prior sealing the well could potential contaminate the well void to have it sealed properly.

As COMAR 26.04.04.11D. *General Requirements* states: An abandoned well shall be filled and sealed in such a way that it will not act as a channel for the interchange of waters of undesirable quality with those whose quality is desirable, or present a hazard to the safety and well-being of humans or animals, or to cause a potential source of pollution to the waters of the State.

The well will be sealed with concrete, Portland cement grout, sodium-base bentonite clay, or combinations of these materials. Curing takes 24 to 48 hours. Driller reports this process in detail and submits the abandonment form in its entirety to all Approving Authorities. Once we receive this report, I will release the demo request on this structure.

Thanks,

Kevin M. Wolf, R.S., R.E.H.S.  
Bureau of Environmental Health  
Well & Septic Program  
Groundwater Mgmt. Sec.  
7178 Columbia Gateway Dr.  
Columbia, MD 21046  
(o) 410-313-2645  
(f) 410-313-2648



### CONFIDENTIALITY NOTICE

**This message and the accompanying documents are intended only for the use of the individual or entity to which they are addressed and may contain information that is privileged, confidential, or exempt from disclosure under applicable law. If the reader of this email is not the intended recipient, you are hereby notified that you are strictly prohibited from reading, disseminating, distributing, or copying this communication. If you have received this email in error, please notify the sender immediately and destroy the original transmission.**

---

**From:** Judi Miller [mailto:JMiller@abd-architects.com]  
**Sent:** Tuesday, January 08, 2013 4:45 PM  
**To:** Wolf, Kevin

MARYLAND DEPARTMENT OF THE ENVIRONMENT, WATER MANAGEMENT ADMINISTRATION  
1800 Washington Blvd., Baltimore, Maryland 21230 (410) 537-3784

\*\*\*\*\*  
WATER WELL ABANDONMENT-SEALING REPORT FORM  
\*\*\*\*\*

SUBMIT COPIES OF COMPLETED FORM TO:

- \* COUNTY ENVIRONMENT AGENCY (contact MDE, WMA if address needed)
- \* WELL OWNER
- \* MDE, WATER MANAGEMENT ADMINISTRATION, WELL PROGRAM

DATE WELL ABANDONED: 1-21-13 (month/day/year)

\* PERMIT NUMBER-OF ABANDONED WELL (if any) \_\_\_\_\_

\* PERMIT NUMBER OF REPLACEMENT WELL \_\_\_\_\_

\* PERSON ABANDONING WELL: Charles Youngbar

WELL DRILLERS LICENSE NUMBER: 3260  
CIRCLE: MWD/MSD/MGD

\* OWNER'S NAME: Robert Miller

SITE LOCATION MAP

\* WELL LOCATION:  
COUNTY: Howard  
NEAREST TOWN: Elliott City  
TAX MAP 0025 BLOCK 0022 PARCEL 0050  
SUBDIVISION: \_\_\_\_\_  
SECTION: \_\_\_\_\_ LOT: \_\_\_\_\_  
NEAREST ROAD: 4405 College Ave  
Elliott City Md

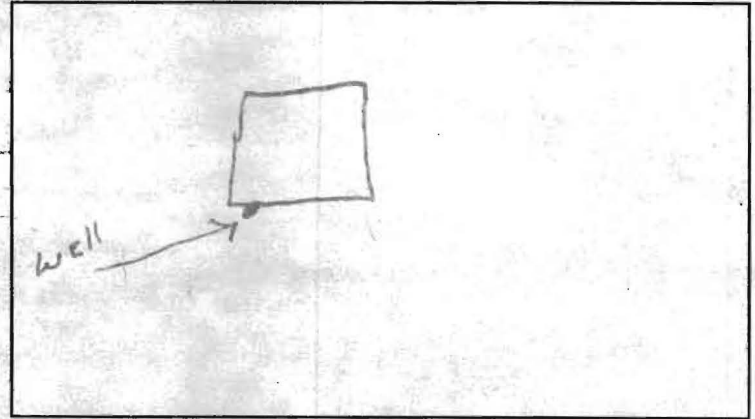

\* TYPE OF WELL BEING ABANDONED:

- DRILLED  JETTED
- BORED/AUGERED  HAND DUG
- OTHER (specify) \_\_\_\_\_

OK  
fw

\* USE CODE:

- DOMESTIC  MUNICIPAL/PUBLIC
- IRRIGATION  INDUSTRIAL
- TEST/OBSERVATION  GEOTHERMAL

\* TYPE OF CASING:

- STEEL  PLASTIC
- CONCRETE  OTHER (specify) \_\_\_\_\_

\* SIZE OF CASING: 6 INCHES IN DIAMETER

\* DEPTH OF WELL: 90 FEET DEEP

\* WAS ANY CASING REMOVED?  YES  NO  
if yes, length removed, in feet: 7

\* WAS CASING RIPPED OR PERFORATED?  YES  NO

LOG OF SEALING MATERIAL

MATERIAL	FEET	
	FROM	TO
hole plug	90	8
clean fill	7	0
VOLUME OF MATERIAL USED		
<u>25 BAGS</u>		

SIGNATURE-MASTER WELL DRILLER OR SUPERVISING SANITARIAN \_\_\_\_\_

LICENSE # 3260

MWD/MSD/MGD  
CIRCLE ONE

DATE 1-22-13



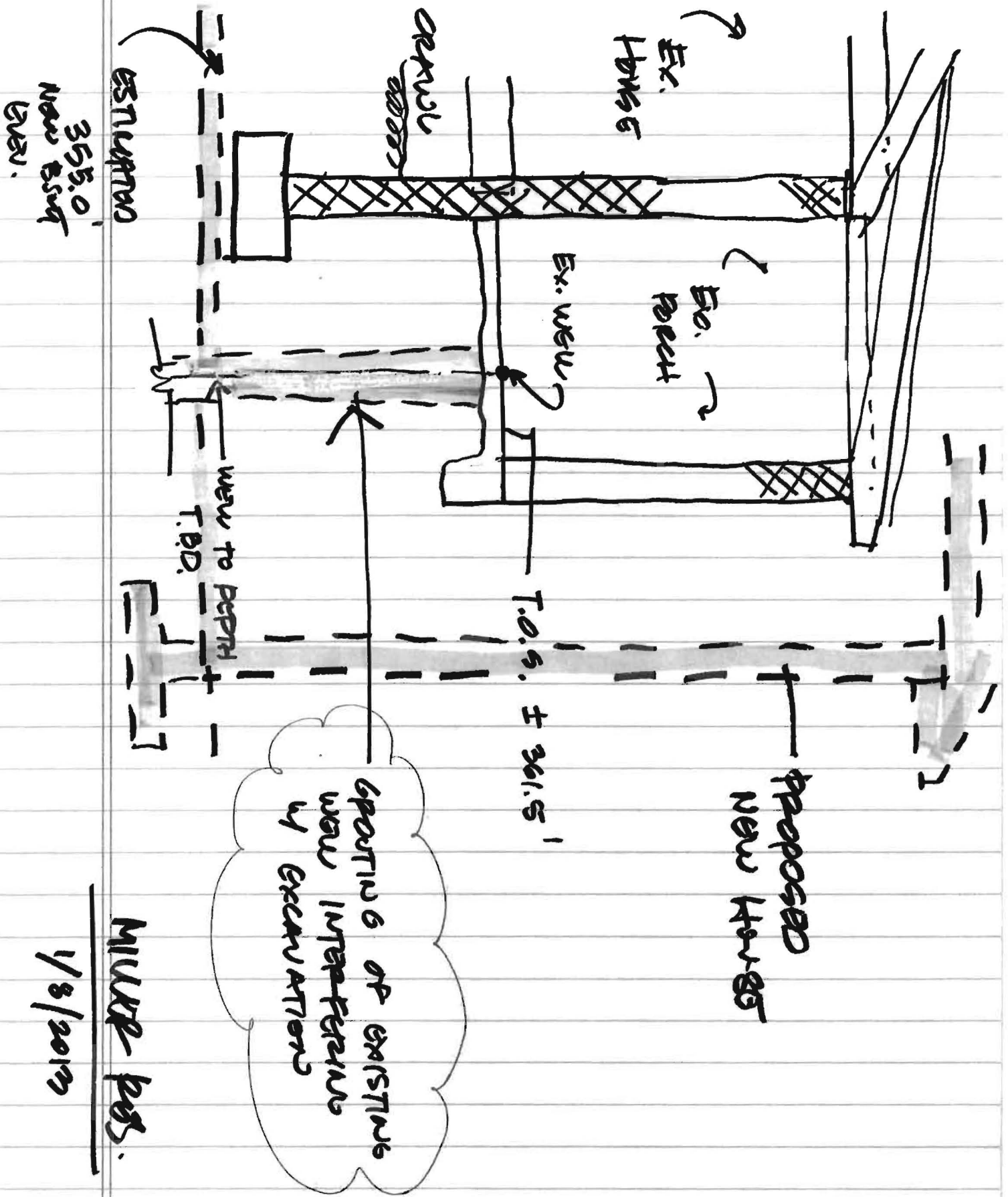

SPOTTING OF EXISTING wall INTERFERING by EXCAVATIONS

MURP Pgs.

1/8/2013