

Bureau of Environmental Health
 7178 Gateway Drive Columbia, MD 21046
 (410) 313-2640 Fax (410) 313-2648
 TDD (410) 313-2323 Toll Free 1-866-313-6300
 website: www.hchealth.org

Maura J. Rossman, M.D., Health Officer

RECEIPT DATE: 6/24/13

ONSITE SEWAGE DISPOSAL SYSTEM

P 545075

INSTALLATION APPROVAL DATE: 8/5/13

**PERMIT
REPAIR**

A _____

PROPERTY ADDRESS: 15055 Old Frederick Road

SUBDIVISION: Harbin Acres

LOT: 3

TAX ID: 04-335864

CONTRACTOR: Fogle's Septic Clean Inc.

EMAIL: kurt@foglesinc.com

CONTRACTOR ADDRESS: 580 Obrecht Road, Sykesville, MD 21784

PHONE: 410-795-5670

PROPERTY OWNER: George E. Harbin

EMAIL: _____

OWNER ADDRESS: 15055 Old Frederick Road, Woodbine, MD 21797

PHONE: 410-707-4082

SEPTIC TANK SIZE (GALLONS): Existing

PUMP CHAMBER CAPACITY (GALLONS): _____ PUMP SIZE: N/A

NUMBER OF BEDROOMS: 3 HOUSE SQ. FT. N/A APPLICATION RATE: 1.2

DISTRIBUTION SYSTEM: GRAVITY FED LOW PRESSURE DOSED

n 58 ton stone.

TRENCHES:	LINEAR FEET REQUIRED: <u>100'</u>	INLET DEPTH: <u>3'</u>
	TRENCH WIDTH: <u>3</u>	MAXIMUM BOTTOM DEPTH: <u>6'</u>
	MINIMUM SPACE BETWEEN TRENCHES: _____	EFFECTIVE AREA BEGINNING DEPTH: _____
LOCATION:	TO BE STAKED BY SANITARIAN DURING PRE-CONSTRUCTION INSPECTION.	
NOTES:	<i>Install 2x50' trenches just below existing D.W. Manhole riser to be added on ex. tank. Pump and collapse ex. D.W.</i>	

ISSUED BY: K. Wolf ISSUE DATE: 7/23/13 EXPIRATION DATE: 7/23/14

- NOTE: CONTRACTOR MUST SCHEDULE A PRE-CONSTRUCTION INSPECTION PRIOR TO BEGINNING ANY INSTALLATION
- NOTE: CONTRACTOR MUST SCHEDULE AN INSPECTION AND GAIN APPROVAL OF ALL COMPONENTS PRIOR TO COVERING
- NOTE: STONE MUST BE APPROVED BY HEALTH DEPARTMENT AND GRAVEL TICKET MUST BE AVAILABLE FOR REVIEW.
- NOTE: WATERTIGHT SEPTIC TANKS REQUIRED
- NOTE: ALL PARTS OF SEPTIC SYSTEM SHALL BE AT LEAST 100 FEET DOWNGRAIENT FROM ANY WATER WELL
- NOTE: MANHOLE RISERS REQUIRED ON ALL SEPTIC TANKS AND PUMP CHAMBERS
- NOTE: AN ELECTRICAL PERMIT IS REQUIRED FOR INSTALLATION OF ANY ELECTRICAL COMPONENTS OF THE SYSTEM

**NEITHER THE HOWARD COUNTY COUNCIL NOR THE HEALTH DEPARTMENT IS RESPONSIBLE FOR THE SUCCESSFUL OPERATION OF ANY SYSTEM.
 PERMITTEE RESPONSIBLE FOR OBTAINING FINAL APPROVAL ON THIS PERMIT.
 CALL 410-313-1771 TO SCHEDULE INSPECTIONS.**

NOT TO SCALE

Ex. Barn

Ex. Pool

Ex. Fence line

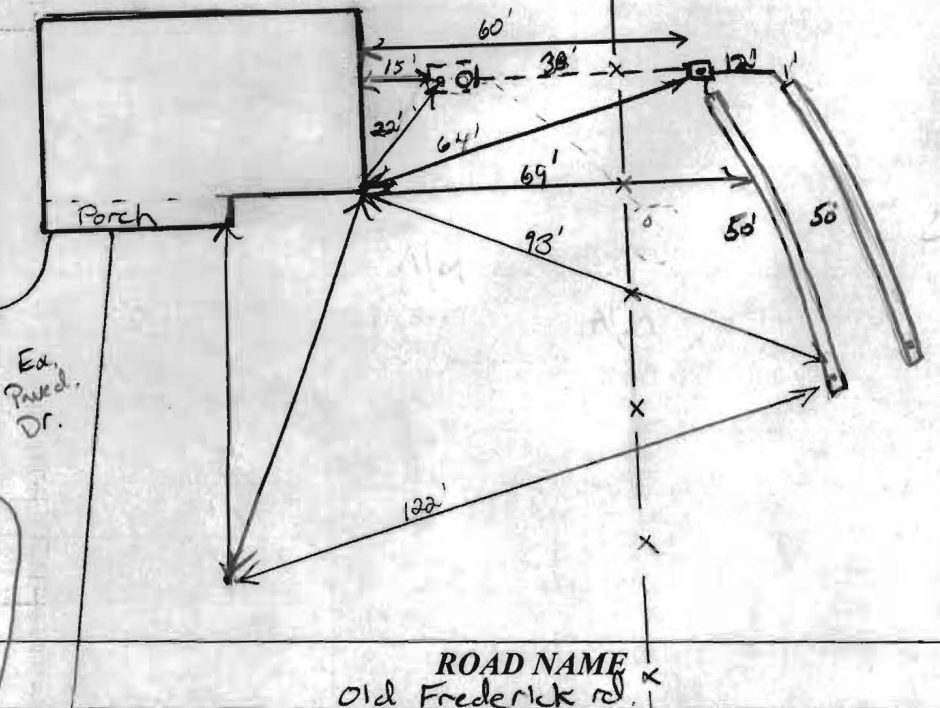

TRENCH/DRAINFIELD DATA

WIDTH	INLET	BOTTOM
3	3	6
NUMBER OF TRENCHES		2
TOTAL LENGTH		100'
ABSORPTION AREA		300' ± SW
DISTRIBUTION BOX LEVEL		Levelers
DISTRIBUTION BOX BAFFLE		Yes
DISTRIBUTION BOX PORT		Yes

Ex. SEPTIC TANK DATA

SEPTIC TANK I LEVEL	Yes
MANUFACTURER	?
CAPACITY	1250/1000 GAL
SEAM LOC	mid
TANK LID DEPTH	
BAFFLES	Yes (New R.)
BAFFLE FILTER	
MANHOLE LOC	Rear
6" PORT LOC	Front
WATERTIGHT TEST	OK
SLOTTED	NO
DATE ON LID	N/A
PUMP/SEPTIC TANK LEVEL	N/A
MANUFACTURER	
CAPACITY	GAL
SEAM LOC	
TANK LID DEPTH	
BAFFLES	
BAFFLE FILTER	
MANHOLE LOC	
6" PORT LOC	
WATERTIGHT TEST	
SLOTTED	
DATE ON LID	

ROAD NAME
Old Frederick rd.

PRE-CONSTRUCTION:

7/22/13 layout given @ time of perc testing. Ex. Drywell to be pumped and collapsed. Install minimum of 2x50' trenches just below failed Drywell. Contour shot in field. Trenches staked out in field. Call for inspection (KW)

INSTALLATION:

8/5/13 system completed on weekend. left open for inspection. Drywell pumped, collapsed. Dbox knocked. Depth of stone OK per specs on permit. OK to cover.

FINAL INSPECTOR

[Signature]

DATE OF APPROVAL

8/5/13