

C1 7106 SEQUENCE NO. (MDE USE ONLY)

STATE OF MARYLAND WELL COMPLETION REPORT

THIS REPORT MUST BE SUBMITTED WITHIN 45 DAYS AFTER WELL IS COMPLETED.

COUNTY NUMBER 13

(THIS NUMBER IS TO BE PUNCHED IN COLS. 3-6 ON ALL CARDS)

FILL IN THIS FORM COMPLETELY PLEASE TYPE

ST/CO USE ONLY DATE RECEIVED

DATE WELL COMPLETED

Depth of Well

PERMIT NO. FROM "PERMIT TO DRILL WELL" 40-95-1395

OWNER Bassler Alfred STREET OR RFD Basslers Way TOWN Ellicott City SUBDIVISION Walnut Creek SECTION 1 LOT 15

WELL LOG Not required for driven wells

STATE THE KIND OF FORMATIONS PENETRATED, THEIR COLOR, DEPTH, THICKNESS AND IF WATER BEARING

Table with columns: DESCRIPTION, FEET (FROM, TO), check if water bearing. Rows include Top Soil, Sand Stone, White mica, Sand Stone, White mica, Sand Stone, White mica, Sand Stone, White mica.

GROUTING RECORD WELL HAS BEEN GROUTED (Y) (N)

TYPE OF GROUTING MATERIAL (Circle one) CEMENT (CM) BENTONITE CLAY (BC) NO. OF BAGS 8 NO. OF POUNDS 500 GALLONS OF WATER 48 DEPTH OF GROUT SEAL (to nearest foot) from 0 ft. to 20 ft.

CASING RECORD casing types insert appropriate code below MAIN CASING TYPE PL Nominal diameter top (main) casing (nearest inch) 6 Total depth of main casing (nearest foot) 22

OTHER CASING (if used) diameter inch depth (feet) from to

SCREEN RECORD screen type or open hole insert appropriate code below (S) STEEL (BR) BRASS (PL) PLASTIC (HO) OPEN HOLE (OT) OTHER

DEPTH (nearest ft.) 1 2 3 4 5 6 7 8 9 10 11 12 13 14 15 16 17 18 19 20 21 22 23 24 25 26 27 28 29 30 31 32 33 34 35 36 37 38 39 40 41 42 43 44 45 46 47 48 49 50 51 52 53 54 55 56 57 58 59 60 61 62 63 64 65 66 67 68 69 70 71 72 73 74 75 76

NUMBER OF UNSUCCESSFUL WELLS: 0

WELL HYDROFRACTURED (Y) (N)

CIRCLE APPROPRIATE LETTER A WELL WAS ABANDONED AND SEALED WHEN THIS WELL WAS COMPLETED E ELECTRIC LOG OBTAINED P TEST WELL CONVERTED TO PRODUCTION WELL

I HEREBY CERTIFY THAT THIS WELL HAS BEEN CONSTRUCTED IN ACCORDANCE WITH COMAR 26.04.04 "WELL CONSTRUCTION" AND IN CONFORMANCE WITH ALL CONDITIONS STATED IN THE ABOVE CAPTIONED PERMIT, AND THAT THE INFORMATION PRESENTED HEREIN IS ACCURATE AND COMPLETE TO THE BEST OF MY KNOWLEDGE.

DRILLERS LIC. NO. M S D 113

DRILLERS SIGNATURE (MUST MATCH SIGNATURE ON APPLICATION) LIC. NO. D

SITE SUPERVISOR (sign. of driller or journeyman responsible for sitework if different from permittee)

C 2 DEPTH (nearest ft.)

1 2 3 4 5 6 7 8 9 10 11 12 13 14 15 16 17 18 19 20 21 22 23 24 25 26 27 28 29 30 31 32 33 34 35 36 37 38 39 40 41 42 43 44 45 46 47 48 49 50 51 52 53 54 55 56 57 58 59 60 61 62 63 64 65 66 67 68 69 70 71 72 73 74 75 76

GRAVEL PACK IF WELL DRILLED WAS FLOWING WELL INSERT F IN BOX 68

MDE USE ONLY (NOT TO BE FILLED IN BY DRILLER) T (E.R.O.S.) W Q

70 72 74 75 76 TELESCOPE CASING LOG INDICATOR OTHER DATA

C 3 PUMPING TEST

HOURS PUMPED (nearest hour) 3

PUMPING RATE (gal. per min.) 10

METHOD USED TO MEASURE PUMPING RATE Bucket

WATER LEVEL (distance from land surface) BEFORE PUMPING 24 ft.

WHEN PUMPING 45 ft.

TYPE OF PUMP USED (for test) A air P piston T turbine C centrifugal R rotary O other (describe below) J jet S submersible

PUMP INSTALLED DRILLER INSTALLED PUMP (CIRCLE) (YES or NO) YES (NO)

IF DRILLER INSTALLS PUMP, THIS SECTION MUST BE COMPLETED FOR ALL WELLS.

TYPE OF PUMP INSTALLED PLACE (A,C,J,P,R,S,T,O) IN BOX 29

CAPACITY: GALLONS PER MINUTE (to nearest gallon) 31 35

PUMP HORSE POWER 37 41

PUMP COLUMN LENGTH (nearest ft.) 43 47

CASING HEIGHT (circle appropriate box and enter casing height) (+) above LAND SURFACE (-) below 2 (nearest foot)

LOCATION OF WELL ON LOT SHOW PERMANENT STRUCTURE SUCH AS BUILDING, SEPTIC TANKS, AND /OR LANDMARKS AND INDICATE NOT LESS THAN TWO DISTANCES (MEASUREMENTS TO WELL)

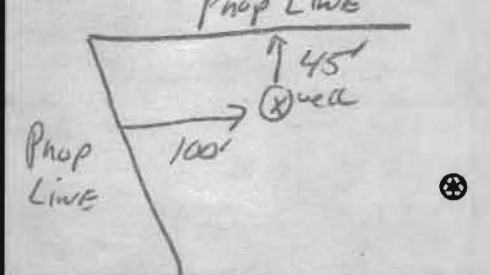

B 1 0562
1 2 3 6

SEQUENCE NO. (MDE USE ONLY)

STATE OF MARYLAND
APPLICATION FOR PERMIT TO DRILL WELL

please type

STATE PERMIT NUMBER

HO-95-1395
70 fill in this form completely 79

Date Received (APA)

OWNER INFORMATION

8 MM DD YY 13
15 Last Name Owner First Name 34
21 22 23 24 25 26 27 28 29 30 31 32 33 34
36 Street or RFD 55
57 Town 70 State 72 Zip 76
Bassler Venture LLC
15950 N. AVE
Lisbon MD. 21765

B 3 LOCATION OF WELL

8 COUNTY 21
23 SUBDIVISION 42
SECTION PHASE I LOT 15
44 46 48 50
52 NEAREST TOWN
CLARKSVILLE
MILES FROM TOWN (enter 0 if in town) 2 MI
73 76 77 78

DRILLER INFORMATION

Driller's Name M SD 117
76 License No. 81
Firm Name
Address
Signature Date
Ralph E. Mayne
Ralph E. Mayne Inc
12024 Handy rd. Mt Airy MD 21771
Ralph E. Mayne 3-30-07

B 4 DIRECTION OF WELL FROM TOWN (CIRCLE BOX)

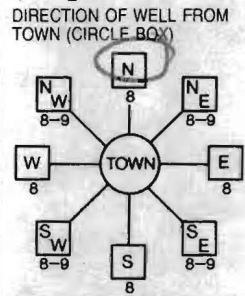

11 NEAR WHAT ROAD 30
ON WHICH SIDE OF ROAD (CIRCLE APPROPRIATE BOX)
34 37
DISTANCE FROM ROAD
ENTER FT OR MI 38 39
TAX MAP: 28 BLK: 11 PARCEL 49
Basslers Way
Keeler

B 2 WELL INFORMATION

1 2 APPROX. PUMPING RATE (GAL. PER MIN.) 5
8 12
AVERAGE DAILY QUANTITY NEEDED (GAL. PER DAY) 14 500 20

USE FOR WATER (CIRCLE APPROPRIATE BOX)

- DOMESTIC POTABLE SUPPLY & RESIDENTIAL IRRIGATION
- FARMING (LIVESTOCK WATERING & AGRICULTURAL IRRIGATION)
- INDUSTRIAL, COMMERCIAL, DEWATERING
- PUBLIC WATER SUPPLY WELL
- TEST, OBSERVATION, MONITORING
- GEO-THERMAL

NOT TO BE FILLED IN BY DRILLER HEALTH DEPARTMENT APPROVAL

Howard 13
COUNTY NAME COUNTY NO.
STATE SIGNATURE INSERT S
DATE ISSUED 1/21/2008 Brian Baber 1/21/2009
43 MM DD YY 48 CO SIGNATURE EXP. DATE
NORTH GRID 510 000 EAST GRID 817 000
50 55 57 63

APPROXIMATE DEPTH OF WELL 150 FEET
24 28

APPROXIMATE DIAMETER OF WELL 64 NEAREST INCH

METHOD OF DRILLING (circle one)

BORED (or Augered) JETTED Jetted & DRIVEN
30 AIR-ROTary AIR-PERCussion ROTARY (Hydraulic Rotary)
37 CABLE REVerse-ROTary DRive-POINT
other

REPLACEMENT OR DEEPEMED WELLS (CIRCLE APPROPRIATE BOX)

- THIS WELL WILL NOT REPLACE AN EXISTING WELL
 - THIS WELL WILL REPLACE A WELL THAT WILL BE ABANDONED AND SEALED
 - THIS WELL WILL REPLACE A WELL THAT WILL BE USED AS A STANDBY-CONTACT LOCAL APPROVING AUTHORITY FOR POLICY ON STANDBY WELLS
 - THIS WELL WILL DEEPEAN AN EXISTING WELL
- PERMIT NUMBER OF WELL TO BE REPLACED OR DEEPEMED (IF AVAILABLE) 41 52

SHOW MAJOR FEATURES OF BOX & LOCATE WELL WITH AN X

- SOURCES OF DRILLING WATER
- well
 -
 -

WRITE THE BOX NUMBER FROM THE MAP HERE
E 8147
N 508510

DRAW A SKETCH BELOW SHOWING LOCATION OF WELL IN RELATION TO NEARBY TOWNS AND ROADS AND GIVE DISTANCE FROM WELL TO NEAREST ROAD JUNCTION

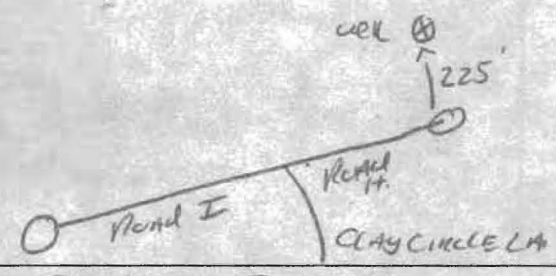

Not to be filled in by driller (MDE OR COUNTY USE ONLY)

APPROX. PERMIT NUMBER G
PERMIT No. HO-95-1395
70 71 72 73 74 75 76 77 78 79

SPECIAL CONDITIONS

Drill Well Per SP-06-07, Radium Sample

WCR15

HOWARD COUNTY HEALTH DEPARTMENT
BUREAU OF ENVIRONMENTAL HEALTH
WELL & SEPTIC PROGRAM
TEL: (410)313-1771 FAX: (410)313-2648

Information Form for the Installation of the Well Pump, Pitless Adapter, and Supply Piping

NOTE: The installer is responsible for requesting an inspection prior to 9 am on the day of the desired inspection. No work is to be covered until approved by the Health Department. All installations must comply with the National Standard Plumbing Code (NSPC, as amended locally) and COMAR 26.04.04 (MD Well Construction Regulations). Submission of a complete form is required prior to Use and Occupancy approval.

Company Name: Trinity Quality Homes Telephone #: 410-480-0023
Address: 3075 Park Ave # 301
Ellicott City MD 21043

(Must circle one) Licensed Plumber Licensed Well Driller Licensed Well Pump Installer

License # and name of individual responsible for the field installation:

Name (Print): Michael Bowersox License# 11202

*A licensed individual must perform the actual installation. Apprentices must be under the supervision of a licensed journeyman or master plumber, pump installer or well driller. Licenses may be subjected to field verification. Unlicensed individuals may be reported to the appropriate licensing agency.

Name of Property Owner: Trinity Quality Homes Telephone #: 410-480-0023
Subdivision: Walnut Creek Lot #: 15 Well Tag #: HO-95-1395
Site Address: 12217 Basslers Way
Clarksville MD 21029

Submersible Pump Data

Make: Myers
Model #: 25T52-12Plus-P4-2
Pump Capacity 12 GPM
Well Yield: 10 GPM

Pitless Adapter

Make: American Granby
Model#: LF200
Depth: yes (36" min)
NSF/WSC approved: yes

Well Cap and Electric Conduit

Two piece watertight cap: yes
Screened, vented well cap: yes
Cap secured to casing: yes
Conduit min 18" B.G.: yes
Conduit secured to well cap: yes

Depth of well encountered at time of pump installation: 240 (feet)

If pump capacity exceeds well yield, a low water cut off switch is required by NSPC 1990 Section 17.8.4

Torque arrestors Cable guards, or other acceptable method used- Must circle one

Safety rope, if used, attached to brass rope adapter or other acceptable method inside of well casing NO

Piping to house

Type: plastic black
PSI: yes (160 psi min)
Depth of supply line: yes (36" min)

House Connection

PVC sleeve to undisturbed soil at wall penetration: yes
Length of sleeve(5' minimum from foundation): 10ft
Sleeve sealed properly: yes

The water supply line is required to be at least ten feet from the septic tank, pump chamber, sewage piping, distribution box, drainfields, and sewage reserve area. If this cannot be accomplished, contact this office for approval prior to installation.

Signature of company representative responsible for installation

date

8-2-14

For Health Department Use Only - Not to be completed by Installer

Date Insp. Requested: 12/23/14 Date Insp. Approved: 12/23/14 Inspector: SC

- Inspection Data: Pitless adapter watertight & water supply line at least 36" below grade ✓
- Two piece cap installed and attached to casing securely ✓
- Elec. conduit extends at least 18" below grade/attached to cap properly ✓
- Safety rope not outside of well cap/casing ✓
- Correct well tag attached properly and casing 8" above finished grade ✓
- Water supply line sleeved adequately at house connection ✓
- Adequate grout observed below pitless adapter ✓

Trinity ✓ house connection submerged, can't verify 12/23 SC
uncovered ✓

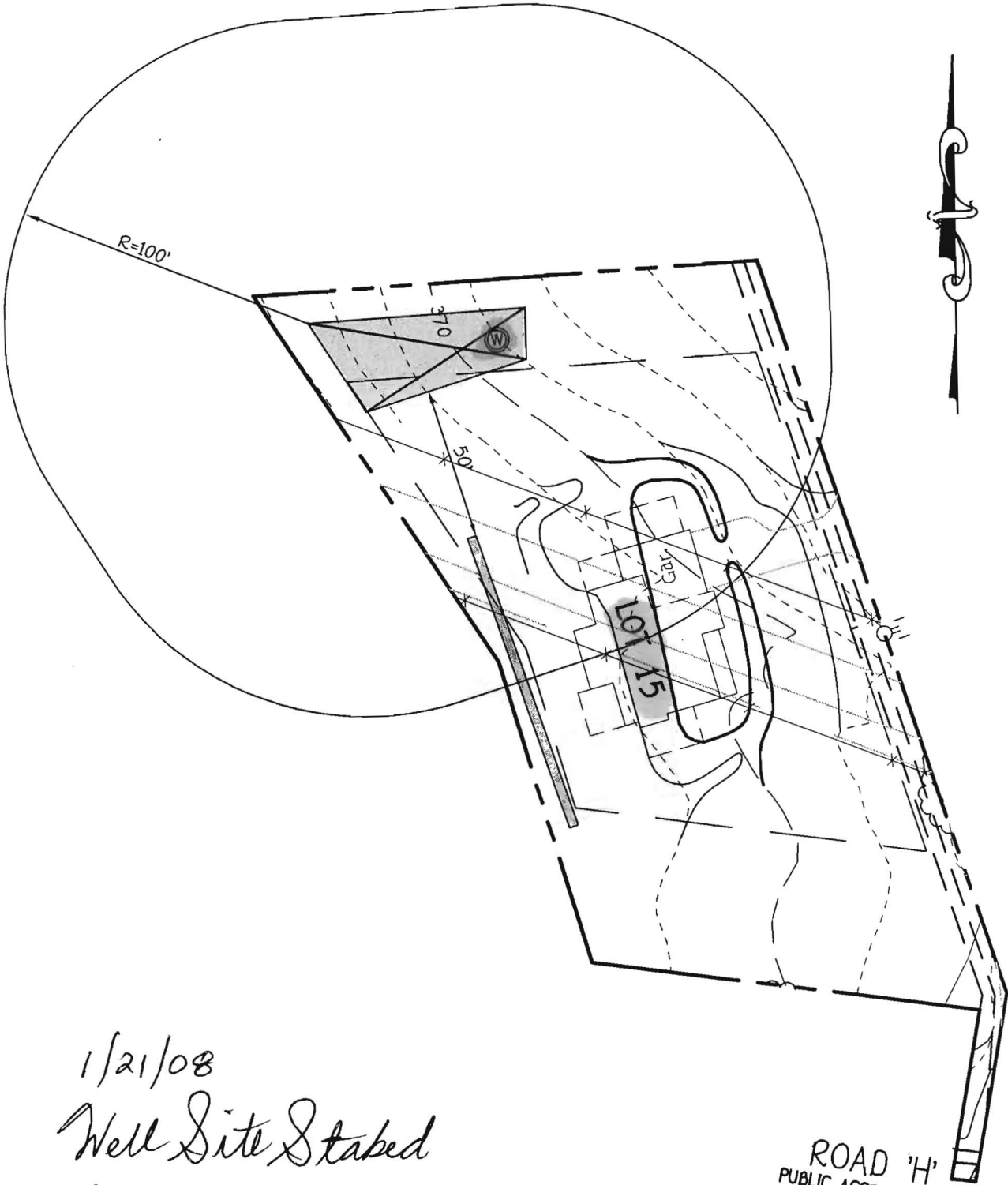

1/21/08
 Well Site Staked
 by 

ROAD 'H'
 PUBLIC ACCESS PLACE

FISHER, COLLINS & CARTER, INC.
 CIVIL ENGINEERING CONSULTANTS & LAND SURVEYORS
 CENTENNIAL SQUARE OFFICE PARK - 10272 BALTIMORE NATIONAL PIKE
 ELLICOTT CITY, MARYLAND 21042
 (410) 461 - 2955

WELL LOCATION PLAN
 LOT 15
 ZONED RC-DEO & RR-DEO
 TAX MAP No. 28 GRID No. 4, 5, 10-12, 17 & 18
 PARCEL No. 49
 FIFTH ELECTION DISTRICT
 HOWARD COUNTY, MARYLAND
 SCALE 1"=50' DATE: FEBRUARY 26, 2007



7178 Columbia Gateway Dr., Columbia, MD 21046
(410) 313-2640 Fax (410) 313-2648
TDD (410) 313-2323 Toll Free 1-866-313-6300
website: www.hchealth.org

Penny E. Borenstein, M.D., M.P.H., Health Officer

TO ALL INTERESTED PARTIES

When submitting a well application for a proposed well for new construction, please indicate one of the following:

Well Site Location:

Walnut Creek	15	Road 'H'
Subdivision/Property Name	Lot #	Road Name

The well site has been staked by Fisher, Collins & Carter, Inc.,
(professional land surveyor or company employing professional land surveyors)
on 01/12/07 (date) and does not require a site inspection.

The well driller, builder or property owner will call the Health Department to schedule a time to meet in the field to verify the proposed well site location.

This sheet, along with two copies of an acceptable well site plan, must be attached to the green well permit application.

Revised 3/11/05

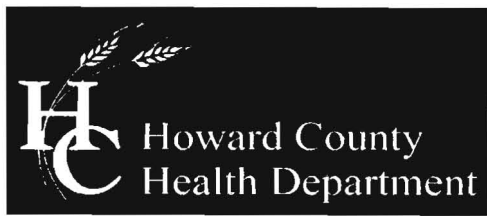

Bureau of Environmental Health
7178 Columbia Gateway Drive, Columbia, MD 21046-2147
(410) 313-2640 Fax (410) 313-2648
TDD (410) 313-2323 Toll Free 1-866-313-6300
website: www.hchealth.org

Peter L. Beilenson, M.D., M.P.H., Health Officer

May 9, 2008

Heritage Realty and Land Development
15950 North Avenue
P. O. Box 482
Lisbon, Maryland 21765

RE: Walnut Creek Subdivision, Lot 15
Well Tag: HO-95-1395 *Basslers Way*

To Whom It May Concern:

A sample was collected during a yield test on April 14, 2008 and submitted to Department of Health & Mental Hygiene Laboratories to assess the possible presence of **Gross Alpha** and **Gross Beta** in the future well water supply. **Gross Alpha** and **Gross Beta (GA / GB)** measure the total alpha and beta particle activity in a water supply. These naturally occurring radioactive nuclides have been demonstrated to be present in a certain type of geologic formation known as the Baltimore Gneiss which exists in your area of development within the County.

Results from this screening revealed a **Gross Alpha** of 17.0 ± 3.0 picocuries/liter (pCi/L); while the **Gross Beta** level was 10.0 ± 2.0 pCi/L. The **Gross Alpha** result was above its **maximum contaminant level (MCL)** of 15 pCi/L, while the **Gross Beta** level was below its target value of 50 pCi/L (roughly equivalent to the **annual dose rate** of 4 millirem/year).

Since the **Gross Alpha** finding exceeded its **MCL**, additional testing for **Radium** will be necessary to verify existing levels prior to occupancy. Alternatively, you may install treatment designed to reduce **Gross Alpha, Gross Beta** and **Radium**, plus provide post treated results (short and long term **GAGB**, plus **Radium**) confirming that levels are in conformance with existing standards. **Additionally**, the owners will be required to sign an "AGREEMENT FOR APPROVAL OF AN INDIVIDUAL DRINKING WELL WITH AN ON-SITE TREATMENT SYSTEM" as part of the Use and Occupancy process. Moreover, keep in mind that the standard potability parameters required for occupancy will still be needed.

A copy of the test results is enclosed for your information. Please call this office at 410-313-1773 if you have any further questions or concerns.

Sincerely,

A handwritten signature in cursive script that reads 'Bert Nixon'.

Bert Nixon, Director
Bureau of Environmental Health

cc: Barry Glotfelty, MDE Water Mgmt., Groundwater
Well & Septic property file

FOUNTAIN VALLEY ANALYTICAL LABORATORY, INC.

1413 Old Taneytown Rd. Westminster, MD (410) 848-1014 (410) 876-4554 FAX (410) 848-0298

REPORT OF ANALYSIS

Laboratory ID #: 101760 Account #: 4035
Reference: Walnut Creek Lot 15 Company: Trinity Quality Homes, Inc.
Location: 12217 Basslers Way Requested By: Michael Pfau
Clarksville, MD 21029 Source: Well Water
Date/ Time Collected: 7/7/2015 1110 Site: Pressure Tank
Date/Time Rec'd: 7/7/2015 1320 Treatment: **
Chlorine ppm: Free: ND Total: ND pH: 7.1
Collected By: J. Yeager 6176JY Well #: HO-95-1395

PARAMETERS	RESULTS	UNITS	REFERENCE	METHOD	DATE/TIME/ANALYST
Gross Alpha, Short Term	13.0	pCi/L	15	900.0	7/10/2015 / 0627 / MJN
Gross Beta, Short Term	10.9	pCi/L	50	900.0	7/10/2015 / 0627 / MJN
Gross Alpha, Long Term	13.1	pCi/L	15	900.0	7/16/2015 / 0651 / MJN
Gross Beta, Long Term	11.6	pCi/L	50	900.0	7/16/2015 / 0651 / MJN
Radium-226	3.4	pCi/L	****	903.1	7/16/2015 / 0935 / MJN
Radium-228	1.5	pCi/L	****	Ra-05	7/15/2015 / 1147 / SN

Pre-Treatment

NOTES

- ****Radium 226 and Radium 228 combined have a reference of 5 pCi/L
 - **Softener/Neutralizer/Sediment Filter
 - Long Term Gross Alpha Detection Limit: 2.2 pCi/L; Long Term Gross Beta Detection Limit: 2.3 pCi/L
 - pCi/L = picocuries per liter
 - Radium 226 Detection Limit: 0.2 pCi/L; Radium 228 Detection Limit: 0.8 pCi/L
 - Results less than or within the reference range are considered satisfactory and within potable water limits at the time of sampling.
 - Short Term Gross Alpha Detection Limit: 1.8 pCi/L; Short Term Gross Beta Detection Limit: 2.2 pCi/L
 - Sub-contracted to Reference Lab #278
 - ND:None Detected
 - Visual well check: Sealed, vented cap
 - pH & Chlorine level tested on site
- Reason for Test : Use & Occupancy
Building Permit # : 14002848

Date Reported: 7/17/2015

Reviewed By:

Bud Dutton

FOUNTAIN VALLEY ANALYTICAL LABORATORY, INC.

1413 Old Taneytown Rd. Westminster, MD (410) 848-1014 (410) 876-4554 FAX (410) 848-0298

REPORT OF ANALYSIS

Laboratory ID #: 101759 Account #: 4035
Reference: Walnut Creek Lot 15 Company: Trinity Quality Homes, Inc.
Location: 12217 Basslers Way Requested By: Michael Pfau
Clarksville, MD 21029 Source: Well Water
Date/ Time Collected: 7/7/2015 1110 Site: Pressure Tank
Date/Time Rec'd: 7/7/2015 1320 Treatment: Softener/Neutralizer/Sediment Filter**
Chlorine ppm: Free: ND Total: ND pH: 7.1
Collected By: J. Yeager 6176JY Well #: HO-95-1395

PARAMETERS	RESULTS	UNITS	REFERENCE	METHOD	DATE/TIME/ANALYST
Bacteria, Coliform, Total, MPN	<1.0	MPN/ 100 ml	<1.0	SM18 9223	7/8/2015 / 0800 / CCH
Bacteria, E. coli, MPN	<1.0	MPN/ 100 ml	<1.0	SM18 9223	7/8/2015 / 0800 / CCH
Nitrate	<1.0	mg/L	10	601	7/7/2015 / 1615 / CRS
Turbidity	0.66	NTU	<10	SM18 2130B	7/7/2015 / 1630 / CRS
Sand	NS	mg/L	5	Visual/Gravimetric	7/7/2015 / 1630 / CRS

OK

NOTES

- ** Sample collected prior to Treatment ✓
- mg/L = milligrams per liter (also, parts per million)
- MPN/ 100 ml = Most Probable Number [of viable bacteria] per 100 ml of sample.
- NS = None Seen (NS indicates less than 5 mg/L)
- NTU = Nephelometric Turbidity Units
- Results less than or within the reference range are considered satisfactory and within potable water limits at the time of sampling.
- ND:None Detected
- Visual well check: Sealed, vented cap
- pH & Chlorine level tested on site

Reason for Test : Use & Occupancy
Building Permit # : 14002848

Date Reported: 7/8/2015

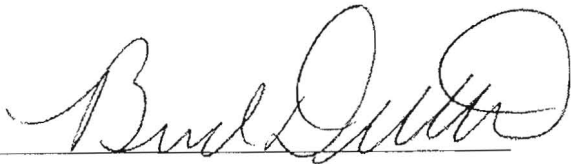
Reviewed By: 

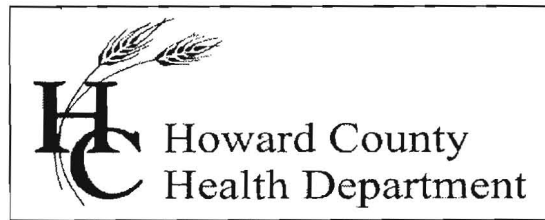

Bureau of Environmental Health

8930 Stanford Blvd., Columbia, MD 21046-2147

Main: 410-313-1774 | Fax: 410-313-2648

TDD 410-313-2323 | Toll Free 1-866-313-6300

www.hchealth.org

Facebook: www.facebook.com/hocohealth

Twitter: HowardCoHealthDep

Maura J. Rossman, M.D., Health Officer

INTERIM CERTIFICATE OF POTABILITY

Expiration Date – JANUARY 22, 2015

July 22, 2015

Homeowner
12217 Basslers Way
Clarksville, MD 21029

**RE: Walnut Creek, Lot 15
12217 Basslers Way
Building Permit: B14002848
Well Permit: HO-95-1395**

Dear Homeowner:

This is to advise you that the septic system installation and water well construction for the above referenced property have been inspected and approved. Final approval of the septic system was granted on **7/22/2015**. Final approval of the well line connection to the dwelling was granted on **12/23/2014**. The well construction was completed on **4/11/2008**. Water samples were collected on **7/7/2015**.

The water sample results indicate that the water samples submitted for testing were free of coliform and fecal coliform bacteria at the time of sampling and are bacteriologically safe for drinking.

Gross Alpha and Beta samples were also collected on **4/14/2008**. Results showed a Gross Alpha level of **17.0 ± 3.0 pCi/L** and Gross Beta level of **10.0 ± 2.0 pCi/L**. **This exceeds the maximum contaminant limit (MCL) of 15 pCi/L and/or 50 pCi/L, respectively. Currently, you have a water softener device in place to treat the excessive radium levels indicated. Post-treated sampling will be required during the Final Certificate of Potability to test for Gross alpha/Beta short term to confirm that the treatment device installed is removing the excessive levels of radium.**

This certifies that the initial sampling requirements of COMAR 26.04.04 "Well Regulations" have been met for the water supply system installed under well permit HO-95-1395. Although the submitted sample results are in compliance with COMAR standards, the Health Department does not guarantee water supplies.

This Interim Certificate of Potability will expire **six months** from the date of issuance. Submission of a second bacteriological test indicating the water is free of coliform and fecal coliform bacteria is required prior to the expiration date, after which time a Final Certificate of Potability will be issued. **Failure to submit an additional sample and obtain a Final Certificate of Potability will result in a Notice of Violation and is punishable as a**

misdemeanor under the *Annotated Code of Maryland, Environment Article, 9-1311*, subject to a fine of up to \$500 or imprisonment not to exceed three months.

Please contact (410) 313-1773 to schedule a final water sample appointment or contact a certified water quality laboratory to schedule a water sample. A list of laboratories certified by the state of Maryland may be found at the following website:

<http://www.mde.state.md.us/assets/document/WSP-Labs-2010apr16.pdf>

Approving Authority,

A handwritten signature in black ink, appearing to read "Kevin M. Wolf". The signature is fluid and cursive, with a long horizontal stroke extending to the right.

Kevin M Wolf, LEHS, Supervisor
Groundwater Management Section
Well & Septic Program

cc: Howard County Dept. of Inspections, Licenses, and Permits
Community Hygiene Program
File

LIBER 15552 FOLIO 48

WR 15

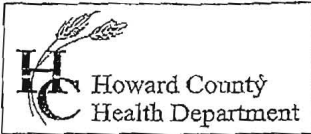

Bureau of Environmental Health
7178 Columbia Gateway Drive Columbia, MD 21046
(410) 313-2640 Fax (410) 313-2648
TDD (410) 313-2323 Toll Free 1-866-313-6300
website: www.hchealth.org

000130

Peter L. Beilenson, M.D., M.P.H., Health Officer

AGREEMENT FOR APPROVAL OF AN INDIVIDUAL DRINKING WELL WITH AN ON-SITE TREATMENT SYSTEM

This agreement is entered into by and between the Howard County Health Department ("the Health Department") and Peter + Juan U. Chew ("the Owner").

WHEREAS, the Owner owns a tract of land at street address 12217 Bassiers Way Clarksville, MD 21029 and the deed and subdivision plat of the property is recorded among the Land Records of Howard County, Maryland, Tax Map # 028, Block # , Parcel # 0249, Deed Reference # and Tax Account # 05-454409 ("the Property").

WHEREAS, the Property lacks an available public drinking water source and is required to have an individual well as the source of drinking water for the residence of the property.

WHEREAS, the Owner has installed a residential drinking well under well permit 40-45-1395 that has been tested by the Health Department (or a private laboratory certified to perform testing) for radionuclide particles. The results of the tests have shown that the gross alpha particle content and/or the gross beta particle content and/or the combined radium 226/228 levels exceeds the standards of 15 picocuries per liter (pCi/L), 4 millirems per year (mrem/yr) and/or 5 pCi/L respectively.

WHEREAS, The Maryland Department of the Environment (MDE) has promulgated rules and regulations under which a Certificate of Potability may be issued and has delegated the authority to issue such Certificate to the Health Department.

WHEREAS, MDE regulations permit the Health Department to issue as a special condition, a permanent deviation to the Certificate of Potability for individual wells where treatment has been installed to meet the maximum contaminate levels (MCL's) for radionuclides.

20
40
JE

WHEREAS, MDE has determined that radium can be effectively removed from the drinking water by the use of treatment devices (e.g., ion exchange or reverse osmosis).

WHEREAS, the Owner is requesting that the Health Department issue a Certificate of Potability contingent upon installation and maintenance of a water treatment device to reduce radionuclides.

WHEREAS, neither the Owner nor the Health Department has knowledge of an alternative safe source of water for the Property.

AREA 1552 ROLLO 450

1952
1953
1954
1955
1956
1957
1958
1959
1960
1961
1962
1963
1964
1965
1966
1967
1968
1969
1970
1971
1972
1973
1974
1975
1976
1977
1978
1979
1980
1981
1982
1983
1984
1985
1986
1987
1988
1989
1990
1991
1992
1993
1994
1995
1996
1997
1998
1999
2000
2001
2002
2003
2004
2005
2006
2007
2008
2009
2010
2011
2012
2013
2014
2015
2016
2017
2018
2019
2020
2021
2022
2023
2024
2025
2026
2027
2028
2029
2030
2031
2032
2033
2034
2035
2036
2037
2038
2039
2040
2041
2042
2043
2044
2045
2046
2047
2048
2049
2050

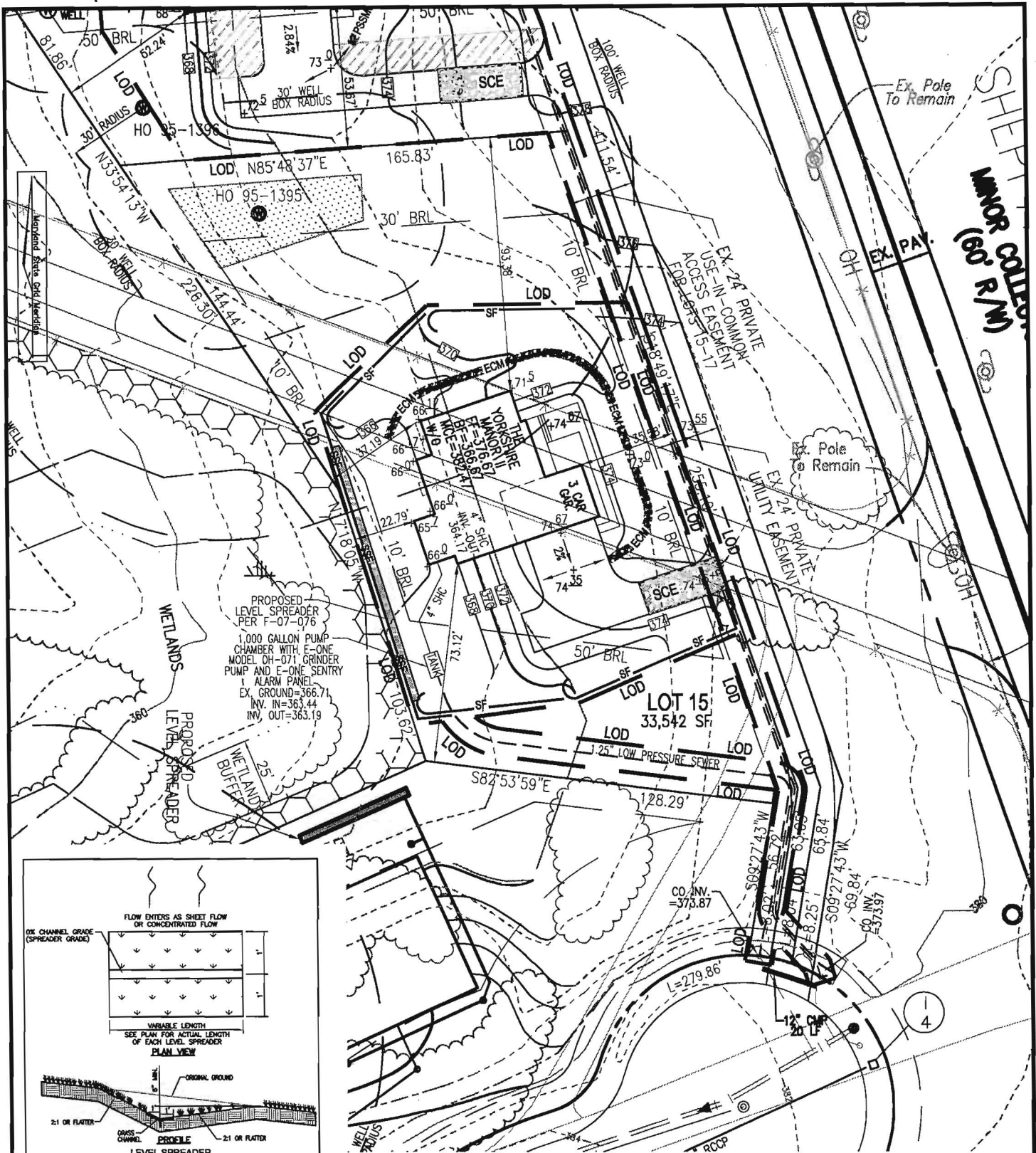

PROPOSED LEVEL SPREADER PER F-07-076
 1,000 GALLON PUMP CHAMBER WITH E-ONE MODEL OH-071 GRINDER PUMP AND E-ONE SENTRY 1 ALARM PANEL
 EX. GROUND=366.71
 INV. IN=363.44
 INV. OUT=363.19

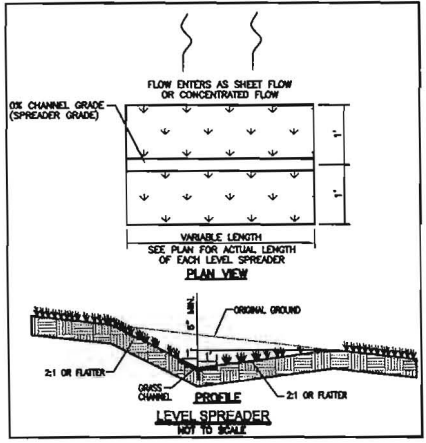

SCALE
 1"=50'

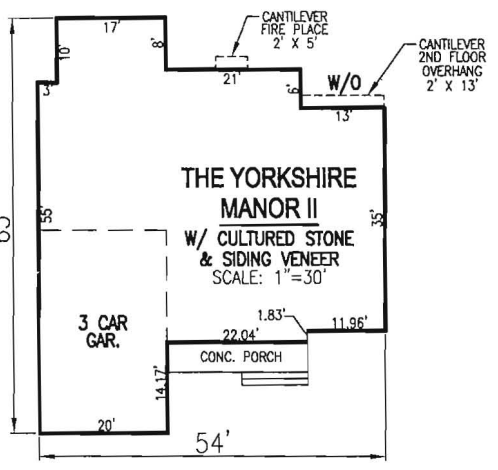

THE EXISTING WELL SHOWN ON LOT 15 TAG NO. 95-1395 HAS BEEN FIELD LOCATED BY FISHER, COLLINS, & CARTER, INC., AND IS ACCURATELY SHOWN.

BUILDING OF LOT 15 FLOOR AREAS:
 BASEMENT FLOOR AREA: 1950
 FIRST FLOOR AREA: 1980
 SECOND FLOOR AREA: 1890
 BEDROOMS: 5

NOTE: STORMWATER MANAGEMENT (WQv AND CPv) IS PROVIDED BY EXTENDED DETENTION FACILITY, ONE RAIN GARDEN, ROADWAY GRASS CHANNELS, AND ON-LOT LEVEL SPREADERS (F-07-076). LOT 15 DOES NOT REQUIRE ANY ADDITIONAL PRACTICES.

BUILDING PERMIT NO. _____

SCALE: AS SHOWN
 DRAWN BY: JMR
 CHECKED BY: RHV
 DATE: JUNE 2014
 PROJECT #: 13-21
 SHEET #: 1 OF 1

PLOT PLAN
WALNUT CREEK
LOT 15
REF: F-07-076
 TAX MAP 28 PARCEL 49
 BLOCK 11
 5TH ELECTION DISTRICT
 HOWARD COUNTY, MARYLAND

ADDRESS
 12217 BASSLERS WAY
 CUMMERSVILLE, MD 21034
 GP: 13-038

OWNER
 TRINITY QUALITY HOMES, INC.
 3675 PARK AVENUE, SUITE 301
 ELLICOTT CITY, MARYLAND 21043
 (410) 480-0023

ROBERT H. VOGEL ENGINEERING, INC.
 ENGINEERS • SURVEYORS • PLANNERS
 8407 MAIN STREET ELLICOTT CITY, MD 21043 TEL: 410.461.7666 FAX: 410.461.8961