

MARYLAND DEPARTMENT OF THE ENVIRONMENT, WATER MANAGEMENT ADMINISTRATION  
1800 Washington Blvd., Baltimore, Maryland 21230 (410) 537-3784

\*\*\*\*\*  
WATER WELL ABANDONMENT-SEALING REPORT FORM  
\*\*\*\*\*

SUBMIT COPIES OF COMPLETED FORM TO:

- \* COUNTY ENVIRONMENT AGENCY (contact MDE, WMA if address needed)
- \* WELL OWNER
- \* MDE, WATER MANAGEMENT ADMINISTRATION, WELL PROGRAM

DATE WELL ABANDONED: 10/1/09 (month/day/year)

\* PERMIT NUMBER OF ABANDONED WELL (if any)

Ho - 81 - 0435

\* PERMIT NUMBER OF REPLACEMENT WELL

\* PERSON ABANDONING WELL: Michael Barlow / MUNE DIXON

WELL DRILLERS LICENSE NUMBER: 355

CIRCLE: MWD MSD/MGD

\* OWNER'S NAME: LAND Design + Development

SITE LOCATION MAP

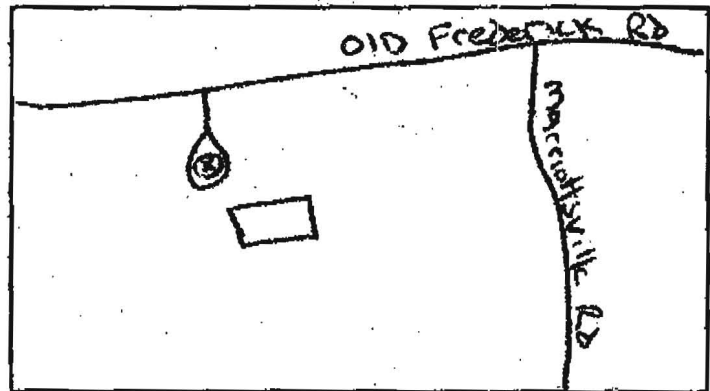

\* WELL LOCATION:  
 COUNTY: Howard  
 NEAREST TOWN: West Friendship  
 TAX MAP BLOCK \_\_\_\_\_ PARCEL \_\_\_\_\_  
 SUBDIVISION: \_\_\_\_\_  
 SECTION: \_\_\_\_\_ LOT: \_\_\_\_\_  
 NEAREST ROAD: 11365 OLD Frederick Rd

TYPE OF WELL BEING ABANDONED:

- DRILLED \_\_\_\_\_ JETTED
- \_\_\_\_\_ BORED/AUGERED \_\_\_\_\_ HAND DUG
- \_\_\_\_\_ OTHER (specify) \_\_\_\_\_

USE CODE:

- DOMESTIC \_\_\_\_\_ MUNICIPAL/PUBLIC
- \_\_\_\_\_ IRRIGATION \_\_\_\_\_ INDUSTRIAL
- \_\_\_\_\_ TEST/OBSERVATION \_\_\_\_\_ GEOTHERMAL

TYPE OF CASING:

- STEEL \_\_\_\_\_ PLASTIC
- \_\_\_\_\_ CONCRETE \_\_\_\_\_ OTHER (specify) \_\_\_\_\_

SIZE OF CASING: 6 INCHES IN DIAMETER

DEPTH OF WELL: 300 FEET DEEP

WAS ANY CASING REMOVED? \_\_\_\_\_ YES  NO  
if yes, length removed, in feet: \_\_\_\_\_

WAS CASING RIPPED OR PERFORATED? \_\_\_\_\_ YES  NO

LOG OF SEALING MATERIAL

MATERIAL	FEET	
	FROM	TO
Per Gravel	300	60
Bentonite Clay	60	0
VOLUME OF MATERIAL USED		

IGNATURE MASTER WELL DRILLER OR SUPERVISING SANITARIAN

355  
LICENSE #

MWD MSD/MGD  
CIRCLE ONE

10/1/09  
DATE

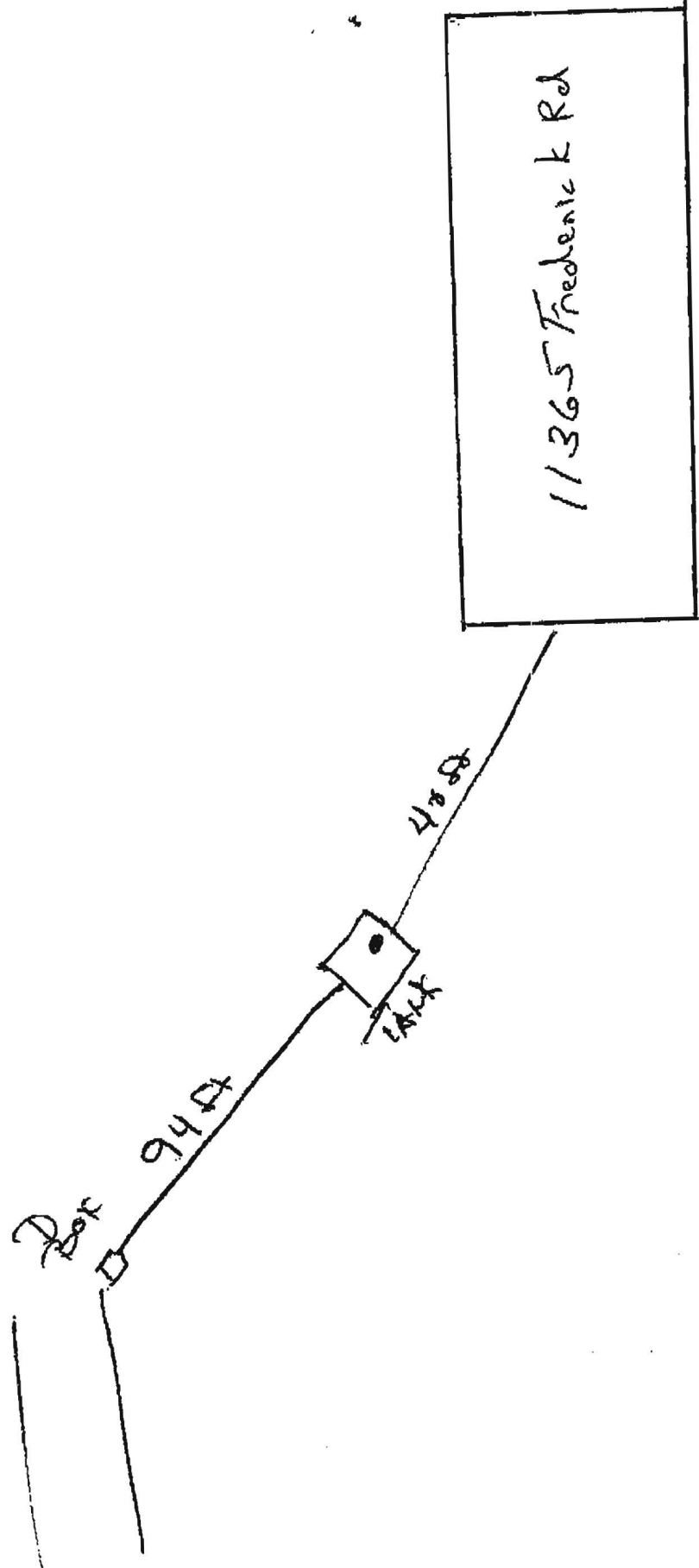

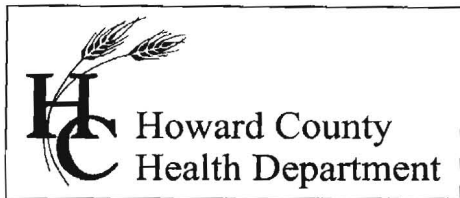

Bureau of Environmental Health  
7178 Gateway Drive Columbia, MD 21046  
(410) 313-2640 Fax (410) 313-2648  
TDD (410) 313-2323 Toll Free 1-866-313-6300  
website: www.hchealth.org

---

**Peter L. Beilenson, M.D., M.P.H., Health Officer**

January 20<sup>th</sup>, 2010

***MEMORANDUM***

TO: Land Design & Development, Inc  
Attn: Debbie Zile  
Faxed to 443-367-0420

FROM: Kevin Wolf, Environmental Sanitarian   
Bureau of Environmental Health  
Well and Septic Program

RE: 11365 Old Frederick Rd  
Marriottsville, Md 21104  
Map 10, Grid 21, Parcel 224 12.33 AC  
(Demolition of Existing House)

---

This is to advise that the Howard County Health Department recommends issuance of the demolition permit for the above referenced property.

The well, which previously served the existing dwelling, has been disconnected and abandoned/sealed. Abandonment form submitted by licensed well driller. The septic system tank that was currently being used on the above aforementioned property, has been properly abandoned; i.e. pumped, collapsed and filled in with clean fill. This may be completed during the demolition phase if not already completed.

If any other wells or septic systems are found during site work, please notify this office immediately.

***Cc: File***

**ASSOCIATED EXCAVATORS CONTRACTORS**  
**16657 FREDERICK ROAD**  
**MT. AIRY, MD 21771**  
**(410) 442-1886 FAX (410) 442-0100**

---

**January 11, 2010**

Howard County Health Department  
C/o Sarah Sappington  
7178 Columbia Gateway Drive  
Columbia, MD 21045

Dear Ms. Sappington:

This letter is to inform you that my company performed the abandonment of a septic tank located at 11365 Frederick Road Marriottsville, Maryland.

Please see the attached drawing.  
oid

If you have any questions please call me at (410) 977.2216.

Thank you,

Mike Johnson

Cc: Mr. Ron Green

Land Design & Development, Inc.

January 18, 2010

FAX NO.: 410-313-2648

MEMO TO: Sarah Sappington  
Health Department

FROM: Debbie Zile  
Land Design and Development

RE: 11365 Frederick Road  
Marriottsville, MD 21104

*1/12/10  
\* Demo house for  
Proposed Subdivision  
KW*

Land Design and Development is going to demolish the above home. The well and septic has been abandoned. Attached you will find a letter from Associated Excavators Contractors dated January 11, 2010 showing the well and septic has been abandoned. Could you please fax me your letter as soon as possible so I can file the permit!

Your department's letter is the only letter needed to file this permit. I would greatly appreciate it.

Please issue a demo letter. This letter can be faxed to 443-367-0420. If there are any issues with issuing this letter, please call Debbie Zile at 443-367-0422 ext. 243.

Thank you for all your help!

*Debbie Zile*

*Subdivision  
waverly overlook  
marriottsville*