

05-409071

PERMIT

SEWAGE DISPOSAL SYSTEM

DEPARTMENT OF HEALTH AND MENTAL HYGIENE

HOWARD COUNTY HEALTH DEPARTMENT

BUREAU OF ENVIRONMENTAL HEALTH

461-9933

INDEXED

4/24/91 P.C.O.
4/25/91 2 P.C.O.
P 46935

A 37824

DISTRICT 5th

DATE 3/23/91

DATE SYSTEM APPROVED 4/25/91

INSPECTOR C.B.D.

Klein & Sons
John Sakai & Associates

IS PERMITTED TO INSTALL ALTER

ADDRESS ~~12002 Glen Road, Potomac, Maryland 20854~~ Eldersburg PHONE ~~258-7414~~ 549-6960

SUBDIVISION Clearview Estates LOT 23 ROAD 11921 Meadow Vista Way

PROPERTY OWNER ESD Associates, Inc. *Maria Ruiz*

ADDRESS

SEPTIC TANK CAPACITY 1250 GALLONS

NUMBER OF BEDROOMS 4

180 SQUARE FEET PER BEDROOM

LINEAR FEET OF TRENCH REQUIRED

TRENCHES - 180 sq. ft. per bedroom. Trench to be 2 feet wide. Inlet 3 feet below original grade. Bottom maximum depth 7 feet below original grade. Effective area begins at 3 feet below original grade. 4 feet of stone below distribution pipe.

LOCATION - Starting from the right front lot corner, start the first trench 120 feet down the right lot line and 80 feet off the same lot line. Run trenches on contour toward both sides of lot.

NOTE - No trench to exceed 100 feet in length. Provide 5" - 8" diameter cleanout and cap to grade or above on septic tank. *OK 3/15/91 RIT*

PLANS APPROVED BY Raymond Hodges CM DATE 03/08/91

COVER NO WORK UNTIL INSPECTED AND APPROVED

NEITHER THE HOWARD COUNTY COUNCIL NOR THE HEALTH DEPARTMENT IS RESPONSIBLE FOR THE SUCCESSFUL OPERATION OF ANY SYSTEM

NOTE: CLEANOUT REQUIRED EVERY 70 FEET OF SEWER LINE AND/OR AT 90° SWEEPS IN LINES FROM HOUSE TO DRAIN FIELDS. 90° ELBOWS NOT ACCEPTABLE

NOTE: ALL PARTS OF SEPTIC SYSTEMS (I.E. TANK, DISTRIBUTION BOX TRENCHES) TO BE 100 FEET FROM WELL (UNLESS OTHERWISE SPECIFICALLY AUTHORIZED)

NOTE: IF DEEP TRENCH(ES) ARE USED CALL FOR INSPECTION BEFORE AND AFTER PLACING GRAVEL IN TRENCH(ES)

NOTE: NO DRY WELL SHALL EXCEED 15 FOOT IN DIAMETER NO ABSORPTION TRENCH TO EXCEED 100 FEET IN LENGTH

NOTE: ALL PIPE FROM HOUSE TO SEPTIC TANK MUST BE CAST IRON OR SCHEDULE 35/40 PVC OR ABS

PERMIT VOID AFTER TWO YEARS

NOTE: INSTALL STAND PIPE ON SEPTIC TANK AND DRY WELL STAND PIPES MUST BE 6 INCHES IN DIAMETER CAST IRON, CONCRETE OR TERRA COTTA OR PVA OR ABS ACCEPTED. IF TOP OF SEPTIC TANK IS DEEPER THAN 3 FEET. MANHOLE TO GRADE REQUIRED.

NOTE: DISTRIBUTION BOXES MUST HAVE BAFFLES

*INSTALLER IS RESPONSIBLE FOR OBTAINING FINAL APPROVAL ON THIS PERMIT

*CALL 461-9933 FOR INSPECTION OF SEPTIC SYSTEM.

HD-260(6-90)

BLDG. PERMIT SIGNED

AND RETURNED 8/19/91

Serial # 39299 addition

BLDG. PERMIT SIGNED AND RETURNED 10/4/93 Serial # 50794 - Improved Portdeck on front house

37824

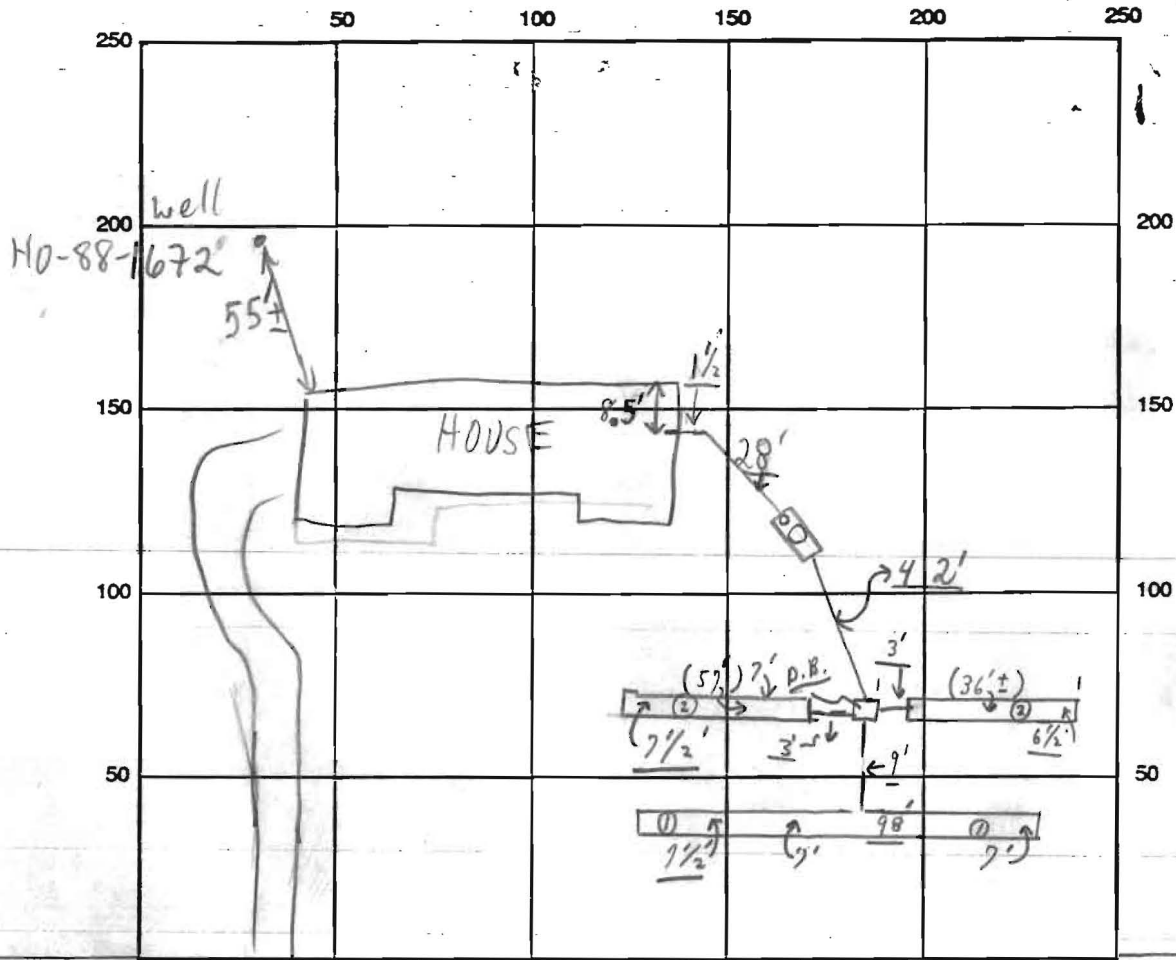

MEADOW VISTA WAY INDICATE NORTH - NAME ADJOINING ROADWAY AS BASE LINE

SEPTIC TANK LEVEL 1500 GAL - OK CLEANOUTS OK - MAN HOLE & CAST IRON 8"
 DISTRIBUTION BOX LEVEL OK (Baffles is in)
 DRAIN FIELD/TITLE DEPTH 7 average FT. TRENCH WIDTH 2+ FT. INLET DEPTH 3 FT.
 EFFECTIVE GRAVEL DEPTH 4 FT. TOTAL LENGTH 98+ FT. } 191'
 NUMBER OF TRENCHES 2 ONE SIDEWALL/BOTTOM AREA 764 SQ. FT.
 DRYWALL INSIDE DIAMETER _____ FT. EFFECTIVE DEPTH BELOW INLET _____ FT.
 ABSORBENT AREA 764+ SQ. FT.

REMARKS: 4/23/91 PIPE FROM HOUSE TO DB CAST IRON; INFORMED
INSTALLER THAT PVC WAS ALSO OK & PREFERABLE; OK CONTINUE
(INSTALLER MAY REPLACE PIPE); TRENCHES 3' WIDE, BUT I
RECOMMENDED THEY GET A 2' BUCKET MR; 4/24/91 Paved -
PVC - ok & all the way to distribution box; ok for stone
in trenches and to cover pipes only from house to
distribution box
 DATE SYSTEM APPROVED 4/25/91 INSPECTOR Charles Bryan Steakes
P.M. 4/25 For Final on (3rd visit) yes above; show on site; OK to cover as finished
 Note: 4/25/91 Final W.P.I. on well line & pitless adapter.
A.M. 2nd stop