

9/29/87
11AM + LATER

PERMIT

SEWAGE DISPOSAL SYSTEM

MARYLAND STATE DEPARTMENT OF HEALTH

HOWARD COUNTY
BUREAU OF ENVIRONMENTAL HEALTH
461-9933

05-391539

P 39993

A 29047

DISTRICT 5th

DATE 9/11/87

DATE SYSTEM APPROVED 9/29 1987

INSPECTOR RH

INDEXED

Paul Schissler

IS PERMITTED TO INSTALL ALTER

ADDRESS 4410 Salem Bottom Road, Westminster, Maryland PHONE 875-4197

SUBDIVISION Triadelphia Mill Farms ROAD 13911 Hallowell Court LOT 2

PROPERTY OWNER Stephen Clark

ADDRESS _____

IF GARBAGE GRINDER IS USED INCREASE SEPTIC TANK CAPACITY BY 50% AND ABSORPTION AREA BY 22%.

GARBAGE GRINDER? YES _____ NO

SEPTIC TANK CAPACITY 1000 GALLONS NUMBER OF BEDROOMS 3

TRENCHES - 170 sq. ft. per bedroom. Trench to be 2 feet wide. Inlet 3.5 feet below original grade. Bottom maximum depth 9 feet below original grade. Effective area begins at 3.5 feet below original grade. 5.5 feet of stone below distribution pipe.

LOCATION - Place the distribution box 165 feet from the front lot line and 125 feet from the left lot line as seen when facing the lot from Hallowell Court. Run trenches on contour toward the right lot line.

NOTE - No trench to exceed 100 feet in length. Provide 6" - 8" diameter cleanout and cap to grade or above on septic tank.

BUILDING PERMIT SIGNED

Stanley Boudreau - S.H.E.D.

AND RETURNED 9/25/87

B00138584 - MBDM ADDITION

PLANS APPROVED BY S. Abel

DATE 4/07/87

COVER NO WORK UNTIL INSPECTED AND APPROVED.

NEITHER THE HOWARD COUNTY COUNCIL NOR THE HEALTH DEPARTMENT IS RESPONSIBLE FOR THE SUCCESSFUL OPERATION OF ANY SYSTEM.

NOTE: CLEANOUT REQUIRED EVERY 70 FEET OF SEWER LINE AND/OR AT 90° SWEEPS IN LINES FROM HOUSE TO DRAIN FIELDS.

NOTE: ALL PARTS OF SEPTIC SYSTEMS (I.E., TANK, DISTRIBUTION BOX, TRENCHES) TO BE 100 FEET FROM WELL. (UNLESS OTHERWISE SPECIFICALLY AUTHORIZED)

NOTE: IF DEEP TRENCHES ARE USED CALL FOR INSPECTION BEFORE AND AFTER PLACING GRAVEL IN TRENCHES).

NOTE: NO DRY WELL SHALL EXCEED 15 FOOT IN DIAMETER. NO ABSORPTION TRENCH TO EXCEED 100 FEET IN LENGTH.

NOTE: ALL PIPE FROM HOUSE TO SEPTIC TANK MUST BE CAST IRON OR SCHEDULE 40 PVC OR ABS.

PERMIT VOID AFTER TWO YEARS.

NOTE: INSTALL STAND PIPE ON SEPTIC TANK AND DRY WELL. STAND PIPES MUST BE 6 INCHES IN DIAMETER. CAST IRON, CONCRETE OR TERRA COTTA OR PVC OR ABS ACCEPTED. IF TOP OF SEPTIC TANK IS DEEPER THAN 3 FEET, MANHOLE TO GRADE REQUIRED.

NOTE: DISTRIBUTION BOXES MUST HAVE BAFFLES.

***INSTALLER IS RESPONSIBLE FOR OBTAINING FINAL APPROVAL ON THIS PERMIT**

*CALL 461-9933 FOR INSPECTION OF SEPTIC SYSTEMS.

EH - 2-1186

Liabe

Wood line

2 of sheet 1

Field
steel
Test mod
per take

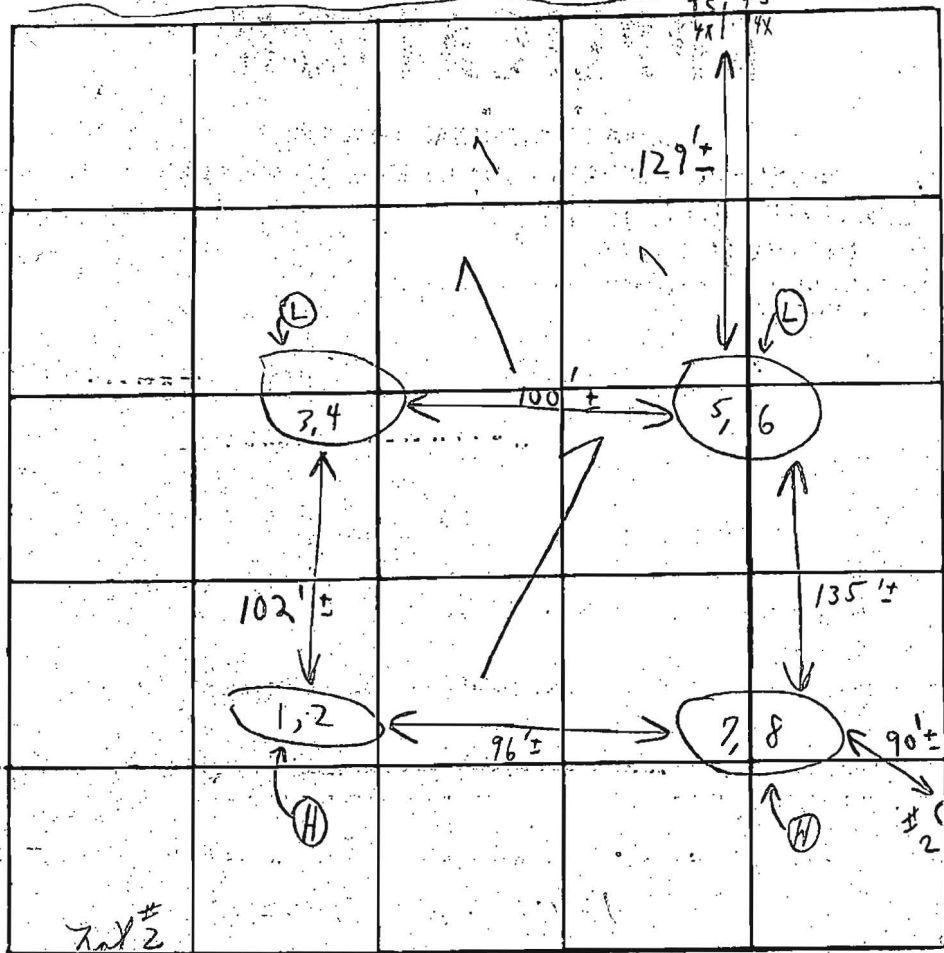

INDICATE NORTH. - NAME ADJOINING ROADWAY AS BASE LINE

	DATE	TEST NO.	DEPTH	PRE-WET.		TEST - 1" DROP		TIME
				START	STOP	START	STOP	
Below clay	11/29/78	1	4'	12:26	12:28	12:28	12:31	3 min
Mud		(H) 2	12 1/2'	12:27	12:32	12:32	12:56	24 min
	loam	3	4 1/2'	12:35	12:37	12:37	12:42	5 min
		4	12 1/2'	12:36	12:42	12:42	12:58	16 min
		5	3 1/2'	12:45	12:47	12:47	12:49	2 min
		6	13'	12:44	12:47	12:47	12:53	6 min
		7	4 1/2'	12:18	12:19	12:19	12:21	2 min
		(H) 8	12 1/2'	12:20	12:24	12:24	12:39	15 min
							8	73

Drilled
4'
160 # / B.R.

10 min

REMARKS Tests in open field

TYPE OF SOIL

TESTED BY C. B. S. ALSO PRESENT: S. Schuler + son

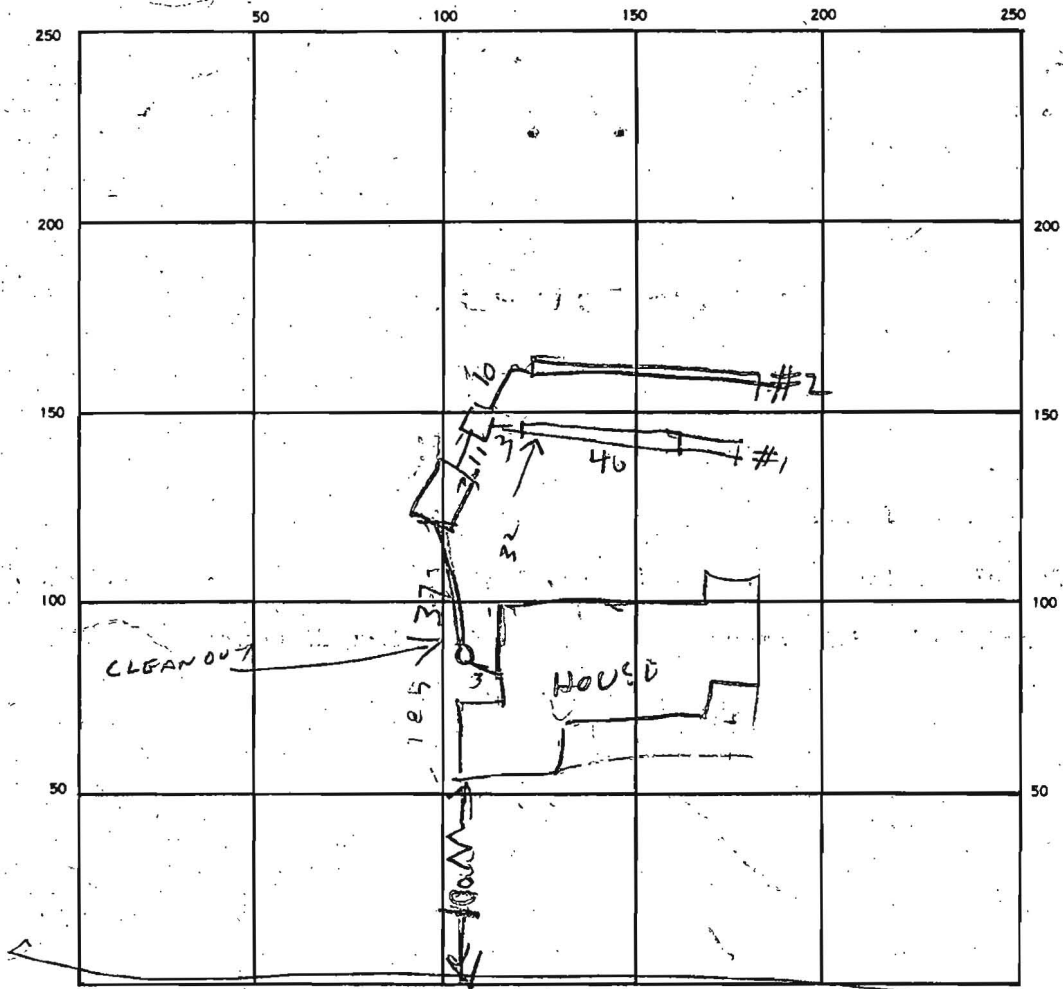

INDICATE NORTH. — NAME ADJOINING ROADWAY AS BASE LINE.

SEPTIC TANK LEVEL 1.000 CLEANOUTS ST / HOUSE SEWER
OK / OK

DISTRIBUTION BOX LEVEL OK

DRAIN FIELD/TILE FIELD. DEPTH 9 / 9 FT. TRENCH WIDTH 2 / 2 FT. INLET DEPTH 3 / 3.5 FT. **BUILDING PERMITTED AND RETURNED**

EFFECTIVE GRAVEL DEPTH 5.5 / 5.5 FT. TOTAL LENGTH 52 / 50 FT. **INSTALLATION REQUIRED**

NUMBER OF TRENCHES _____ ONE SIDEWALL/BOTTOM AREA 56 / 50 SQ. FT. 510

DRYWELL INSIDE DIAMETER _____ FT. EFFECTIVE DEPTH BELOW INLET _____ FT.

ABSORBENT AREA _____ SQ. FT.

REMARKS: 9/29/87 AM LOCATION OK TRENCH #1 DUG FINISH DIGGING
TRENCH #1 & ADD STONE. DIG TRENCH #2 & ADD STONE
9/29/87 PM TRENCH #1 FINISHED TRENCH #2
ALMOST ALL FINISHED. R.D. DUGGS

DATE SYSTEM APPROVED 9/29/87

INSPECTOR Raymond Hodgas