



APPLICATION

FOR PERCOLATION TESTING AND SITE EVALUATION

TEST DATE(S) _____ TEST TIME _____ A/P _____

AGENCY REVIEW: _____ DATE _____

DO NOT WRITE ABOVE THIS LINE

I HEREBY APPLY FOR THE NECESSARY TESTING/EVALUATION PRIOR TO ISSUANCE OF SEWAGE DISPOSAL SYSTEM PERMIT(S) TO:

CHECK AS NEEDED:

- CONSTRUCT NEW SEPTIC SYSTEM(S)
- REPAIR/ADD TO AN EXISTING SEPTIC SYSTEM
- REPLACE AN EXISTING SEPTIC SYSTEM

CHECK AS NEEDED:

- NEW STRUCTURE(S)
- ADDITION TO AN EXISTING STRUCTURE
- REPLACE AN EXISTING STRUCTURE

CHECK ONE:

- CREATE NEW LOT(S)
- BUILD ON AN EXISTING LOT IN A SUBDIVISION
- BUILD ON AN EXISTING PARCEL OF RECORD

IS THE PROPERTY WITHIN 2500' OF ANY RESERVOIR?

- YES
- NO

THE TYPE OF STRUCTURE IS:

- RESIDENTIAL WITH _____ PROPOSED BEDROOMS IN THE COMPLETED STRUCTURE (NOTE **UNKNOWN** IF APPROPRIATE)
- COMMERCIAL (PROVIDE DETAIL OF NUMBERS AND TYPES OF EMPLOYEES/ CUSTOMERS ON ACCOMPANYING PLAN)
- INSTITUTIONAL/GOVERNMENT (PROVIDE DETAIL OF NUMBERS AND TYPES OF EMPLOYEES/USERS ON ACCOMPANYING PLAN)

PROPERTY OWNER(S) _____

DAYTIME PHONE _____ CELL _____ FAX _____

MAILING ADDRESS _____
STREET CITY/TOWN STATE ZIP

APPLICANT _____

DAYTIME PHONE _____ CELL _____ FAX _____

MAILING ADDRESS _____
STREET CITY/TOWN STATE ZIP

APPLICANT'S ROLE: DEVELOPER BUILDER BUYER RELATIVE/FRIEND REALTOR CONSULTANT

PROPERTY LOCATION
SUBDIVISION/PROPERTY NAME _____ LOT NO. _____

PROPERTY ADDRESS _____
STREET TOWN/POST OFFICE

TAX MAP PAGE(S) _____ GRID _____ PARCEL(S) _____ PROPOSED LOT SIZE _____

AS APPLICANT, I UNDERSTAND THE FOLLOWING: THE SYSTEM INSTALLED SUBSEQUENT TO THIS APPLICATION IS ACCEPTABLE ONLY UNTIL PUBLIC SEWERAGE IS AVAILABLE. THIS APPLICATION IS COMPLETE WHEN ALL APPLICABLE FEES AND A SUITABLE SITE PLAN HAVE BEEN RECEIVED. I ACCEPT THE RESPONSIBILITY FOR COMPLIANCE WITH ALL M.O.S.H.A. AND "MISS UTILITY" REQUIREMENTS. APPROVAL IS BASED UPON SATISFACTORY REVIEW OF A PERC CERTIFICATION PLAN.

TEST RESULTS WILL BE MAILED TO APPLICANT. _____
SIGNATURE OF APPLICANT

HOWARD COUNTY HEALTH DEPARTMENT, BUREAU OF ENVIRONMENTAL HEALTH, WELL AND SEPTIC PROGRAM
3525-H ELLICOTT MILLS DRIVE, ELLICOTT CITY, MARYLAND 21043-4544 (410) 313-1771 FAX (410) 313-2648
TDD (410) 313-2323 TOLL FREE 1-877-4MD-DHMH

A/P (A)

2.5' Br Topsoil and Cl Loam
 Mixture of Or-Br Cl Loam and Dense Red Sa Cl Loam
 15% Quartzite
 5.5-7' Dense Red Sa Cl Loam and Fine Or Br Sa Loam
 20-25% Quartzite
 7' Or Br and Beige Fine Sa Loam
 10-15% Saprolite
 11'

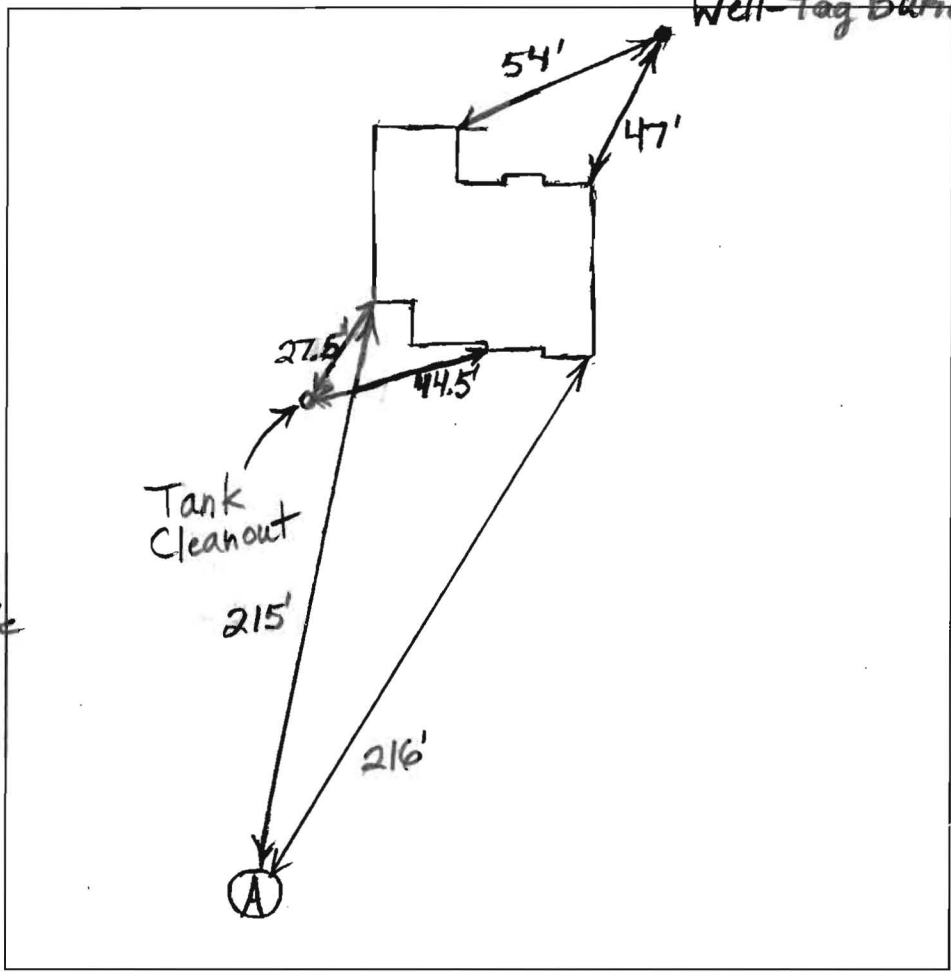

DATE	TEST #	DEPTH	START	BREAK 1" DROP	STOP 2" DROP	TIME OF 2nd INCH	P/F/H	
10/24/06	A	6.5'/11'	~30 minutes for 1st inch					
		7'		6		10	P	

REMARKS _____
 SANITARIAN B. Baker BACKHOE Mannarelli OTHERS _____
 TEST HOLES USED IN SDA _____ AVG. PERC TIME _____ SQ. FT/BR _____
 TRENCH WIDTH _____ INLET DEPTH _____ MAX. BOT DEPTH _____ EFFECTIVE SW _____

LEGEND

- EXISTING 2' CONTOURS
- EXISTING 10' CONTOURS
- EXISTING TREE LINE
- SOIL LINES AND TYPES
- ⊙ DENOTES PASSED PERC

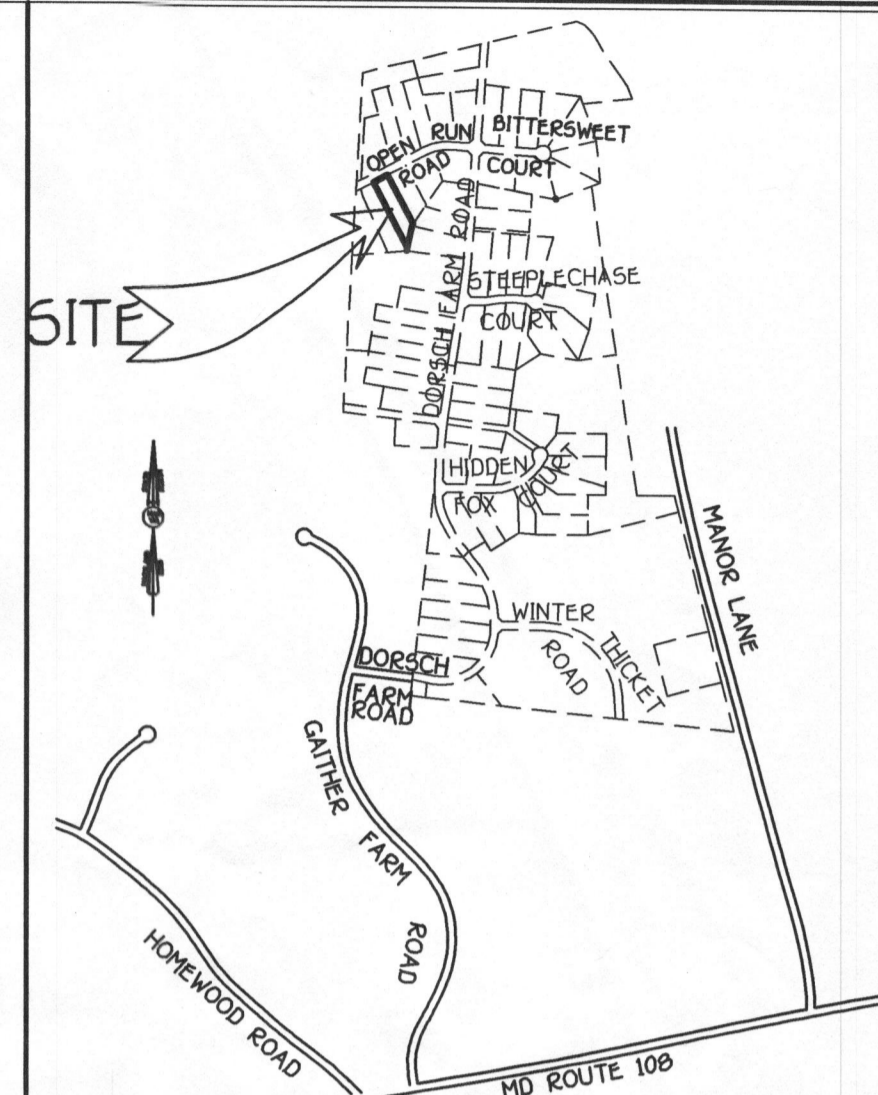

VICINITY MAP
SCALE : 1" = 1200'

SOILS LEGEND		
SOIL	NAME	CLASS
GIC2	Glenelg loam, 0 to 15 percent slopes, moderately eroded	B
ChB2	Chester silt loam, 3 to 0 percent slopes, moderately eroded	B

- NOTES:**
- * Hydric soils and/or contains hydric inclusions
 - ** May contain hydric inclusions
 - † Generally only within 100-year floodplain areas

PERC CERTIFICATION
I certify that the locations shown hereon are based on field locations done under my direct supervision and are correct to the best of my professional knowledge and belief.

Terrell A. Fisher
Signature of Professional Land Surveyor
Terrell A. Fisher, Professional Land Surveyor No. 10692

11/15/06
Date

APPROVED FOR PRIVATE WATER AND PRIVATE SEWERAGE SYSTEMS,
HOWARD COUNTY HEALTH DEPARTMENT.

Robert J. Weber
COUNTY HEALTH OFFICER

12/2/06
DATE

FISHER, COLLINS & CARTER, INC.
CIVIL ENGINEERING CONSULTANTS & LAND SURVEYORS
CENTENNIAL SQUARE OFFICE PARK - 10272 BALTIMORE NATIONAL PIKE
ELLICOTT CITY, MARYLAND 21042
(410) 461 - 2895

GENERAL NOTES:

1. THIS AREA DESIGNATES A PRIVATE SEWERAGE EASEMENT OF AT LEAST 10,000 SQUARE FEET AS REQUIRED BY THE MARYLAND STATE DEPARTMENT OF THE ENVIRONMENT FOR INDIVIDUAL SEWERAGE DISPOSAL. IMPROVEMENTS OF ANY NATURE IN THIS AREA ARE RESTRICTED UNTIL PUBLIC SEWERAGE IS AVAILABLE. THESE EASEMENTS SHALL BECOME NULL AND VOID UPON CONNECTION TO A PUBLIC SEWERAGE SYSTEM. THE COUNTY HEALTH OFFICER SHALL HAVE THE AUTHORITY TO GRANT ADJUSTMENTS TO THE PRIVATE SEWERAGE EASEMENT. RECORDATION OF A MODIFIED SEWERAGE EASEMENT SHALL NOT BE NECESSARY.
2. ADJUSTMENTS TO SEPTIC EASEMENT AREA IS NOT PERMITTED WITHOUT ADDITIONAL TESTING.
3. THE LOT SHOWN HEREON COMPLIES WITH THE MINIMUM OWNERSHIP WIDTH AND LOT AREA AS REQUIRED BY THE MARYLAND STATE DEPARTMENT OF THE ENVIRONMENT.
4. EXISTING WELLS AND/OR SEWERAGE EASEMENTS WITHIN 100 FEET OF THE PROPERTY HAVE BEEN SHOWN FROM THE BEST AVAILABLE INFORMATION.
5. ALL HOUSE SITES SHOWN COMPLY WITH MINIMUM BUILDING RESTRICTION REGULATIONS.
6. WELL EXISTS ON LOT 57.
7. TOPOGRAPHY SHOWN IS FIELD RUN BY FISHER COLLINS AND CARTER, INC. ON NOVEMBER 6, 2006.
8. BOUNDARY OUTLINE BASED ON RECORDED PLAT NO. 13488.
9. PLAT REFERENCE GAITHER HUNT SECTION 1, AREA 2 LOTS 34 - 62 AND BUILDABLE PRESERVATION PARCEL 'A' PLAT NO. 13487 THRU 13488.
10. THIS AREA DESIGNATES EXISTING PRIVATE SEWERAGE EASEMENTS RECORDED ON PLAT NO. 13488, GAITHER HUNT, SECTION 1, AREA 2.

PERC CERTIFICATION PLAT
GAITHER HUNT
SECTION 1, AREA 2
(PLAT NO. 13488)
LOT 57
*12009 OPEN RUN ROAD

TA) MAP *29 PARCEL: 21
SECOND ELECTION DISTRICT
SCALE: 1" = 50'

ZONED: RC-DEO
HOWARD COUNTY, MARYLAND
DATE: NOVEMBER 15, 2006