

LAYOUT 6/14/2011 INSP 4 _____
 INSP 2 6/20/2011 INSP 5 _____
 INSP 3 6/22/2011 INSP 6 _____

ISSUE DATE: 6/24/2011
 APPROVAL DATE: 6/28/2011

PERMIT

P _____
 A _____

**ON-SITE SEWAGE DISPOSAL SYSTEM
 HOWARD COUNTY HEALTH DEPARTMENT
 BUREAU OF ENVIRONMENTAL HEALTH**

_____ IS PERMITTED TO INSTALL ALTER

ADDRESS: _____ PHONE NUMBER: _____

SUBDIVISION: _____ LOT NUMBER: _____

ADDRESS: 11887 Hall Shop Rd. PROPERTY OWNER: _____

SEPTIC TANK CAPACITY (GALLONS): _____ OUTLET BAFFLE FILTER REQUIRED

PUMP CHAMBER CAPACITY (GALLONS): _____ COMPARTMENTED TANK REQUIRED

NUMBER OF BEDROOMS: _____

SQUARE FEET PER BEDROOM: _____

LINEAR FEET OF TRENCH REQUIRED: 76'
2-38'

Trenches 2' Wide
 Inlet 1.5'
 Bottom: Top Trench 9.5'
 Lower Trench 8.5'

TRENCHES:	Trench to be _____ feet wide. Inlet _____ feet below original grade. Bottom maximum depth _____ feet below original grade. Effective area begins at _____ feet below original grade. _____ feet of stone below distribution pipe.
LOCATION:	_____
NOTES:	_____

PLANS APPROVED: _____ DATE: _____

- NOTE: PERMIT VOID AFTER 2 YEARS
- NOTE: CONTRACTOR RESPONSIBLE FOR SCHEDULING A PRE-CONSTRUCTION INSPECTION FOR ALL INSTALLATIONS
- NOTE: WATERTIGHT SEPTIC TANKS REQUIRED
- NOTE: ALL PARTS OF SEPTIC SYSTEM SHALL BE 100 FEET FROM ANY WATER WELL
- NOTE: MANHOLE RISERS REQUIRED ON ALL SEPTIC TANKS AND PUMP CHAMBERS UNLESS SPECIFICALLY AUTHORIZED

**NEITHER THE HOWARD COUNTY COUNCIL NOR THE HEALTH DEPARTMENT IS
 RESPONSIBLE FOR THE SUCCESSFUL OPERATION OF ANY SYSTEM
 PERMITTEE RESPONSIBLE FOR OBTAINING FINAL APPROVAL ON THIS PERMIT
 CALL 410-313-2640 FOR INSPECTION OF SEPTIC SYSTEM**

Hall Shop Road NOT TO SCALE

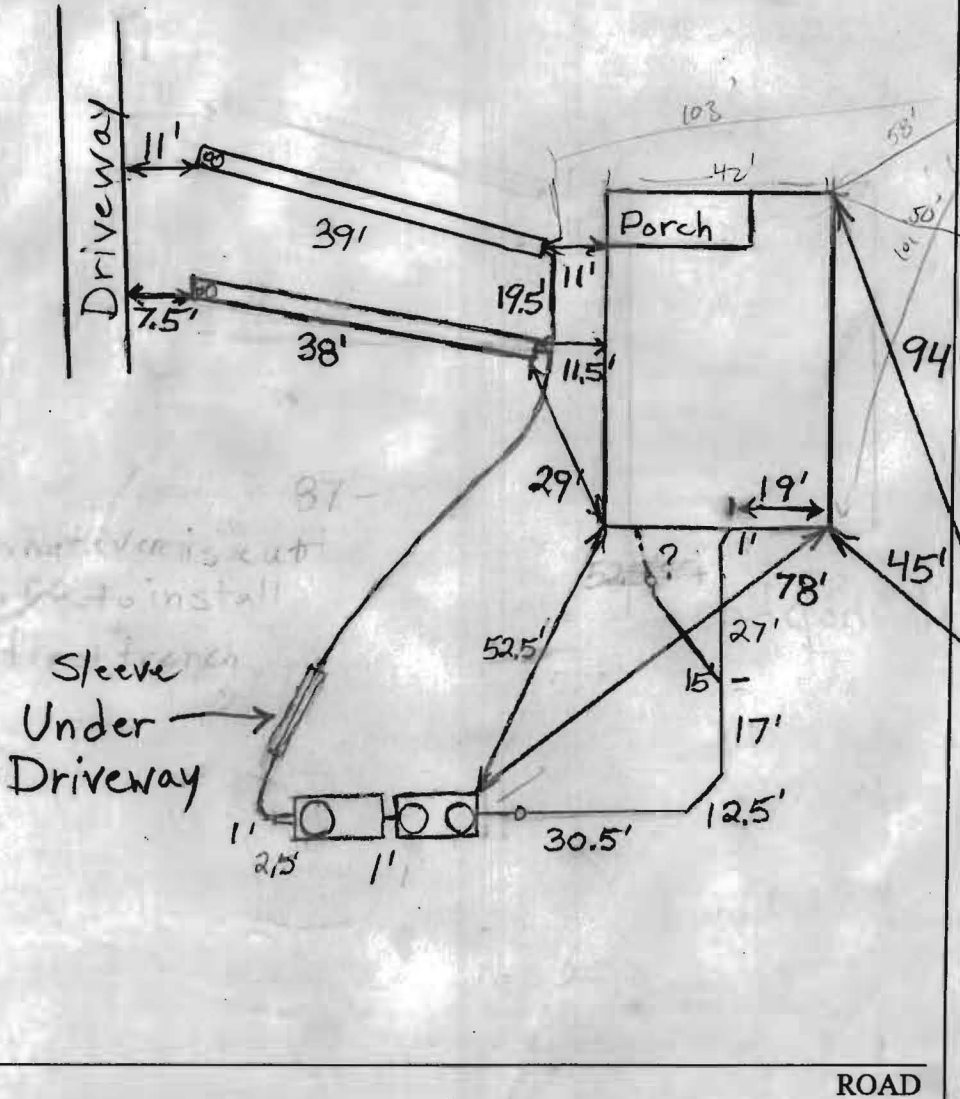

TRENCH/DRAINFIELD DATA		
WIDTH	INLET	BOTTOM
2'	2'	8.5-9.5'
NUMBER OF TRENCHES		2
TOTAL LENGTH		77'
ABSORPTION AREA		539
DISTRIBUTION BOX LEVEL		N/A
DISTRIBUTION BOX BAFFLE		N/A
DISTRIBUTION BOX PORT		N/A

SEPTIC TANK DATA	
SEPTIC TANK 1 LEVEL	Yes
CAPACITY	1500 GAL
SEAM LOC	Top
TANK LID DEPTH	0.5-1'
BAFFLES	Yes
BAFFLE FILTER	No
MANHOLE LOC	Front+Rear
6" PORT LOC	None
WATERTIGHT TEST	No
SEPTIC TANK 2 LEVEL	Yes
CAPACITY	1500 GAL
SEAM LOC	Top
TANK LID DEPTH	1-1.5'
BAFFLES	Front
BAFFLE FILTER	No
MANHOLE LOC	Rear
6" PORT LOC	None
WATERTIGHT TEST	No

PRE-CONSTRUCTION 6/14/2011 I install two 38' trenches on the western side of the house. A pump system is required.
 INSTALLATION Might as well use LPD. See hole spacing plan. A 1/2 HP pump is required. (BB) 6/20/2011 Tanks set. Started on house connection. (BB) 6/22/2011 House connections made. Pump line run under driveway. (BB) 6/24/2011 Rest of pump line installed. Electrical boxes installed. (BB) 6/28/2011 System finished. Two feet of head in upper lateral. O.K. to backfill. (BB)

FINAL INSPECTOR B. Baber DATE OF APPROVAL 6/28/2011

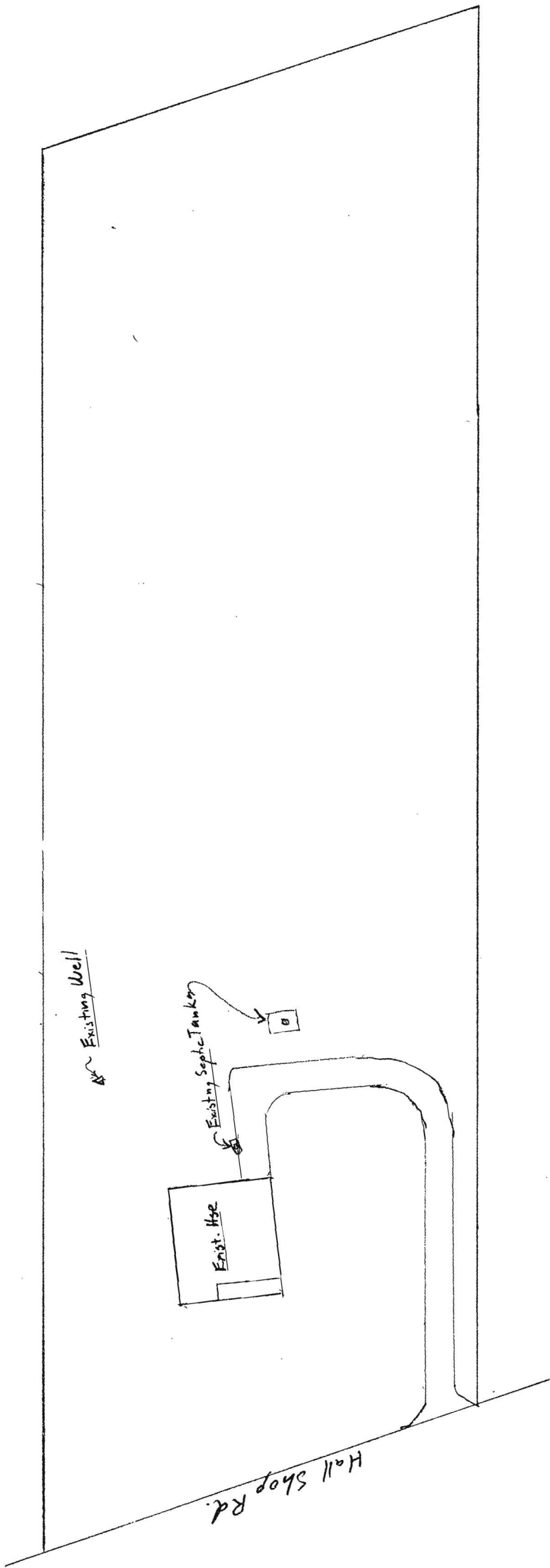

Fred Gossage
11887 Hall Shop Rd
Clarksville, MD 21029