

LAYOUT 8/25/09 INSP 4 _____
INSP 2 8/26/09 INSP 5 _____
INSP 3 _____ INSP 6 _____

ISSUE DATE: 8/17/09 **PERMIT - Repair** P 531096

APPROVAL DATE: 8/26/09 Tax ID # 04332644 A Repair

**ON-SITE SEWAGE DISPOSAL SYSTEM
HOWARD COUNTY HEALTH DEPARTMENT
BUREAU OF ENVIRONMENTAL HEALTH**

Foglia's Septic Clean IS PERMITTED TO INSTALL ALTER

ADDRESS: 580 Obrecht Road. PHONE NUMBER: 410-795-5670

SUBDIVISION: _____ LOT NUMBER: _____

ADDRESS: 16332 Carrs Mill Road PROPERTY OWNER: Frank Castella

SEPTIC TANK CAPACITY (GALLONS): Ex. OUTLET BAFFLE FILTER REQUIRED

PUMP CHAMBER CAPACITY (GALLONS): N/A COMPARTMENTED TANK REQUIRED

NUMBER OF BEDROOMS: 4 APPLICATION RATE: _____

SQUARE FOOTAGE OF HOUSE: N/A

LINEAR FEET OF TRENCH REQUIRED: 160

TRENCHES:	Trenches to be 3 feet wide. Inlet 3-4 feet below original grade. Bottom maximum depth 6-6.5 feet below grade. Effective area begins at 5 feet below original grade. Approx. 3 feet of stone below distribution pipe.
LOCATION:	A Layout inspection is required for correct placement and verification of trench locations. 2x80' trenches will be installed w\ observation pipes at the ends.
NOTES:	Trenches will be maintaining 3' of stone below the pipe laterals throughout. Top trench invert may be deeper than 3' to make fall from ex. septic tank. Bottom trench inlet invert will be shallower. Manhole access needs to be installed on the tank. Pump and collapse ex. dry well.

PLANS APPROVED: Kevin Wolf DATE: 8/17/2009

- NOTE: PERMIT VOID AFTER 2 YEARS
- NOTE: CONTRACTOR RESPONSIBLE FOR SCHEDULING A PRE-CONSTRUCTION INSPECTION FOR ALL INSTALLATIONS
- NOTE: WATERTIGHT SEPTIC TANKS REQUIRED
- NOTE: ALL PARTS OF SEPTIC SYSTEM SHALL BE 100 FEET FROM ANY WATER WELL
- NOTE: MANHOLE RISERS REQUIRED ON ALL SEPTIC TANKS AND PUMP CHAMBERS

NEITHER THE HOWARD COUNTY COUNCIL OR THE HEALTH DEPARTMENT IS RESPONSIBLE FOR THE SUCCESSFUL OPERATION OF ANY SYSTEM PERMITTEE RESPONSIBLE FOR OBTAINING FINAL APPROVAL ON THIS PERMIT CALL 410-313-1771 FOR INSPECTION OF SEPTIC SYSTEM

Ex. Tank Dug

NOT TO SCALE

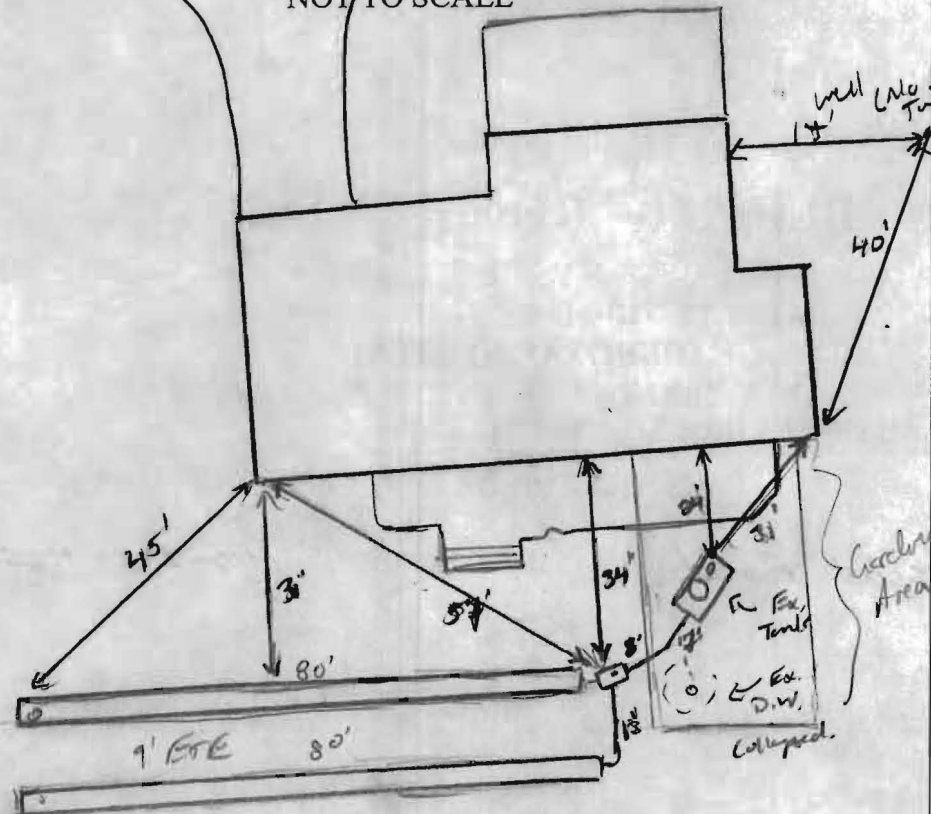

ROAD NAME

TRENCH/DRAINFIELD DATA		
WIDTH	INLET	BOTTOM
3'	4-4.5'	6.5'-7'
NUMBER OF TRENCHES		2
TOTAL LENGTH		160'
ABSORPTION AREA		480+SW
DISTRIBUTION BOX LEVEL		Levelers
DISTRIBUTION BOX BAFFLE		Yes
DISTRIBUTION BOX PORT		Yes

SEPTIC TANK DATA	
SEPTIC TANK I LEVEL	Yes
MANUFACTURER	?
CAPACITY	1250? GAL
SEAM LOC	mid
TANK LID DEPTH	2.5'
BAFFLES	Rear (new)
BAFFLE FILTER	
MANHOLE LOC	Center
6" PORT LOC	Front
WATERTIGHT TEST	
SLOTTED	No
DATE ON LID	
PUMP/SEPTIC TANK LEVEL	
MANUFACTURER	
CAPACITY	
SEAM LOC	
TANK LID DEPTH	
BAFFLES	
BAFFLE FILTER	
MANHOLE LOC	
6" PORT LOC	
WATERTIGHT TEST	
SLOTTED	
DATE ON LID	

PRE-CONSTRUCTION:

8/25/09 Pre-construction meeting w/ Fogler. Ex. Tank dug up. May not be able to maintain 3' Fall. Keep 4' inlet or close to it as possible. Run 2x80' trenches as specified on plan. Call for resp. (19)

INSTALLATION:

8/26/09 Contractor held .25% fall from tank to Dbox. Could not make 4' inlet @ top trench. 4.5' inlet. Dry well pumped & collapsed. OK to cover (19)

FINAL INSPECTOR Jh. Wall DATE OF APPROVAL 8/26/09

Fogle's Septic Clean, Inc.
Fogle's Portable Toilets • Fogle's Well Drilling, LLC
Fogle's Excavating, LLC

August 24, 2009

Howard County Health Department

Ref: 16332 Carrs Mill Road

Mr and Mrs Frank Castella contacted us to install their septic repair at the above address. They had originally contracted with Freedom Septic, Inc. ; but have now contracted with Fogle's Septic Clean, Inc. We ask that the permit be transferred to us. They will settle on their house on August 29 and will need to have the work completed before that date. Thank you for your prompt attention to this matter.

Sincerely,



Dale H. Fogle

