



# APPLICATION

## FOR PERCOLATION TESTING AND SITE EVALUATION

TEST DATE(S) \_\_\_\_\_ TEST TIME \_\_\_\_\_ A/D 53486

AGENCY REVIEW: \_\_\_\_\_ DATE 3-3-11

DO NOT WRITE ABOVE THIS LINE

I HEREBY APPLY FOR THE NECESSARY TESTING/EVALUATION PRIOR TO ISSUANCE OF SEWAGE DISPOSAL SYSTEM PERMIT(S) TO:

CHECK AS NEEDED:

- CONSTRUCT NEW SEPTIC SYSTEM(S)
- REPAIR/ADD TO AN EXISTING SEPTIC SYSTEM
- REPLACE AN EXISTING SEPTIC SYSTEM

CHECK AS NEEDED:

- NEW STRUCTURE(S)
- ADDITION TO AN EXISTING STRUCTURE
- REPLACE AN EXISTING STRUCTURE

CHECK ONE:

- CREATE NEW LOT(S)
- BUILD ON AN EXISTING LOT IN A SUBDIVISION
- BUILD ON AN EXISTING PARCEL OF RECORD

IS THE PROPERTY WITHIN 2500' OF ANY RESERVOIR?

- YES
- NO

1971 Built

THE TYPE OF STRUCTURE IS:

- RESIDENTIAL WITH 3 PROPOSED BEDROOMS IN THE COMPLETED STRUCTURE (NOTE **UNKNOWN** IF APPROPRIATE)
- COMMERCIAL (PROVIDE DETAIL OF NUMBERS AND TYPES OF EMPLOYEES/ CUSTOMERS ON ACCOMPANYING PLAN)
- INSTITUTIONAL/GOVERNMENT (PROVIDE DETAIL OF NUMBERS AND TYPES OF EMPLOYEES/USERS ON ACCOMPANYING PLAN)

PROPERTY OWNER(S) Kirk Siegwirth

DAYTIME PHONE 410-250-6128 CELL \_\_\_\_\_ FAX \_\_\_\_\_

MAILING ADDRESS 10091 Century Dr Ellicott MD 21042  
STREET CITY/TOWN STATE ZIP

APPLICANT Hatfield's Equipment

DAYTIME PHONE 410-984-0047 CELL \_\_\_\_\_ FAX 410 490-5794

MAILING ADDRESS PO Box Annapolis Junction MD 20701  
STREET CITY/TOWN STATE ZIP

APPLICANT'S ROLE: DEVELOPER  BUILDER  BUYER  RELATIVE/FRIEND  REALTOR  CONSULTANT  
Septic Contractor

PROPERTY LOCATION  
SUBDIVISION/PROPERTY NAME \_\_\_\_\_ LOT NO. \_\_\_\_\_

PROPERTY ADDRESS 10091 Century Drive Ellicott City  
STREET TOWN/POST OFFICE

TAX MAP PAGE(S) \_\_\_\_\_ GRID \_\_\_\_\_ PARCEL(S) \_\_\_\_\_ PROPOSED LOT SIZE \_\_\_\_\_

AS APPLICANT, I UNDERSTAND THE FOLLOWING: THE SYSTEM INSTALLED SUBSEQUENT TO THIS APPLICATION IS ACCEPTABLE ONLY UNTIL PUBLIC SEWERAGE IS AVAILABLE. THIS APPLICATION IS COMPLETE WHEN ALL APPLICABLE FEES AND A SUITABLE SITE PLAN HAVE BEEN RECEIVED. I ACCEPT THE RESPONSIBILITY FOR COMPLIANCE WITH ALL M.O.S.H.A. AND "MISS UTILITY" REQUIREMENTS. APPROVAL IS BASED UPON SATISFACTORY REVIEW OF A PERC CERTIFICATION PLAN.

TEST RESULTS WILL BE MAILED TO APPLICANT. \_\_\_\_\_  
SIGNATURE OF APPLICANT

HOWARD COUNTY HEALTH DEPARTMENT, BUREAU OF ENVIRONMENTAL HEALTH, WELL AND SEPTIC PROGRAM  
7178 COLUMBIA GATEWAY DRIVE COLUMBIA, MARYLAND 21046 (410) 313-2640 FAX (410) 313-2648  
TDD (410) 313-2323 TOLL FREE 1-877-4MD-DHMH

(A)  
 8" OM, Top Soil  
 SDBK, Str. Br. CL,  
 WK SDBK,  
 Friable, mist, many roots  
 some mica  
 3-4' Br, Orange Sb,  
 Friable, loose,  
 calc. platy,  
 5% silt clumps  
 many mica  
 many roots  
 7' medium SL, light Br,  
 Friable, Dry,  
 Highly micaceous  
 10% grass frags  
 12' Hard bottom  
 gneiss 12' 8"

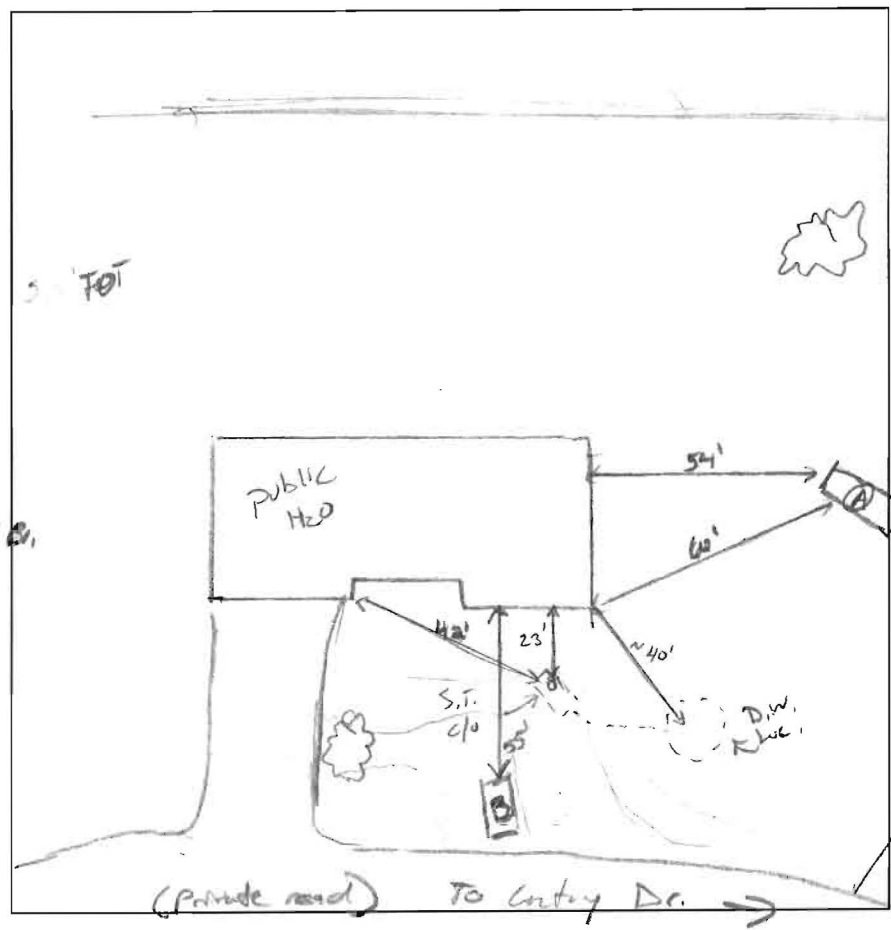

St. CL,  
 m SDBK  
 Friable, roots  
 WK SDBK,  
 Friable.

Pop Lin.

DATE	TEST #	DEPTH	START	BREAK 1" DROP	STOP 2" DROP	TIME OF 2ND INCH	P/F/H
3/9/11	(A)	4' 3" / 12' 8"	12:07	12:12	12:17	5	(P)
		5'	12:21	12:24	12:28	4	(P)

15

(B)  
 10" om, SDBK  
 Str. Br. roots  
 Str. Br. CL,  
 sticky, mist  
 m SDBK, Friable  
 ↓  
 8' VFSL, separate  
 inhabit of Br.  
 10% quartz frag.  
 highly micaceous  
 ↓  
 16' 3"

REMARKS S.T. Depth - 6' S.T. outlet 14V - 7' 65 ton #2 stone  
 Dry well collapse, shot grout in front yard for gravity, not enough mass.  
 SANITARIAN K. Wolf BACKHOE Ken Hatfield Jr. OTHERS Homeowner  
 TEST HOLES USED IN SDA 1 AVG. PERC TIME 4.5 SQ. FT/BR  
 TRENCH WIDTH 2' INLET DEPTH 2' MAX. BOT DEPTH 6' EFFECTIVE SW 3.5

$4(150) = \frac{600}{1.2} = 500 \div 2 = 250 (50) = 130 \text{ LF (must BE PUMP SYSTEM)}$