

C 1 7391

SEQUENCE NO. (MDE USE ONLY)

STATE OF MARYLAND WELL COMPLETION REPORT

THIS REPORT MUST BE SUBMITTED WITHIN 45 DAYS AFTER WELL IS COMPLETED.

(THIS NUMBER IS TO BE PUNCHED IN COLS. 3-6 ON ALL CARDS)

COUNTY NUMBER 13 A530342

ST/CO USE ONLY DATE RECEIVED

DATE WELL COMPLETED

Depth of Well

PERMIT NO. FROM "PERMIT TO DRILL WELL"

OWNER: Cumberland Curtis; STREET OR RFD: Doral Rd.; TOWN: Woodbine; SUBDIVISION: River Farms; SECTION: 2; LOT: 18

WELL LOG Not required for driven wells

STATE THE KIND OF FORMATIONS PENETRATED, THEIR COLOR, DEPTH, THICKNESS AND IF WATER BEARING

Table with columns: DESCRIPTION, FEET (FROM, TO), check if water bearing. Rows include Top Soil, Brown Slate, Blue Slate, Flint Rock, etc.

GROUTING RECORD WELL HAS BEEN GROUTED (Y) (N)

TYPE OF GROUTING MATERIAL (C) (B) CEMENT BENTONITE CLAY

CASING RECORD (S) (C) (P) (O) STEEL CONCRETE PLASTIC OTHER

MAIN CASING TYPE Nominal diameter top (main) casing (nearest inch)! Total depth of main casing (nearest foot)

OTHER CASING (if used) diameter inch depth (feet) from to

SCREEN RECORD (S) (B) (H) (P) (O) STEEL BRASS BRONZE PLASTIC OPEN HOLE OTHER

NUMBER OF UNSUCCESSFUL WELLS: 0

WELL HYDROFRACTURED (Y) (N)

CIRCLE APPROPRIATE LETTER A WELL WAS ABANDONED AND SEALED WHEN THIS WELL WAS COMPLETED

I HEREBY CERTIFY THAT THIS WELL HAS BEEN CONSTRUCTED IN ACCORDANCE WITH COMAR 26.04.04 "WELL CONSTRUCTION" AND IN CONFORMANCE WITH ALL CONDITIONS STATED IN THE ABOVE CAPTIONED PERMIT...

DRILLERS LIC. NO. 1 M SD 112

DRILLERS SIGNATURE (MUST MATCH SIGNATURE ON APPLICATION)

SITE SUPERVISOR (sign. of driller or journeyman responsible for sitework if different from permittee)

DEPTH (nearest ft.)

Table with columns: A, C, H, S, R, E, N. Rows for casing sections 1, 2, 3.

GRAVEL PACK IF WELL DRILLED WAS FLOWING WELL INSERT F IN BOX 68

MDE USE ONLY (NOT TO BE FILLED IN BY DRILLER) T (E.R.O.S.) W Q

C 3

PUMPING TEST HOURS PUMPED (nearest hour) 3

PUMPING RATE (gal. per min.) 7.5

METHOD USED TO MEASURE PUMPING RATE

WATER LEVEL (distance from land surface) BEFORE PUMPING 29 ft.

WHEN PUMPING 38 ft.

TYPE OF PUMP USED (for test) (A) air (P) piston (T) turbine (C) centrifugal (R) rotary (O) other (J) jet (S) submersible

PUMP INSTALLED DRILLER INSTALLED PUMP YES (NO)

IF DRILLER INSTALLS PUMP, THIS SECTION MUST BE COMPLETED FOR ALL WELLS.

TYPE OF PUMP INSTALLED PLACE (A,C,J,P,R,S,T,O) IN BOX 29

CAPACITY: GALLONS PER MINUTE (to nearest gallon) 31 35

PUMP HORSE POWER 37 41

PUMP COLUMN LENGTH (nearest ft.) 43 47

CASING HEIGHT (circle appropriate box and enter casing height) (+) above () below LAND SURFACE 2 (nearest) foot

LOCATION OF WELL ON LOT SHOW PERMANENT STRUCTURE SUCH AS BUILDING, SEPTIC TANKS, AND /OR LANDMARKS AND INDICATE NOT LESS THAN TWO DISTANCES (MEASUREMENTS TO WELL)

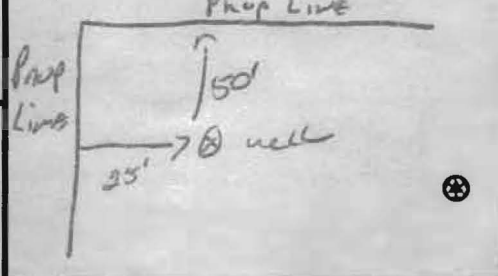

B 1 **8487**

SEQUENCE NO. (MDE USE ONLY)

STATE OF MARYLAND
APPLICATION FOR PERMIT TO DRILL WELL
532500 please type

STATE PERMIT NUMBER

HO - 95 - 1866
fill in this form completely

Date Received (APA)

OWNER INFORMATION

8 MM DD YY 13
Cumberland Curtis
15 Last Name Owner First Name 34
2261 Duval Rd
36 Street or RFD 55
WOODBINE MD. 21797
57 Town 70 State 72 Zip 76

B 3 LOCATION OF WELL

8 COUNTY **Howard** 21
River Farm's
23 SUBDIVISION 42
SECTION **2** LOT **18**
44 46 48 50
WOODBINE MD.
52 NEAREST TOWN 71
MILES FROM TOWN (enter 0 if in town) **4** M 1
73 76 77 78

DRILLER INFORMATION

Ralph E Mayne M S D 119
76 Driller's Name License No. 81
Ralph E. Mayne Inc
Firm Name
17024 Handy Rd Mt. Airy MD 21771
Address
R E Mayne **1-13-10**
Signature Date

B 4

1 2
DIRECTION OF WELL FROM TOWN (CIRCLE BOX)

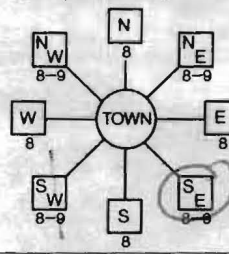

Duval Rd
11 NEAR WHAT ROAD 30
ON WHICH SIDE OF ROAD (CIRCLE APPROPRIATE BOX)
NORTH N
WEST W EAST E
34 40 37 SOUTH S
DISTANCE FROM ROAD **A**
ENTER FT OR MI 38 39
TAX MAP: _____ BLK: _____ PARCEL _____

B 2 WELL INFORMATION

1 2
APPROX. PUMPING RATE (GAL. PER MIN.) **5**
8 12
AVERAGE DAILY QUANTITY NEEDED (GAL. PER DAY) **500**
14 20

NOT TO BE FILLED IN BY DRILLER HEALTH DEPARTMENT APPROVAL

Howard (13) **A 530342**
COUNTY NAME COUNTY NO.
STATE SIGNATURE _____ INSERT S → 41
DATE ISSUED **2/5/10** **Kim Wolf** **2/5/11**
43 MM DD YY 48 CO SIGNATURE EXP. DATE
NORTH GRID **534 000** EAST GRID **6776 000**
50 55 57 63

USE FOR WATER (CIRCLE APPROPRIATE BOX)

- DOMESTIC POTABLE SUPPLY & RESIDENTIAL IRRIGATION
- FARMING (LIVESTOCK WATERING & AGRICULTURAL IRRIGATION)
- INDUSTRIAL, COMMERCIAL, DEWATERING
- PUBLIC WATER SUPPLY WELL
- TEST, OBSERVATION, MONITORING
- GEO-THERMAL

Handwritten notes:
24655
4-3pm
225 depth
80' casing
21' stub

APPROXIMATE DEPTH OF WELL **150** FEET
24 28

APPROXIMATE DIAMETER OF WELL **64** NEAREST INCH

METHOD OF DRILLING (circle one)

BORED (or Augered) JETTED Jetted & DRIVEN
30 AIR-ROTARY AIR-PERCussion ROTARY (Hydraulic Rotary)
37 CABLE REVerse-ROTary DRive-POINT
other _____

REPLACEMENT OR DEEPEMED WELLS (CIRCLE APPROPRIATE BOX)

- THIS WELL WILL NOT REPLACE AN EXISTING WELL
 - THIS WELL WILL REPLACE A WELL THAT WILL BE ABANDONED AND SEALED
 - 39 THIS WELL WILL REPLACE A WELL THAT WILL BE USED AS A STANDBY-CONTACT LOCAL APPROVING AUTHORITY FOR POLICY ON STANDBY WELLS
 - THIS WELL WILL DEEPEMED AN EXISTING WELL
- PERMIT NUMBER OF WELL TO BE REPLACED OR DEEPEMED (IF AVAILABLE) 41 _____ 52

SHOW MAJOR FEATURES OF BOX & LOCATE WELL WITH AN X

- SOURCES OF DRILLING WATER
1. well
 - 2.
 - 3.

WRITE THE BOX NUMBER FROM THE MAP HERE
E **760 776**
N **530 4**

DRAW A SKETCH BELOW SHOWING LOCATION OF WELL IN RELATION TO NEARBY TOWNS AND ROADS AND GIVE DISTANCE FROM WELL TO NEAREST ROAD JUNCTION

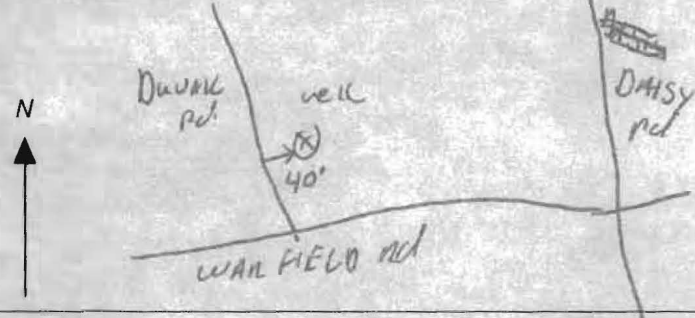

Not to be filled in by driller (MDE OR COUNTY USE ONLY)

APPROX. PERMIT NUMBER _____ G _____
PERMIT No. **HO - 95 - 1866**
70 71 72 73 74 75 76 77 78 79

SPECIAL CONDITIONS

NOTE APPROVING AUTHORITIES SHOULD USE SEPARATE SHEET IF NEEDED

**HOWARD COUNTY HEALTH DEPARTMENT
BUREAU OF ENVIRONMENTAL HEALTH
WATER AND SEWERAGE PROGRAM
TEL: (410)313-2640 FAX: (410)313-2648**

Information Form for the Installation of the Well Pump, Pitless Adapter, and Supply Piping

NOTE: The installer is responsible for requesting an inspection prior to 9 am on the day of the desired inspection. No work is to be covered until approved by the Health Department. All installations must comply with the National Standard Plumbing Code (NSPC, as amended locally) and COMAR 26.04.04 (MD Well Construction Regulations). Submission of a complete form is required prior to Use and Occupancy approval.

Company Name: Cumberland Co. Inc Telephone #: 301-252-1123
Address: 16391 A.F. Mullins Rd
Woodbine

(Must circle one) Licensed Plumber Licensed Well Driller Licensed Well Pump Installer

License # and name of individual responsible for the field installation:

Name (Print): Kelly Cumberland License# 61717

***A licensed individual must perform the actual installation. Apprentices must be under the supervision of a licensed journeyman or master plumber, pump installer or well driller. Licenses may be subjected to field verification. Unlicensed individuals may be reported to the appropriate licensing agency.**

Name of Property Owner: Anderson Telephone #: 301-252-1122
Subdivision: River Face Lot #: 18 Well Tag #: HO-95-1866
Site Address: 2959 Dural Rd
Woodbine Md

Submersible Pump Data

Make: Grumpf
Model #: 15-187
Pump Capacity: 8 GPM
Well Yield: 8 GPM

Pitless Adapter

Make: Pool
Model #: 1'
Depth: 42 (36" min)
NSF/WSC approved:

Well Cap and Electric Conduit

Two piece watertight cap:
Screened, vented well cap:
Cap secured to casing:
Conduit min 18" B.G.:
Conduit secured to well cap:

Depth of well encountered at time of pump installation: 30 (feet)

If pump capacity exceeds well yield, a low water cut off switch is required by NSPC 1990 Section 17.8.4

Torque arrestors, Cable guards, or other acceptable method used- Must circle one

Safety rope, if used, attached to brass rope adapter or other acceptable method inside of well casing

Piping to house

Type: 1" Poly
PSI: 160 (160 psi min)
Depth of supply line: 42 (36" min)

House Connection

PVC sleeve to undisturbed soil at wall penetration:
Approximate length of sleeve: 60"
Sleeve caulked and sealed properly:

The water supply line is required to be at least ten feet from the septic tank, pump chamber, sewage piping, distribution box, drainfields, and sewage reserve area. If this cannot be accomplished, contact this office for approval prior to installation.

Kelly Cumberland 6-4-15
Signature of company representative responsible for installation date

For Health Department Use Only - Not to be completed by Installer

Date Insp. Requested: _____ Date Insp. Approved: 10/21/14 Inspector: BBB
Inspection Data: Pitless adapter watertight & water supply line at least 36" below grade
Two piece cap installed and attached to casing securely
Elec. conduit extends at least 18" below grade/attached to cap properly
Safety rope not seen outside of well cap/casing
Correct well tag attached properly and casing 8" above finished grade
Water supply line sleeved adequately at house connection
Adequate grout observed below pitless adapter

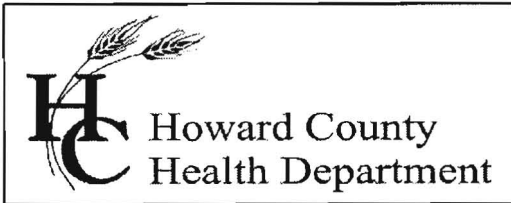

Bureau of Environmental Health

8930 Stanford Blvd., Columbia, MD 21045
Main: 410-313-2640 | Fax: 410-313-2648
TDD 410-313-2323 | Toll Free 1-866-313-6300
www.hchealth.org

Facebook: www.facebook.com/hocohealth
Twitter: HowardCoHealthDep

Maura J. Rossman, M.D., Health Officer

INTERIM CERTIFICATE OF POTABILITY

Expiration Date – DECEMBER 12, 2015

June 12, 2015

Homeowner
2959 Duvall Road
Woodbine, MD 21797

RE: River Farms, Lot 18
2959 Duvall Road
Building Permit: B14003042
Well Permit: HO-95-1866

Dear Homeowner:

This is to advise you that the septic system installation and water well construction for the above referenced property have been inspected and approved. Final approval of the septic system was granted on **6/11/2015**. Final approval of the well line connection to the dwelling was granted on **10/21/2014**. The well construction was completed on **3/17/2010**. Water samples were collected on **6/9/2015**.

The water sample results indicate that the water samples submitted for testing were free of coliform and fecal coliform bacteria at the time of sampling and are bacteriologically safe for drinking. This certifies that the initial sampling requirements of COMAR 26.04.04 "Well Regulations" have been met for the water supply system installed under well permit HO-95-1866. Although the submitted sample results are in compliance with COMAR standards, the Health Department does not guarantee water supplies.

This Interim Certificate of Potability will expire **six months** from the date of issuance. Submission of a second bacteriological test indicating the water is free of coliform and fecal coliform bacteria is required prior to the expiration date, after which time a Final Certificate of Potability will be issued. **Failure to submit an additional sample and obtain a Final Certificate of Potability will result in a Notice of Violation and is punishable as a misdemeanor under the Annotated Code of Maryland, Environment Article, 9-1311, subject to a fine of up to \$500 or imprisonment not to exceed three months.**

Please contact (410) 313-1773 to schedule a final water sample appointment or contact a Maryland certified water laboratory to schedule a water sample. A list of laboratories certified by the state of Maryland may be found at the following website:
<http://www.mde.state.md.us/assets/document/WSP-Labs-2010apr16.pdf>

Approving Authority,

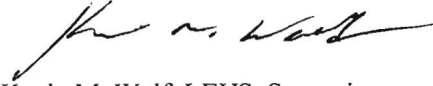
A handwritten signature in black ink, appearing to read "Kevin M. Wolf". The signature is fluid and cursive, with a long horizontal stroke at the end.

Kevin M. Wolf, LEHS, Supervisor
Groundwater Mgmt. Sec.
Well & Septic Program

cc: Howard County Dept. of Inspections, Licenses, and Permits
Community Hygiene Program
File

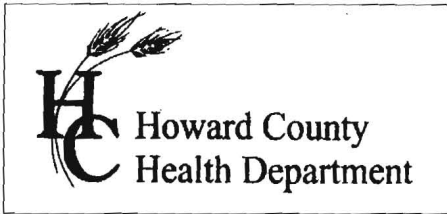

7178 Columbia Gateway Dr., Columbia, MD 21046
 (410) 313-2640 Fax (410) 313-2648
 TDD (410) 313-2323 Toll Free 1-866-313-6300
 website: www.hchealth.org

Peter L. Bielensohn, M.D., M.P.H., Health Officer

TO ALL INTERESTED PARTIES

When submitting a well application for a proposed well for new construction, please indicate one of the following:

Well Site Location:

RIVER FARMS 18 Sec 2 Duwall Rd
 Subdivision/Property Name Lot # Road Name

The well site has been staked by CS ENGINEERING,
 (professional land surveyor or company employing professional land surveyors)
 on 9/29/09 (date) and does not require a site inspection.

The well driller, builder or property owner will call the Health Department to schedule a time to meet in the field to verify the proposed well site location.

This sheet, along with two copies of an acceptable well site plan, must be attached to the green well permit application.

Revised 3/11/07

STATE
 HEALTH
 DEPARTMENT
 WELL PERMIT APPLICATION
 FORM 10-1
 10/07

FOUNTAIN VALLEY ANALYTICAL LABORATORY, INC.

1413 Old Taneytown Rd. Westminster, MD (410) 848-1014 (410) 876-4554 FAX (410) 848-0298

REPORT OF ANALYSIS

Laboratory ID #: 101148 Account #: 7085
Reference: Cumberland Dev. Company: Cumberland Development
Location: 2959 Duvall Road Requested By: Curtis L. Cumberland
Woodbine, MD 21797 Source: Well Water
Date/ Time Collected: 6/9/2015 1110 Site: Pressure Tank
Date/Time Rec'd: 6/9/2015 1240 Treatment: Prior to Sediment Filter
Chlorine ppm: Free: ND Total: ND pH: 5.8
Collected By: J. Yeager 6176JY Well #: HO-95-1866

PARAMETERS	RESULTS	UNITS	REFERENCE	METHOD	DATE/TIME/ANALYST
Bacteria, Coliform, Total, MPN	<1.0 ✓	MPN/ 100 ml	<1.0	SM18 9223	6/10/2015 / 1015 / CCH
Bacteria, E. coli, MPN	<1.0 ✓	MPN/ 100 ml	<1.0	SM18 9223	6/10/2015 / 1015 / CCH
Nitrate	4.18 ✓	mg/L	10	601	6/9/2015 / 1615 / CRS
Turbidity	0.59 ✓	NTU	<10	SM18 2130B	6/9/2015 / 1715 / CRS
Sand	NS	mg/L	5	Visual/Gravimetric	6/9/2015 / 1715 / CRS

NOTES

- 1 mg/L = milligrams per liter (also, parts per million)
- 2 MPN/ 100 ml = Most Probable Number [of viable bacteria] per 100 ml of sample.
- 3 NS = None Seen (NS indicates less than 5 mg/L)
- 4 NTU = Nephelometric Turbidity Units
- 5 Results less than or within the reference range are considered satisfactory and within potable water limits at the time of sampling.
- 6 ND:None Detected
- 7 Visual well check: Sealed, vented cap
- 8 pH & Chlorine level tested on site

Reason for Test : Use & Occupancy

Building Permit # : B14003042

Date Reported: 6/10/2015