

PUB. SEWER STATUS VERIFIED BY _____

ISSUE DATE: 10/1/2009

PERMIT

P 531932

APPROVAL DATE: 10/7/09

A REPAIR

Tax ID # 05-432324

ON-SITE SEWAGE DISPOSAL SYSTEM HOWARD COUNTY HEALTH DEPARTMENT BUREAU OF ENVIRONMENTAL HEALTH

Fogles Septic Clean, Inc IS PERMITTED TO INSTALL ALTER

ADDRESS: 580 Obrecht Rd, Sykesville MD 21784 PHONE NUMBER: 410-795-5670

SUBDIVISION: Big Branch Overlook LOT NUMBER: 42

ADDRESS: 14056 Big Branch Drive PROPERTY OWNER: _____

SEPTIC TANK CAPACITY (GALLONS): _____

PUMP CHAMBER CAPACITY (GALLONS): _____

NUMBER OF BEDROOMS: 4

SQUARE FOOTAGE (OF HOUSE): _____

LINEAR FEET OF TRENCH REQUIRED: _____

TRENCHES:	Trench to be feet wide. Inlet at feet below original grade. Bottom maximum depth feet below original grade. Effective area begins at feet below original grade. feet of stone below the distribution pipe.
LOCATION:	In support of Building Permit for a deck, D-Box to be moved and piping to the trenches adjusted. Call for inspection when ground is opened.
ADDITIONAL NOTES:	

PLANS APPROVED: _____ DATE: _____

- NOTE: PERMIT VOID AFTER 2 YEARS
- NOTE: CONTRACTOR RESPONSIBLE FOR SCHEDULING A PRE-CONSTRUCTION INSPECTION FOR ALL INSTALLATIONS
- NOTE: WATERTIGHT SEPTIC TANKS REQUIRED
- NOTE: ALL PARTS OF SEPTIC SYSTEM SHALL BE 100 FEET FROM ANY WATER WELL
- NOTE: MANHOLE RISERS REQUIRED ON ALL SEPTIC TANKS AND PUMP CHAMBERS

NEITHER THE HOWARD COUNTY COUNCIL OR THE HEALTH DEPARTMENT IS RESPONSIBLE FOR THE SUCCESSFUL OPERATION OF ANY SYSTEM PERMITTEE RESPONSIBLE FOR OBTAINING FINAL APPROVAL ON THIS PERMIT CALL 410-313-2640 FOR INSPECTION OF SEPTIC SYSTEM

NOT TO SCALE

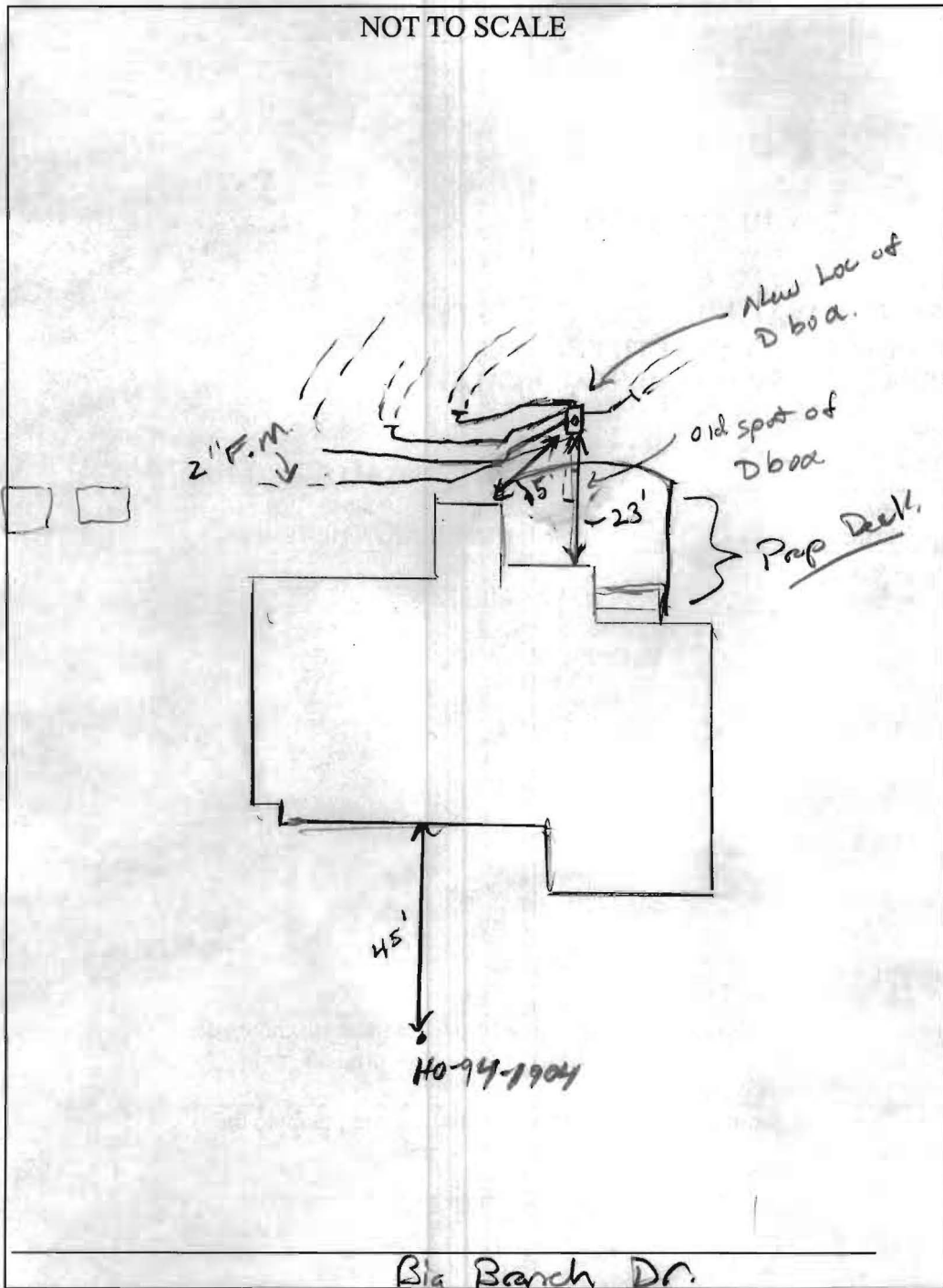

TRENCH/DRAINFIELD DATA		
WIDTH	INLET	BOTTOM
_____	_____	_____
NUMBER OF TRENCHES _____		
TOTAL LENGTH _____		
ABSORPTION AREA _____		
DISTRIBUTION BOX LEVEL _____		
DISTRIBUTION BOX BAFFLE _____		
DISTRIBUTION BOX PORT _____		

SEPTIC TANK DATA	
SEPTIC TANK 1 LEVEL _____	
MANUFACTURER	_____
CAPACITY	_____ GAL
SEAM LOC	_____
TANK LID DEPTH	_____
BAFFLES	_____
BAFFLE FILTER	_____
MANHOLE LOC	_____
6" PORT LOC	_____
WATERTIGHT TEST	_____
SLOTTED	_____
PUMP/SEPTIC TANK LEVEL _____	
MANUFACTURER	_____
CAPACITY	_____ GAL
SEAM LOC	_____
TANK LID DEPTH	_____
BAFFLES	_____
BAFFLE FILTER	_____
MANHOLE LOC	_____
6" PORT LOC	_____
WATERTIGHT TEST	_____
SLOTTED	_____

PRE-CONSTRUCTION

Big Branch Dr.

(10:30am)

INSTALLATION 10/7/09 Contractor exposed D box, F.M. and dist. network. Proposed Deck marked off in field. Re-locate D box ~ 5' downhill and re-plan dist. network and F.M. (150)

10/7/09 (2:30 PM) D box moved ~ 45' away from here. F.M. re-routed out of way from proposed Deck. Dist. network re-routed away from proposed Deck area. (150)

FINAL INSPECTOR Jh. Wolf DATE OF APPROVAL 10/7/09