



Building Permit Application

Howard County Maryland
Department of Inspections, Licenses and Permits
3430 Court House Drive
Permits: 410-313-2455
www.howardcountymd.gov

Date Received: _____

Permit No.: _____

Building Address: 7530 Browns Bridge Rd.
 City: Highland State: MD Zip Code: 20777
 Suite/Apt. # D/A SDP/WP/BA #: _____
 Census Tract: _____ Subdivision: Greenwood Farm
 Section: N/A Area: _____ Lot: 6
 Tax Map: 0040 Parcel: 0158 Grid: 0018
 Zoning: _____ Map Coordinates: _____ Lot Size: 1 AC

Property Owner's Name: RINA S. ROCA VITO ROCA
 Address: 7530 Browns Bridge Rd.
 City: Highland State: MD Zip Code: 20777
 Phone: 301-854-0295 Fax: _____
 Email: Rinasant@AOL.com

Existing Use: Home
 Proposed Use: HOME
 Estimated Construction Cost: \$ _____
 Description of Work: add a sunroom
 Occupant or Tenant: owner
 Was tenant space previously occupied? N/A Yes No
 Contact Name: Property owner
 Address: _____
 City: _____ State: _____ Zip Code: _____
 Phone: _____ Fax: _____
 Email: _____

Applicant's Name & Mailing Address, (if other than stated herein)
 Applicant's Name: _____
 Address: _____
 City: _____ State: _____ Zip Code: _____
 Phone: _____ Fax: _____
 Email: _____

Contractor Company: _____
 Contact Person: VITO ROCA
 Address: 7530 Browns Bridge Rd
 City: Highland State: MD Zip Code: 20777
 License No.: _____
 Phone: 301-854-0295 Fax: _____
 Email: Rinasant@AOL.com

Engineer/Architect Company: _____
 Responsible Design Prof.: _____
 Address: _____
 City: _____ State: _____ Zip Code: _____
 Phone: _____ Fax: _____
 Email: _____

Commercial Building Characteristics	Residential Building Characteristics
Height: _____	<input checked="" type="checkbox"/> SF Dwelling <input type="checkbox"/> SF Townhouse
No. of stories: _____	Depth _____ Width _____
Gross area, sq. ft./floor: _____	1 st floor: <u>1400</u>
Area of construction (sq. ft.): _____	2 nd floor: _____
Use group: _____	Basement: <input checked="" type="checkbox"/> Finished Basement
Construction type: _____	<input checked="" type="checkbox"/> Unfinished Basement
<input type="checkbox"/> Reinforced Concrete	<input type="checkbox"/> Crawl Space
<input type="checkbox"/> Structural Steel	<input type="checkbox"/> Slab on Grade
<input type="checkbox"/> Masonry	No. of Bedrooms: <u>3</u>
<input type="checkbox"/> Wood Frame	<u>Multi-family Dwelling</u>
<input type="checkbox"/> State Certified Modular	No. of efficiency units: _____
	No. of 1 BR units: _____
	No. of 2 BR units: _____
	No. of 3 BR units: _____
	Other Structure: _____
	Dimensions: _____
<input checked="" type="checkbox"/> Roadside Tree Project Permit	Footings: _____
<input type="checkbox"/> Yes <input type="checkbox"/> No	Roof: _____
Roadside Tree Project Permit # _____	<input type="checkbox"/> State Certified Modular
	<input type="checkbox"/> Manufactured Home

Utilities	
<u>Water Supply</u>	
<input type="checkbox"/> Public	
<input checked="" type="checkbox"/> Private	
<u>Sewage Disposal</u>	
<input type="checkbox"/> Public	
<input checked="" type="checkbox"/> Private	
Electric: <input checked="" type="checkbox"/> Yes <input type="checkbox"/> No	
Gas: <input checked="" type="checkbox"/> Yes <input type="checkbox"/> No	
<u>Heating System</u>	
<input type="checkbox"/> Electric <input type="checkbox"/> Oil	
<input checked="" type="checkbox"/> Natural Gas <input type="checkbox"/> Propane Gas	
<input type="checkbox"/> Other: _____	
<u>Sprinkler System:</u>	
<input type="checkbox"/> Yes <input checked="" type="checkbox"/> No	
Grading Permit Number: _____	
Building Shell Permit Number: _____	

THE UNDERSIGNED HEREBY CERTIFIES AND AGREES AS FOLLOWS: (1) THAT HE/SHE IS AUTHORIZED TO MAKE THIS APPLICATION; (2) THAT THE INFORMATION IS CORRECT; (3) THAT HE/SHE WILL COMPLY WITH ALL REGULATIONS OF HOWARD COUNTY WHICH ARE APPLICABLE THERETO; (4) THAT HE/SHE WILL PERFORM NO WORK ON THE ABOVE REFERENCED PROPERTY NOT SPECIFICALLY DESCRIBED IN THIS APPLICATION; (5) THAT HE/SHE GRANTS COUNTY OFFICIALS THE RIGHT TO ENTER ONTO THIS PROPERTY FOR THE PURPOSE OF INSPECTING THE WORK PERMITTED AND POSTING NOTICES.

Applicant's Signature: Rina S. Roca
 Email Address: Rinasant@AOL.com
 Title/Company: _____

Print Name: RINA S. ROCA
 Date: 06/16/15

Checks Payable to: DIRECTOR OF FINANCE OF HOWARD COUNTY
 PLEASE WRITE NEATLY & LEGIBLY
 -FOR OFFICE USE ONLY-

AGENCY	DATE	SIGNATURE OF APPROVAL
State Highways		
Building Officials		
PSZA (Zoning)		
PSZA (Engineering)		
Health		<u>L. B. Bernard</u>

Is Sediment Control approval required for Issuance? Yes No
 CONTINGENCY CONSTRUCTION START

DPZ SETBACK INFORMATION	
Front:	
Rear:	
Side:	
Side St.:	
All minimum setbacks met?	<input type="checkbox"/> Yes <input type="checkbox"/> No
Is Entrance Permit Required?	<input type="checkbox"/> Yes <input type="checkbox"/> No
Historic District?	<input type="checkbox"/> Yes <input type="checkbox"/> No
Lot Coverage for New Town Zone:	
SDP/Red-line approval date:	

Filing Fee	\$
Permit Fee	\$
Tech Fee	\$
Excise Tax	\$
PSFS	\$
Guaranty Fund	\$
Add'l per Fee	\$
Total Fees	\$
Sub-Total Paid	\$
Balance Due	\$
Check #	#

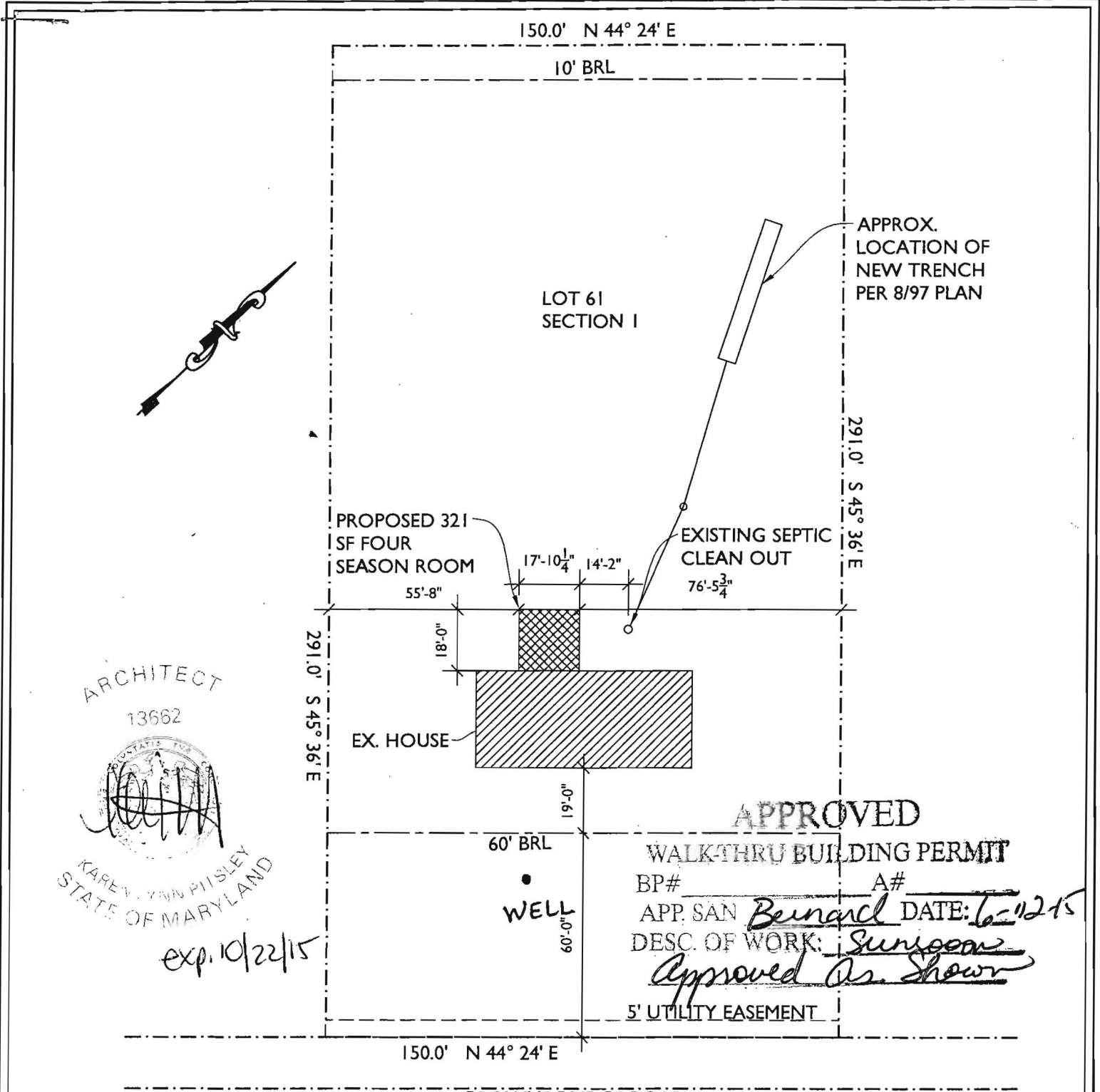

ARCHITECT
13662

KAREY ANN PITTSLEY
STATE OF MARYLAND

exp. 10/22/15

APPROVED
WALKTHRU BUILDING PERMIT
BP# _____ A# _____
APP. SAN Bernard DATE: 6-12-15
DESC. OF WORK: Surgeon
Approved As Shown

01
A-1

SITE PLAN

SCALE: 1/40"=1'-0"



7612 Browns Bridge Rd
Highland, MD 20777
301-776-2666
301-776-2886 fax
1-877-828-7267
info@TransformingArchitecture.com
www.TransformingArchitecture.com

The Roca Residence
7530 Browns Bridge Road, Highland, MD 20777

SCALE: AS NOTED DATE: 06-11-15 PROJECT No: 15-217