



# Building Permit Application

Howard County Maryland  
Department of Inspections, Licenses and Permits  
3430 Court House Drive  
Permits: 410-313-2455  
www.howardcountymd.gov

Date Received: \_\_\_\_\_

Permit No.: \_\_\_\_\_

Building Address: 6501 Heather Glen Way  
City: Clarksville State: MD Zip Code: 21029  
Suite/Apt. # \_\_\_\_\_ SDP/WP/BA #: \_\_\_\_\_  
Census Tract: \_\_\_\_\_ Subdivision: Willow Pond  
Section: \_\_\_\_\_ Area: \_\_\_\_\_ Lot: 57  
Tax Map: 34 Parcel: 382 Grid: 17  
Zoning: \_\_\_\_\_ Map Coordinates: \_\_\_\_\_ Lot Size: ±5AC

Existing Use: Single Family  
Proposed Use: SAME  
Estimated Construction Cost: \$ 30,000.00  
Description of Work: Install new deck at rear of house w/steps 740 SF

Occupant or Tenant: owner  
Was tenant space previously occupied?  Yes  No  
Contact Name: \_\_\_\_\_  
Address: \_\_\_\_\_  
City: \_\_\_\_\_ State: \_\_\_\_\_ Zip Code: \_\_\_\_\_  
Phone: \_\_\_\_\_ Fax: \_\_\_\_\_  
Email: \_\_\_\_\_

Property Owner's Name: Sherman Canapp  
Address: SOME  
City: \_\_\_\_\_ State: \_\_\_\_\_ Zip Code: \_\_\_\_\_  
Phone: 301 305 1249 Fax: \_\_\_\_\_  
Email: \_\_\_\_\_

Applicant's Name & Mailing Address, (If other than stated herein)  
Applicant's Name: \_\_\_\_\_  
Address: \_\_\_\_\_  
City: \_\_\_\_\_ State: \_\_\_\_\_ Zip Code: \_\_\_\_\_  
Phone: \_\_\_\_\_ Fax: \_\_\_\_\_  
Email: \_\_\_\_\_

Contractor Company: owner  
Contact Person: Bernd Greis  
Address: \_\_\_\_\_  
City: \_\_\_\_\_ State: \_\_\_\_\_ Zip Code: \_\_\_\_\_  
License No.: \_\_\_\_\_  
Phone: 301 674 6551 Fax: \_\_\_\_\_  
Email: Smokeygreis@gmail.com

Engineer/Architect Company: Morningstar  
Responsible Design Prof.: Jonathan Seils  
Address: 4991 Morningstar DR  
City: Dorton State: MD Zip Code: 21036  
Phone: 301 854 9012 Fax: \_\_\_\_\_  
Email: jseils@mostarchitects.net

Commercial Building Characteristics	Residential Building Characteristics	
Height:	<input checked="" type="checkbox"/> SF Dwelling <input type="checkbox"/> SF Townhouse	
No. of stories: <u>2</u>	Depth	Width
Gross area, sq. ft./floor:	1 <sup>st</sup> floor:	
	2 <sup>nd</sup> floor:	
Area of construction (sq. ft.):	Basement:	
	<input checked="" type="checkbox"/> Finished Basement	
Use group:	<input type="checkbox"/> Unfinished Basement	
	<input type="checkbox"/> Crawl Space	
<b>Construction type:</b>	<input type="checkbox"/> Slab on Grade	
<input type="checkbox"/> Reinforced Concrete	No. of Bedrooms:	
<input type="checkbox"/> Structural Steel	<b>Multi-family Dwelling</b>	
<input type="checkbox"/> Masonry	No. of efficiency units:	
<input checked="" type="checkbox"/> Wood Frame	No. of 1 BR units:	
<input type="checkbox"/> State Certified Modular	No. of 2 BR units:	
	No. of 3 BR units:	
	Other Structure:	
	Dimensions:	
<input checked="" type="checkbox"/> Roadside Tree Project Permit	Footings:	
<input type="checkbox"/> Yes <input type="checkbox"/> No	Roof:	
Roadside Tree Project Permit #	<input type="checkbox"/> State Certified Modular	
	<input type="checkbox"/> Manufactured Home	

Utilities	
<b>Water Supply</b>	
<input type="checkbox"/> Public	
<input checked="" type="checkbox"/> Private	
<b>Sewage Disposal</b>	
<input type="checkbox"/> Public	
<input checked="" type="checkbox"/> Private	
Electric: <input checked="" type="checkbox"/> Yes <input type="checkbox"/> No	
Gas: <input checked="" type="checkbox"/> Yes <input type="checkbox"/> No	
<b>Heating System</b>	
<input type="checkbox"/> Electric <input type="checkbox"/> Oil	
<input checked="" type="checkbox"/> Natural Gas <input type="checkbox"/> Propane Gas	
<input type="checkbox"/> Other:	
<b>Sprinkler System:</b>	
<input checked="" type="checkbox"/> Yes <input type="checkbox"/> No	
Grading Permit Number:	
Building Shell Permit Number:	

THE UNDERSIGNED HEREBY CERTIFIES AND AGREES AS FOLLOWS: (1) THAT HE/SHE IS AUTHORIZED TO MAKE THIS APPLICATION; (2) THAT THE INFORMATION IS CORRECT; (3) THAT HE/SHE WILL COMPLY WITH ALL REGULATIONS OF HOWARD COUNTY WHICH ARE APPLICABLE THERETO; (4) THAT HE/SHE WILL PERFORM NO WORK ON THE ABOVE REFERENCED PROPERTY NOT SPECIFICALLY DESCRIBED IN THIS APPLICATION; (5) THAT HE/SHE GRANTS COUNTY OFFICIALS THE RIGHT TO ENTER ONTO THIS PROPERTY FOR THE PURPOSE OF INSPECTING THE WORK PERMITTED AND POSTING NOTICES.

Bernd Greis Owners rep.  
Applicant's Signature  
Smokeygreis@gmail.com  
Email Address  
owner rep.  
Title/Company

BERND GREIS  
Print Name  
6-11-15  
Date

Checks Payable to: DIRECTOR OF FINANCE OF HOWARD COUNTY  
\*\*PLEASE WRITE NEATLY & LEGIBLY\*\*  
-FOR OFFICE USE ONLY-

AGENCY	DATE	SIGNATURE OF APPROVAL
State Highways		
Building Officials		
PSZA ( Zoning )		
PSZA ( Engineering )		
Health	<u>6/11/15</u>	<u>H. Oswald</u>

Is Sediment Control approval required for issuance?  Yes  No  
 CONTINGENCY CONSTRUCTION START

DPZ SETBACK INFORMATION
Front:
Rear:
Side:
Side St.:
All minimum setbacks met? <input type="checkbox"/> Yes <input type="checkbox"/> No
Is Entrance Permit Required? <input type="checkbox"/> Yes <input type="checkbox"/> No
Historic District? <input type="checkbox"/> Yes <input type="checkbox"/> No
Lot Coverage for New Town Zone:
SDP/Red-line approval date:

Filing Fee	\$
Permit Fee	\$
Tech Fee	\$
Excise Tax	\$
PSFS	\$
Guaranty Fund	\$
Add'l per Fee	\$
Total Fees	\$
Sub-Total Paid	\$
Balance Due	\$
Check	#

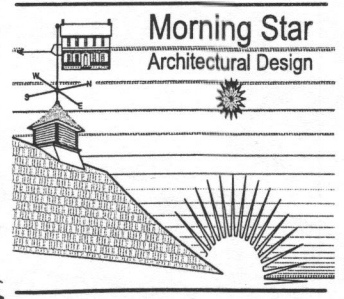

4991 Morning Star Drive  
Dayton, MD 21036  
P. 301.854.9012  
email jseils@mostarchitects.net

**Residential Deck Willow Pond**  
Lot 7 Tax Map 34 Grid 17 Parcel 382  
5th District, Clarksville, MD 20029  
Howard County

**Proposed Site Plan**

drawing title:

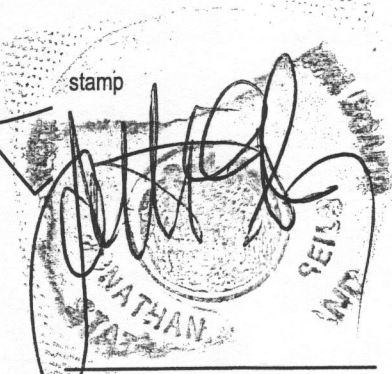
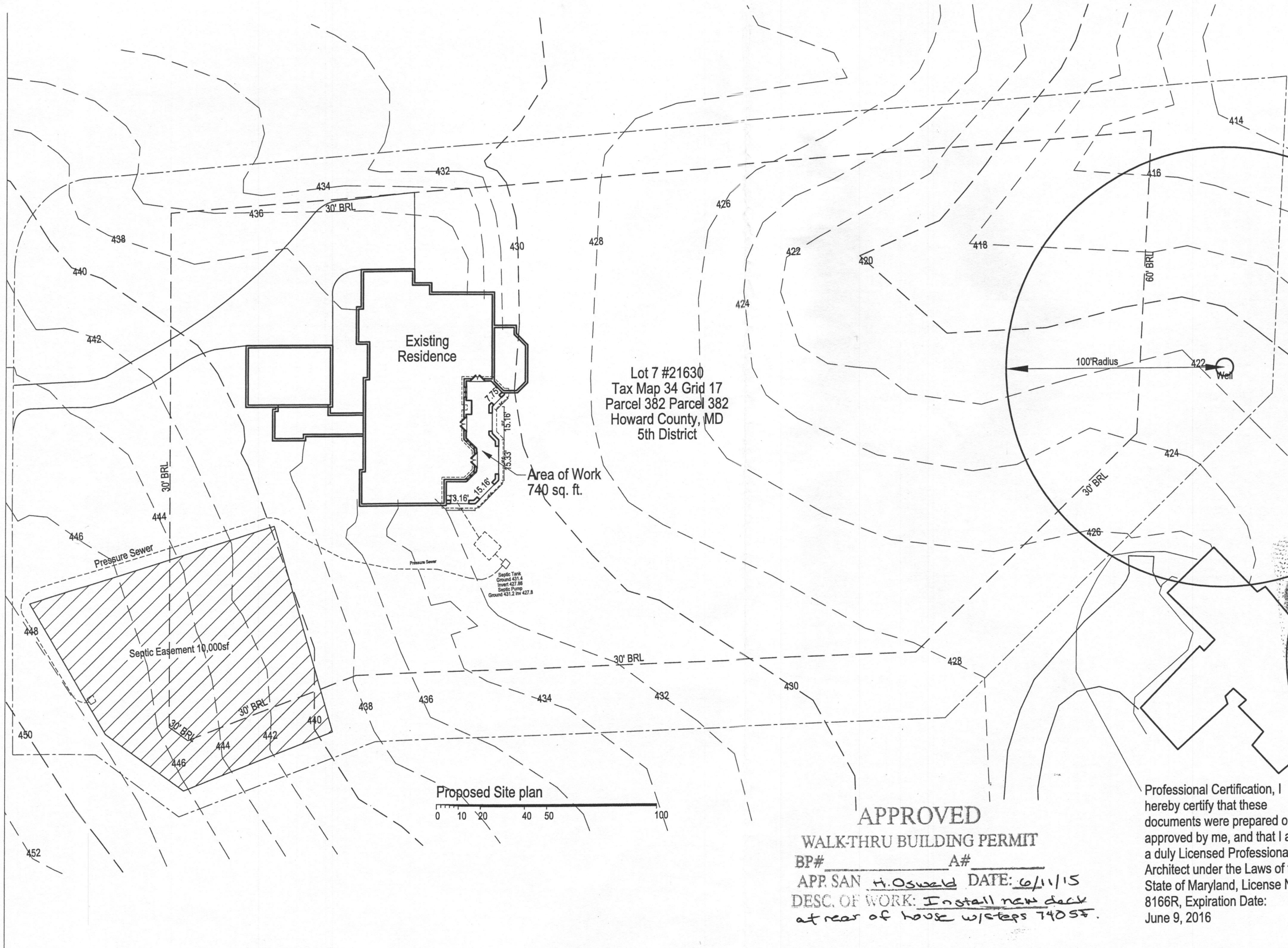

date: 8\_8\_15  
scale: 1/40"=1'-0"  
project no. HC-2015.35.1  
drawing no.

**C-1**

**APPROVED**  
**WALK-THRU BUILDING PERMIT**  
BP# \_\_\_\_\_ A# \_\_\_\_\_  
APP. SAN H. Oswald DATE: 6/11/15  
DESC. OF WORK: Install new deck at rear of house w/ steps 740 SF.

Professional Certification, I hereby certify that these documents were prepared or approved by me, and that I am a duly Licensed Professional Architect under the Laws of the State of Maryland, License No. 8166R, Expiration Date: June 9, 2016