

C1 3759

SEQUENCE NO. (MDE USE ONLY)

STATE OF MARYLAND WELL COMPLETION REPORT

THIS REPORT MUST BE SUBMITTED WITHIN 45 DAYS AFTER WELL IS COMPLETED.

1 2 3 6 (THIS NUMBER IS TO BE PUNCHED IN COLS. 3-6 ON ALL CARDS)

FILL IN THIS FORM COMPLETELY PLEASE TYPE

COUNTY NUMBER A 511939-M

ST/CO USE ONLY DATE Received MM DD YY 8 13

DATE WELL COMPLETED MM DD YY 09 07 04

Depth of Well 22 180 26 (TO NEAREST FOOT)

PERMIT NO. FROM "PERMIT TO DRILL WELL" HO-94-3991

OWNER Joseph Teklits STREET OR RFD 3242 Huntersworth Way TOWN Beltsville SUBDIVISION woods Wellington SECTION LOT 14

WELL LOG

Not required for driven wells

STATE THE KIND OF FORMATIONS PENETRATED, THEIR COLOR, DEPTH, THICKNESS AND IF WATER BEARING

Table with columns: DESCRIPTION, FEET (FROM, TO), check if water bearing. Includes entries for Top Soil, Sandy, Sand Stone, Sand Stone, MICKA, Flint Rock, MICKA.

260 ft Drilling HOLE Abandoned & sealed

GROUTING RECORD

WELL HAS BEEN GROUTED (Y) (N) TYPE OF GROUTING MATERIAL (C) (B) NO. OF BAGS 9 NO. OF POUNDS 900 GALLONS OF WATER 54 DEPTH OF GROUT SEAL 24

CASING RECORD

MAIN CASING TYPE PL Nominal diameter 6 Total depth 26

OTHER CASING (if used) diameter inch depth (feet) from to

SCREEN RECORD

screen type or open hole (H) (O) DEPTH (nearest ft.) 24 180

DIAMETER OF SCREEN 56 (NEAREST INCH) from to

GRAVEL PACK IF WELL DRILLED WAS FLOWING WELL INSERT F IN BOX 88

MDE USE ONLY (NOT TO BE FILLED IN BY DRILLER) T (E.R.O.S.) W Q

C 3

PUMPING TEST

HOURS PUMPED (nearest hour) 3 PUMPING RATE (gal. per min.) 15 METHOD USED TO MEASURE PUMPING RATE Bucket WATER LEVEL (distance from land surface) BEFORE PUMPING 54 WHEN PUMPING 56 TYPE OF PUMP USED (for test) S submersible

PUMP INSTALLED

DRILLER INSTALLED PUMP (YES) (NO) IF DRILLER INSTALLS PUMP, THIS SECTION MUST BE COMPLETED FOR ALL WELLS. TYPE OF PUMP INSTALLED PLACE (A,C,J,P,R,S,T,O) IN BOX 29 CAPACITY: GALLONS PER MINUTE (to nearest gallon) 31 35 PUMP HORSE POWER 37 41 PUMP COLUMN LENGTH (nearest ft.) 43 47 CASING HEIGHT (circle appropriate box and enter casing height) (+) above (nearest) (-) below (nearest) 2 (foot)

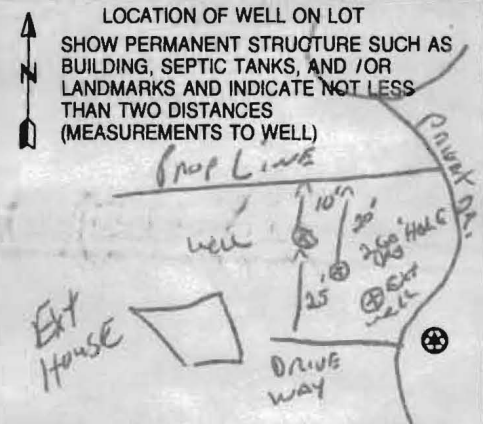

NUMBER OF UNSUCCESSFUL WELLS: 1 WELL HYDROFRACTURED (Y) (N) CIRCLE APPROPRIATE LETTER A WELL WAS ABANDONED AND SEALED WHEN THIS WELL WAS COMPLETED E ELECTRIC LOG OBTAINED P TEST WELL CONVERTED TO PRODUCTION WELL

I HEREBY CERTIFY THAT THIS WELL HAS BEEN CONSTRUCTED IN ACCORDANCE WITH COMAR 26.04.04 "WELL CONSTRUCTION" AND IN CONFORMANCE WITH ALL CONDITIONS STATED IN THE ABOVE CAPTIONED PERMIT, AND THAT THE INFORMATION PRESENTED HEREIN IS ACCURATE AND COMPLETE TO THE BEST OF MY KNOWLEDGE.

DRILLERS LIC. NO. MSD 117 DRILLERS SIGNATURE (MUST MATCH SIGNATURE ON APPLICATION) LIC. NO. D

SITE SUPERVISOR (sign. of driller or journeyman responsible for sitework if different from permittee)

B 1 18681

SEQUENCE NO. (MDE USE ONLY)

STATE OF MARYLAND PERMIT TO DRILL WELL

STATE PERMIT NUMBER

W 52075 Please print or type

400-94-3991 fill in this form completely

Date Received (APA) 06/30/04

OWNER INFORMATION

8 MM DD YY 13 15 Last Name Owner First Name 34 36 Street or RFD 55 57 Town 70 State 72 Zip 76 SELFRIDGE Builders TELKITS Rejected 14045 GANED DR. GLENWOOD MD 21738

B 3

LOCATION OF WELL

8 COUNTY 21 23 SUBDIVISION 42 44 46 SECTION 48 50 LOT 14 52 NEAREST TOWN 71 GLENWOOD 73 76 77 78 MILES FROM TOWN (enter 0 if in town) I M I

DRILLER INFORMATION

Driller's Name 76 License No. 81 Firm Name Address Signature Date RALPH E. MAYWE M S D 117 RALPH E. MAYWE INC 17024 HANDY RD. MT AIRY MD 21771 630-04

B 4

1 2 DIRECTION OF WELL FROM TOWN (CIRCLE BOX)

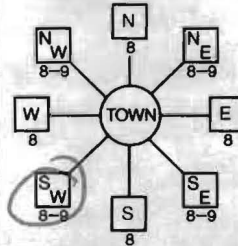

3242 11 NEAR WHAT ROAD 30 HUNTERWORTH WAY ON WHICH SIDE OF ROAD (CIRCLE APPROPRIATE BOX) NORTH WEST EAST SOUTH 34 40 37 DISTANCE FROM ROAD 41 ENTER FT OR MI 38 39 TAX MAP: 14 BLK: 19 PARCEL 264

B 2 WELL INFORMATION

1 2 APPROX. PUMPING RATE (GAL. PER MIN.) 5 8 500 12 AVERAGE DAILY QUANTITY NEEDED (GAL. PER DAY) 14 20

USE FOR WATER (CIRCLE APPROPRIATE BOX)

- (D) DOMESTIC POTABLE SUPPLY & RESIDENTIAL IRRIGATION (F) FARMING (LIVESTOCK WATERING & AGRICULTURAL IRRIGATION) (I) INDUSTRIAL, COMMERCIAL, DEWATERING (P) PUBLIC WATER SUPPLY WELL (T) TEST, OBSERVATION, MONITORING (G) GEO-THERMAL

NOT TO BE FILLED IN BY DRILLER HEALTH DEPARTMENT APPROVAL

COUNTY NAME COUNTY NO. STATE SIGNATURE INSERT S 41 DATE ISSUED 4/1/04 CO SIGNATURE EXP. DATE 8/1/05 NORTH GRID 528 0 0 0 EAST GRID 786 0 0 0 50 55 57 63

APPROXIMATE DEPTH OF WELL 150 24 28 FEET APPROXIMATE DIAMETER OF WELL 6 NEAREST INCH

METHOD OF DRILLING (circle one)

BORED (or Augered) JETTED Jetted & DRIVEN AIR-ROTARY AIR-PERCussion ROTARY (Hydraulic Rotary) CABLE REVERSE-ROTARY DRIVE-POINT other

REPLACEMENT OR DEEPEMED WELLS (CIRCLE APPROPRIATE BOX)

- (N) THIS WELL WILL NOT REPLACE AN EXISTING WELL (Y) THIS WELL WILL REPLACE A WELL THAT WILL BE ABANDONED AND SEALED (S) THIS WELL WILL REPLACE A WELL THAT WILL BE USED AS A STANDBY-CONTACT LOCAL APPROVING AUTHORITY FOR POLICY ON STANDBY WELLS (D) THIS WELL WILL DEEPEMED AN EXISTING WELL PERMIT NUMBER OF WELL TO BE REPLACED OR DEEPEMED (IF AVAILABLE) 41 52

Not to be filled in by driller (MDE OR COUNTY USE ONLY)

APPROX. PERMIT NUMBER 54 GAP 63 PERMIT No. 40-94-3991 70 71 72 73 74 75 76 77 78 79

SHOW MAJOR FEATURES OF BOX & LOCATE WELL WITH AN X

- SOURCES OF DRILLING WATER 1. well 2. 3.

WRITE THE BOX NUMBER FROM THE MAP HERE

E 520 786 N 786 528 000 000

DRAW A SKETCH BELOW SHOWING LOCATION OF WELL IN RELATION TO NEARBY TOWNS AND ROADS AND GIVE DISTANCE FROM WELL TO NEAREST ROAD JUNCTION

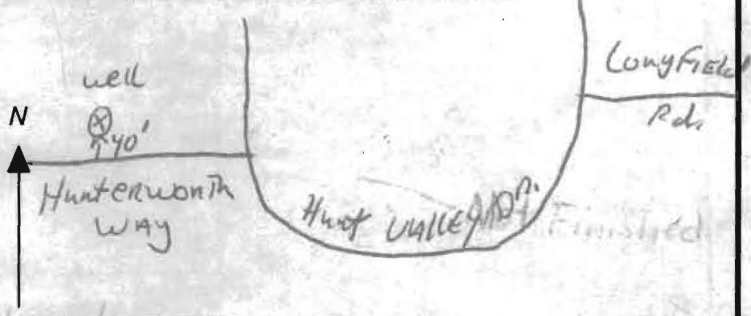

SPECIAL CONDITIONS

NOTE - APPROVING AUTHORITIES SHOULD USE SEPARATE SHEET IF NEEDED



Howard County
Health Department

3525 H Ellicott Mills Drive • Ellicott City, MD 21043
(410) 313-2640 Fax (410) 313-2648
TDD (410) 313-2323 Toll Free 1-866-313-6300
website: www.hchealth.org

Penny E. Borenstein, M.D., M.P.H., Health Officer

ATTENTION WELL DRILLERS!!!

When submitting a well application for a new or replacement well, please indicate one of the following:

- The well site has been staked by Benchmark Engineering on 6/14/04 and is ready for site inspection.
- _____ will call the Health Department for a time to meet in the field to verify a well location.
- Site plan for new well is attached to well permit application.

Please attach this sheet when submitting your green application. This should help improve communication allowing a more timely service for our citizens.

KN

**HOWARD COUNTY HEALTH DEPARTMENT
BUREAU OF ENVIRONMENTAL HEALTH
WATER AND SEWERAGE PROGRAM
TEL: (410)313-2640 FAX: (410)313-2648**

Information Form for the Installation of the Well Pump, Pitless Adapter, and Supply Piping

NOTE: The installer is responsible for requesting an inspection prior to 9 am on the day of the desired inspection. No work is to be covered until approved by the Health Department. All installations must comply with the National Standard Plumbing Code (NSPC, as amended locally) and COMAR 26.04.04 (MD Well Construction Regulations). Submission of a complete form is required prior to Use and Occupancy approval.

Company Name: NATIONAL WATER SERVICING Telephone #: 301-854-1333
Address: P.O. Box 138
ASHTON, MD 20861

(Must circle one) Licensed Plumber Licensed Well Driller **Licensed Well Pump Installer**
License # and name of individual responsible for the field installation:
Name (Print): DAVID RYCKE License# PI 0145

*A licensed individual must perform the actual installation. Apprentices must be under the direct supervision of a licensed journeyman or master plumber, pump installer or well driller. Licenses may be subjected to field verification.

Name of Property Owner: Joseph TEKITS Telephone #: _____
Subdivision: WOODS WELLINGTON Lot #: 14 Well Tag #: HO-94-3991
Site Address: 3242 HUNTERS WORTH WAY
STENWOOD, MD 21738

Submersible Pump Data	Pitless Adapter	Well Cap and Electric Conduit
Make: <u>GRUNDOS</u>	Make: <u>Am. GRUNDOS</u>	Two piece watertight cap: <u>YES</u>
Model #: <u>15 SQF 7B-18C</u>	Model#: <u>PT800</u>	Screened, vented well cap: <u>YES</u>
Pump Capacity <u>15</u> GPM	Depth: <u>42"</u> (36" min)	Cap secured to casing: <u>YES</u>
Well Yield: <u>15</u> GPM	NSF approved: <u>YES</u>	Conduit min 18" B.G.: <u>YES</u>
Depth of well encountered at time of pump installation: <u>180</u> (feet)		Conduit secured to well cap: <u>YES</u>

If pump capacity exceeds well yield, a low water cut off switch is required by NSPC 1990 Section 17.8.4
Torque arrestors or Cable guards are required - Must circle one
Safety rope, if used, attached to inside of well casing with eye bolt _____

Piping to house
Type: Aqua Jet Coil
PSI: 160 (160 psi min)
Depth of supply line: 36" (36" min)

House Connection
PVC sleeved to undisturbed soil at wall penetration: YES
Approximate length of sleeve: 5'10"
Sleeve caulked and sealed properly: YES

The water supply line is required to be at least ten feet from the septic tank, pump chamber, sewage piping, distribution box, drainfields, and sewage reserve area. If this cannot be accomplished, contact this office for approval prior to installation.

Signature of company representative responsible for installation: MDE PI-0145 date: 10/5/04

For Health Department Use Only - Not to be completed by Installer

Date Insp. Requested: _____ Date Insp. Approved: _____

Inspection Data:

Pitless adapter and water supply line at least 36" below grade	<input checked="" type="checkbox"/>	10/1/04 Not Finished
Two piece cap installed and attached to casing securely	<input checked="" type="checkbox"/>	
Elec. conduit extends at least 18" below grade/attached to cap properly	<input checked="" type="checkbox"/>	
Safety rope installed inside of well casing	<input checked="" type="checkbox"/>	
Correct well tag attached properly and casing 8" above finished grade	<input checked="" type="checkbox"/>	
Water supply line sleeved adequately at house connection	<input checked="" type="checkbox"/>	
Adequate grout observed below pitless adapter	<input checked="" type="checkbox"/>	Connected to Existing Line

