

LAYOUT 10/7/2010 INSP 4 \_\_\_\_\_  
INSP 2 \_\_\_\_\_ INSP 5 \_\_\_\_\_  
INSP 3 \_\_\_\_\_ INSP 6 \_\_\_\_\_

ISSUE DATE: 10/6/2010

# PERMIT

P 534054

APPROVAL DATE: 10/8/2010

A UPGRADE

Tax ID # \_\_\_\_\_

## ON-SITE SEWAGE DISPOSAL SYSTEM TANK REPLACEMENT HOWARD COUNTY HEALTH DEPARTMENT BUREAU OF ENVIRONMENTAL HEALTH

LEVEL LAND, INC. IS PERMITTED TO INSTALL  ALTER

ADDRESS: PO BOX 100 LISBON MD 21765 PHONE NUMBER: 443-677-0627

SUBDIVISION: TRIADELPHIA FARMS II LOT NUMBER: 11-B

ADDRESS: 13388 HUNT RIDGE ROAD PROPERTY OWNER: KANG CHUL

SEPTIC TANK CAPACITY (GALLONS): 1,000 OUTLET BAFFLE FILTER REQUIRED

PUMP CHAMBER CAPACITY (GALLONS): NA COMPARTMENTED TANK REQUIRED

NOTES:	Add 1,000 gallon tank in series to existing 1,000 gallon tank. Move dbx if necessary. <b>Do not</b> order the septic tank until after layout inspection and Sanitarian approval. Layout inspection required prior to tank installation. A written variance request is required for tanks deeper than 3 feet. A traffic bearing lid is required for tanks deeper than 4 feet.
--------	--

PLANS APPROVED: HS DATE: 10/6/2010

- NOTE: PERMIT VOID AFTER 2 YEARS
- NOTE: CONTRACTOR RESPONSIBLE FOR SCHEDULING A PRE-CONSTRUCTION INSPECTION FOR ALL INSTALLATIONS
- NOTE: WATERTIGHT SEPTIC TANKS REQUIRED
- NOTE: ALL PARTS OF SEPTIC SYSTEM SHALL BE 100 FEET FROM ANY WATER WELL
- NOTE: MANHOLE RISERS REQUIRED ON ALL SEPTIC TANKS AND PUMP CHAMBERS

**NEITHER THE HOWARD COUNTY COUNCIL OR THE HEALTH DEPARTMENT IS RESPONSIBLE FOR THE SUCCESSFUL OPERATION OF ANY SYSTEM PERMITTEE RESPONSIBLE FOR OBTAINING FINAL APPROVAL ON THIS PERMIT CALL 410-313-1771 FOR INSPECTION OF SEPTIC SYSTEM**

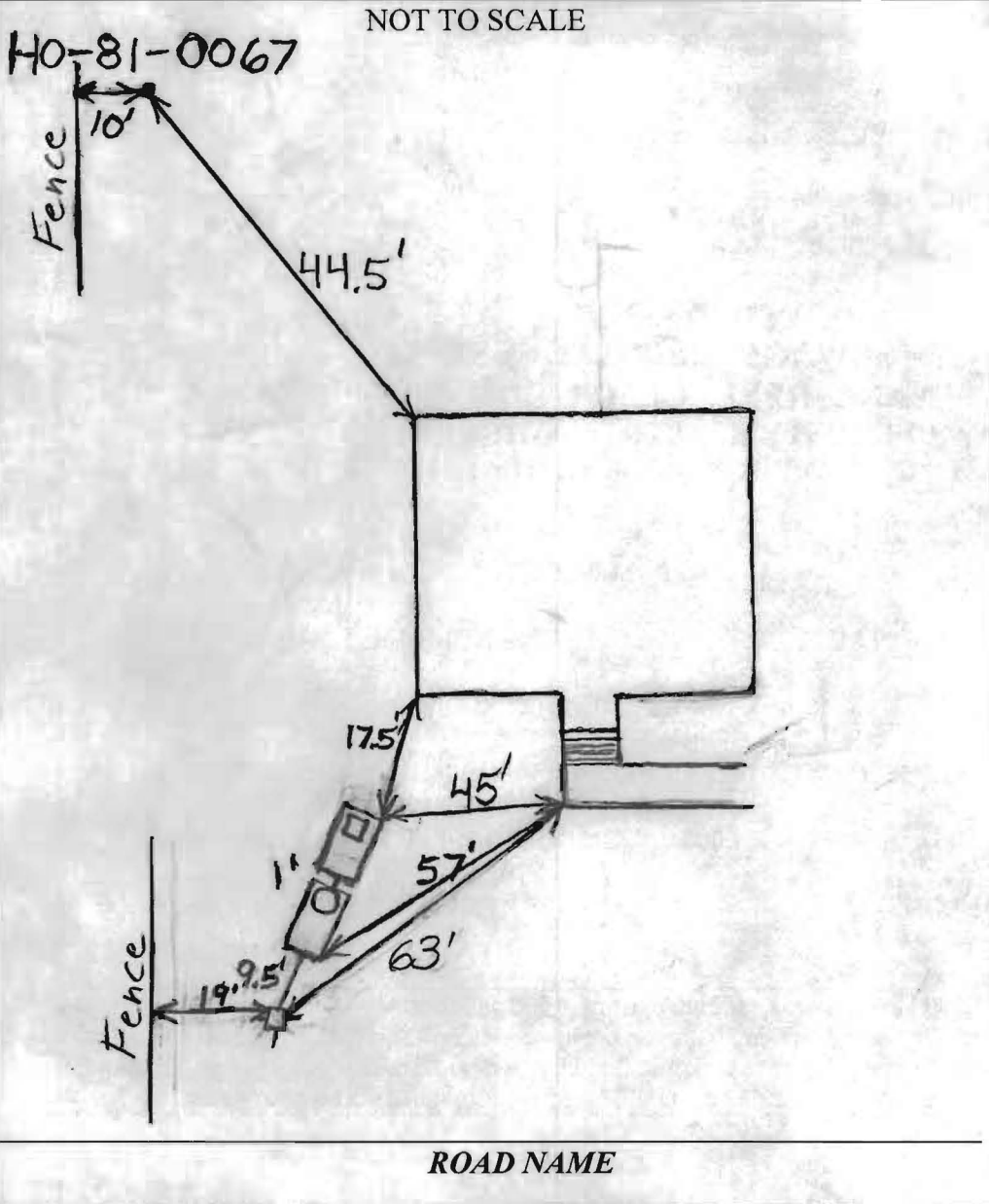

**TRENCH/DRAINFIELD DATA**

WIDTH	INLET	BOTTOM
_____	_____	_____
NUMBER OF TRENCHES _____		
TOTAL LENGTH _____		
ABSORPTION AREA _____		
DISTRIBUTION BOX LEVEL <u>Levelers</u>		
DISTRIBUTION BOX BAFFLE <u>Yes</u>		
DISTRIBUTION BOX PORT <u>No</u>		

**SEPTIC TANK DATA**

SEPTIC TANK I LEVEL \_\_\_\_\_

MANUFACTURER \_\_\_\_\_

CAPACITY \_\_\_\_\_ GAL

SEAM LOC Midseam

TANK LID DEPTH 1-1.5

BAFFLES Yes

BAFFLE FILTER N

MANHOLE LOC Front

6" PORT LOC None

WATERTIGHT TEST No

SLOTTED No

DATE ON LID None

PUMP/SEPTIC TANK LEVEL Yes

MANUFACTURER Babylon

CAPACITY 1,000 GAL

SEAM LOC Top Seam

TANK LID DEPTH 1-1.5

BAFFLES Yes

BAFFLE FILTER NO

MANHOLE LOC Front

6" PORT LOC None

WATERTIGHT TEST NO

SLOTTED No

DATE ON LID 8/29/10

PRE-CONSTRUCTION: 10/7/2010 Tank set. Pipe from original tank to dist. box was going uphill. I told installer to raise tank and line from house or if possible lower dist. box. (BB)

INSTALLATION: 10/8/2010 Installer said he was able to lower pipes going to bed and thus lower dist. box. Slight fall to dist. box. from tank. O.K. to cover. (BB)

FINAL INSPECTOR B. Baker DATE OF APPROVAL 10/8/2010