

APPLICATION

FOR PERCOLATION TESTING AND SITE EVALUATION

TEST DATE(S) _____ TEST TIME _____

AVP 533221

AGENCY REVIEW: _____

DATE 4-30-10

DO NOT WRITE ABOVE THIS LINE

HEREBY APPLY FOR THE NECESSARY TESTING/EVALUATION PRIOR TO ISSUANCE OF SEWAGE DISPOSAL SYSTEM PERMIT(S) TO:

CHECK AS NEEDED:

- CONSTRUCT NEW SEPTIC SYSTEM(S)
- REPAIR/ADD TO AN EXISTING SEPTIC SYSTEM
- REPLACE AN EXISTING SEPTIC SYSTEM

CHECK AS NEEDED:

- NEW STRUCTURE(S)
- ADDITION TO AN EXISTING STRUCTURE
- REPLACE AN EXISTING STRUCTURE

CHECK ONE:

- CREATE NEW LOT(S)
- BUILD ON AN EXISTING LOT IN A SUBDIVISION
- BUILD ON AN EXISTING PARCEL OF RECORD

IS THE PROPERTY WITHIN 2500' OF ANY RESERVOIR?

- YES
- NO

THE TYPE OF STRUCTURE IS:

- RESIDENTIAL WITH 3 PROPOSED BEDROOMS IN THE COMPLETED STRUCTURE (NOTE UNKNOWN IF APPROPRIATE)
- COMMERCIAL (PROVIDE DETAIL OF NUMBERS AND TYPES OF EMPLOYEES/ CUSTOMERS ON ACCOMPANYING PLAN)
- INSTITUTIONAL/GOVERNMENT (PROVIDE DETAIL OF NUMBERS AND TYPES OF EMPLOYEES/USERS ON ACCOMPANYING PLAN)

PROPERTY OWNER(S) Jennifer & Bob KAPLAN

DAYTIME PHONE 410-531-3562 CELL _____ FAX _____

MAILING ADDRESS 14185 Howard Rd Dayton MD 21036
STREET CITY/TOWN STATE ZIP

APPLICANT Ronnie Heaps / J.M. Cont. LLC.

DAYTIME PHONE 443-277-7526 CELL SAME FAX 410-552-5815

MAILING ADDRESS 4125 OBracht Rd. Sykesville MD 21784
STREET CITY/TOWN STATE ZIP

APPLICANT'S ROLE: DEVELOPER BUILDER BUYER RELATIVE/FRIEND REALTOR CONSULTANT

PROPERTY LOCATION
SUBDIVISION/PROPERTY NAME _____ LOT NO. _____

PROPERTY ADDRESS 14185 Howard Rd. Dayton MD 21036
STREET TOWN/POST OFFICE

MAP PAGE(S) _____ GRID _____ PARCEL(S) _____ PROPOSED LOT SIZE _____

I, APPLICANT, I UNDERSTAND THE FOLLOWING: THE SYSTEM INSTALLED SUBSEQUENT TO THIS APPLICATION IS ACCEPTABLE ONLY UNTIL PUBLIC SEWERAGE IS AVAILABLE. THIS APPLICATION IS COMPLETE WHEN ALL APPLICABLE FEES AND A DETAILED SITE PLAN HAVE BEEN RECEIVED. I ACCEPT THE RESPONSIBILITY FOR COMPLIANCE WITH ALL M.O.S.H.A. AND "ISSUE UTILITY" REQUIREMENTS. APPROVAL IS BASED UPON SATISFACTORY REVIEW OF A PERC CERTIFICATION PLAN. TEST RESULTS WILL BE MAILED TO APPLICANT.

Ronnie Heaps
SIGNATURE OF APPLICANT

HOWARD COUNTY HEALTH DEPARTMENT, BUREAU OF ENVIRONMENTAL HEALTH, WELL AND SEPTIC PROGRAM
 7178 COLUMBIA GATEWAY DRIVE COLUMBIA, MARYLAND 21046 (410) 313-1771 FAX (410) 313-2648
 TDD (410) 313-2323 TOLL FREE 1-877-4MD-DHMH



APPLICATION

FOR PERCOLATION TESTING AND SITE EVALUATION

TEST DATE(S) _____ TEST TIME _____ A/P 533 221

AGENCY REVIEW: _____ DATE 4/30/10

DO NOT WRITE ABOVE THIS LINE

I HEREBY APPLY FOR THE NECESSARY TESTING/EVALUATION PRIOR TO ISSUANCE OF SEWAGE DISPOSAL SYSTEM PERMIT(S) TO:

CHECK AS NEEDED:

- CONSTRUCT NEW SEPTIC SYSTEM(S)
- REPAIR/ADD TO AN EXISTING SEPTIC SYSTEM
- REPLACE AN EXISTING SEPTIC SYSTEM

CHECK AS NEEDED:

- NEW STRUCTURE(S)
- ADDITION TO AN EXISTING STRUCTURE
- REPLACE AN EXISTING STRUCTURE

CHECK ONE:

- CREATE NEW LOT(S)
- BUILD ON AN EXISTING LOT IN A SUBDIVISION
- BUILD ON AN EXISTING PARCEL OF RECORD

IS THE PROPERTY WITHIN 2500' OF ANY RESERVOIR?

- YES
- NO

THE TYPE OF STRUCTURE IS:

- RESIDENTIAL WITH _____ PROPOSED BEDROOMS IN THE COMPLETED STRUCTURE (NOTE **UNKNOWN** IF APPROPRIATE)
- COMMERCIAL (PROVIDE DETAIL OF NUMBERS AND TYPES OF EMPLOYEES/CUSTOMERS ON ACCOMPANYING PLAN)
- INSTITUTIONAL/GOVERNMENT (PROVIDE DETAIL OF NUMBERS AND TYPES OF EMPLOYEES/USERS ON ACCOMPANYING PLAN)

PROPERTY OWNER(S) _____

DAYTIME PHONE _____ CELL _____ FAX _____

MAILING ADDRESS _____
STREET CITY/TOWN STATE ZIP

APPLICANT _____

DAYTIME PHONE _____ CELL _____ FAX _____

MAILING ADDRESS _____
STREET CITY/TOWN STATE ZIP

APPLICANT'S ROLE: DEVELOPER BUILDER BUYER RELATIVE/FRIEND REALTOR CONSULTANT

PROPERTY LOCATION
SUBDIVISION/PROPERTY NAME 14185 Howard Road LOT NO. _____

PROPERTY ADDRESS _____
STREET TOWN/POST OFFICE

TAX MAP PAGE(S) _____ GRID _____ PARCEL(S) _____ PROPOSED LOT SIZE _____

AS APPLICANT, I UNDERSTAND THE FOLLOWING: THE SYSTEM INSTALLED SUBSEQUENT TO THIS APPLICATION IS ACCEPTABLE ONLY UNTIL PUBLIC SEWERAGE IS AVAILABLE. THIS APPLICATION IS COMPLETE WHEN ALL APPLICABLE FEES AND A SUITABLE SITE PLAN HAVE BEEN RECEIVED. I ACCEPT THE RESPONSIBILITY FOR COMPLIANCE WITH ALL M.O.S.H.A. AND "MISS UTILITY" REQUIREMENTS. APPROVAL IS BASED UPON SATISFACTORY REVIEW OF A PERC CERTIFICATION PLAN.

BEST RESULTS WILL BE MAILED TO APPLICANT.

SIGNATURE OF APPLICANT

HOWARD COUNTY HEALTH DEPARTMENT, BUREAU OF ENVIRONMENTAL HEALTH, WELL AND SEPTIC PROGRAM
7178 COLUMBIA GATEWAY DRIVE COLUMBIA, MARYLAND 21046 (410) 313-1771 FAX (410) 313-2648
TDD (410) 313-2323 TOLL FREE 1-877-4MD-DHMH

(A)
 Dense Br
 Sa Cl Loam
 6.5'
 21'
 41'
 7.5'
 Dense Sa
 Loam, Some
 Cl, Getting
 Sandier
 Near Bottom
 14'

(C)
 ~70%
 Rock
 6.5'

(D)
 >50%
 Below
 3.5'

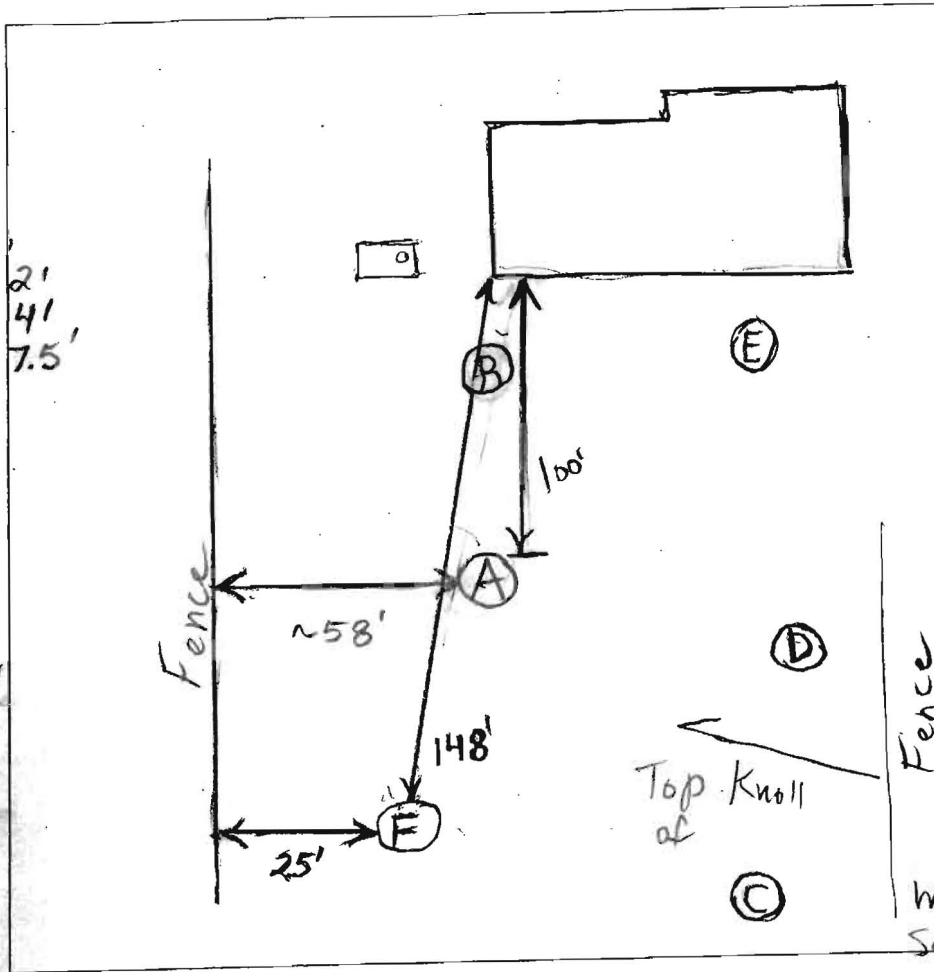

(B)
 Fill 2'
 Red Br
 Sa Cl Loam
 15% Rock 5.5'
 Dense Sa Loam,
 Some Clay
 ~40% Rock,
 Turning to
 a Sa Loam Near Bottom
 11'
 Water
 Seepage 13'

(E)
 Br Loam
 sbk 2'-2.5'
 Red Br
 Cl Loam Dense
 sbk 4'-5'
 Red Br
 Sa Cl Loam Loose
 Not Much
 Rock 7'
 5+8'
 Water
 Seepage
 60-70%
 Hard
 Bottom 9'

(F)
 Topsoil 1.5'
 Cl Loam Mottled
 Dense 4'
 Sa Cl Loam
 ~10% Rock
 Rock
 10'

DATE	TEST #	DEPTH	START	BREAK 1" DROP	STOP 2" DROP	TIME OF 2ND INCH	P/F/H
5/4/10	A	6.5' / 14'	11:54	12:20:30	12:54:30		34
	C	6.5' V					F
	D	7' V					F

REMARKS Front Yard Should Be Evaluated For Repairs
 SANITARIAN B. Baker BACKHOE Heaps OTHERS _____
 TEST HOLES USED IN SDA None AVG. PERC TIME 40 SQ. FT/BR _____
 TRENCH WIDTH _____ INLET DEPTH _____ MAX. BOT DEPTH _____ EFFECTIVE SW _____



Bureau of Environmental Health
7178 Columbia Gateway Drive, Columbia, MD 21046-2147
(410) 313-2640 Fax (410) 313-2648
TDD (410) 313-2323 Toll Free 1-866-313-6300
website: www.hchealth.org

Peter L. Beilenson, M.D., M.P.H., Health Officer

To: George Schooley, Applicant
Legacy Contracting, Inc, Fax 410-871-0404

gschooley@legacycontracting.com

From: Robert Bricker, RS/REHS, CPSS
Environmental Sanitarian Supervisor, Development Coordination Section

RE: 14185 Howard Road, Percolation Test Application Proposal

Date: July 8, 2011

A plan must be submitted to the Well and Septic Program so that the percolation test proposal for the subject property may be scheduled.

The plan must be to scale of 1":30' (1 inch = 30 feet), 1":40', 1":50', 1":60', or 1":100', and it must accurately depict the following features.

1. The property line.
2. The house footprint and the footprint of the proposed new construction.
3. Existing well and septic locations, and if considered a location for a replacement well.
4. Neighbors' wells' and septic systems.
5. Proposed percolation test locations.

Should you or your clients have questions concerning this evaluation you may contact me at the Bureau of Environmental Health.

Copy: Shawn Rosenberry, owner
Jeff Williams, Well and Septic Program Supervisor
file

George Schooley
Legacy Contracting
301-370-4121



APPLICATION

FOR PERCOLATION TESTING AND SITE EVALUATION

TEST DATE(S) _____ TEST TIME _____

AGENCY REVIEW: _____

AP# 55243
DATE 06/08/2014

DO NOT WRITE ABOVE THIS LINE

I HEREBY APPLY FOR THE NECESSARY TESTING/EVALUATION PRIOR TO ISSUANCE OF SEWAGE DISPOSAL SYSTEM PERMIT(S) TO:

CHECK AS NEEDED:

- CONSTRUCT NEW SEPTIC SYSTEM(S)
- REPAIR/ADD TO AN EXISTING SEPTIC SYSTEM
- REPLACE AN EXISTING SEPTIC SYSTEM

CHECK AS NEEDED:

- NEW STRUCTURE(S)
- ADDITION TO AN EXISTING STRUCTURE
- REPLACE AN EXISTING STRUCTURE

CHECK ONE:

- CREATE NEW LOT(S)
- BUILD ON AN EXISTING LOT IN A SUBDIVISION
- BUILD ON AN EXISTING PARCEL OF RECORD

IS THE PROPERTY WITHIN 2500' OF ANY RESERVOIR?

- YES
- NO

THE TYPE OF STRUCTURE IS:

- RESIDENTIAL WITH 3 PROPOSED BEDROOMS IN THE COMPLETED STRUCTURE (NOTE *UNKNOWN* IF APPROPRIATE)
- COMMERCIAL (PROVIDE DETAIL OF NUMBERS AND TYPES OF EMPLOYEES/ CUSTOMERS ON ACCOMPANYING PLAN)
- INSTITUTIONAL/GOVERNMENT (PROVIDE DETAIL OF NUMBERS AND TYPES OF EMPLOYEES/USERS ON ACCOMPANYING PLAN)

PROPERTY OWNER(S) Shawn M. Rosenberry

DAYTIME PHONE _____ CELL _____ FAX _____

MAILING ADDRESS 1418S HOWARD RD. DAYTON MD 21036
STREET CITY/TOWN STATE ZIP

APPLICANT Legacy Contracting Inc

DAYTIME PHONE 410-840-8766 CELL 301-370-4121 FAX 410-891-0404

MAILING ADDRESS 1538 MANCHESTER RD WESTMINSTER MD 21157
STREET CITY/TOWN STATE ZIP

APPLICANT'S ROLE: DEVELOPER BUILDER BUYER RELATIVE/FRIEND REALTOR CONSULTANT

PROPERTY LOCATION
SUBDIVISION/PROPERTY NAME Rosenberry LOT NO. _____

PROPERTY ADDRESS 1418S HOWARD RD. DAYTON MD. 21036
STREET TOWN/POST OFFICE

TAX MAP PAGE(S) _____ GRID _____ PARCEL(S) _____ PROPOSED George School

AS APPLICANT, I UNDERSTAND THE FOLLOWING: THE SYSTEM INSTALLED SUBSEQUENT TO THIS A
 BLE ONLY UNTIL PUBLIC SEWERAGE IS AVAILABLE. THIS APPLICATION IS COMPLETE WHEN ALL A
 SUITABLE SITE PLAN HAVE BEEN RECEIVED. I ACCEPT THE RESPONSIBILITY FOR COMPLIANCE WIT
 "MISS UTILITY" REQUIREMENTS. APPROVAL IS BASED UPON SATISFACTORY REVIEW OF A PERC CE
 TEST RESULTS WILL BE MAILED TO APPLICANT.

George School
 SIGNATURE OF APPLICANT

HOWARD COUNTY HEALTH DEPARTMENT, BUREAU OF ENVIRONMENTAL HEALTH AND SAFETY PROGRAM
 7178 COLUMBIA GATEWAY DRIVE COLUMBIA, MARYLAND 21045 (410) 313-2640 FAX (410) 313-2648
 TDD (410) 313-2323 TOLL FREE 1-877-4MD-0111



APPLICATION

FOR PERCOLATION TESTING AND SITE EVALUATION

TEST DATE(S) _____ TEST TIME _____

AP# 535243

AGENCY REVIEW: _____

DATE 06/08/2011

DO NOT WRITE ABOVE THIS LINE

I HEREBY APPLY FOR THE NECESSARY TESTING/EVALUATION PRIOR TO ISSUANCE OF SEWAGE DISPOSAL SYSTEM PERMIT(S) TO:

CHECK AS NEEDED:

- CONSTRUCT NEW SEPTIC SYSTEM(S)
- REPAIR/ADD TO AN EXISTING SEPTIC SYSTEM
- REPLACE AN EXISTING SEPTIC SYSTEM

CHECK AS NEEDED:

- NEW STRUCTURE(S)
- ADDITION TO AN EXISTING STRUCTURE
- REPLACE AN EXISTING STRUCTURE

CHECK ONE:

- CREATE NEW LOT(S)
- BUILD ON AN EXISTING LOT IN A SUBDIVISION
- BUILD ON AN EXISTING PARCEL OF RECORD

IS THE PROPERTY WITHIN 2500' OF ANY RESERVOIR?

- YES
- NO

THE TYPE OF STRUCTURE IS:

- RESIDENTIAL WITH 3 PROPOSED BEDROOMS IN THE COMPLETED STRUCTURE (NOTE UNKNOWN IF APPROPRIATE)
- COMMERCIAL (PROVIDE DETAIL OF NUMBERS AND TYPES OF EMPLOYEES/ CUSTOMERS ON ACCOMPANYING PLAN)
- INSTITUTIONAL/GOVERNMENT (PROVIDE DETAIL OF NUMBERS AND TYPES OF EMPLOYEES/USERS ON ACCOMPANYING PLAN)

PROPERTY OWNER(S) Shawn M. Rosenberry

DAYTIME PHONE _____ CELL _____ FAX _____

MAILING ADDRESS 1418 S HOWARD RD. DAYTON MD 21036
STREET CITY/TOWN STATE ZIP

APPLICANT Legacy Contracting Inc

DAYTIME PHONE 410-840-8766 CELL 301-370-4121 FAX 410-891-0404

MAILING ADDRESS 1538 MANCHESTER RD WESTMINSTER MD 21157
STREET CITY/TOWN STATE ZIP

APPLICANT'S ROLE: DEVELOPER BUILDER BUYER RELATIVE/FRIEND REALTOR CONSULTANT

PROPERTY LOCATION
SUBDIVISION/PROPERTY NAME Rosenberry LOT NO. _____

PROPERTY ADDRESS 1418 S HOWARD RD. DAYTON MD, 21036
STREET TOWN/POST OFFICE

TAX MAP PAGE(S) _____ GRID _____ PARCEL(S) _____ PROPOSED George School

AS APPLICANT, I UNDERSTAND THE FOLLOWING: THE SYSTEM INSTALLED SUBSEQUENT TO THIS APPLICATION IS COMPLETE WHEN ALL A SUITABLE SITE PLAN HAVE BEEN RECEIVED. I ACCEPT THE RESPONSIBILITY FOR COMPLIANCE WITH "MISS UTILITY" REQUIREMENTS. APPROVAL IS BASED UPON SATISFACTORY REVIEW OF A PERCOLATION TEST RESULTS WILL BE MAILED TO APPLICANT.

[Signature]
SIGNATURE OF APPLICANT

HOWARD COUNTY HEALTH DEPARTMENT, BUREAU OF ENVIRONMENTAL HEALTH, WELL AND SEPTIC PROGRAM
7178 COLUMBIA GATEWAY DRIVE COLUMBIA, MARYLAND 21046 (410) 313-2640 FAX (410) 313-2643
TDD (410) 313-2323 TOLL FREE 1-877-4MD-DHML

Legacy Contracting

ICF/Geothermal/Concrete & Paving, Excavating & Utilities

410-313-2648 (f)

18 May, 2012

Mr. Curtis Hughes

Howard County Health Department

6751 Columbia Gateway Drive

Columbia, MD 21046

RE: 14185 Howard Road

Dayton, MD

Dear Mr. Hughes:

In talking with Ms. Juanita King today, I advised that we are inquiring about the attached receipt #35243 dated 06/08/11 in the amount of \$506.00. Legacy requested a Perc Test permit for the home owner (at the time) Shawn Rosenberry. I do not have a record that this permit made any progress after that payment.

Our Customer, Shawn Rosenberry, has since sold the house and no longer lives in the area. Legacy would like to request a refund on Mr. Rosenberry's behalf. Please advise regarding what would be necessary to make this happen.

Thank you for your assistance.

Sincerely,

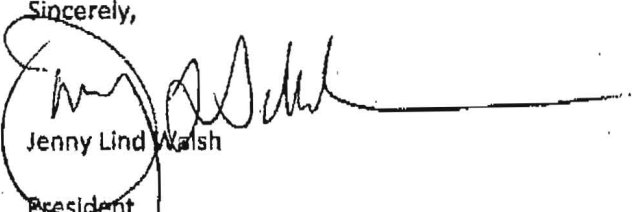

Jenny Lind Walsh

President

cc: Mr. Shawn Rosenberry

1538 Manchester Road • Westminster, MD 21157 • Office 410/840-8766 • Fax 410/871-0404
www.legacycontracting.com



Bureau of Environmental Health
7178 Columbia Gateway Drive, Columbia, MD 21046-2147
(410) 313-2640 Fax (410) 313-2648
TDD (410) 313-2323 Toll Free 1-866-313-6300
website: www.hchealth.org

Peter L. Beilenson, M.D., M.P.H., Health Officer

To: George Schooley, Applicant
Legacy Contracting, Inc, Fax 410-871-0404

gschooley@legacycontracting.com

From: Robert Bricker, RS/REHS, CPSS
Environmental Sanitarian Supervisor, Development Coordination Section

RE: 14185 Howard Road, Percolation Test Application Proposal

Date: July 8, 2011

A plan must be submitted to the Well and Septic Program so that the percolation test proposal for the subject property may be scheduled.

The plan must be to scale of 1":30' (1 inch = 30 feet), 1":40', 1":50', 1":60', or 1":100', and it must accurately depict the following features.

1. The property line.
2. The house footprint and the footprint of the proposed new construction.
3. Existing well and septic locations, and if considered a location for a replacement well.
4. Neighbors' wells' and septic systems.
5. Proposed percolation test locations.

Should you or your clients have questions concerning this evaluation you may contact me at the Bureau of Environmental Health.

Copy: Shawn Rosenberry, owner
Jeff Williams, Well and Septic Program Supervisor
file

*George Schooley
Legacy Contracting
301-370-4121*

Legacy Contracting

ICF/Geothermal/Concrete & Paving, Excavating & Utilities

410-313-2648 (f)

18 May, 2012

Mr. Curtis Hughes

Howard County Health Department

6751 Columbia Gateway Drive

Columbia, MD 21046

RE: 14185 Howard Road

Dayton, MD

Dear Mr. Hughes:

In talking with Ms. Juanita King today, I advised that we are inquiring about the attached receipt #35243 dated 06/08/11 in the amount of \$506.00. Legacy requested a Perc Test permit for the home owner (at the time) Shawn Rosenberry. I do not have a record that this permit made any progress after that payment.

Our Customer, Shawn Rosenberry, has since sold the house and no longer lives in the area. Legacy would like to request a refund on Mr. Rosenberry's behalf. Please advise regarding what would be necessary to make this happen.

Thank you for your assistance.

Sincerely,

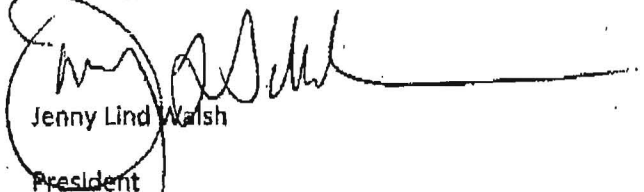

Jenny Lind Walsh
President

cc: Mr. Shawn Rosenberry

1538 Manchester Road • Westminster, MD 21157 • Office 410/340-8766 • Fax 410/371-0104
www.legacycontracting.com

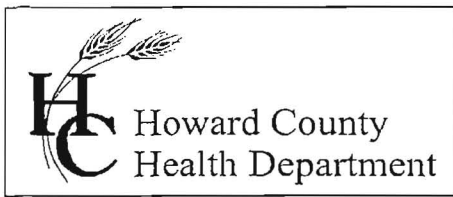

Bureau of Environmental Health
7178 Gateway Drive Columbia, MD 21046
(410) 313-2640 Fax (410) 313-2648
TDD (410) 313-2323 Toll Free 1-866-313-6300
website: www.hchealth.org

Peter L. Beilenson, M.D., M.P.H., Health Officer

May 29, 2012

To Whom It May Concern:

Legacy Contracting, paid for a PERC test, in the amount of \$506.00 (check #7999);
Legacy Contracting did not have to PERC the property. Jenny Lind Walsh is requesting
\$506.00 refund – (receipt #35243). If you have any other questions please call Jenny
Lind Walsh at 410-840-8766

Mail Check To
Legacy Contracting
1538 Manchester Road
Westminster, MD 21787

#35243 06/08/2011 written by LaShae Mitchelle
#84570 06/10/2011 written by Willie Sims

Thanks in advance

Cute HR at 1774- 5/29/12-

Juanita King ext 4251

Juanita King 5/29/12

Jeff Williams 5/29/12

Jeff Williams

Well & Septic Supervisor

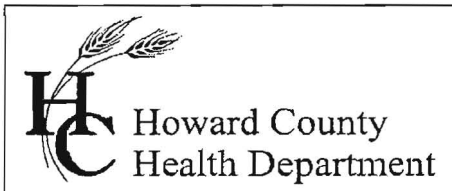

Bureau of Environmental Health
7178 Gateway Drive Columbia, MD 21046
(410) 313-2640 Fax (410) 313-2648
TDD (410) 313-2323 Toll Free 1-866-313-6300
website: www.hchealth.org

Peter L. Beilenson, M.D., M.P.H., Health Officer

MEMORANDUM

TO: Curtis Hughes
FROM: Jeff Williams *JW*
RE: Perc Test Fee Refund
DATE: May 29, 2012

I approve the refund of a perc test fee for 14185 Howard Road paid by Legacy Contracting for the owner Shawn Rosenberry. The receipt number was 35243.

Howard County Health Department
Daily Receipts

Date Of Clinic or Collection : 8-Jun-11

Receipt Numbers: Well & Septic- 35242-35244

<u>Unit / Clinic</u>	<u>Project Code - item</u>	<u>Amount</u>
Administration	3701	
Personal Health Admin	3703	
Environmental Health	3765-1933	\$ 785.00
Technology Surcharge	3765-1965	\$ 51.00
Child Health	4416	
Prenatal	4418	
E.C. & Savage Family Planning	4419	
Communicable Disease*	4422	
Addictions Detention Center	3712	
Columbia Family Planning	4691	
Addictions	4843	
Copies	1939	\$0.00
Return Check Fee	9000-4450	
Total		\$836.00

E/H
Well 3
Septic

Submitted By: *Rachael Mitchell*

*Communicable Disease includes: item codes		
Human rabies	Client Fees	-1933
Tuberculosis	Postage	-0302
Influenza	Copying	-1939
Pneumococcal	Faxes	-1939
Hepatitis	MH Lunchies	-1939

YOUR RECEIPT
THANK YOU
CALL AGAIN

REG 06-09-2011 16:47
0001

NON-TAX
CHECK \$55.00
\$55.00

YOUR RECEIPT
THANK YOU
CALL AGAIN

REG 06-09-2011 16:47
0002

NON-TAX
CHECK \$506.00
\$506.00

YOUR RECEIPT
THANK YOU
CALL AGAIN

REG 06-09-2011 16:47
0003

NON-TAX
CHECK \$275.00
\$275.00



HOWARD COUNTY HEALTH DEPARTMENT

84570

CASH
 CHECK
NO.

CODES ^{785.00}
3765 - 1963
^{51.00}
3765 - 1965

DATE
6/10/11

Received From L. Mitchell
For Wellt Septor 35242 - 35244

eight hundred thirty six Dollars

\$ 836.00

Received By W. Mitchell



HOWARD COUNTY HEALTH DEPARTMENT

35243

DATE 01 / 06 / 00

Received From PERC Testing Lab PHONE # 410-326-7000

1533 14185 Howard Rd

For PERC Testing - 14185 Howard Rd

MD 21036

NO. 7999

five hundred and xx Dollars

\$ 500.00 Received By A. M. ...



HOWARD COUNTY HEALTH DEPARTMENT

35243

DATE 06/08/2011

AS

Received From

Lacey Contracting

PHONE # 410-840-8716

1538 Manchester Rd Westminster MD 21157

For Perc testing - 14185 Howard Rd Puyallup MD 21036

<input type="checkbox"/>	CASH
<input checked="" type="checkbox"/>	CHECK
NO.	7999
(CC)	

five hundred six xx/ Dollars

\$ 506.00

Received By Amichele

FILE INQUIRY NOTES

DATE	RESULTS OF REVIEW FOR FILE
5/9/11	If Any perc application for an addition / upgrade
	is is submitted, please check with Jeff for
	details. There are marginal soil conditions that may
	require a consult with Steve Krieg. SW