

PUB. SEWER STATUS VERIFIED BY _____

ISSUE DATE: 11/08/07

P 527900

APPROVAL DATE: 11/30/07

A REPAIR

Tax ID # **04-327608**

**ON-SITE SEWAGE DISPOSAL SYSTEM
HOWARD COUNTY HEALTH DEPARTMENT
BUREAU OF ENVIRONMENTAL HEALTH**

Hatfields Equipment IS PERMITTED TO INSTALL ALTER

ADDRESS: PO Box 519, Annapolis Junction 20701 PHONE NUMBER: 301-490-4289

SUBDIVISION: _____ LOT NUMBER: _____

ADDRESS: 2221 Daisy Road PROPERTY OWNER: Toni Deal

SEPTIC TANK CAPACITY (GALLONS): 1500

PUMP CHAMBER CAPACITY (GALLONS): _____

NUMBER OF BEDROOMS: _____

SQUARE FEET PER BEDROOM: _____

LINEAR FEET OF TRENCH REQUIRED: _____

TRENCHES:	Trench to be _____ feet wide. Inlet _____ feet below original grade. Bottom maximum depth _____ feet below original grade. Effective area begins at _____ feet below original grade. _____ feet of stone below distribution pipe.
LOCATION:	
PURPOSE:	Replacing existing septic tank with 1500 gallon tank. Call for inspection when ground is opened so sanitarian can recommend repair.

PLANS APPROVED: _____ DATE: _____

- NOTE: PERMIT VOID AFTER 2 YEARS
- NOTE: CONTRACTOR RESPONSIBLE FOR SCHEDULING A PRE-CONSTRUCTION INSPECTION FOR ALL INSTALLATIONS
- NOTE: WATERTIGHT SEPTIC TANKS REQUIRED
- NOTE: ALL PARTS OF SEPTIC SYSTEM SHALL BE 100 FEET FROM ANY WATER WELL
- NOTE: MANHOLE RISERS REQUIRED ON ALL SEPTIC TANKS AND PUMP CHAMBERS

NEITHER THE HOWARD COUNTY COUNCIL OR THE HEALTH DEPARTMENT IS RESPONSIBLE FOR THE SUCCESSFUL OPERATION OF ANY SYSTEM PERMITTEE RESPONSIBLE FOR OBTAINING FINAL APPROVAL ON THIS PERMIT CALL 410-313-2640 FOR INSPECTION OF SEPTIC SYSTEM

P 31516

NOT TO SCALE

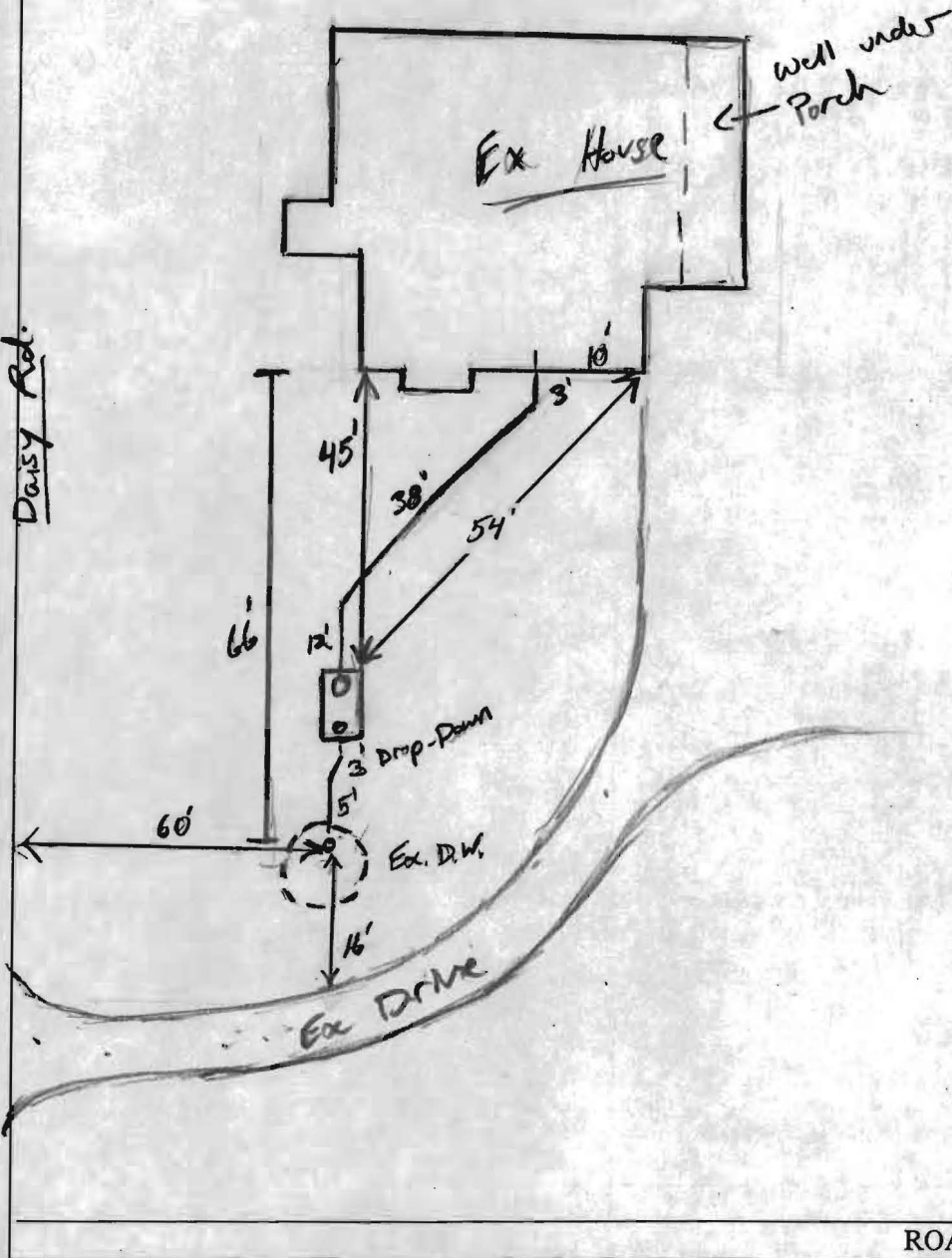

TRENCH/DRAINFIELD DATA		
WIDTH	INLET	BOTTOM
_____	_____	_____
NUMBER OF TRENCHES _____		
TOTAL LENGTH _____		
ABSORPTION AREA _____		
DISTRIBUTION BOX LEVEL _____		
DISTRIBUTION BOX BAFFLE _____		
DISTRIBUTION BOX PORT _____		

SEPTIC TANK DATA		
SEPTIC TANK 1 LEVEL <u>Yes</u>		
CAPACITY	<u>1500</u>	GAL
SEAM LOC	<u>Top</u>	
TANK LID DEPTH	<u>2-3'</u>	
BAFFLES	<u>Yes</u>	
BAFFLE FILTER	<u>—</u>	
MANHOLE LOC	<u>Front</u>	
6" PORT LOC	<u>Rear</u>	
WATERTIGHT TEST	<u>—</u>	
<u>Babyon 2comp slotted</u>		
SEPTIC TANK 2 LEVEL _____		
CAPACITY	_____	GAL
SEAM LOC	_____	
TANK LID DEPTH	_____	
BAFFLES	_____	
BAFFLE FILTER	_____	
MANHOLE LOC	_____	
6" PORT LOC	_____	
WATERTIGHT TEST	_____	

PRE-CONSTRUCTION

INSTALLATION: 11/30/07 All new plumbing installed from house to Ex. D.W. Ex. Drywell fairly dry. OK to backfill (M)

FINAL INSPECTOR K. Wolf DATE OF APPROVAL 11/30/07

Hatfield's Equipment and Dedication Services, Inc.

P.O. Box 519 • Annapolis Junction, MD 20701-0519
Office: 301-490-4289 / 888-490-4289 • Fax: 301-490-5794

Toni Deal
2221 Daisy Road
Woodbine, MD 21797

Tank replacement
Proposal # 2602

October 23, 2007

We propose to supply the labor, materials and equipment to complete the following:

Apply for permit.

\$165.00

Pump and remove existing septic tank, haul off site. Install a 1,500 gallon top seam two compartmented tank using existing manhole. Install 50 LF of 4" PVC pipe from outside the house to the new tank, from the tank to the existing drywell. Seed and straw disturbed area.

Tank
Replacement