

Bureau of Environmental Health
 8930 Stanford Blvd. Columbia, MD 21045
 (410) 313-2640 Fax (410) 313-2648
 TDD (410) 313-2323 Toll Free 1-866-313-6300
 website: www.hchealth.org

Maura J. Rossman, M.D., Health Officer

RECEIPT DATE: 7/14/14 **ONSITE SEWAGE DISPOSAL SYSTEM** P 554541

INSTALLATION
 APPROVAL DATE: 8/1/14 **PERMIT** A _____
UPGRADE

PROPERTY ADDRESS: 2012 Meadow Tree Court

SUBDIVISION: Riggs Property LOT: 35 TAX ID: 04-360532

CONTRACTOR: Fogle's Septic Clean Inc. EMAIL: kevin@foglesinc.com

CONTRACTOR ADDRESS: 580 Obrecht Road, Sykesville, MD 21784 PHONE: 410-795-5670

PROPERTY OWNER: Thomas and Allison Kern EMAIL: _____

OWNER ADDRESS: 2012 Meadow Tree Court, Cooksville, MD 21723 PHONE: 410-409-2229

BAT UNIT MODEL: _____ BAT UNIT SIZE: _____

PUMP CHAMBER CAPACITY (GALLONS): _____ PUMP SIZE: _____

NUMBER OF BEDROOMS: _____ HOUSE SQ. FT. _____ APPLICATION RATE: _____

DISTRIBUTION SYSTEM: GRAVITY FED LOW PRESSURE DOSED

TRENCHES:	LINEAR FEET REQUIRED: _____	INLET DEPTH: _____
	TRENCH WIDTH: _____	MAXIMUM BOTTOM DEPTH: _____
	MINIMUM SPACE BETWEEN TRENCHES: _____	EFFECTIVE AREA BEGINNING DEPTH: _____
	LOCATION: PER APPROVED SITE PLAN. SEWAGE DISPOSAL AREA AND BAT UNIT LOCATION MUST BE STAKED BY LICENSED SURVEYOR PRIOR TO PRE-CONSTRUCTION INSPECTION.	
NOTES:	<i>New 2000 gallon septic tank to be set per approved site plan. Stake out addition corners. New septic tank must meet 10-foot setback to proposed addition. Pump out old septic tank, collapse and backfill with clean fill dirt.</i>	

ISSUED BY: Hank Oswald ISSUE DATE: _____ EXPIRATION DATE: _____

- NOTE: CONTRACTOR MUST SCHEDULE A PRE-CONSTRUCTION INSPECTION PRIOR TO BEGINNING ANY INSTALLATION
- NOTE: CONTRACTOR MUST SCHEDULE AN INSPECTION AND GAIN APPROVAL OF ALL COMPONENTS PRIOR TO COVERING
- NOTE: STONE MUST BE APPROVED BY HEALTH DEPARTMENT AND GRAVEL TICKET MUST BE AVAILABLE FOR REVIEW.
- NOTE: WATERTIGHT SEPTIC TANKS REQUIRED
- NOTE: ALL PARTS OF SEPTIC SYSTEM SHALL BE AT LEAST 100 FEET DOWNGRADIENT FROM ANY WATER WELL
- NOTE: MANHOLE RISERS REQUIRED ON ALL SEPTIC TANKS AND PUMP CHAMBERS
- NOTE: AN ELECTRICAL PERMIT IS REQUIRED FOR INSTALLATION OF ANY ELECTRICAL COMPONENTS OF THE SYSTEM

NEITHER THE HOWARD COUNTY COUNCIL NOR THE HEALTH DEPARTMENT IS RESPONSIBLE FOR THE SUCCESSFUL OPERATION OF ANY SYSTEM.

PERMITTEE RESPONSIBLE FOR OBTAINING FINAL APPROVAL ON THIS PERMIT.

CALL 410-313-1771 TO SCHEDULE INSPECTIONS.

NOT TO SCALE

~50'

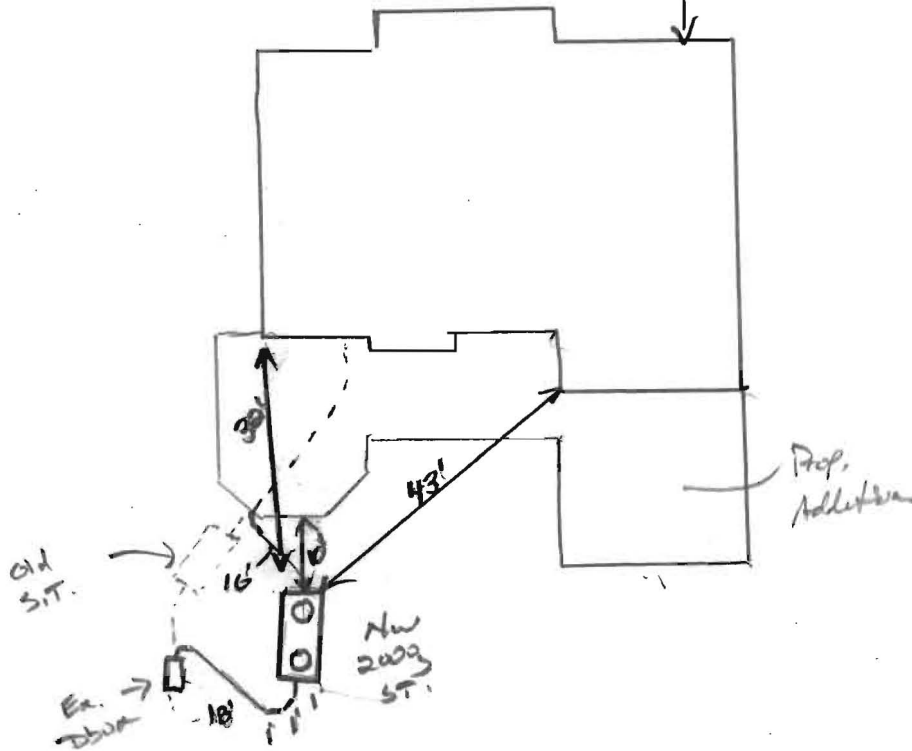

ROAD NAME

TRENCH/DRAINFIELD DATA

WIDTH	INLET	BOTTOM
_____	_____	_____
NUMBER OF TRENCHES _____		
TOTAL LENGTH _____		
ABSORPTION AREA _____		
DISTRIBUTION BOX LEVEL _____		
DISTRIBUTION BOX BAFFLE _____		
DISTRIBUTION BOX PORT _____		

SEPTIC TANK DATA

SEPTIC TANK I LEVEL	Yes
MANUFACTURER	Babylon
CAPACITY	2000 GAL
SEAM LOC	Top
TANK LID DEPTH	4'
BAFFLES	Yes
BAFFLE FILTER	—
MANHOLE LOC	Front/Rear
6" PORT LOC	none
WATERTIGHT TEST	—
SLOTTED	Yes
DATE ON LID	6-25-14

PUMP/SEPTIC TANK LEVEL

MANUFACTURER	_____
CAPACITY	_____ GAL
SEAM LOC	_____
TANK LID DEPTH	_____
BAFFLES	_____
BAFFLE FILTER	_____
MANHOLE LOC	_____
6" PORT LOC	_____
WATERTIGHT TEST	_____
SLOTTED	_____
DATE ON LID	_____

PRE-CONSTRUCTION:

INSTALLATION: 8/1/14 Ex. septic tank pump and collapsed. New 2000 gal 2 compartment tank installed downhill of existing tank, 10' to proposed addition. Tank depth around 4'. No lid ordered or cover.

FINAL INSPECTOR

K. Wolf

DATE OF APPROVAL

8/1/14

Oswald, Hank

From: Oswald, Hank
Sent: Tuesday, July 22, 2014 2:06 PM
To: 'kevin@foglesinc.com'; 'AL.STEARNS@AROCONLLC.COM'
Cc: Martin, Sharhonda; Wolf, Kevin; Baker, Brian; 'Allison Kern'
Subject: Septic Upgrade Permit_2012 Meadow Tree Court

Kevin (Fogle's Septic Clean inc.):

The septic upgrade permit for 2012 Meadow Tree Court has been approved.

Al Stearns (Arocon Roofing & Construction):

At time of new septic tank inspection, please stake location of proposed addition to help inspector verify the 10 foot setback requirement.

Please contact me with any questions.

Respectfully,

Hank

Hank Oswald, L.E.H.S.
Howard County Health Department
Well & Septic Program
8930 Stanford BLVD
Columbia, MD 21045
410-313-1786
410-313-2648 (Fax)

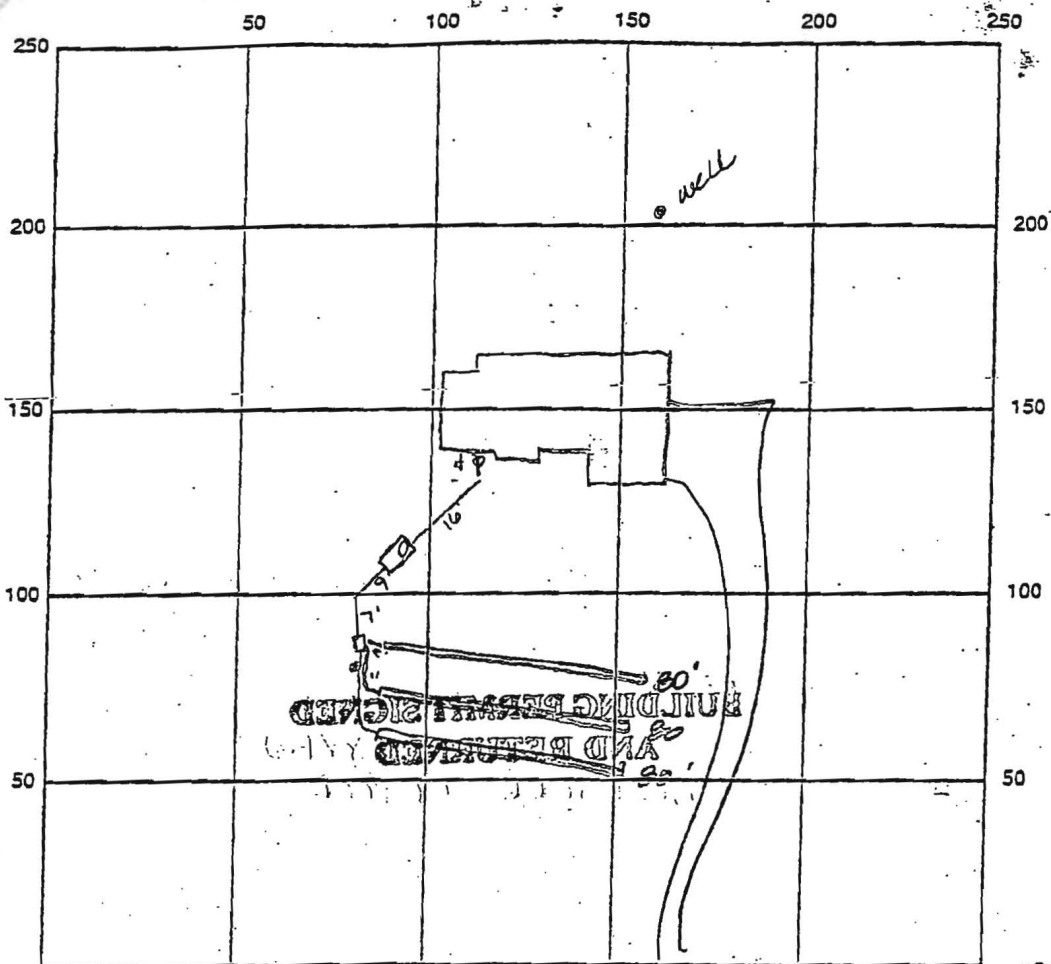

INDICATE NORTH - NAME ADJOINING ROADWAY AS BASE LINE Riggs Meadow

LEVEL 1250 gal CLEANOUTS 2 cleanouts @ roose tank
 BOX LEVEL OK baffles in
 TILE DEPTH 5.5 FT. TRENCH WIDTH 3.0 FT. INLET DEPTH 3.5 FT.
 AVEL DEPTH 2.0 FT. TOTAL LENGTH 240 FT.
 NUMBER OF TRENCHES 3 ONE SIDEWALL/BOTTOM AREA 720 SQ. FT. $\frac{240}{\frac{1}{3}}$
 PIPE DIAMETER — FT. EFFECTIVE DEPTH BELOW INLET 2.0 FT.
 CORBENT AREA — SQ. FT.

1199 OK to cover all work final Au

Pitless adaptor OK - PVC conduit needed Au

APPROVED 2/1/99 INSPECTOR Amy McMillan