

C1 3739

SEQUENCE NO. (MDE USE ONLY)

STATE OF MARYLAND WELL COMPLETION REPORT

THIS REPORT MUST BE SUBMITTED WITHIN 45 DAYS AFTER WELL IS COMPLETED.

COUNTY NUMBER D 44358

1 2 3 6 (THIS NUMBER IS TO BE PUNCHED IN COLS. 3-6 ON ALL CARDS)

ST/CO USE ONLY

DATE RECEIVED MM DD YY

DATE WELL COMPLETED

MM DD YY 7 15 04

Depth of Well

22 300 26 (TO NEAREST FOOT)

PERMIT NO. FROM "PERMIT TO DRILL WELL"

10 - 94 - 3971

OWNER

STREET OR RFD 13201 Highland Rd TOWN Highland, MD

SUBDIVISION 34/21/67 SECTION LOT

WELL LOG

Not required for driven wells

STATE THE KIND OF FORMATIONS PENETRATED, THEIR COLOR, DEPTH, THICKNESS AND IF WATER BEARING

DESCRIPTION (Use additional sheets if needed) FEET FROM TO check if water bearing

Table with 3 columns: Description, Feet From, Feet To. Rows include Brown mica (0-95), Gray Limestone (95-120), White (120-21), Gray Limestone (21-285), white (285-286), Gray Limestone (286-300).

GROUTING RECORD

WELL HAS BEEN GROUTED (Circle Appropriate Box) Y N

TYPE OF GROUTING MATERIAL (Circle one) CEMENT CM BENTONITE CLAY BC

NO. OF BAGS 14 NO. OF POUNDS 1316

GALLONS OF WATER 84

DEPTH OF GROUT SEAL (to nearest foot)

from 0 ft. to 40 ft. (enter 0 if from surface)

CASING RECORD

MAIN CASING TYPE PL Nominal diameter top (main casing) (nearest inch)! 06 Total depth of main casing (nearest foot) 100

OTHER CASING (if used) diameter inch depth (feet) from to

SCREEN RECORD

screen type or open hole insert appropriate code below ST BR HO PL OT

DEPTH (nearest ft.) 1 2 3 4 5 6 7 8 9 10 11 12 13 14 15 16 17 18 19 20 21 22 23 24 25 26 27 28 29 30 31 32 33 34 35 36 37 38 39 40 41 42 43 44 45 46 47 48 49 50 51

SLOT SIZE 1 2 3 DIAMETER OF SCREEN (NEAREST INCH) 56 60 from to

GRAVEL PACK IF WELL DRILLED WAS FLOWING WELL INSERT F IN BOX 68

MDE USE ONLY (NOT TO BE FILLED IN BY DRILLER) T (E.R.O.S.) W Q

70 72 TELESCOPE CASING LOG INDICATOR OTHER DATA

C 3

PUMPING TEST

HOURS PUMPED (nearest hour) 01

PUMPING RATE (gal. per min.) 10

METHOD USED TO MEASURE PUMPING RATE 190L

WATER LEVEL (distance from land surface)

BEFORE PUMPING 55 ft.

WHEN PUMPING 290 ft.

TYPE OF PUMP USED (for test)

A air P piston T turbine C centrifugal R rotary O other (describe below) J jet S submersible

PUMP INSTALLED

DRILLER INSTALLED PUMP (CIRCLE) (YES or NO) YES NO

IF DRILLER INSTALLS PUMP, THIS SECTION MUST BE COMPLETED FOR ALL WELLS.

TYPE OF PUMP INSTALLED PLACE (A,C,J,P,R,S,T,O) IN BOX 29

CAPACITY: GALLONS PER MINUTE (to nearest gallon) 10

PUMP HORSE POWER 3/4

PUMP COLUMN LENGTH (nearest ft.) 280

CASING HEIGHT (circle appropriate box and enter casing height)

above below 01 (nearest foot)

LOCATION OF WELL ON LOT

SHOW PERMANENT STRUCTURE SUCH AS BUILDING, SEPTIC TANKS, AND /OR LANDMARKS AND INDICATE NOT LESS THAN TWO DISTANCES (MEASUREMENTS TO WELL)

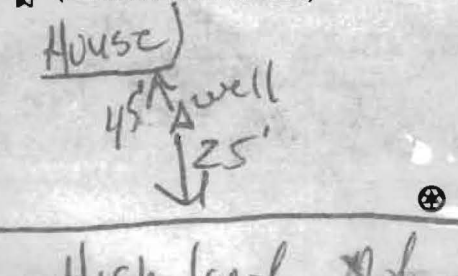

NUMBER OF UNSUCCESSFUL WELLS: 0

WELL HYDROFRACTURED yes Y no N

CIRCLE APPROPRIATE LETTER A WELL WAS ABANDONED AND SEALED WHEN THIS WELL WAS COMPLETED E ELECTRIC LOG OBTAINED P TEST WELL CONVERTED TO PRODUCTION WELL

I HEREBY CERTIFY THAT THIS WELL HAS BEEN CONSTRUCTED IN ACCORDANCE WITH COMAR 26.04.04 "WELL CONSTRUCTION" AND IN CONFORMANCE WITH ALL CONDITIONS STATED IN THE ABOVE CAPTIONED PERMIT, AND THAT THE INFORMATION PRESENTED HEREIN IS ACCURATE AND COMPLETE TO THE BEST OF MY KNOWLEDGE.

DRILLERS LIC. NO. M SD 009

DRILLERS SIGNATURE LIC. NO. D

SITE SUPERVISOR (sign. of driller or journeyman responsible for sitework if different from permittee)

B 1 2839

SEQUENCE NO. (MDE USE ONLY)

STATE OF MARYLAND APPLICATION FOR PERMIT TO DRILL WELL please type

STATE PERMIT NUMBER

HO - 94 - 3971

Date Received (APA)

OWNER INFORMATION

Thomas, Charlie
13201 Highland Rd.
Highland, Md. 20777

B 3 LOCATION OF WELL

Howard
8 COUNTY 21
23 SUBDIVISION 42
SECTION 44 46 LOT 48 50
Highland
52 NEAREST TOWN 71
MILES FROM TOWN (enter 0 if in town) 3

DRILLER INFORMATION

Allen Compton MS D 009
Fogle Well Drilling
580 Obrecht Rd
5-19-04

B 4

DIRECTION OF WELL FROM TOWN (CIRCLE BOX)

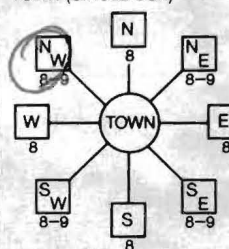

13201 Highland Rd
NEAR WHAT ROAD

ON WHICH SIDE OF ROAD (CIRCLE APPROPRIATE BOX)
NORTH WEST EAST SOUTH
DISTANCE FROM ROAD 100 FT
ENTER FT OR MI
TAX MAP: 34 BLK: 21 PARCEL 67

B 2 WELL INFORMATION

APPROX. PUMPING RATE (GAL. PER MIN.) 5
AVERAGE DAILY QUANTITY NEEDED (GAL. PER DAY) 500

NOT TO BE FILLED IN BY DRILLER HEALTH DEPARTMENT APPROVAL

Howard P44358
COUNTY NAME COUNTY NO.
STATE SIGNATURE INSERT S
DATE ISSUED 6/24/04 6/28/05
CO SIGNATURE EXP. DATE
NORTH GRID 492 000 EAST GRID 808 000

USE FOR WATER (CIRCLE APPROPRIATE BOX)

- D DOMESTIC POTABLE SUPPLY & RESIDENTIAL IRRIGATION
F FARMING (LIVESTOCK WATERING & AGRICULTURAL IRRIGATION)
I INDUSTRIAL, COMMERCIAL, DEWATERING
P PUBLIC WATER SUPPLY WELL
T TEST, OBSERVATION, MONITORING
G GEO-THERMAL

SHOW MAJOR FEATURES OF BOX & LOCATE WELL WITH AN X

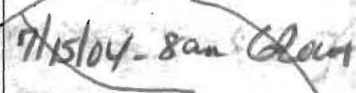

SOURCES OF DRILLING WATER

WRITE THE BOX NUMBER FROM THE MAP HERE

E 808
N 492

DRAW A SKETCH BELOW SHOWING LOCATION OF WELL IN RELATION TO NEARBY TOWNS AND ROADS AND GIVE DISTANCE FROM WELL TO NEAREST ROAD JUNCTION



APPROXIMATE DEPTH OF WELL 300 FEET

APPROXIMATE DIAMETER OF WELL 6 INCH

METHOD OF DRILLING (circle one)

BORED (or Augered) JETTED Jetted & DRIVEN
AIR-ROTary AIR-PERCussion ROTARY (Hydraulic Rotary)
CABLE REVerse-ROTary DRive-POINT

REPLACEMENT OR DEEPEMED WELLS (CIRCLE APPROPRIATE BOX)

- N THIS WELL WILL NOT REPLACE AN EXISTING WELL
Y THIS WELL WILL REPLACE A WELL THAT WILL BE ABANDONED AND SEALED
S THIS WELL WILL REPLACE A WELL THAT WILL BE USED AS A STANDBY-CONTACT LOCAL APPROVING AUTHORITY FOR POLICY ON STANDBY WELLS
D THIS WELL WILL DEEPEMED AN EXISTING WELL

PERMIT NUMBER OF WELL TO BE REPLACED OR DEEPEMED (IF AVAILABLE) 41

Not to be filled in by driller (MDE OR COUNTY USE ONLY)

APPROP. PERMIT NUMBER G
PERMIT No. HO - 94 - 3971

SPECIAL CONDITIONS

NOTE - APPROVING AUTHORITIES SHOULD USE SEPARATE SHEET IF NEEDED

**HOWARD COUNTY HEALTH DEPARTMENT  
BUREAU OF ENVIRONMENTAL HEALTH  
WATER AND SEWERAGE PROGRAM  
TEL: (410)313-2640 FAX: (410)313-2648**

**Information Form for the Installation of the Well Pump, Pitless Adapter, and Supply Piping**

**NOTE: The installer is responsible for requesting an inspection prior to 9 am on the day of the desired inspection. No work is to be covered until approved by the Health Department. All installations must comply with the National Standard Plumbing Code (NSPC, as amended locally) and COMAR 26.04.04 (MD Well Construction Regulations). Submission of a complete form is required prior to Use and Occupancy approval.**

Company Name: \_\_\_\_\_ Telephone #: \_\_\_\_\_  
Address: \_\_\_\_\_  
\_\_\_\_\_

(**Must circle one**) Licensed Plumber      Licensed Well Driller      Licensed Well Pump Installer  
License # and name of individual responsible for the field installation:

Name (Print): \_\_\_\_\_ License# \_\_\_\_\_

**\*A licensed individual must perform the actual installation. Apprentices must be under the supervision of a licensed journeyman or master plumber, pump installer or well driller. Licenses may be subjected to field verification. Unlicensed individuals may be reported to the appropriate licensing agency.**

Name of Property Owner: CHARLIE THOMAS Telephone #: \_\_\_\_\_  
Subdivision: \_\_\_\_\_ Lot #: \_\_\_\_\_ Well Tag #: HO-94-3971 ✓  
Site Address: 13201 HIGHLAND ROAD

<b><u>Submersible Pump Data</u></b>	<b><u>Pitless Adapter</u></b>	<b><u>Well Cap and Electric Conduit</u></b>
Make: _____	Make: _____	Two piece watertight cap: _____
Model #: _____	Model#: _____	Screened, vented well cap: _____
Pump Capacity _____ GPM	Depth: _____ (36" min)	Cap secured to casing: _____
Well Yield: _____ GPM	NSF/WSC approved: _____	Conduit min 18" B.G.: _____
Depth of well encountered at time of pump installation: _____ (feet)	Conduit secured to well cap: _____	

If pump capacity exceeds well yield, a low water cut off switch is required by NSPC 1990 Section 17.8.4  
Torque arrestors, Cable guards, or other acceptable method used- Must circle one  
**Safety rope, if used, attached to brass rope adapter or other acceptable method inside of well casing**

<b><u>Piping to house</u></b>	<b><u>House Connection</u></b>
Type: _____	PVC sleeve to undisturbed soil at wall penetration: _____
PSI: _____ (160 psi min)	Approximate length of sleeve: _____
Depth of supply line: _____ (36" min)	Sleeve caulked and sealed properly: _____

**The water supply line is required to be at least ten feet from the septic tank, pump chamber, sewage piping, distribution box, drainfields, and sewage reserve area. If this cannot be accomplished, contact this office for approval prior to installation.**

Signature of company representative responsible for installation \_\_\_\_\_ date \_\_\_\_\_

**For Health Department Use Only - Not to be completed by Installer**

Date Insp. Requested: 7/29/04 AM Date Insp. Approved: 8/2/04 Inspector: (SO)  
 Inspection Data: Pitless adapter watertight & water supply line at least 36" below grade \_\_\_\_\_  
 Two piece cap installed and attached to casing securely \_\_\_\_\_  
 Elec. conduit extends at least 18" below grade/attached to cap properly \_\_\_\_\_  
 Safety rope not seen outside of well cap/casing \_\_\_\_\_  
 Correct well tag attached properly and casing 8" above finished grade \_\_\_\_\_  
 Water supply line sleeved adequately at house connection \_\_\_\_\_  
 Adequate grout observed below pitless adapter \_\_\_\_\_

*T/C to Cont. said cap is glued (SO)*

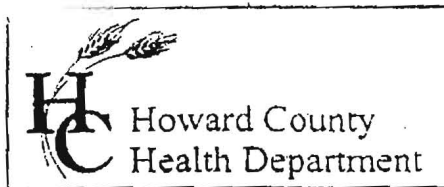

3525 H Ellicott Mills Drive, Ellicott City, MD 21043  
(410) 313-2640 Fax (410) 313-2648  
TDD (410) 313-2323 Toll Free 1-866-313-6300  
website: www.hchealth.org

Penny E. Borenstein, M.D., M.P.H., Health Officer

TO ALL INTERESTED PARTIES

When submitting a well permit application for a proposed well for new construction, please indicate one of the following:

- The well site has been staked by \_\_\_\_\_  
(professional land surveyor or company employing professional land surveyors)  
on \_\_\_\_\_ (date) and does not require a site inspection.
- The well driller, builder or property owner will call the Health Department to schedule a time to meet in the field to verify the proposed well site location.

This sheet, along with two copies of an acceptable well site plan, must be attached to the green well permit application.

Revised 6/10/03

Mark already spoke with the  
homeowner about this - have  
Mark call us when he can  
meet on site -  
Thanks  
Theresa

